

RECEIVED
AUG 16 2024
Natural Resources
NYSDEC Region 3 - New Paltz

NORTH EDGE REALTY
TOPOGRAPHIC SURVEY OF PROPERTY
SITUATE IN THE
TOWN OF SOMERS
WESTCHESTER COUNTY
NEW YORK

SCALE: 1" = 50'
SURVEYED: APRIL 1, 2021

ADDITIONAL TOPOGRAPHIC INFORMATION SHOWN FOR ADJACENT LOT: AUGUST 19, 2021
AMENDED TO SHOW NYSDEC FRESHWATER WETLAND BOUNDARY VALIDATION : SEPTEMBER 9, 2021
SURVEYED AMENDED TO REFLECT CURRENT OWNERS NAME AND UPDATE DEC VALIDATION BOX: FEBRUARY 12, 2024
WETLAND FLAGS & MAP AMENDED AUGUST 7, 2024

- THE PREMISES SHOWN HEREON DESIGNATED AS LOT NO. 1 ON A CERTAIN MAP ENTITLED "LOT LINE CHANGE MAP PREPARED FOR NORTH EDGE REALTY CORP.", MADE BY LINK LAND SURVEYORS DATED SEPTEMBER 5, 2023 FILED IN THE WESTCHESTER COUNTY CLERK'S OFFICE - DIVISION OF LAND RECORDS ON OCTOBER 24, 2023 AS FILED MAP NO. 29762.
- THIS MAP IS BASED UPON THE INFORMATION SUPPLIED BY THE CLIENT AND/OR HIS REPRESENTATIVE AND SUBJECT TO THE FINDINGS THAT A COMPLETE ABSTRACT OF TITLE MAY UNCOVER.
- TOPOGRAPHIC INFORMATION SHOWN HEREON TAKEN FROM THE WESTCHESTER COUNTY GEOGRAPHIC INFORMATION SYSTEMS MAP.
- THE OFFSETS SHOWN HEREON ARE NOT INTENDED TO ESTABLISH PROPERTY LINES FOR THE ERECTION OF FENCES, STRUCTURES OR ANY OTHER IMPROVEMENTS.
- ENCROACHMENTS BELOW GRADE AND/OR SUBSURFACE FEATURES, IF ANY, NOT LOCATED OR SHOWN HEREON.
- UNAUTHORIZED ALTERATION OR ADDITION TO A SURVEY MAP BEARING A LICENSED LAND SURVEYOR'S SEAL IS A VIOLATION OF SECTION 7209, SUBDIVISION 2, OF THE NEW YORK STATE EDUCATION LAWS.
- THE INFORMATION DEPICTED HEREON IS BASED UPON AN ACTUAL FIELD SURVEY AND IS AN OPINION BASED UPON SAID SURVEY. VARIATIONS IN OFFSETS FROM THAT OF THE OTHERS CAN AND MAY EXIST.
- ONLY COPIES FROM THE ORIGINAL OF THIS SURVEY MARKED WITH AN ORIGINAL OF THE LAND SURVEYOR'S SEAL SHALL BE CONSIDERED TO BE TRUE VALID COPIES.
- WETLAND FLAGS DELINEATED BY EVANS ASSOCIATES ENVIRONMENTAL CONSULTING, INC. FD FLAGS #1 - #31
WETLAND FLAGS DELINEATED BY TIM MILLER ASSOCIATES INC., ON JULY 29, 2024 FD FLAGS #32 - #41
- THIS MAP WAS PREPARED FROM AN ACTUAL FIELD SURVEY CONDUCTED ON THE DATE SHOWN AND THAT SAID SURVEY WAS PERFORMED IN ACCORDANCE WITH THE EXISTING "CODE OF PRACTICE FOR LAND SURVEYS" ADOPTED BY THE NEW YORK STATE ASSOCIATION OF PROFESSIONAL LAND SURVEYORS.

PREPARED FOR: NORTH EDGE REALTY CORP.

Link
Land Surveyors P.C.
21 Clark Place, Suite 1-B Mahopac N.Y. 10541
Phone 845-628-5857

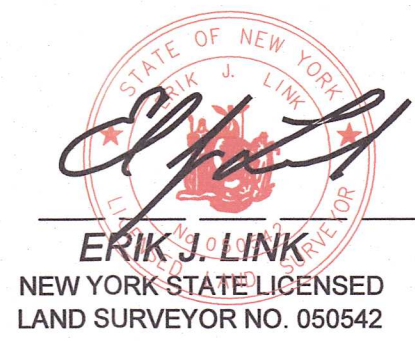

COPYRIGHT 2024
LINK LAND SURVEYOR P.C. ALL RIGHTS RESERVED. THE UNAUTHORIZED REPRODUCTION AND OR DISTRIBUTION OF THIS DOCUMENT IS ILLEGAL, AND IS A VIOLATION UNDER UNITED STATES COPYRIGHT LAWS.

NYSDEC FRESHWATER WETLAND BOUNDARY VALIDATION
The freshwater wetland boundary as represented on these plans accurately depicts the limits of Freshwater Wetlands ML-10 as delineated by SARAH PAWLICZAK on

DEC Staff: Sarah Pawliczak Surveyor / Engineer: ERIK J. LINK

Date: 8/29/24 Expires: 8/29/29

Wetland boundary delineations as validated by the New York State Department of Environmental Conservation remain valid for 5 years unless existing exempt activities, area hydrology, or land use practices change (e.g., agricultural to residential). After 5 years the boundary must be revalidated by DEC staff. Revalidation may include a new delineation and survey of the wetland boundary.

Any proposed construction, grading, filling, excavating, clearing or other regulated activity in the freshwater wetland or within 100 feet of the wetland boundary as depicted on this plan requires a permit from the NYS Department of Environmental Conservation under Article 24 of the Environmental Conservation Law (Freshwater Wetlands Act) prior to commencement of work.

