

# OBD-II Installation Guide



**azūga**<sup>™</sup>  
a Bridgestone Company

# OBD-II INSTALLATION GUIDE

## GETTING STARTED



## METHOD A: USING THE AZUGA FLEETMOBILE APP

1. Log in to the **Azuga FleetMobile app**.
2. Navigate to **Dashboard > Utilities > Installation**.
3. Input the device serial number. This can be done in two ways:
  - a. By scanning the barcode of the device.
  - b. By manually entering the serial number.
4. Tap **Continue** and follow the instructions on the screen to install the device in your vehicle.
5. Enter the vehicle details and tap **Submit**.

**Note:** Note: If you are not around the vehicle, you can proceed by tapping the **Setup without Vehicle** button.

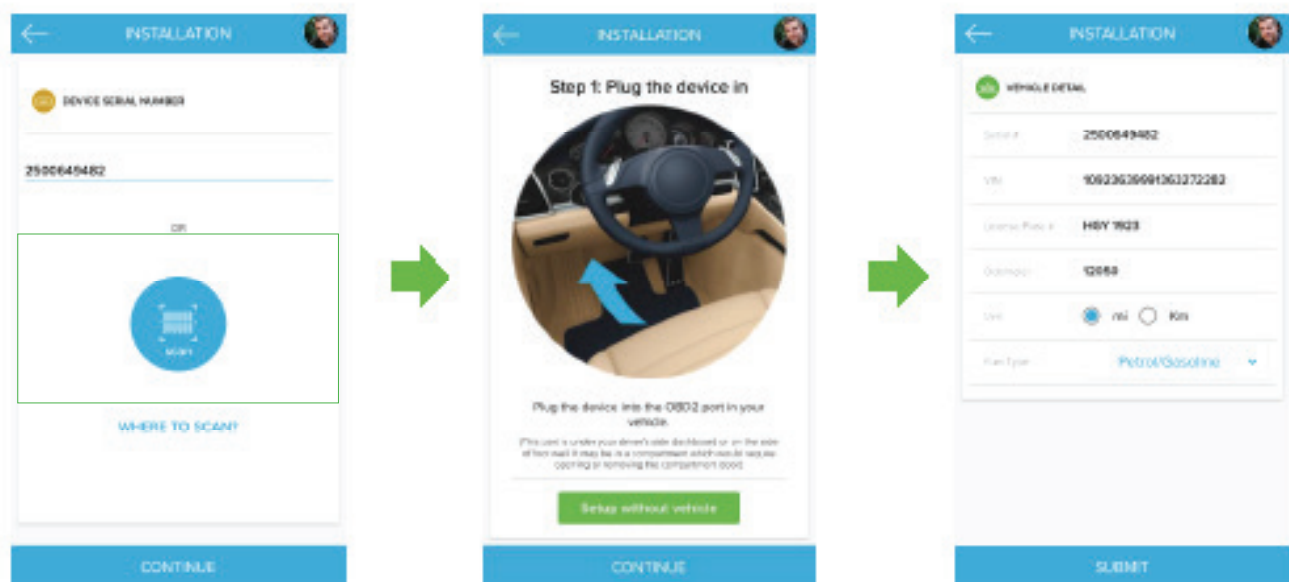

## METHOD B: USING THE AZUGA FLEET WEB APP



1. Look at the device that you received and locate the serial number. The device serial number is a unique 10-digit number.
2. Write this down in the **Serial Number** column in the table below.
3. Identify which vehicle this device will be installed on and give it a 'friendly name'. For example, 'John's F150'. Write this in the **Vehicle Name** column in the table below. Please keep these vehicle names short.

NO.	PLANNED INSTALL DATE	SERIAL NUMBER	VEHICLE NAME

(See Appendix for a single clean sheet with this table which you can print and copy.)

4. The **Planned Install Date** helps you schedule when you plan to have your drivers back in the office for the device installation. Of course, the sooner you install, the sooner you can start saving money and delivering better customer service with Azuga!
5. Repeat this step for all devices that you have with you. Photocopy this page if so that you can complete the process for your entire fleet.
6. Log in to the Azuga Fleet web application and ensure that the vehicle name is accurate. The login URL is <https://apps.azuga.com>. Your login credentials would have been sent to you earlier. Look for an email from do-not-reply@azuga.com in your inbox (check your SPAM folder) to get your username and password.
7. To add or edit vehicles, go to the **Admin > Vehicles page**.
8. Type the serial number of the device you are holding in the search bar. You will notice that the vehicle name is the same as the serial number. Azuga does this by default when the devices are initially tested.
9. Change the vehicle name and give it a 'friendly name' (e.g. 'John's Ford F-150', 'Parts Van'). This name needs to be unique. You cannot have two vehicles with the same name. Also, fill in the mandatory fields (marked with a \*).
10. Click **Update Vehicle** to save the vehicle record.
11. Repeat these steps for the remaining vehicles. Note that the vehicle names need to be unique.

## INSTALLING THE DEVICE



1. Make sure your vehicle is parked outside, with a clear view of the sky to ensure proper GPS location. If your vehicle is parked in a garage or inside a building, you may not be able to get a GPS location reading right away. However, you will start getting GPS once you drive around in open sky conditions.
2. Make sure that your vehicle's ignition is OFF.
3. Locate the OBD-II diagnostic port. The port is typically located below the steering wheel column. Some vehicles have panels which cover the diagnostic port and fuse block. You may have to remove the panel to access the diagnostic port.

**Note:** In some cases, you will need a cable to ensure that the device is not protruding from the panel. Azuga can supply this cable. Please send a note to [orders@azuga.com](mailto:orders@azuga.com) requesting the quantity needed.

4. Plug in the device and wait for a few minutes. All LEDs on the device will blink once.
5. Once the green LED remains solid for 5 seconds, you are all set!  
**Note:** If installation failed, the red LED will blink every 2 seconds.
6. Your vehicle should now be visible on the Azuga Fleet website.  
**Note:** If the device needs to be removed for service or vehicle diagnostic activity, please be sure to reinstall the device.



APPENDIX

NO.	PLANNED INSTALL DATE	SERIAL NUMBER	VEHICLE NAME

# About Bridgestone

Nashville, Tennessee based Bridgestone Americas Tire Operations is the U.S. subsidiary of Bridgestone Corporation, the world's largest tire and rubber company offering a wide range of Bridgestone, Firestone and associate brand tires, BATO maintains wholesale and original equipment sales operations across a broad line of products, including passenger, light truck, commercial truck and bus, agricultural, motorcycle, kart and off-the-road tires.

Additional US subsidiaries include Bridgestone Retail Operations which operates the largest network of company-owned automotive service providers in the world – nearly 2,200 tire and vehicle service centers across the United States – including Firestone Complete Auto Care, Tires Plus, Wheelworks and Hibdon store locations. Bridgestone authorized dealers consist of independent tire retailers that are authorized to sell and service Bridgestone or Firestone products. BATO's Commercial Solutions Group also has an extensive dealer network that also includes Truck, Bus, Radial Division. In summary the Bridgestone network consists of approximately 5,400 service locations for tire, automotive and fleet solutions.

Below is a complete list of links to our products for Commercial, Retreads and Consumer tires.

## Bridgestone Brand

Alenza, Blizzak, DriveGuard, Dueler, Ecopia, Potenza, Turanza  
Bridgestone Consumer product

website: <https://www.bridgestonetire.com/>

Bridgestone Commercial product

website: <https://commercial.bridgestone.com/en-us/index>

## Firestone Brand

All season, Champion, Destination, Firehawk, Transforce, WeatherGrip, Winterforce

Firestone Consumer product

website: <https://www.firestonetire.com/>

Firestone Commercial product

website: <https://commercial.firestone.com/en-us/index>

## Bandag Retread

website: <https://www.bandag.com/en-us/index>

# About Azuga

Azuga, a Bridgestone company, is a leading global connected vehicle platform, helping our customers turn data about vehicles and their use into intelligence that improves operations and safety while reducing costs and risk. Azuga provides reliable end-to-end solutions for commercial fleets, government agencies, insurance companies and automotive industry suppliers, encompassing hardware, the Azuga One platform, award-winning fleet applications and data analytics. Azuga is headquartered in Fremont, California.

Our award-winning Azuga Fleet solution is used by thousands of customers—from the small fleet of one or a few vehicles up to several thousand—and is lauded by our customers for its ease-of-use, robust features and affordable pricing.

## OBD-II Installation Guide

