

# LED Smart Slim Panel Light



**【Brightness & RGBCW Adjustable】** Offer warm white and cool white from 2700K to 6500K. Provide 16 million colors. 1%-100% brightness is adjustable; DIY the scene modes available. **【Voice Control】** Compatible with Alexa and Google Assistant. A simple dialogue can turn LED Recessed Lighting on or off and adjust more colors.

**【APP Intelligent Control】** Download TUYA Smart APP or Smart Life APP to connect and enjoy intelligent control. Only support 2.4 GHz Wi-Fi. ① Make your own schedule to turn off/on recessed light; ② Control recessed lighting in groups; ③ Remotely control the canless led recessed light through the APP; ④ Share other devices to control the led smart recessed lights together; ⑤ With memory function will stay at the last setting you choose while turn on again

**【Music Sync】** The smart recessed lighting can change the color with the beat of the music or the sound of the game.

**【Scheduled On-Off】** Enjoy the benefits of smart living by scheduling your lights to wake you up in the morning, to turn on when you arrive home



Catalog Number	Description	Lumens	Watts	CCT	Voltage
SZ-DL10W4-SP (RGBCW)	LED Slim Panel 4"	700 Lm	10W	Adjustable 2700K - 6500K	120V
SZ-DL15W6-SP (RGBCW)	LED Slim Panel 6"	1050 Lm	15W	Adjustable 2700K - 6500K	120V

## ORDERING GUIDE

Example: SZ-DL10W4-SP (RGBCW)

Company Code	Fixture Type	Wattage	Size	SP	RGBCW
<input type="text"/>	<input type="text"/>	<input type="text"/>	<input type="text"/>	<input type="text"/>	<input type="text"/>
SZ Company Name	DL Downlight Series	10W 15W	4 4" 6 6"	Slim Panel	RGB+2700K-6500K

# LED Smart Slim Panel Light

## Specifications

### CONSTRUCTION

Aluminum housing with spring action clips.

### ELECTRICAL

Drive: AC 120V 60Hz.

### CCT & CRI

RGB + (2700K~6500K)

CRI 80

### Beam Angle

120°

### Operating Temperature

Suitable for use in -20° C to 45° C (-4° F to 113° F).

### Efficacy

70 lumens per watt.

### DIMMING

Triac dimmable.

### Certifications

UL Listed.

### WARRANTY

5 Years Limited Warranty.

Color: Warm White+Cold White  
Brightness can be adjusted from 1% to 100%.



Color: RGB  
Brightness can be adjusted from 1% to 100%.



Control the light in groups.



Timer function, setting lights on/off automatically.



Work with Amazon Alexa / Google Home.

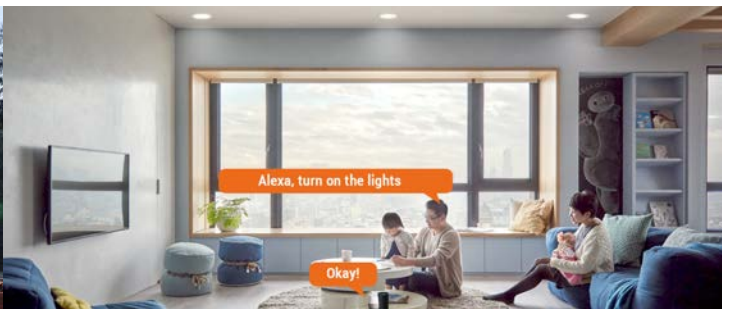

Multi preset scene modes and DIY scenes to fits any occasions.

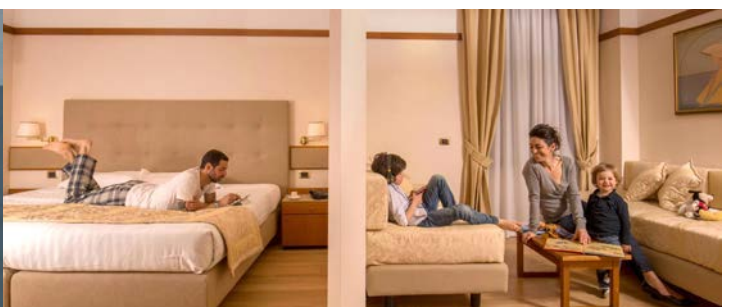

# LED Smart Slim Panel Light

## DIMENSIONS (unit: inch)

### 4inch

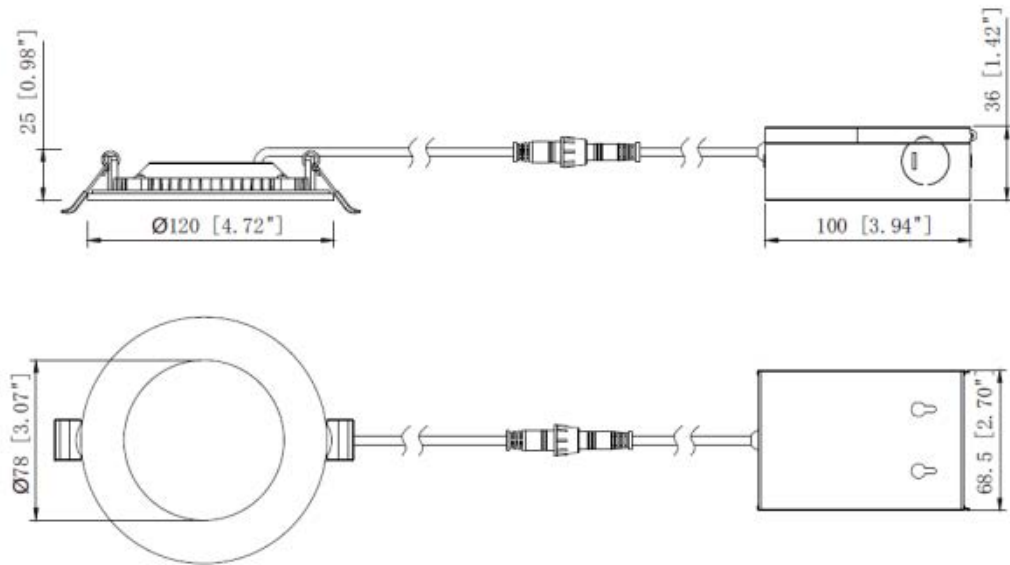

### 6inch

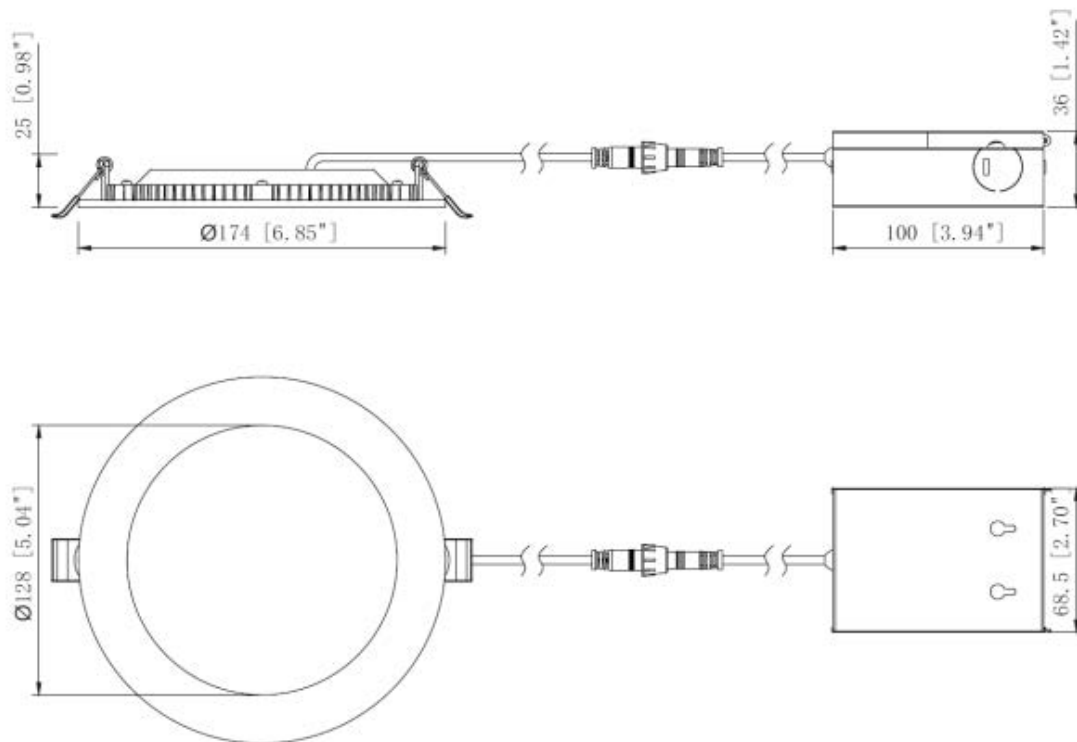

## Packing/Weight:

Model	Outer box (L*W*H)	Qty/CTN (pcs)	N.W./pcs (lbs/kg)	G.W./CTN (lbs/kg)	Remark
SZ-DL10W4-SP (RGBCW)	16.5"* 10.5"*11" 420*265*280mm	24	13.4/6.1	17.6/8	
SZ-DL15W6-SP (RGBCW)	16.5"*14.6"*15.2" 420*370*385mm	24	19.1/8.7	24.3/11	

# LED Smart Slim Panel Light

## INSTALLATION INSTRUCTIONS

1. Turn power OFF from the electrical panel prior to installation.
2. Determine the location for installation and cut ceiling hole in accordance with cut-hole dimensions. Refer to hole diameter table for appropriate sizes.(Fig.1)
3. Remove the appropriate knlckouts on the side panel.(Fig.2)
4. Insert the electrical supply cable through the knockout and secure with a cable connector (sold separately).
5. Using quick-connect push-in terminals,connect the ground wire tothe green wire terminal; black wire to black wire terminal; white wire to white wire terminal.(Fig.2)
6. Place all wiring and connections back in to the box and close the cover. Connect the driver to the light panel.
7. Insert junction box through the mounting hole.(Fig.3)
8. Push spring-loaded clips on the fixture upwards and insert fixture base in to the mounting hole. Release the clips and fixture will be pulled flush to the ceiling.(Fig.4)

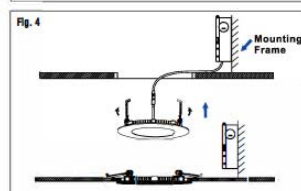
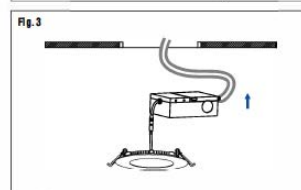
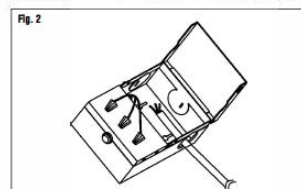

## How to Connect:

1. Download the "Tuya Smart" or "Smart Life" from Apple Store or Google Store, register an account and log in.
2. Turn on WiFi on your phone.
3. Click "+" in the upper light corner-Lighting-Lighting Source Bluetooth+Wifi
4. Switch the ON/Off for 3 times continuously. IF light flashes, can start the connection.
5. Click "confirm light blinks rapidly"on the APP and then input the correct Wifi Password (2.4Ghz WiFi ).
6. Within 30 seconds, it will be connected. Start to enjoy the scene.

# LED Smart Slim Panel Light

## Install the APP:For example "Smart Life" APP

Download the "Smart Life" APP to connect and enjoy intelligent control.  
NOTE: Only support 2.4 GHz Wi-Fi.

- 1.Search for Smart Life in Apple's App store and other major App stores or scan the following QR code to download the Smart Life App.
- 2."Sign Up" to create an account.

Sign up the APP, enter your mobile phone number or email address.  
Note:Please select your region and country.

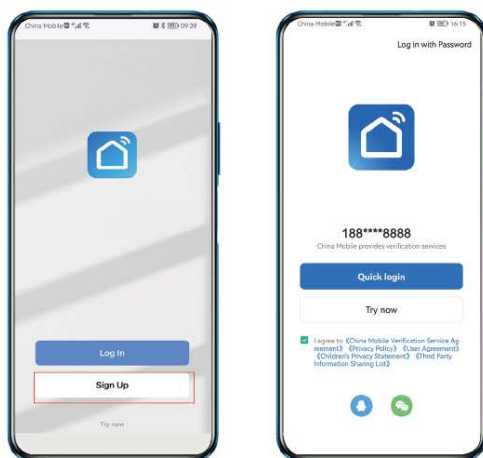

Turn on mobile phone WiFi, bluetooth

NOTE: Only support 2.4 GHz Wi-Fi.

Switch on and off 10 times on the wall switch, enter standby mode, make sure light rapidly flashing white .

### 3.Connect devices

#### STEP1

- Open the Smart Life. In the top corner of the screen, click "+" and "Add Device".

#### STEP2

- Choose "Add".

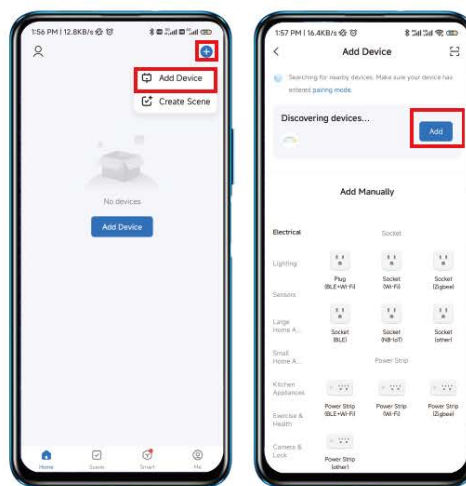

#### STEP3

- Enter your WIFI network and password, press "Next" in the App.

#### STEP4

- Click "+" in front of the fixture .

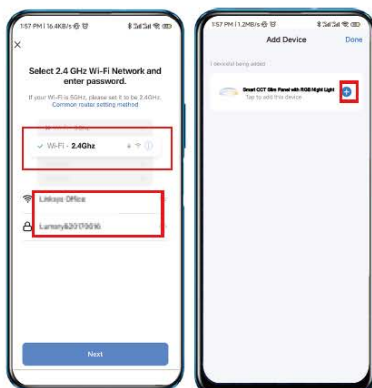

#### STEP5

- "v" in front of the fixture stand for successfully connected and click done.

#### STEP6

- Enter the setting status of single fixture. Optional scene mode. The main light and auxiliary light can be selected for brightness. Segment dimming and do-not-disturb mode can be setted. Click "Z" in the top right to enter the setup interface.

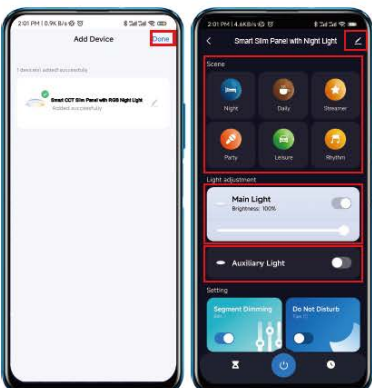

#### STEP7

- Choose "Create Group"

#### STEP8

- Click "+" in front of the fixture to your "Create Group" and save.

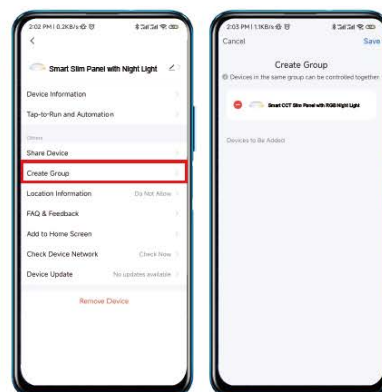

#### STEP9

- Named "Create Group" and "save."

#### STEP10

- Click "Group" to enter.

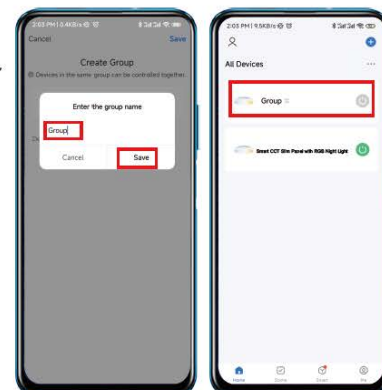

# LED Smart Slim Panel Light

## STEP11

- Choose the scene, light adjustment and setting of group

## STEP12

- Click "Create Scene"

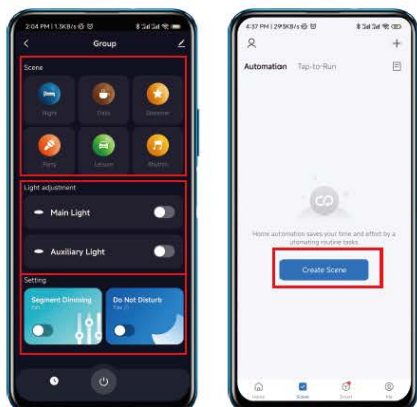

## STEP13

- Choose "Schedule", enter the timing interface.

## STEP14

- Set the ON-OFF time of fixture for your demand.

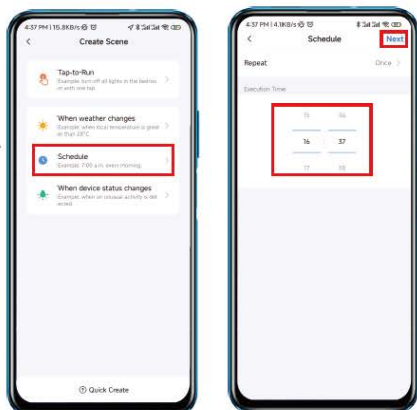

## STEP14

- Choose time and group. Click "Save"

## STEP15

- Slide switch to open or close the Automation.

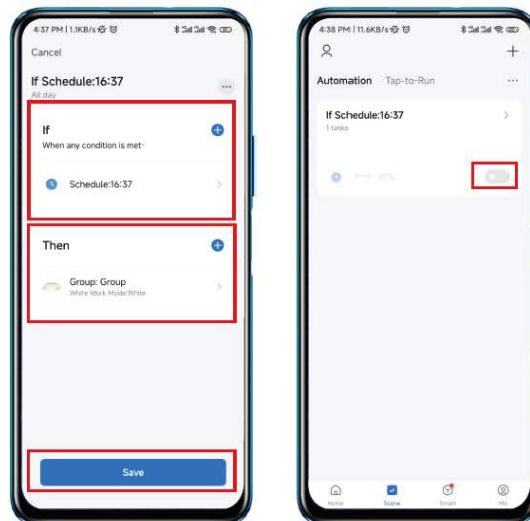

## Warm Tips:

Above connection instruction based on the basic version.

It may vary if APP version update.

Please follow up the actual version guideline.