

# LED Commercial Downlight



The Wattage Adjustable and Color Tunable LED Recessed Down Lights are the perfect canless alternative to traditional recessed lighting. No need to worry about purchasing separate recessed housings, trims, and bulbs as this product combines everything into one easy-to-install recessed down light. It cuts installation time by up to 50% vs traditional recessed lighting, saves up to 60% in energy use, and saves in routine maintenance of not needing to change bulbs. These commercial LED down lights are IC rated (safe for insulation contact) to maximize energy savings. These commercial LED down lights are great options for commercial settings such as offices, retailers, airports, hotels, schools, and more. They are also great options for residential settings in kitchens, living rooms, bedrooms, bathrooms, utility rooms, basements, and more.



Catalog Number	Description	Lumens	Watts	CCT	Voltage
SZ-DL16W4-CD-ACP (02)	LED Commercial 4"	1760 Lm	Adjustable 8W/10W/14W/16W	Adjustable 2700K - 5000K	120V - 277V
SZ-DL30W6-CD-ACP (02)	LED Commercial 6"	3300 Lm	Adjustable 15W/18W/22./26W/30W	Adjustable 2700K - 5000K	120V - 277V Optional 120-347V
SZ-DL35W8-CD-ACP (02)	LED Commercial 8"	4200 Lm	Adjustable 15W/20W/25W/30W/35W	Adjustable 2700K - 5000K	120V - 277V Optional 120-347V
SZ-DL40W10-CD-ACP (02)	LED Commercial 10"	4800 Lm	Adjustable 20W/25W/30W/35W/40W	Adjustable 2700K - 5000K	120V - 277V Optional 120-347V

## ORDERING GUIDE

Example: SZ-DL30W6-CD-ACP (02)

Company Code	Fixture Type	Wattage	Size	Voltage	CD	ACP
SZ Company Name	DL Downlight Series	16W 30W 35W 40W	4 4" 6 6" 8 8" 10 10"	Blank 120-277V	CD Commercial Downlight	ACP Adjustable CCT and Power 16W: 8/10/14/16W 2700K/3000K/3500K/4000K/5000K 30W: 15/18/22/26/30W 2700K/3000K/3500K/4000K/5000K 35W: 15/20/25/30/35W 2700K/3000K/3500K/4000K/5000K 40W: 20/25/30/35/40W 2700K/3000K/3500K/4000K/5000K

# LED Commercial Downlight

## Specifications

### CONSTRUCTION

Aluminum housing with spring action clips.

### ELECTRICAL

Drive: AC 120-277VAC, Optional 120-347V.50/60Hz.

### CCT & CRI

2700K, 3000K, 3500K, 4000K, 5000K

Field Selectable CCT

CRI 80

### Operating Temperature

Suitable for use in -20° C to 45° C (-4° F to 113° F).

### Efficacy

110-120 lumens per watt.

### DIMMING

0-10V, Triac, ELV, dimmable.

### Certifications

ETL Listed, FCC, ES.

### WARRANTY

5 Years Limited Warranty.

## DIMENSIONS (unit: inch)

4"-16W  
Cutout: 3 13/16" (Ø96mm)

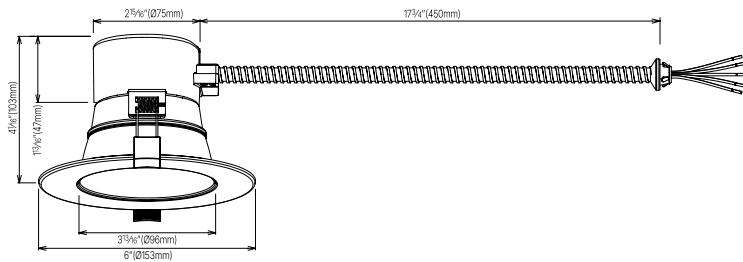

6"-30W  
Cutout: 5 5/16" (Ø151mm)

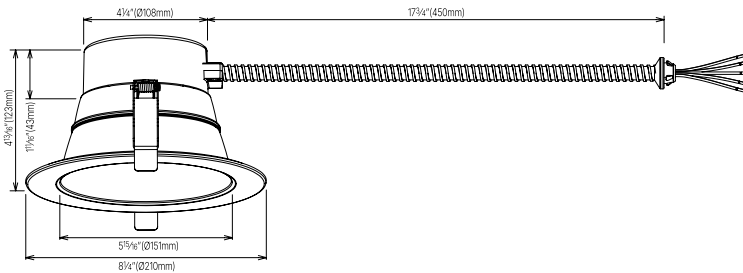

8"-35W  
Cutout: 7 3/4" (Ø197mm)

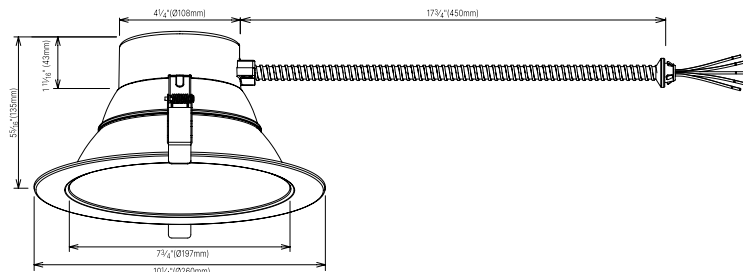

10"-40W  
Cutout: 8 3/4" (Ø223mm)

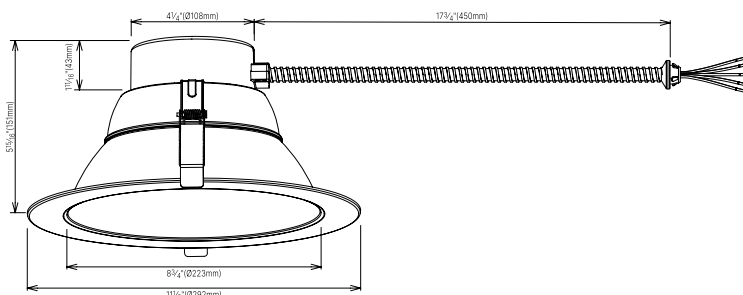

# LED Commercial Downlight

## Packing/Weight :

Catalog Number	Outer box (L*W*H)	Qty/CTN (pcs)	N.W./CTN (lbs/kg)	G.W./CTN (lbs/kg)	Remark
SZ-DL16W4-CD-ACP (02)	20.87*13.98*14.57" 530*360*370mm	18	16.94/7.7	23.98/10.9	
SZ-DL30W6-CD-ACP (02)	18.5*18.31*18.7" 470*470*480mm	12	15.62/7.1	23.1/10.5	
SZ-DL35W8-CD-ACP (02)	22.83*22.64*18.7" 580*580*480mm	12	17.6/8	28.16/12.8	
SZ-DL40W10-CD-ACP (02)	25*12.81*20.5" 635*326*520mm	6	9.13/4.15	16.58/7.6	

## Dimming Compatible Controls

### COMPATIBLE DIMMERS

NO.	Brands	Model NO.	Interface
1	Lutron	CTCL-153P	Triac
2	Lutron	MACL-153MR	Triac
3	Lutron	DVCL-153P	Triac
4	Insteon	2477DH	ELV
5	Lutron	SCL-153P	Triac
6	Leviton	6672	Triac
7	Lutron	DVWCL-153PH-WH	Triac
8	Leviton	R12-06672-1LW	Triac
9	Lutron	NLV-600-WH	MLV
10	Lutron	DVSELV-300P-BI	ELV
11	Lutron	MACL-153MR	Triac
12	Lutron	DVSTV-IV	0-10V
13	Leviton	IP710-DLZ(IP710)	0-10V
14	Lutron	NTSTV0DV	0-10V
15	Lutron	DVTV-WH	0-10V
16	Leviton	DS710	0-10V

# LED Commercial Downlight

## INSTALLATION INSTRUCTIONS

### Important Safety Instructions:

Basic safety precautions should always be followed when installing, including the following:

1. Read all instructions.
2. Licensed electrician for installation only.
3. Always ensure the power is OFF and the fitting has cooled down before performing any maintenance, cleaning, or adjustment to the fitting.
4. Do not install any luminaire near the heat source.
5. Do not exceed the nominal supply voltage or amperage ratings.
6. To avoid injury or damage to the fitting, please ensure that power leads and screws are secure before connecting the power.

### WARNING

1. Switch off before installation.
2. Switch on only after complete installation and examination of the circuit.
3. Professional electrician for installation and maintenance only.



**Turn Off  
Power Supply**

Turn Off power supply before starting any installation. Read instructions & check you have all the tools & accessories to complete the installation correctly.

#### Step 1

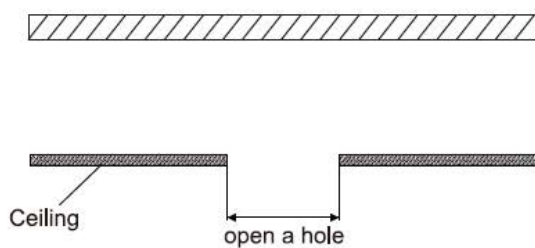

The height of the fixture should be no less than 100mm

Opening a hole in ceiling according to cutout size of the lamp

#### Step 2

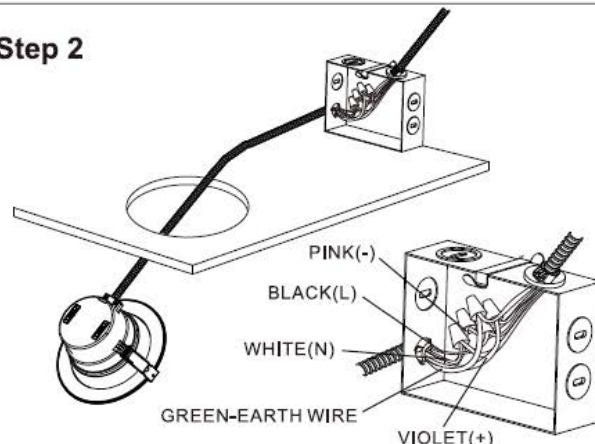

Connect AC and Dimming wires correspondingly as shown in picture

#### Step 3

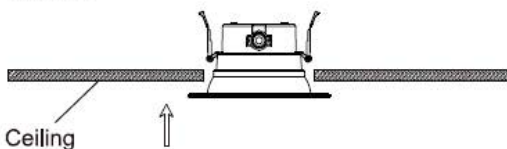

Bend back the spring clips then push the lamp into the hole.

#### Step 4

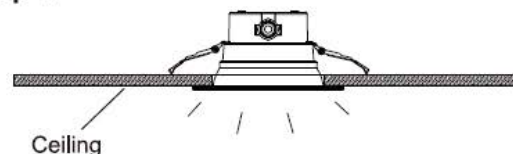

Installation completed. Switch on.

