

# MAX-8

V2604.01



**Let's grow together**

# MAX-8

Excellent Performances & Reliability

## CPCD50-100T8

T8 Diesel Forklift 5.0/6.0/7.0/8.0/10.0t

**SINGAPORE DEALER:**

DYNASTY LIFT TRUCKS SERVICES PTE LTD

92 Tagore Lane, Singapore 787534

Tel : +65 6556 1860 Whatsapp : +65 8112 0200

Email : sales@dynastyforklift.com. www.dynastyforklift.com

# CPCD50/60/70T8

T8 series 5.0-7.0t forklift specification:

General		EP												
		CPCD50T8	CPCD60T8	CPCD70T8	CPCD50T8	CPCD60T8	CPCD70T8	CPCD50T8	CPCD60T8	CPCD70T8	CPCD50T8	CPCD60T8	CPCD70T8	
1	Manufacture													
2	Model													
3	Power type	Diesel												
4	Rated capacity	Kg	5000	6000	7000	5000	6000	7000	5000	6000	7000	5000	6000	7000
5	Load center	mm	600											
6	Lift height	mm	3000											
7	Free lift height	mm	130											
8	Fork size	L×W×T	1220×150×55   1220×150×60   1220×150×65   1220×150×65   1220×150×65   1220×150×65   1220×150×65   1220×150×65   1220×150×65   1220×150×65   1220×150×65   1220×150×65   1220×150×65											
9	Mast tilt range	F/R	6/12											
10	Fork overhang(wheel center to fork face)	mm	635											
11	Rear overhang	mm	700	810	770	700	770	770	770	770	770	700	770	770
12	Length to face of fork	mm	3480	3590	3590	3480	3590	3590	3480	3590	3590	3480	3590	3590
13	Overall width	mm	1995											
14	Mast lowered height	mm	2510											
15	Mast extended height	mm	4429											
16	Overhead guard height	mm	2430											
17	Turning radius(outside)	mm	3330	3480	3480	3330	3480	3480	3480	3480	3480	3330	3480	3480
18	Minimum rectangular aisle width.	mm	4068	4218	4218	4068	4218	4218	4218	4218	4218	4068	4218	4218
19	Speed	Km/h	26											
20	Travel (No load)	mm/sec	500/330											
21	Lifting (Full load)	mm/sec	500/340											
22	Max.Drawbar Pull (Full load)	N	42000	42000	52000	42000	42000	52000	42000	42000	52000	42000	42000	52000
23	Max Gradeability (Full load)	%	20											
24	Tyres	mm	4×8.25-15-14											
25		mm	2×8.25-15-14											
26	Tread	mm	1470											
27		mm	1700											
28	Wheelbase	mm	2250											
29	Ground clearance	mm	200/160											
30	Mast (No/Full load)		240/200											
31	Self weight	Kg	8000	8650	9050	8000	8650	9050	8650	9050	8650	8000	8650	9050
32	Full load		10660	12452	13642	10660	12452	13642	10660	12452	13642	10660	12452	13642
33	Rear		2340	2198	2028	2340	2198	2028	2340	2198	2028	2340	2198	2028
34	Front		2800	3028	3168	2800	3028	3168	2800	3028	3168	2800	3028	3168
35	Rear		5200	5622	5882	5200	5622	5882	5200	5622	5882	5200	5622	5882
36	Battery	V/AH	24/80											
37	Modal		S6S-T	QSF3-8			6BG332					6BG1		
38	Manufacture		Mitsubishi	Cummins			CY					ISUZU		
39	Rated output/r.p.m	kw	63.9/2300	86/2200			85/2200					82.3/2000		
40	Rated torque/r.p.m	N.m	285/1700	470/1320			450/1400-1800					416/1400-1600		
41	No.of cylinder		6	4			6					6		
42	Bore×Stroke	mm	94×120	102×115			102×118					105/125		
43	Displacement	cc	4996	3757			5785					6494		
44	Fuel tank capacity	L	140	140			140					140		
45	Manufacture		OEM											
46	Type		Powershift											
47	Stage		2/2											
48	Operating pressure	Mpa	19											

1.Special lifting height available for further information please contact us. 2.Attachment available.

3.The specification in the table are for standard models only. For further information please contact us.

4.Specification are subject to change without notice.

# CPCD80/100T8

T8 series 8.0-10.0t forklift specification:

General		CPCD80T8	CPCD100T8	CPCD80T8	CPCD100T8	CPCD80T8	CPCD100T8	
1	Manufacture						EP	
2	Model							
3	Power type						Diesel	
4	Rated capacity	8000	10000	8000	10000	8000	10000	
5	Load center						600	
6	Lift height						3000	
7	Free lift height						200	
8	Fork size	L×W×T	1520×160×80	1520×160×75	1520×160×80	1520×160×75	1520×160×80	
9	Mast tilt range	F/R					6/12	
10	Fork overhang(wheel center to fork face)						728	
11	Rear overhang		700	680	700	680	700	
12	Length to face of fork		4250	3950	4250	3950	4250	
13	Overall width						2245	
14	Mast lowered height						2850	
15	Mast extended height						4420	
16	Overhead guard height						2560	
17	Turning radius(outside)		4050	3700	4050	3700	4050	
18	Minimum rectangular aisle width.		4950	4580	4950	4580	4950	
19	Speed	Travel (No load)					25	
20	Max. Drawbar Pull (Full load)	Lifting (Full load)	390/340	480/350	390/340	480/350	390/340	
21	Max. Gradeability (Full load)		61000	58000	61000	58000	61000	
22								
23								
24	Tyres	Front	4x900-20-14PR					
25		Rear	2x900-20-14PR					
26	Tread	Front	1600					
27		Rear	1700					
28	Wheelbase		2800	2500	2800	2500	2800	
29	Ground clearance	Mast (No/Full load)	240/190					
30		Frame (No/Full load)	350/340					
31	Self weight		12900	11050	12900	11050	12900	
32		Front	17200	17200	20900	17200	20900	
33		Rear	1850	1850	1960	1850	1960	
34	Weight Distribution	Front	4900	4900	6260	4900	6260	
35		Rear	6150	6150	6640	6150	6640	
36	Battery	Voltage/Capacity	24/80					
37	Modal	6BG332	OSF3-8					6BG1
38	Manufacture	CHAO CHAI	Cummins					ISUZU
39	Rated output/r.p.m	85/2200	86/2200					82.3/2000
40	Rated torque/r.p.m	450/1400-1800	470/1320					416/1400-1600
41	Engine	No of cylinder	6	4				6
42		Bore×Stroke	102×118	102×115				105/125
43		Displacement	5785	3757				6494
44		Fuel tank capacity	160	160				160
45		Manufacture	OEM					
46	Transmissions	Type	Powershift					
47		Stage	2/2					
48	Operating pressure		20.5					

1.Special lifting height available for further information please contact us. 2.Attachment available.

3.The specification in the table are for standard models only. For further information please contact us.

4.Specification are subject to change without notice.

**5.0/6.0/7.0t T8 series mast: (pneumatic)**

Type	Model	Max. fork height	Overall height			Free lift		Front Overhang	Tilt range		Capacity		
			Lowered	Extended		Without backrest	With backrest		FWD	BWD	Load capacity at 600 mm		
				Without backrest	With backrest						5.0t	6.0t	7.0t
			mm	mm	mm	mm	mm		mm	mm	Deg	Deg	kg
Wide view mast	2W300	3000	2510	4000	4430	130	130	635	6	12	5000	6000	7000
	2W330	3300	2660	4200	4730	130	130	635	6	12			
	2W350	3500	2760	4500	4930	130	130	635	6	12			
	2W400	4000	3020	5000	5430	130	130	635	6	12			
	2W450	4500	3310	5500	5930	130	130	635	6	6			
	2W500	5000	3560	6000	6430	130	130	635	6	6	4800	5800	6800
2W550	5500	3860	6500	6930	130	130	635	6	6	4500	5500	6400	
Wide view full 2-stage mast	2F300	3000	2480	4000	4430	1545	1090	635	6	12	5000	6000	—
	2F330	3300	2630	4300	4730	1695	1240	635	6	12			
	2F350	3500	2730	4500	4930	1795	1340	635	6	12			
	2F400	4000	3030	5000	5430	2095	1640	635	6	12			
Wide view full 3-stage mast	3F450	4500	2650	5455	5850	1670	1285	680	6	6	4500	5500	6500
	3F480	4800	2765	5755	6150	1785	1390	680	6	6			
	3F500	5000	2830	5955	6350	1850	1455	680	3	6			
	3F540	5400	2965	6455	6850	1985	1590	680	3	6	4200	5200	5500
	3F600	6000	3165	6955	7350	2185	1790	680	3	6	4000	5000	5300

**8.0/10.0t T8 series mast: (pneumatic)**

Type	Model	Max. fork height	Overall height			Free lift		Front Overhang		Tilt range		Capacity		
			Lowered	Extended	With backrest	Without backrest	With backrest	8.0t	10.0t	FWD	BWD	Load capacity at 600 mm		
												mm	mm	mm
			mm	mm	mm	mm	mm	mm	mm	mm	Deg	Deg	kg	kg
Wide view mast	2W300	3000	2920	4470	210	210	728	728	6	12	8000	10000		
	2W330	3300	3070	4770	210	210	728	728	6	12				
	2W350	3500	3170	4970	210	210	728	728	6	12				
	2W400	4000	3470	5470	210	210	728	728	6	12				
	2W450	4500	3720	5970	210	210	728	728	6	12				
	2W500	5000	3970	6470	210	210	728	728	6	6	7200	8500		
2W550	5500	4270	6970	210	210	728	728	6	6	7200	8500			
Wide view full 3-stage mast	3F450	4500	2900	6010	1380	1380	768	768	6	6	7200	7800		
	3F480	4800	3000	6310	1480	1480	768	768	6	6	7000	7650		
	3F500	5000	3065	6510	1545	1545	768	768	6	6	6300	7500		
	3F540	5400	3255	6910	1735	1735	768	768	3	6	6500	7200		
	3F600	6000	3455	7510	1935	1935	768	768	3	6	6000	6000		

RATED CAPACITIES AND LOAD CENTERS GRAPH

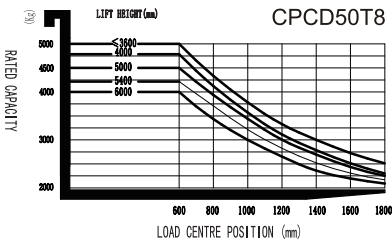

RATED CAPACITIES AND LOAD CENTERS GRAPH

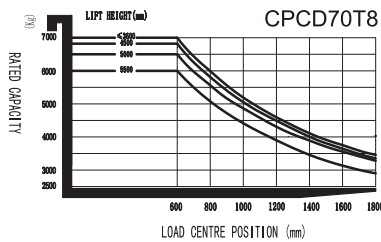

RATED CAPACITIES AND LOAD CENTERS GRAPH

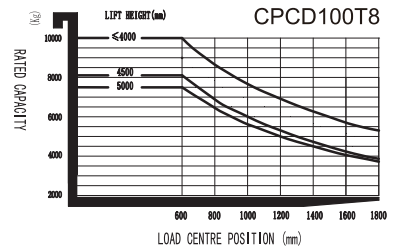

RATED CAPACITIES AND LOAD CENTERS GRAPH

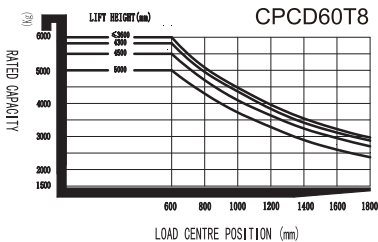

RATED CAPACITIES AND LOAD CENTERS GRAPH

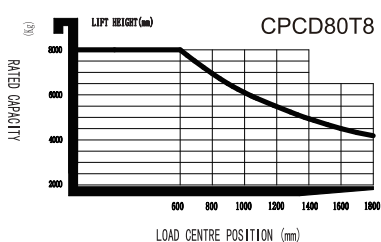

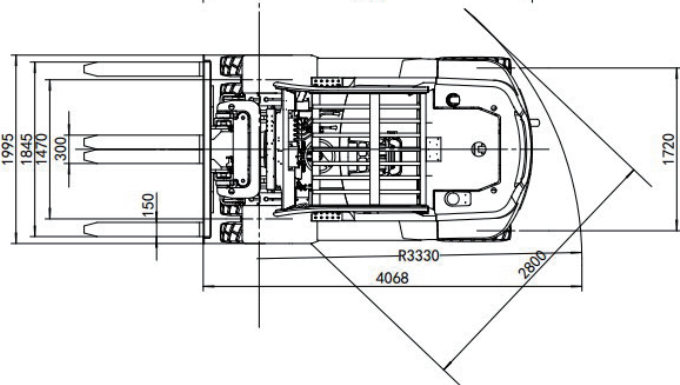
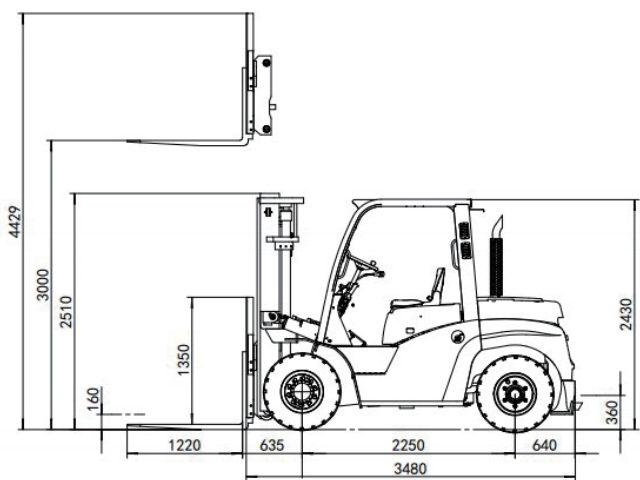

CPCD50T8

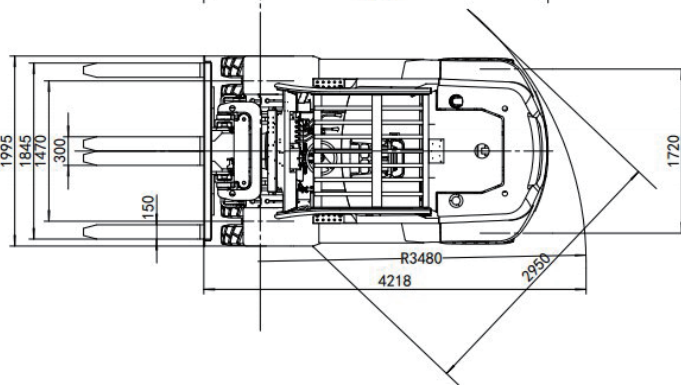
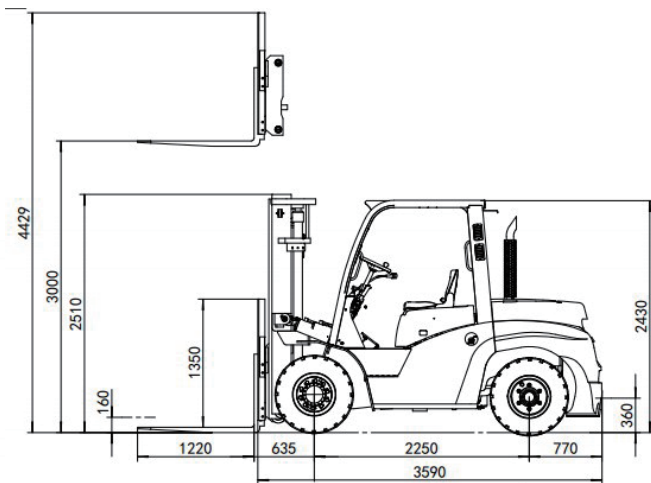

CPCD70T8

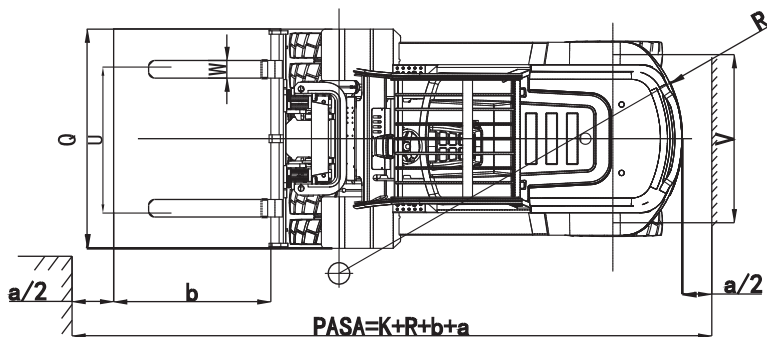
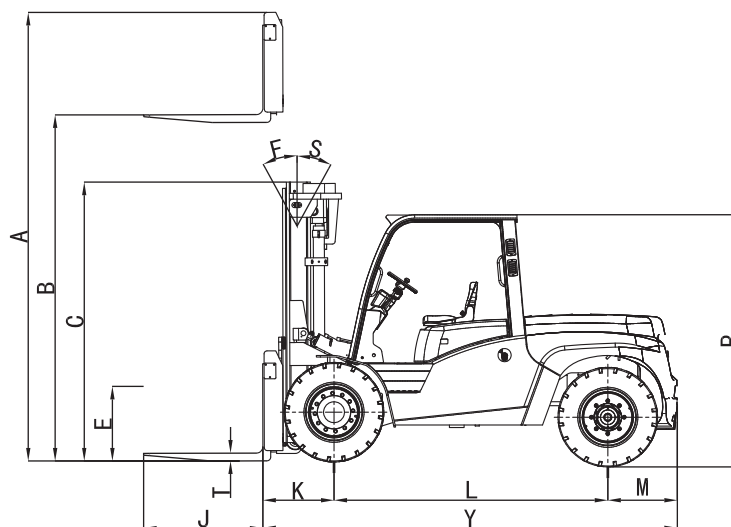

CPCD80-100T8

# Option

Options	CPCD50T8	CPCD60T8	CPCD70T8	CPCD80T8	CPCD100T8
1 Other dimension forks	○	○	○	○	○
2 Fork Extension	○	○	○	○	○
3 Folding fork	○	○	○	○	○
4 Fork positioner	○	○	○	○	○
5 Imported engine	○	○	○	○	○
6 High-mounted Exhaust system	○	○	○	○	○
7 Dual air cleaner	○	○	○	○	○
8 Solid tyre	○	○	○	○	○
9 No-mark tyre	○	○	○	○	○
10 Special height overhead guard	○	○	○	○	○
11 Overhead guard rainproof hood	●	●	●	●	●
12 Different lifting height masts	○	○	○	○	○
13 Attachment	○	○	○	○	○
14 Cabin	○	○	○	○	○
15 Heater	○	○	○	○	○
16 Front window with wiper	○	○	○	○	○
17 Rear window with wiper	○	○	○	○	○
18 Cabin without side doors	●	●	●	●	●
19 LED Front working light	●	●	●	●	●
20 LED rear working light	○	○	○	○	○
21 Fire extinguisher	○	○	○	○	○
22 Luxury Seat(full suspension)	○	○	○	○	○
23 Seat switch	●	●	●	●	●
24 Warning light under engine cover	○	○	○	○	○
25 Insulation mat	○	○	○	○	○
26 OPS system	○	○	○	○	○
27 Special carriage and backrest	○	○	○	○	○
28 FAN	○	○	○	○	○

Note: ● standard ○ option — NA

**T8 series 5.0-7.0t forklift**



**T8 series 8.0-10.0t forklift**

