



EFL181

4-WHEEL LI-ION COUNTERBALANCE FORKLIFT 1.8T

1800 kg 4800 mm 48 V Li-Ion



Ideal for building sites and small companies with intermittent forklift needs. Perfect for short-term rental due to its maintenance-free Li-Ion battery and integrated charger, ensuring it's always ready for use. Ideal for navigating in tight spaces due to compact size and short wheelbase.

| SPECIFICATION | REF | UNIT | VALUE |
|-----------------------------|-----------|------|------------|
| Battery type | | | Li-Ion |
| Battery nominal capacity K5 | | Ah | 150 |
| Battery voltage | | V | 48 |
| Rated capacity | Q | kg | 1800 |
| Load centre distance | c | mm | 500 |
| Service weight | | kg | 3030 |
| Height, mast lowered | h_1 | mm | 1995 |
| Lift | h_3 | mm | 3000 |
| Height, mast extended | h_4 | mm | 4028 |
| Overall length | l_1 | mm | 2935 |
| Overall width | b_1/b_2 | mm | 1080 |
| Length to face of forks | l_2 | mm | 2015 |
| Fork dimensions | s/e/l | mm | 40×100×920 |
| Turning radius | W_a | mm | 1920 |
| Manufacturer | | | EP |
| Model designation | | | EFL181 |

SINGAPORE DEALER:
DYNASTY LIFT TRUCKS SERVICES PTE LTD
92 Tagore Lane, Singapore 787534
Tel : +65 6556 1860 Whatsapp : +65 8112 0200
Email : sales@dynastyforklift.com. www.dynastyforklift.com

Features

Plug&Play on-board charging

The integrated single-phase 48V charger enables effortless opportunity charging from any standard power outlet. This eliminates the need for external chargers or dedicated charging areas, ensuring uninterrupted workflow and maximum uptime



Compact and versatile design

Despite its compact frame, the EFL181 offers increased legroom for improved operator ergonomics. The small turning radius of 1,920 mm and narrow overall width of 1,080 mm make it ideal for tight spaces and mixed indoor-outdoor operations.

Durable and reliable construction

Built on a proven IC chassis and equipped with 10-year market-tested components, the EFL181 ensures stability and long-term reliability. The high ground clearance and solid rubber tires provide dependable performance even on uneven or wet surfaces.



Efficient Li-ion performance

The maintenance-free 48V/150Ah Li-ion battery system delivers consistent power output with fast recharging capability. The combination of 6 kW traction and 7.5 kW lift motors offers smooth acceleration, responsive handling, and excellent lifting efficiency

VDI Chart

| | SPECIFICATION | REF | UNIT | VALUE |
|------|---|--------------------------------|------|--------------|
| 1.1 | Manufacturer | | | EP |
| 1.2 | Model designation | | | EFL181 |
| 1.3 | Drive | | | Electric |
| 1.4 | Operator type | | | Seated |
| 1.5 | Rated capacity | Q | kg | 1800 |
| 1.6 | Load centre distance | c | mm | 500 |
| 1.8 | Load distance, centre of drive axle to fork | x | mm | 405 |
| 1.9 | Wheelbase | y | mm | 1260 |
| 2.1 | Service weight | | kg | 3030 |
| 2.2 | Axle loading, laden front/rear | | kg | 4395/435 |
| 2.3 | Axle loading, unladen front/rear | | kg | 1300/1730 |
| 3.1 | Tyres | | | Solid rubber |
| 3.2 | Tyre size, front | | mm | 6.5-10 |
| 3.3 | Tyre size, rear | | mm | 5.00-8 |
| 3.5 | Wheels, number front/rear (x=drive wheels) | | | 2x/ 2 |
| 3.6 | Tread width, front | b ₁₀ | mm | 905 |
| 3.7 | Tread width, rear | b ₁₁ | mm | 920 |
| 4.1 | Tilt of mast/fork carriage forward/backward | | ° | 6/10 |
| 4.2 | Height, mast lowered | h ₁ | mm | 1995 |
| 4.3 | Free lift | h ₂ | mm | 130 |
| 4.4 | Lift | h ₃ | mm | 3000 |
| 4.5 | Height, mast extended | h ₄ | mm | 4028 |
| 4.7 | Height of overhead guard (cabin) | h ₆ | mm | 2080 |
| 4.8 | Seat height relating to SIP/stand height | h ₇ | mm | 1060 |
| 4.12 | Coupling height | h ₁₀ | mm | 370 |
| 4.19 | Overall length | l ₁ | mm | 2935 |
| 4.20 | Length to face of forks | l ₂ | mm | 2015 |
| 4.21 | Overall width | b ₁ /b ₂ | mm | 1080 |
| 4.22 | Fork dimensions | s/e/l | mm | 40×100×920 |
| 4.23 | Fork carriage ISO 2328, class/type A, B | | | 2A |
| 4.24 | Fork carriage width | | mm | 1040 |
| 4.31 | Ground clearance, laden, below mast | | mm | 115 |

| SPECIFICATION | | REF | UNIT | VALUE |
|---------------|---|----------------|-------|------------|
| 4.32 | Ground clearance, centre of wheelbase | m ₂ | mm | 120 |
| 4.34.1 | Aisle width for pallets 1000×1200 crossways | Ast | mm | 3525 |
| 4.34.2 | Aisle width for pallets 800 × 1200 lengthways | Ast | mm | 3725 |
| 4.35 | Turning radius | Wa | mm | 1920 |
| 5.1 | Travel speed, laden/unladen | | km/h | 8.5/9 |
| 5.2 | Lift speed, laden/unladen | | m/s | 0.25/ 0.3 |
| 5.3 | Lowering speed, laden/unladen | | m/s | 0.43/ 0.45 |
| 5.8 | Max. gradeability, laden/unladen | | % | 10.5/15 |
| 5.10 | Service brake | | | Hydraulic |
| 5.11 | Parking brake | | | Mechanical |
| 6.1 | Drive motor rating S2 60 min | | kW | 6 |
| 6.2 | Lift motor rating at S3 15% | | kW | 7.5 |
| 6.4 | Battery nominal capacity K5 | | Ah | 150 |
| 6.4 | Battery voltage | | V | 48 |
| 6.4.1 | Battery type | | | Li-Ion |
| 6.5 | Battery weight | | kg | 115 |
| 6.6 | Energy consumption according to DIN EN 16796 | | kWh/h | 3.88 |
| 6.7 | Turnover output according to VDI 2198 | | | 82.8 |
| 6.8 | Turnover efficiency according to VDI 2198 | | | 21.34 |
| 8.1 | Type of drive unit | | | AC |
| 10.1 | Operating pressure for attachments | | bar | 180 |
| 10.2 | Oil volume for attachments | | ℓ/min | 25 |
| 10.5 | Steering design | | | Hydraulic |
| 10.7 | Sound pressure level at the driver's seat | | dB(A) | 70 |

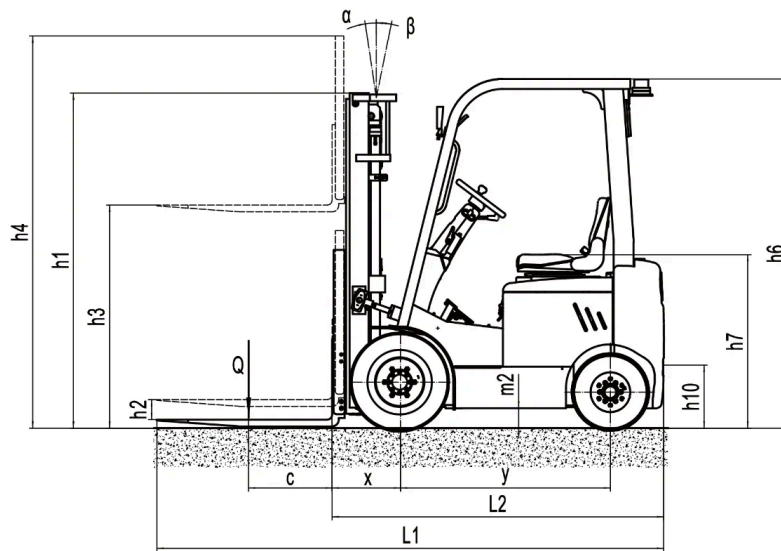
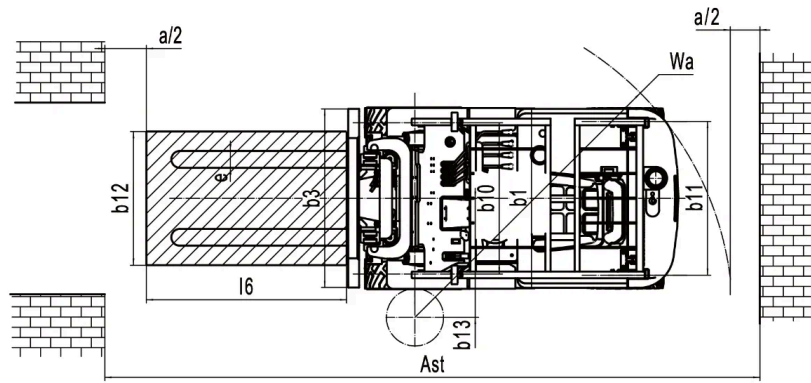

RATED CAPACITIES AND LOAD CENTERS GRAPH

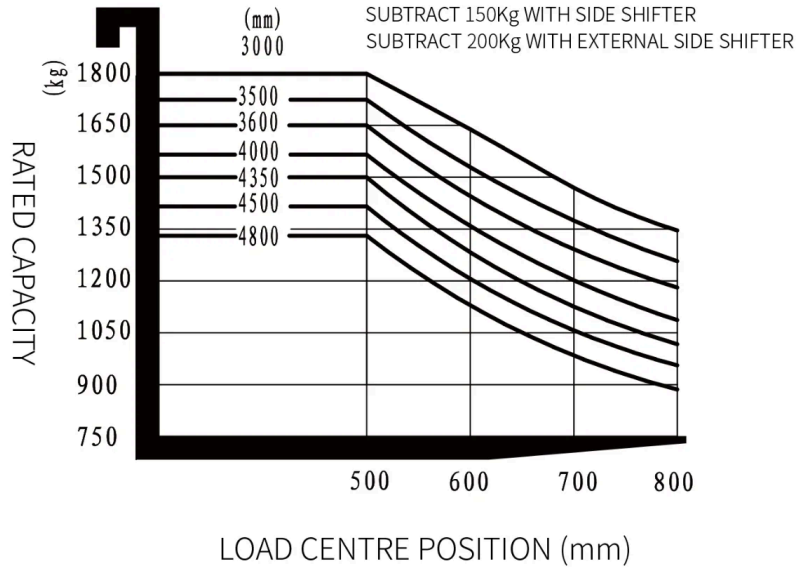

Mast Options

| MAST TYPE | LIFT HEIGHT (H3, MM) | MAST LOWERED HEIGHT (H1, MM) | MAST EXTENDED HEIGHT, NO BACKREST (H4, MM) | MAST EXTENDED HEIGHT, WITH BACKREST (H4, MM) | FREE LIFT HEIGHT, NO BACKREST (H2, MM) | FREE LIFT HEIGHT, WITH BACKREST (H2, MM) |
|-----------------|----------------------|------------------------------|--|--|--|--|
| 2-Standard Mast | 2500 | 1745 | 2985 | 3528 | 130 | 130 |
| 2-Standard Mast | 2700 | 1845 | 3185 | 3728 | 130 | 130 |
| 2-Standard Mast | 3000 | 1995 | 3485 | 4028 | 130 | 130 |
| 2-Standard Mast | 3300 | 2145 | 3785 | 4328 | 130 | 130 |
| 2-Standard Mast | 3600 | 2295 | 4085 | 4628 | 130 | 130 |
| 2-Free Mast | 2500 | 1778 | 2985 | 3528 | 1293 | 750 |
| 2-Free Mast | 2700 | 1878 | 3185 | 3728 | 1393 | 850 |
| 2-Free Mast | 3000 | 2028 | 3485 | 4028 | 1543 | 1000 |
| 2-Free Mast | 3300 | 2178 | 3785 | 4328 | 1693 | 1150 |
| 3-Free Mast | 4350 | 2000 | 4844 | 5328 | 1506 | 975 |
| 3-Free Mast | 4500 | 2050 | 4994 | 5528 | 1556 | 1022 |
| 3-Free Mast | 4800 | 2150 | 5294 | 5828 | 1656 | 1122 |

Options

| ITEM | OPTIONS (optional items marked in yellow) |
|----------------------------|--|
| Fork dimension | 100*40*920 100*40*1070 100*40*1100 100*40*1150 100*40*1220 100*40*1370 100*40*1520 100*40*1800 |
| Fork lowered height | 1028mm Yes and can be customized |
| Fork carriage width option | 1068mm Yes and can be customized |
| Front wheel material | Solid Pneumatic Non-marking tires |
| Rear wheel material | Solid Pneumatic Non-marking tires |
| Battery capacity | 48V150AH 48V205AH |
| Charger | 48V50A 48V30A |
| Seat type | Comfortable Suspension |
| Attachments | No Built-in sidsifter External shifter Adjustable fork |
| Traction pin | Yes |
| Front lamp | LED |
| Rear lamp | No LED |
| Warning lamp | Yes |
| Blue lamp | No Yes and not customized |
| Area warning lamp | No Yes and not customized |
| Rearview mirror | One in front Two on sides |
| Buzzer | Yes |
| OPS system | No Yes and not customized |
| Telematics | Yes and not customized |
| Cabin | No Semi-enclosed cab, front wiper, after wiper,with electric fan |
| Turn signal light | Yes |