

Features :

- Input Voltage: 120-277VAC 50/60Hz.
- ETL & DLC 5.1 certified.
- 130lm/W high lumen efficacy, 80+ CRI.
- 0-10V Dimmable LED driver.
Adjustable CCT: 3500K/4000K/5000K/5700K/6500K
Adjustable Power: 30W/40W/50W/60W/72W.
- High efficiency LM80 SMD LEDs.
- Designed for 50,000 hours lifetime.
- Instant startup, soft light, no glare, no noise.
- Easy for installation.

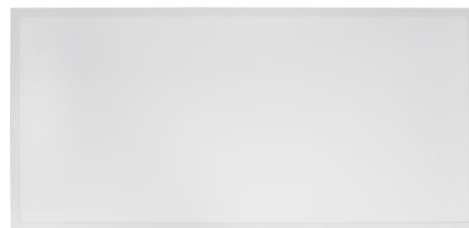

Application:

- ◆ Factory, offices .
- ◆ Living room, clubs, lobbies.
- ◆ Supermarkets, school, hotel.
- ◆ Exhibitions, etc..



Product Dimension: Unit:mm

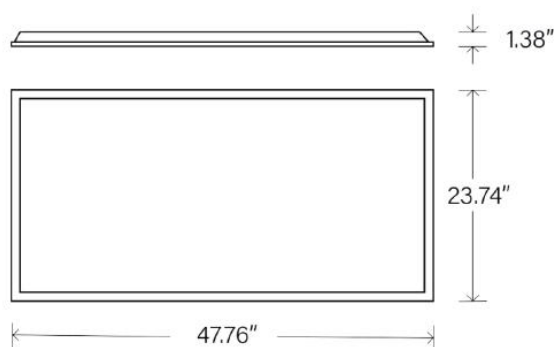

FRONT



BACK

Specifications

LED Panel Light

Model:	SZ-PL24-A72W-CCT
Wattage:	30W/40W/50W/60W/72W
CCT:	3500K/4000K/5000K/5700K/6500K
Input Voltage:	120-277VAC 50/60hz
Power Factor:	>0.9
Efficacy:	125LM/W
CRI:	>80
THD:	<20
Dimmable:	Yes
Dimensions:	2*4FT 603*1213mm
Lifespan:	>50,000hours
Beam Angle:	120°
Operating Temperature:	-20°C to 50°C
IP Grade:	IP20
Certification:	ETL, DLC5.1
Optional Accessory	Emergency Driver:Max 8W, Recharge time: ≥24Hrs, Discharge time :90minutes. Sensor: PIR Sensor or Microwave Sensor.

Package

Size	Qty/Carton	Gross Weight	Net Weight
125.5*22.5*65cm	6	21.93Kg	19.5Kg

Installation instructions

1.Unscrew the driver cover.

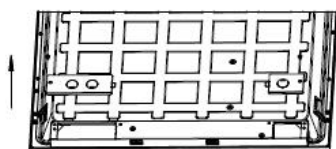

2.Connect the conduit to the driver box.

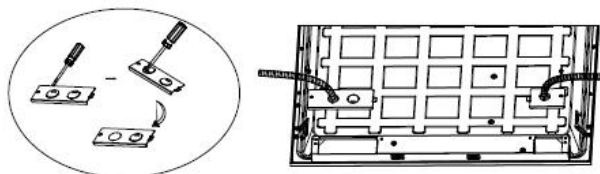

3.Connect other wires separately.

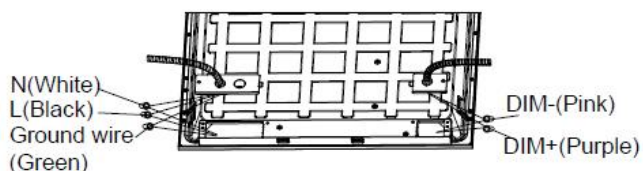

4.Put back the driver cover and fix it by screw
Select adjustable power and color temperature

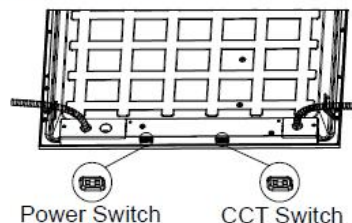

* Optional accessories
If there are more wires, you can choose to use enlarged junction box.

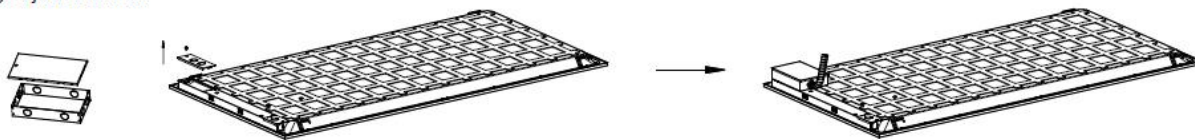

Recessed Installation

1. Replace existing lighting fixture from ceiling with LED Panel.

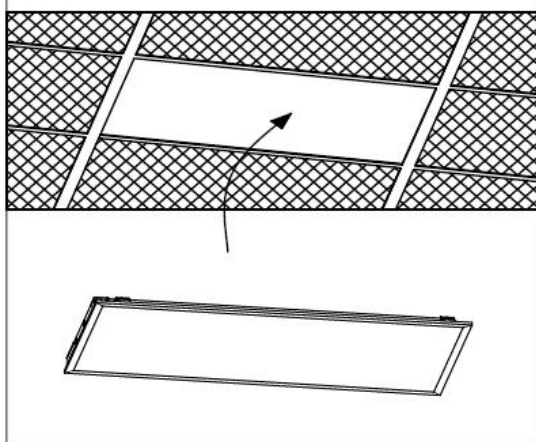

2. Use the protective brackets for the sake of safety.

