

## LED Recessed Light



LED Slim Linear Recessed Panels are designed for modern, efficient, and customizable indoor lighting. Constructed with a durable aluminum frame and an opal polycarbonate lens, these panels are designed to blend seamlessly into any T grid ceiling with their recessed mounting style. From warm to cool white (3500K to 5000K), adjust the color temperature and wattage to fit the mood of the space or to enhance the functionality of the area. Available in 2-foot and 4-foot sizes, these panels integrate effortlessly into any space and are perfect for retail settings, schools, office and healthcare facilities.



Catalog Number	Description	Angle	Lumens	Watts	CCT	Voltage
SZ-LRL20W-2FT-ACP	LED Recessed Light	120°	2000 Lm	Adjustable 10W/15W/20W	Adjustable 3500K/4000K/5000K	120V - 277V Optional 120-347V
SZ-LRL40W-4FT-ACP	LED Recessed Light	120°	4000 Lm	Adjustable 25W/30W/40W	Adjustable 3500K/4000K/5000K	120V - 277V Optional 120-347V

## ORDERING GUIDE

Example: SZ-LRL40W-4FT-ACP

Company Code	Fixture Type	Wattage	Size	Sensor (optional)	ACP
<input type="text"/>	<input type="text"/>	<input type="text"/>	<input type="text"/>	<input type="text"/>	<input type="text"/>
<b>SZ</b> Company Name	<b>LRL</b> LED Recessed Light	<b>20W</b> <b>40W</b>	<b>2FT</b> <b>4FT</b>	<b>Blank</b> Without Photocell/Sensor  <b>S</b> Sensor base (option)	<b>ACP</b>  Adjustable CCT and Power 20W:10/15/20W 3500K/4000K/5000K 40W:25/30/40W 3500K/4000K/5000K

## LED Recessed Light

### Specifications

#### Housing

Constructed with a durable aluminum frame and an opal polycarbonate lens.

#### Electrical

Standard 120V - 277V, Optional 120-347V  
0-10V dimming standard with a dimming range of 100% to 10%. PF > 0.9.

#### CCT and CRI

Adjustable 3500K/4000K/5000K. CRI 80.

#### Angle

120°

#### Operating Temperature

Suitable for use in -20° C to 45° C (-4° F to 113° F).

#### Efficacy

Up to 100 lumens per watt.

#### Lifespan

L70 >50,000 Hours at 25°C (77°F).

#### Certifications

ETL Listed.

#### Warranty

5-year limited warranty.

**WATT/CCT**  
**SELECTABLE**

**POWER:**  
2FT 10/15/20W;  
4FT 25/30/40W

**CCT:35/40/50K**



#### Mounting Brackets:

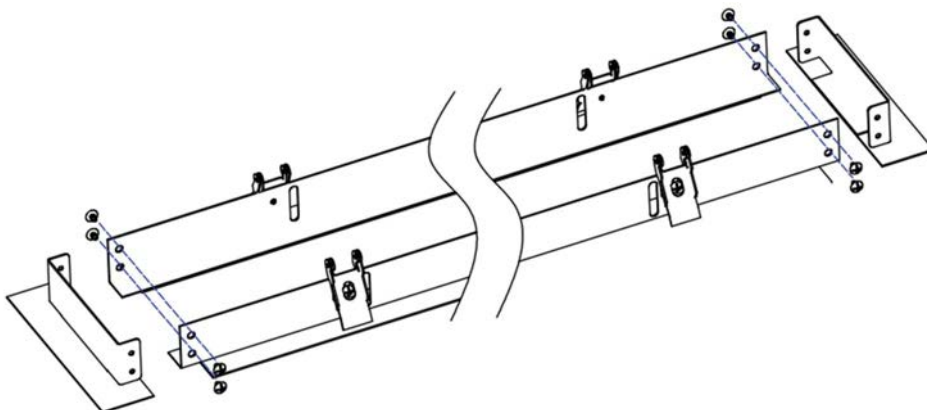

Recessed Flange Kit

LED Recessed Light

Dimension:

2FT

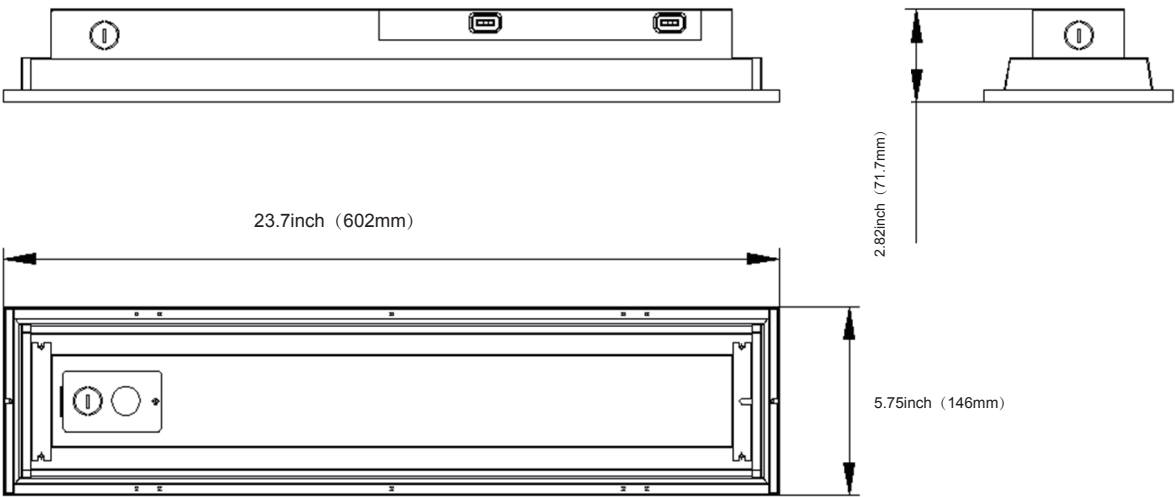

4FT

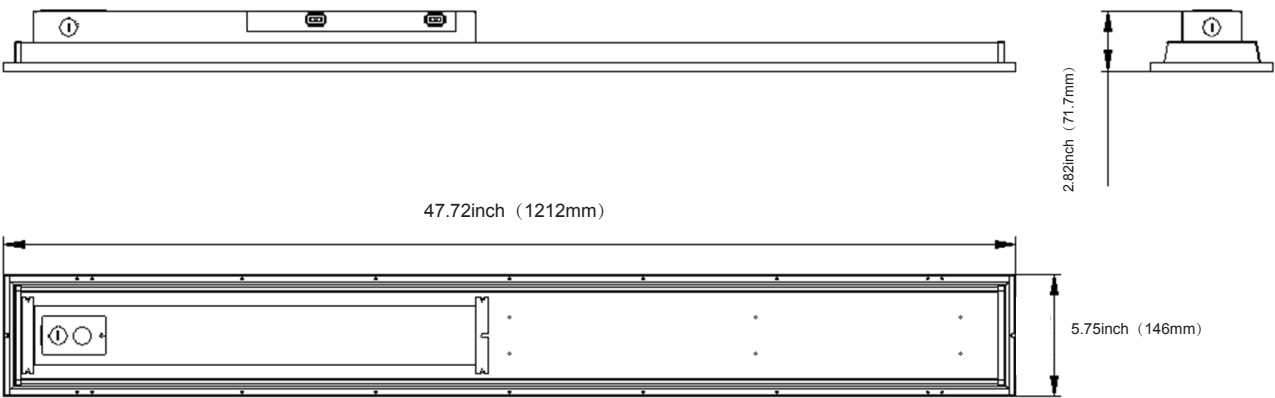

Packing/Weight :

Model	Outer box (L*W*H)	Qty/CTN (pcs)	N.W./pcs (lbs/kg)	G.W./CTN (lbs/kg)	Remark
SZ-LRL20W-2FT-ACP	25.35"* 7.24"*4.61" 644*184*117mm	1	3.09/1.4	4.12/1.87	
SZ-LRL40W-4FT-ACP	49.37"*7.24*4.61" 1254*184*117mm	1	5.07/2.3	6.75/3.06	

## LED Recessed Light

### Installation Instruction:

#### 1.Embedded installation:

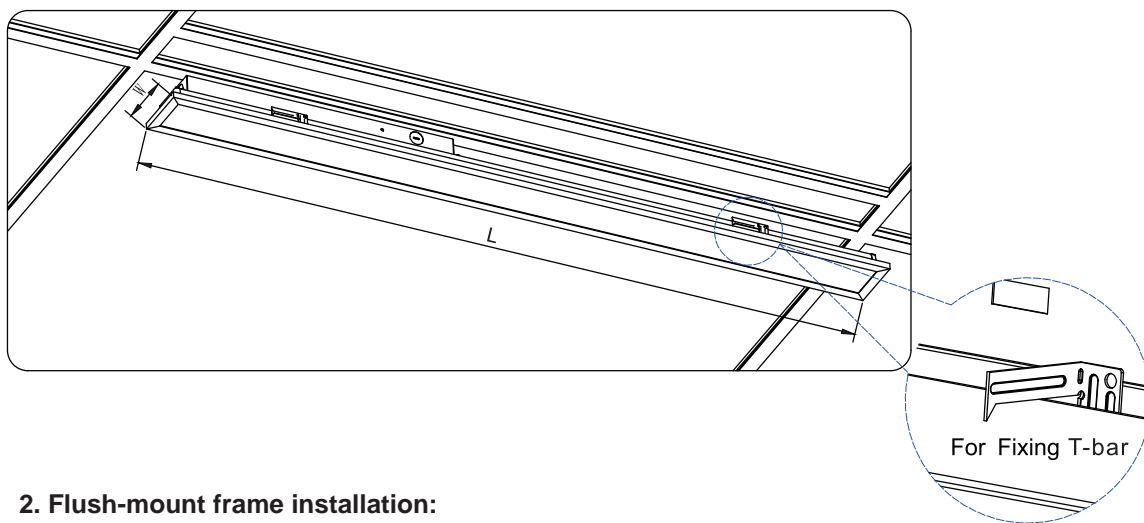

#### 2. Flush-mount frame installation:

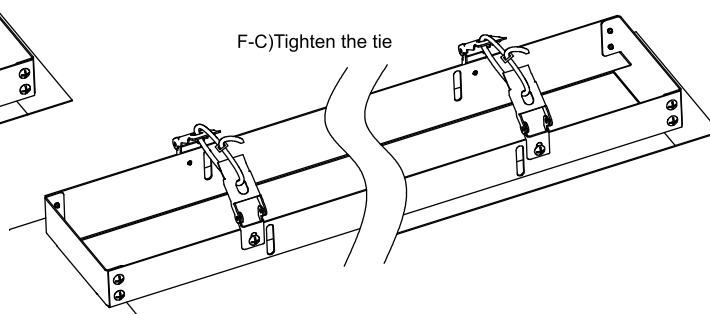
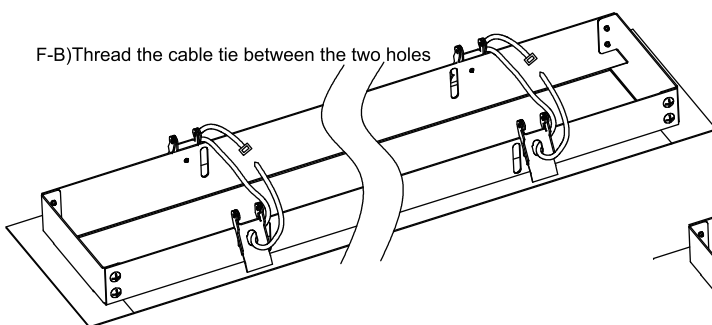
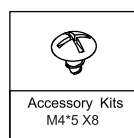
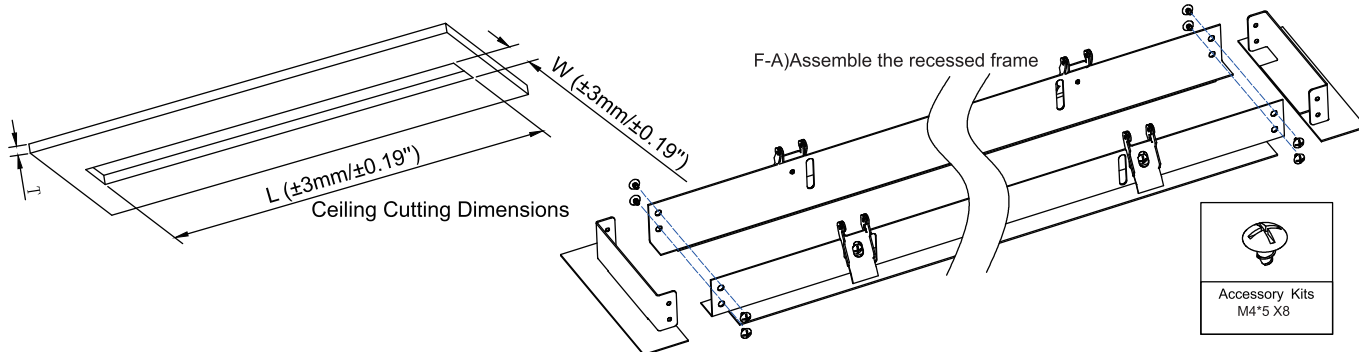

## LED Recessed Light

F-D) Recess the fixture into the ceiling

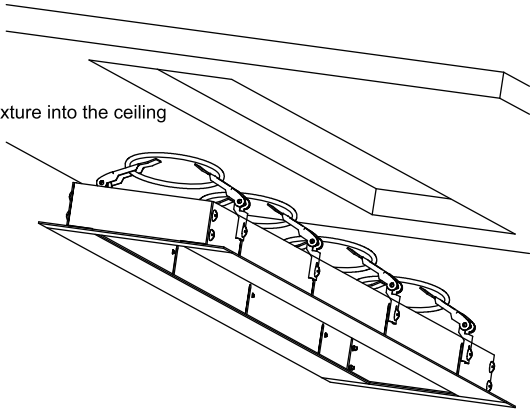

F-E) Cut off the tie  
let it rebound

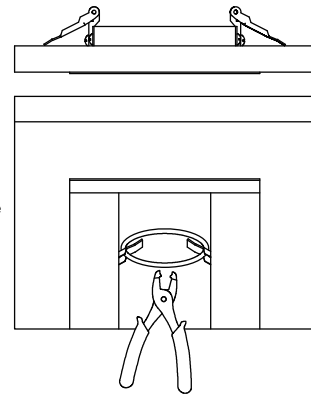

D-D) Put the fixture in, and adjust the position

D-E) Installation Finished

