

LED Canopy Light

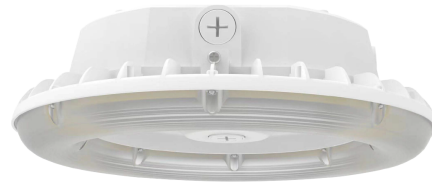

SZ-CNP100/80/60W-H-ACP



SZ-CNP100/80/60WR-H-ACP

The LED Garage and Canopy light is slim and durable with a lightweight design, and provides you with a visually appealing lighting experience. This luminaire can be surface mounted directly to the ceiling or pendant mounted using rigid conduit. Its light-weight design with quick and easy mounting plate allows simple installation and hands-free wiring. Whether it's new construction, or a retrofit installation, the Garage and Canopy fixture will provide years of trouble free operation and keep you on budget.



Catalog Number	Description	Angle	Lumens	Watts	CCT	Voltage
SZ-CNP100/80/60W-H-ACP	LED Canopy Light	120°	13000 Lm)	Adjustable 100W/80W/60W	Adjustable 3500K/4000K/5000K	120V - 277V Optional 120-347V
SZ-CNP100/80/60WR-H-ACP	LED Canopy Light	150°	13000 Lm	Adjustable 100W/80W/60W	Adjustable 3500K/4000K/5000K	120V - 277V Optional 120-347V

ORDERING GUIDE

Example: SZ-CNP100/80/60W-H-ACP

Company Code	Fixture Type	Wattage	Shape	High Efficiency	Voltage	ACP	Housing finish color
SZ Company Name	CNP CanopyLight	100/80/60W	Blank Square R Round	H high Efficient	Blank 120-277V MV 120-347V	ACP Adjustable CCT and Power 100/80/60W 35000K/4000K/5000K	B Bronze W White

Accessories (Optional)



SZ-MS-MH1: Microwave sensor
SZ-PS-A: Photocell snesor



SZ-MS-MH1K5
Plug-and-Play Microwave and
Photocell Sensor, 5 Manual
Switches, easy programming



SZ-MS-RC1
Sensor Remote

LED Canopy Light

Specifications

Housing

Sealed die-casting profile for outdoor applications.

Electrical

Standard 120V - 277V, Optional 120-347V
0-10V dimming standard with a dimming range of 100% to 10%. PF > 0.9. Surge protection: 6KV.

CCT and CRI

Adjustable 3500K/4000K/5000K. CRI 70.

Angle

Square 120°, Round 150°

Operating Temperature

Suitable for use in -40° C to 45° C (-40° F to 113° F).

Efficacy

Up to 130 lumens per watt.

Lifespan

L70 >50,000 Hours at 25°C (77°F).

Certifications

UL Listed for wet locations, DLC5.1, FCC compliant, IP65 rated.

Warranty

5-year limited warranty.

Product Structure Characteristics:



Mounting Bracket

Suitable for J-BOX mounting, and easy for installation, also support pendant mounting, wires coming out from the back for easier wire connections.

Housing

One piece die cast housing better waterproofing, suitable for both indoor and outdoor application.

Sensor Base

Optional PIR, Microwave, sensor allows for security and energy saving.

Dimension:

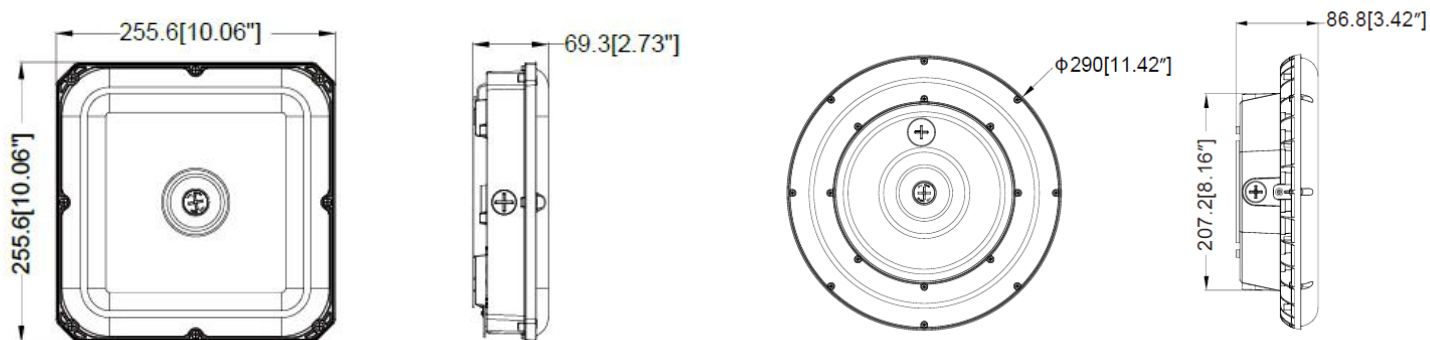

Packing/Weight:

Model	Outer box (L*W*H)	Qty/CTN (pcs)	N.W./pcs (lbs/kg)	G.W./CTN (lbs/kg)	Remark
SZ-CNP100/80/60W-H-ACP	13.23* 11.14*11.14" 336*283*283mm	4	18/8.2	20.24/9.2	
SZ-CNP100/80/60WR-H-ACP	17.24*12.52*13" 438*318*330mm	4	16.28/7.4	19.49/8.86	

LED Canopy Light

INSTALLTION INSTRUCTION: SZ-CNP100/80/60W-H-ACP

Ceiling Installation

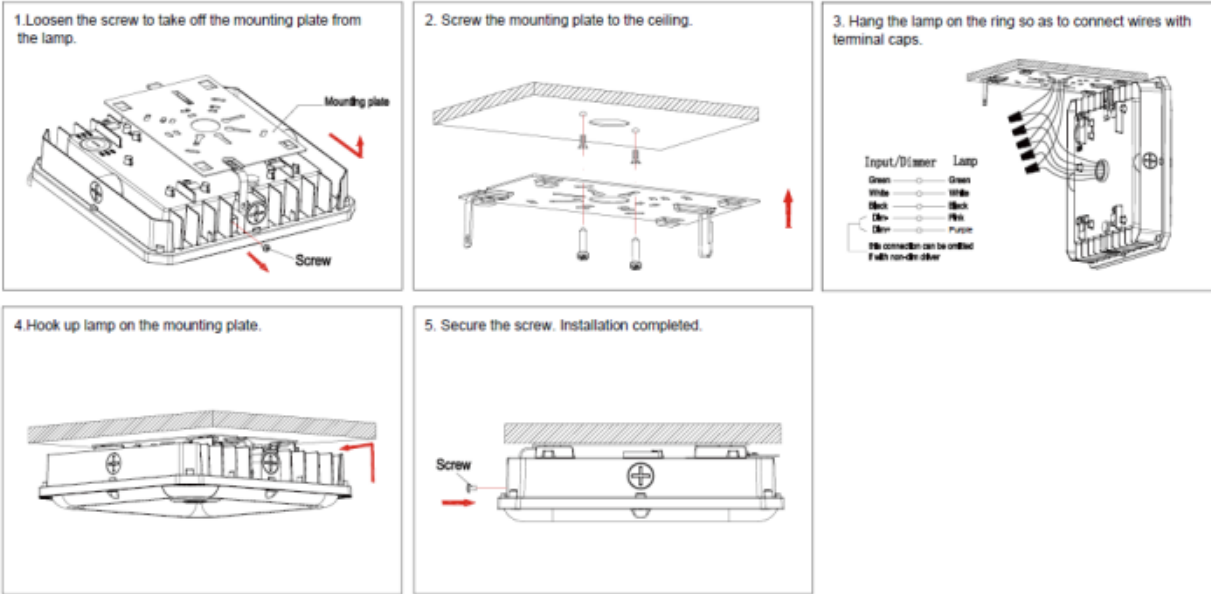

Pole-pendant Installation

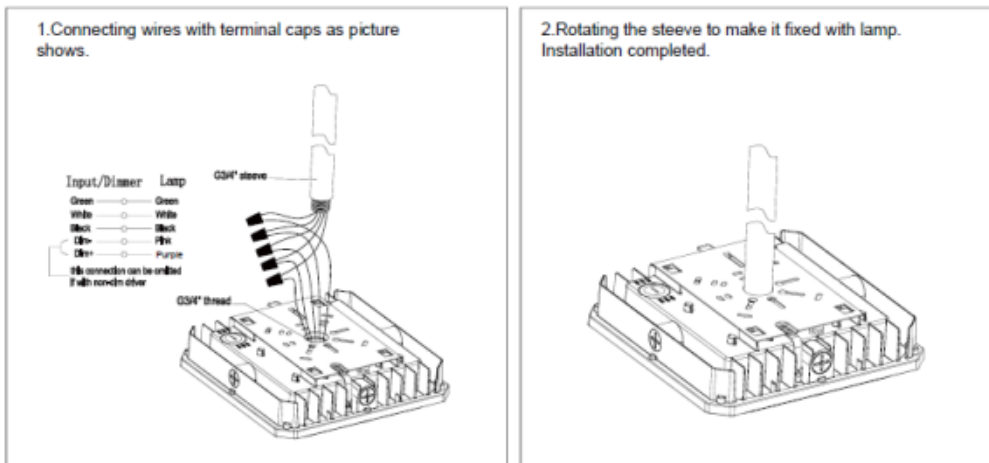

Plug sensor installation

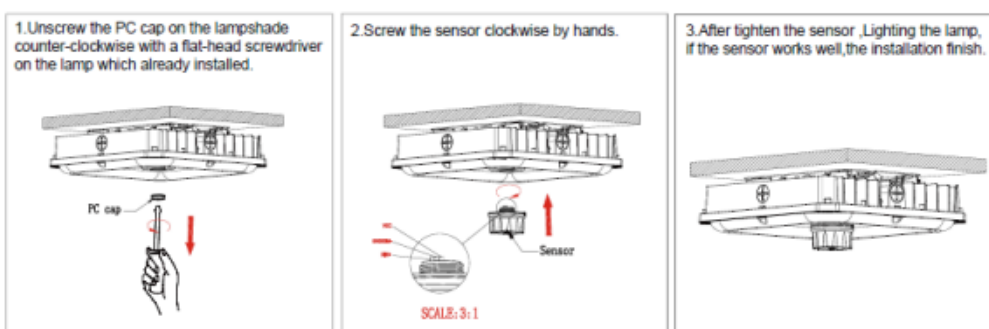

Function of CCT and power Selective

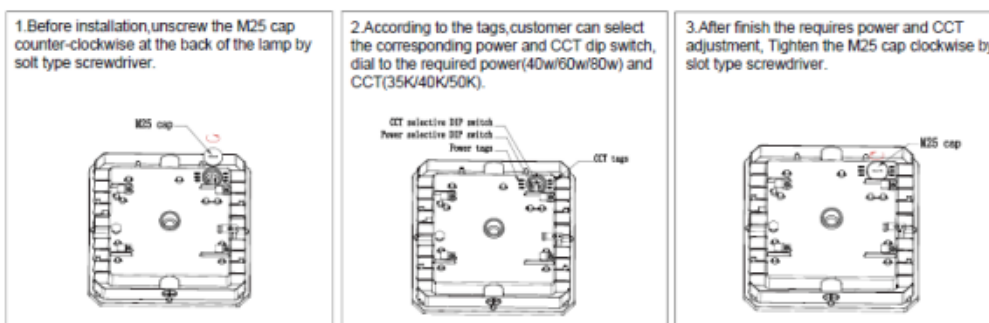

LED Canopy Light

INSTALLTION INSTRUCTION:SZ-CNP100/80/60WR-H-ACP

Ceiling Installation

1. Use a screwdriver to unscrew the lamp screws and open the upper half of the fixture.

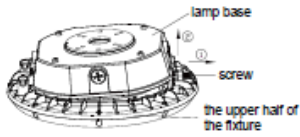

2. Remove the hook of safety rope and the upper part of the luminaire.

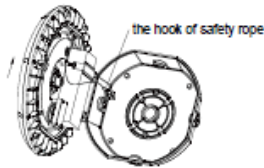

3. According to the embedded terminal box, punch the corresponding mounting hole on the light's mount.

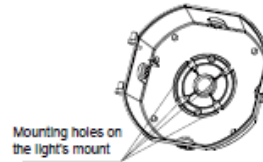

4. Put the input line in the embedded box passes through the waterproof pad and then passed through the lamp base.

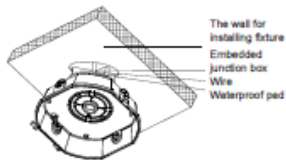

5. Use screw to lock the lamp base on the embedded junction box.

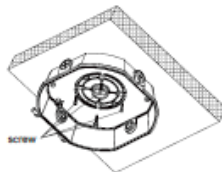

6. Attach the upper part of the luminaire and hang the safety rope hook.



7. Connect the Input wire and the dimming wire of the light, then put the connected wires into the embedded terminal box. Connect the output wires of driver with the wires of PCB board.

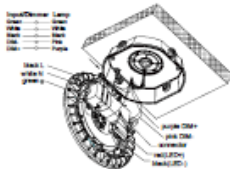

8. Secure the screw. Installation completed.

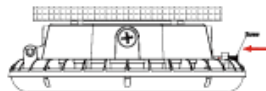

Pole-pendant Installation

1. Connecting wires with terminal caps as picture shows.

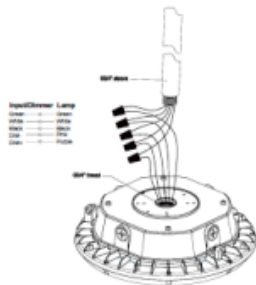

2. Rotating the sleeve to make it fixed with lamp. Installation completed.

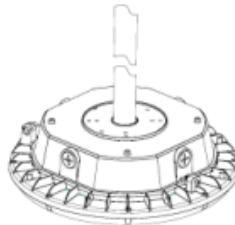

Plug sensor installation

1. Unscrew the PC cap on the lampshade counter-clockwise with a flat-head screwdriver on the lamp which already installed.

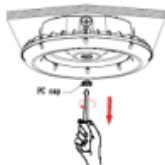

2. Screw the sensor clockwise by hands.

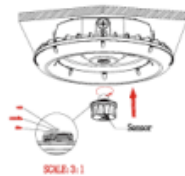

3. After tighten the sensor, Lighting the lamp, if the sensor works well, the installation finish.



Function of CCT and power Selective

1. Before installation, unscrew the M26 cap counter-clockwise at the back of the lamp by slot type screwdriver.



2. According to the tags, customer can select the corresponding power and CCT dip switch, dial to the required power(40w/60w/80w) and CCT(35K/40K/50K).



3. After finish the requires power and CCT adjustment, Tighten the M26 cap clockwise by slot type screwdriver.

