

## LED COB STRIP

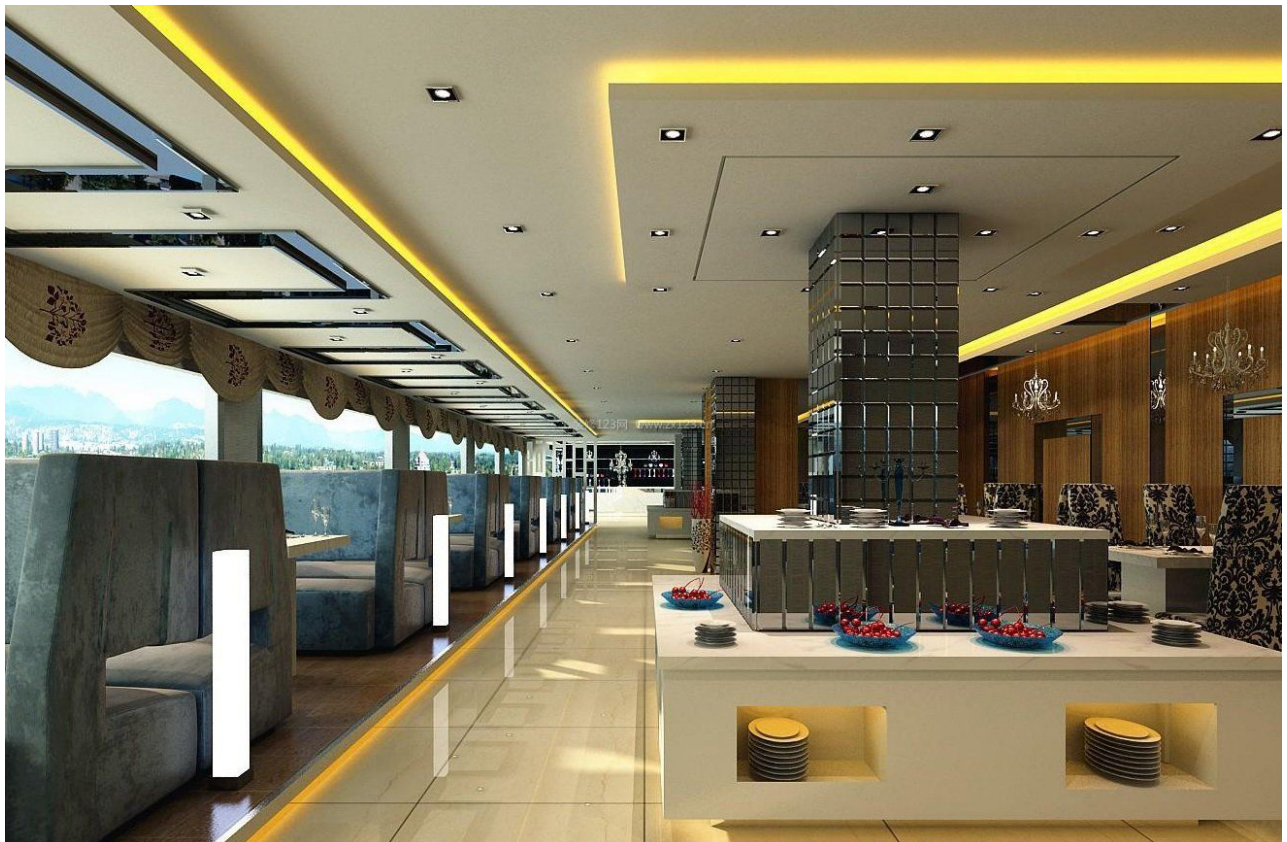

### Application



## Product Features

1. No spot, no shadow, soft light.
2. The antistatic grade (MIL – STD – 883 – e) : HBM level 2 (2000 ~ 4000 v)
3. The largest emitting angle can reach to 180°
4. Can be cut, and be free to cut off and weld along with the above cutting line.
5. Certification:UL

## PARAMETER

Model No.	JE-004W-ST-COB-X	SMD Type	COB
Input voltage	24V	Warranty	3 years
CRI(Ra)	>80	Working temperture	-25 °C ~+45 °C
Bram angle	180°	Cutttable length(inch)	1.97"
LEDs /m	480LEDs	PCB Width(inch)	0.315"
CCT	2700K/3000K/3500K/4000K/5000K	Watt	3W/Foot
Lumen	>300LM/Foot	IP Grade	IP20

## Structure & Parameter

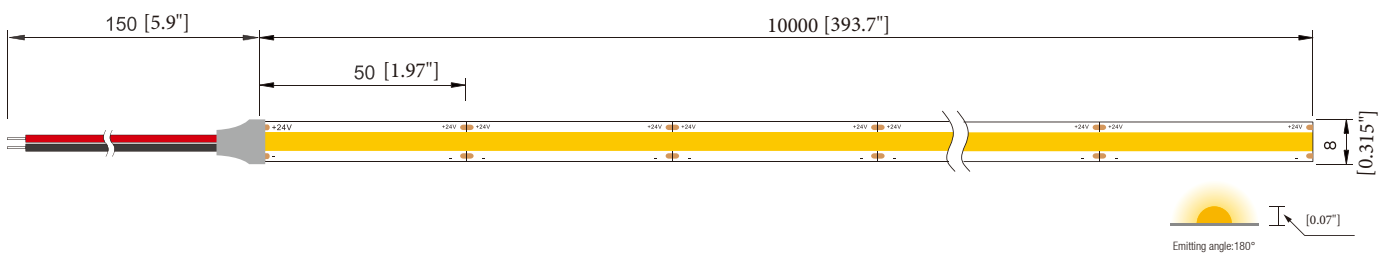

## Wiring Diagram

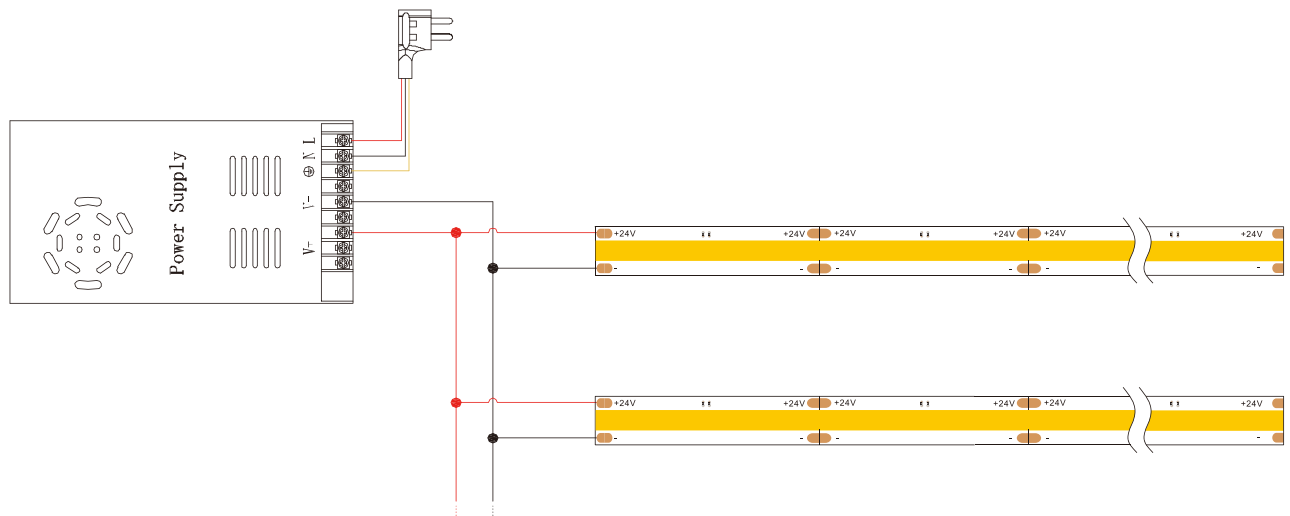

### Cautions

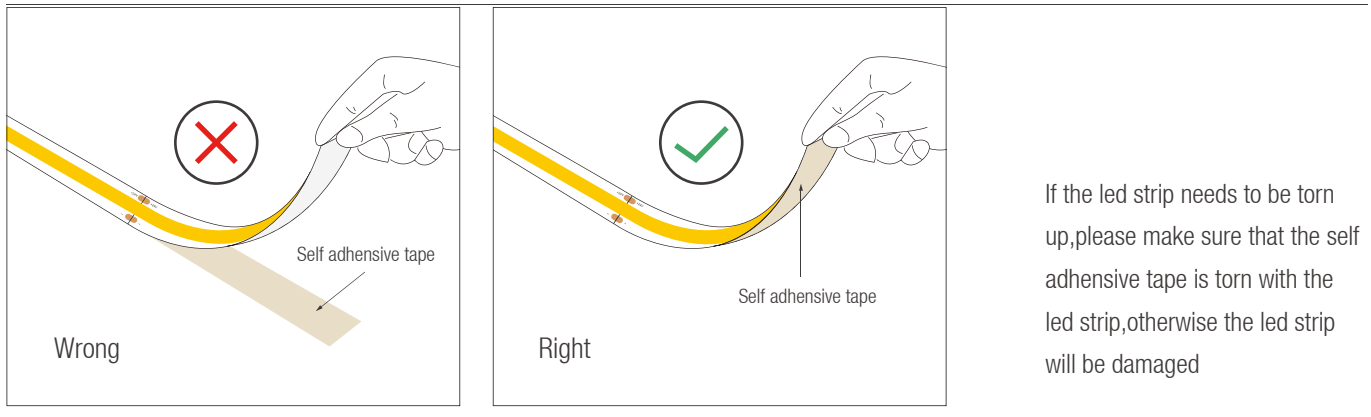

When install the led strip, please note the installation technique. The led strip can be bent, but not distorted, as shown below.

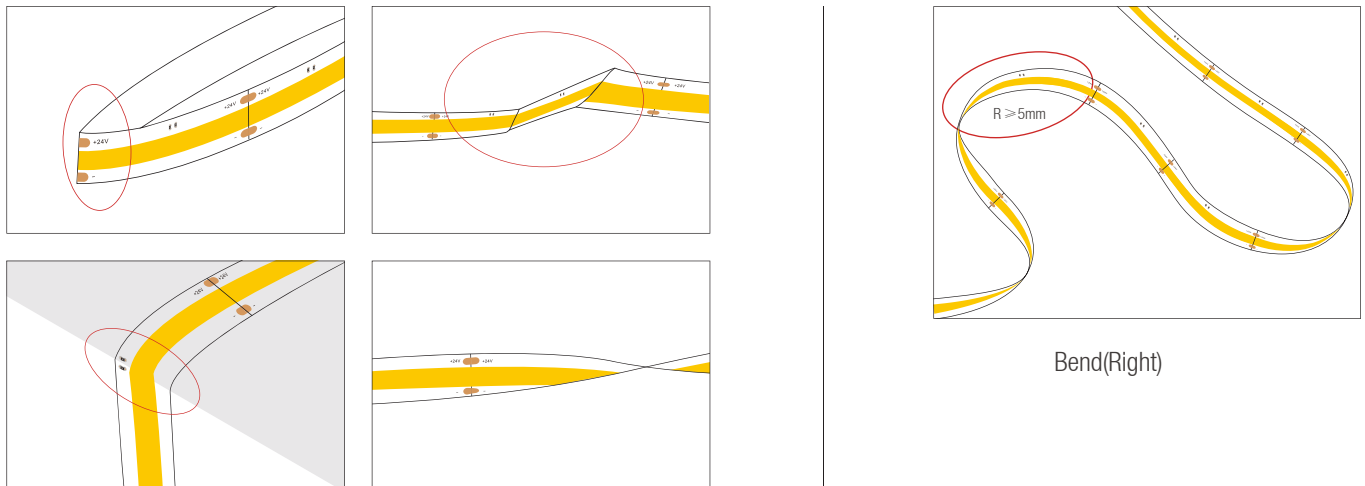

- LED strips are low voltage products, you must use the power supply(transformer). Please don't connect the led strip directly to the AC 110v or AC 220v, otherwise it will burn out the LED strips.

- Clean up the installation surface, it will ensure the reliability of the adhesive, The electrical connection process must be operated by a professional person.