



SiloScan Go

Portable Cable Reader

User Manual V2.0

May 2026

Powering On

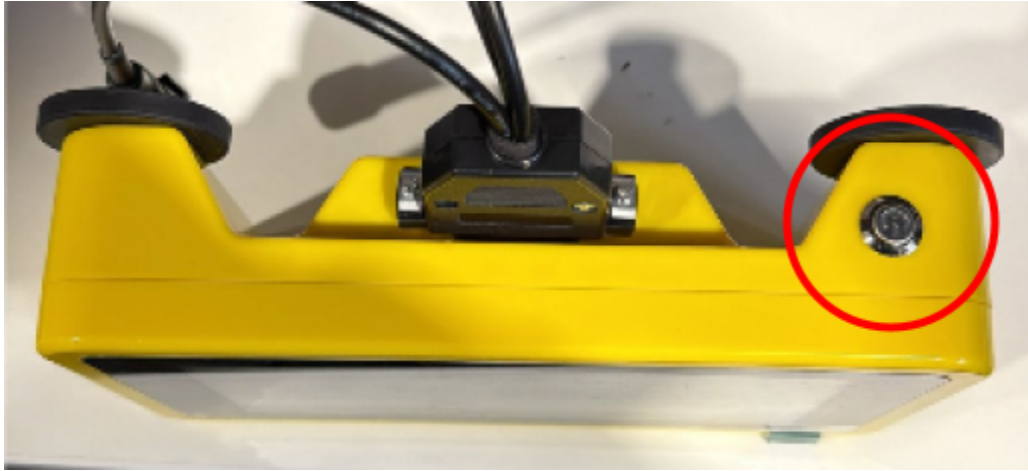

Hold the power button for 3 seconds to power the device on/off.

Charging



While the screen is off and the device is charging, a quick tap on the power button will show the charging status screen.

Recommended charger: 20W/30W PD QC USBC charger

Start Up Screen



The start up screen displays the HW/FW version and the device serial number.

Settings

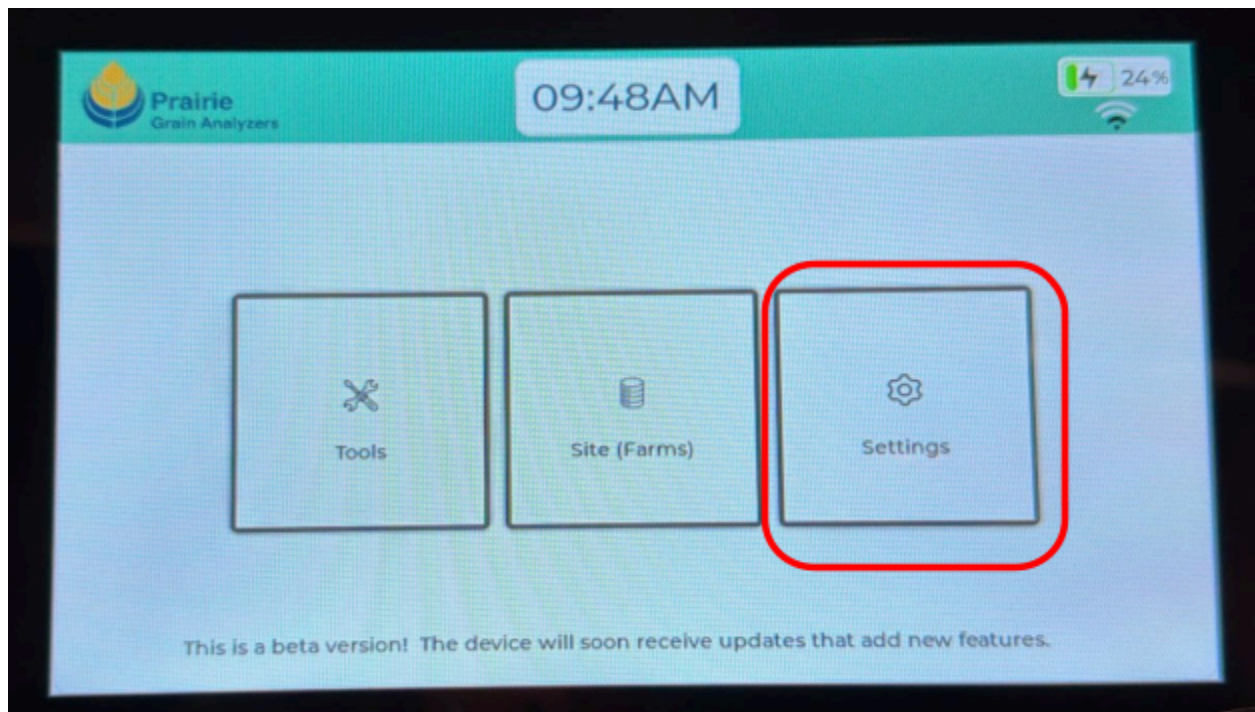

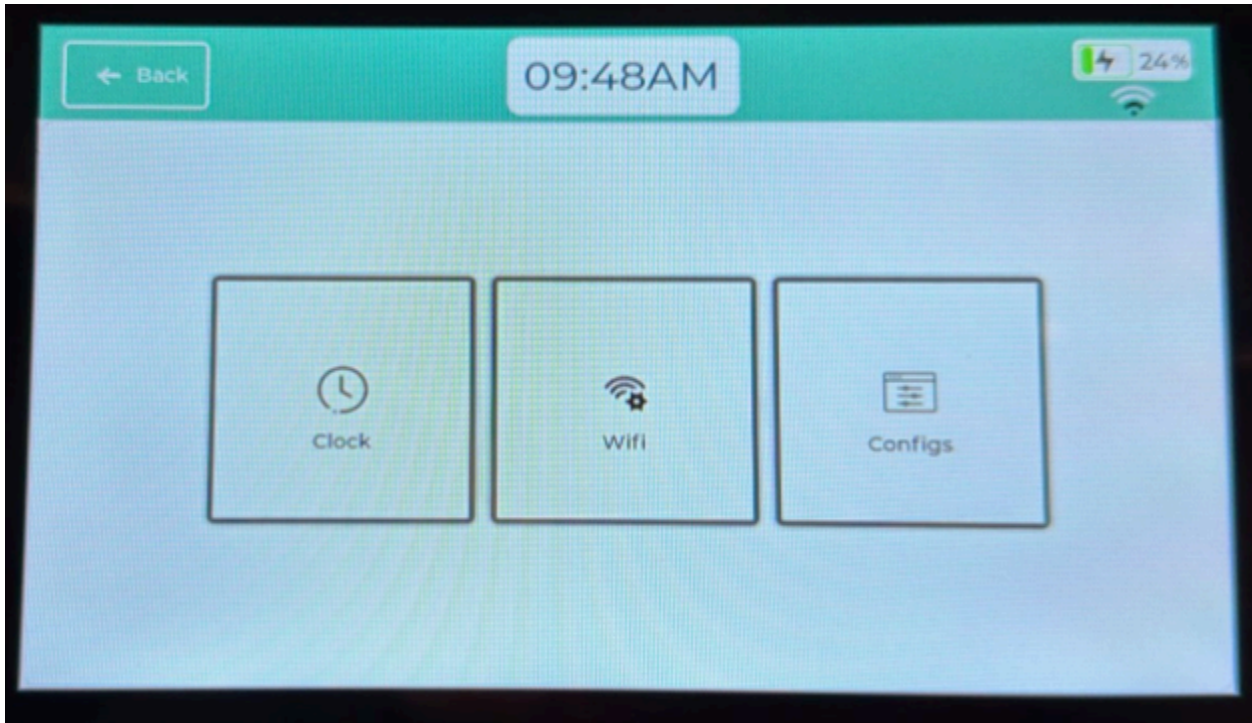

Configs

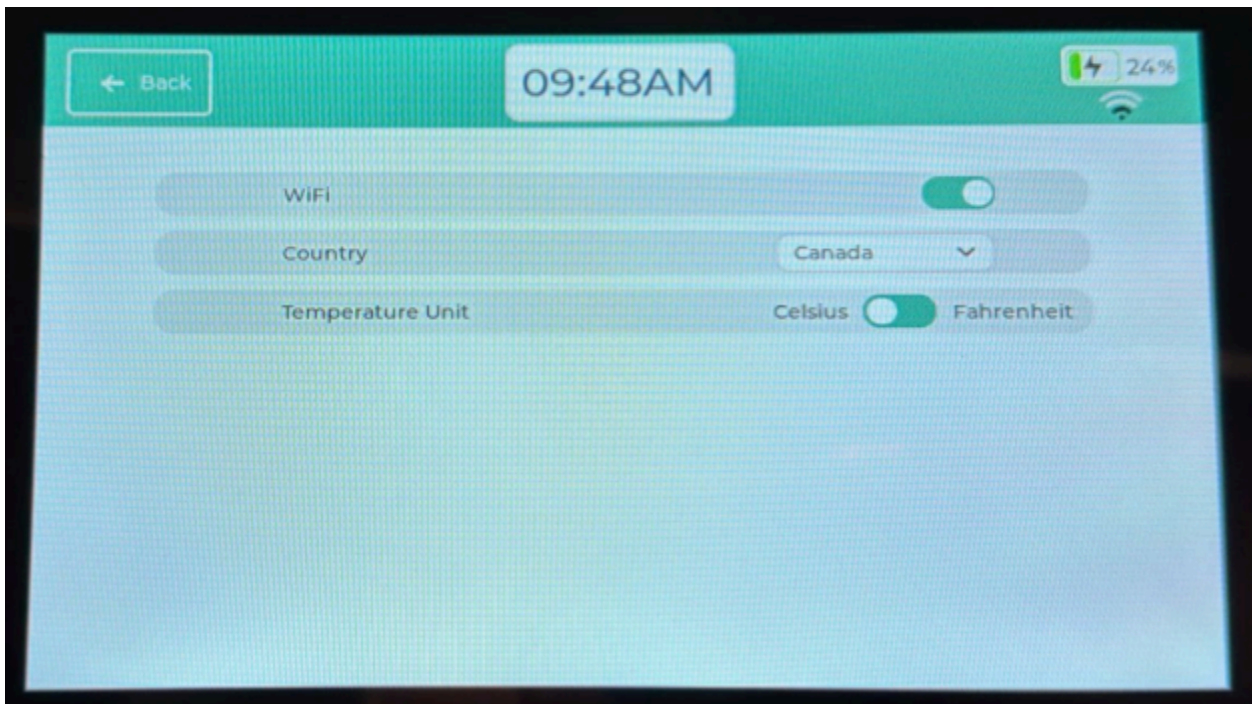

Turn off WIFI, select the country, and temperature unit here.

Wifi

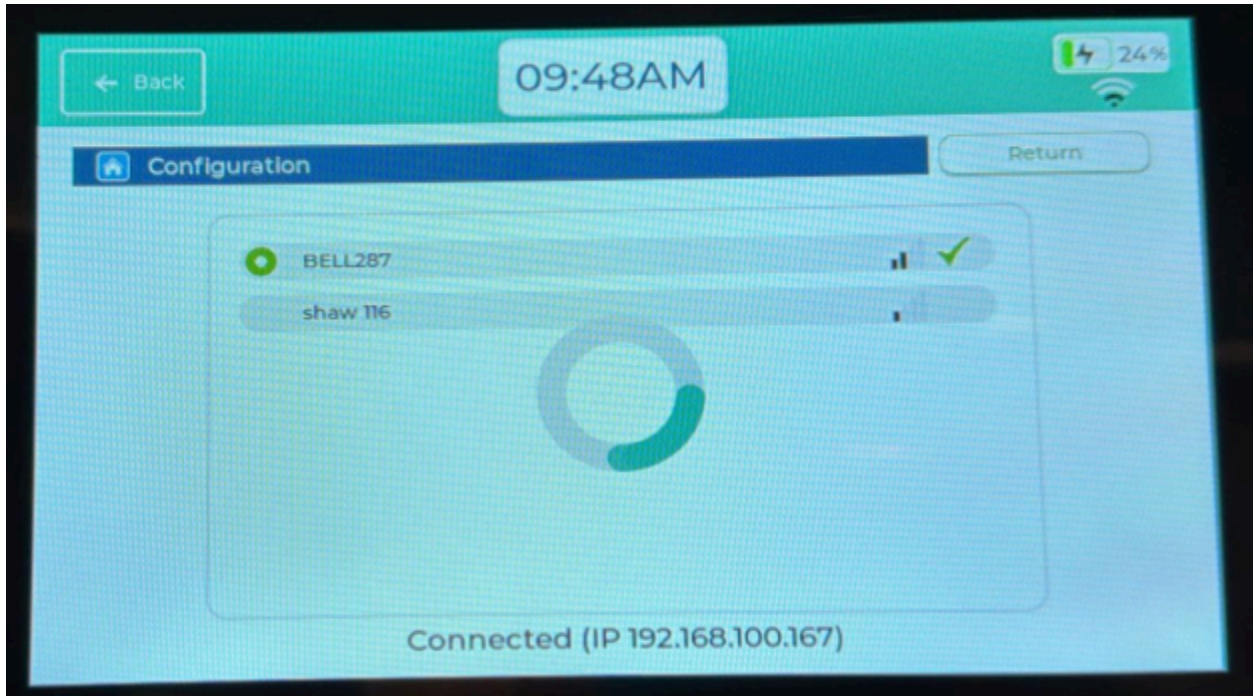

Select from the list of available networks.

Clock

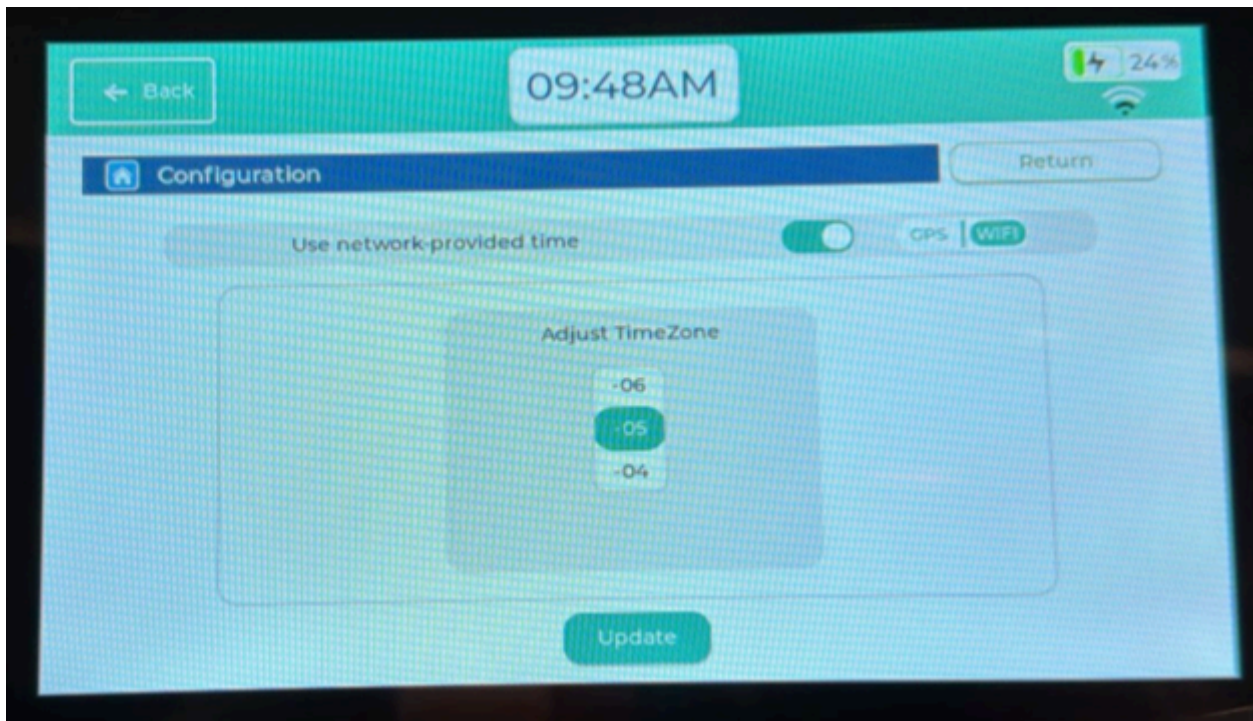

Select Use network-provided time and adjust the time-zone to set the time, or set the time manually.

Tools

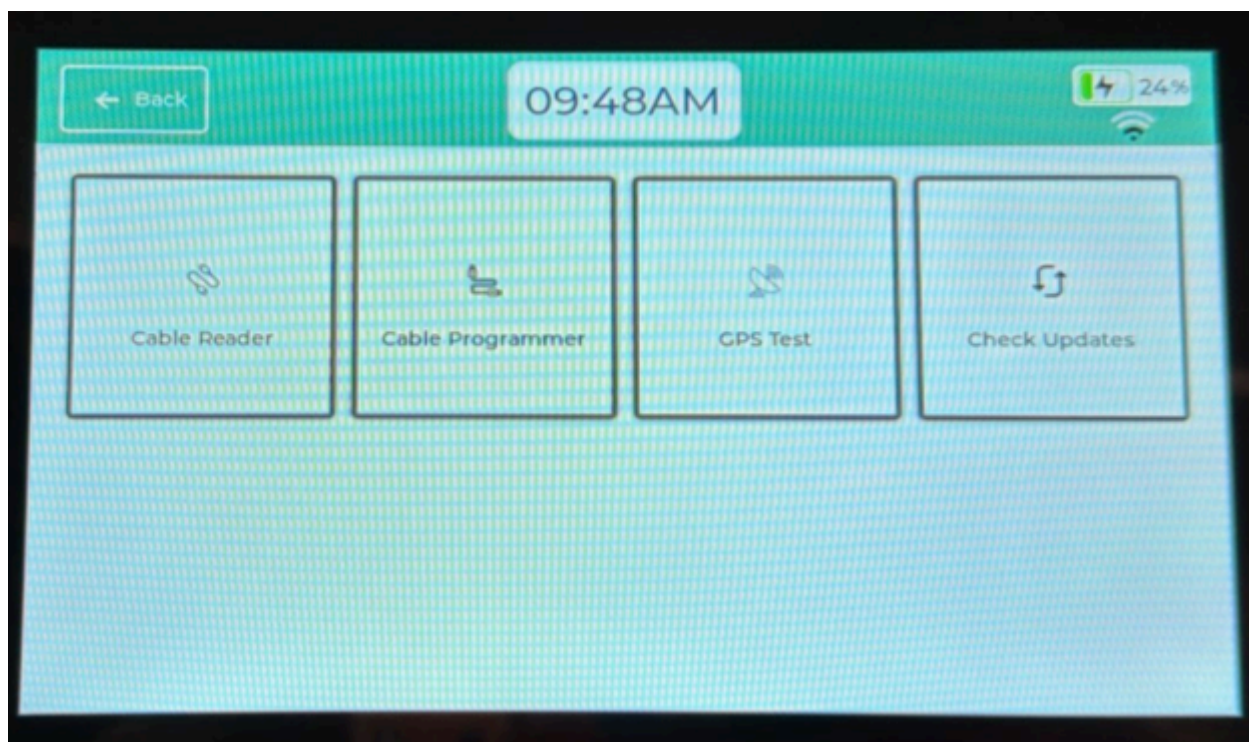
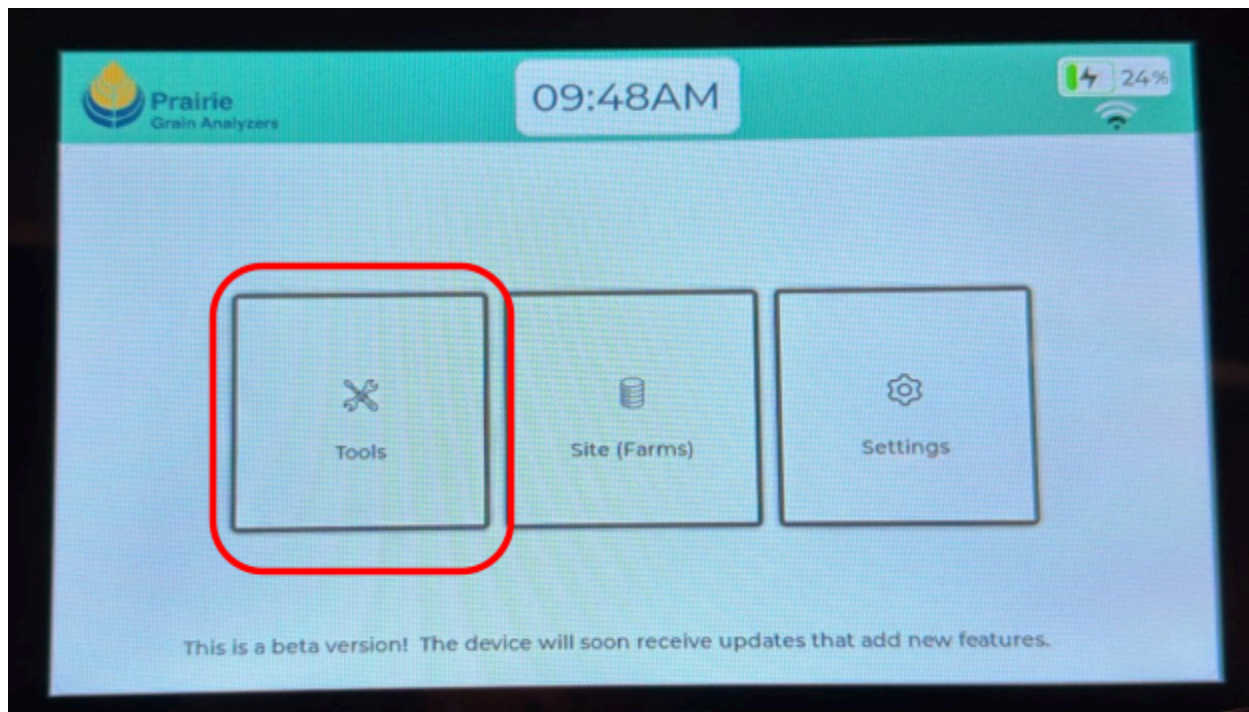

Check Updates

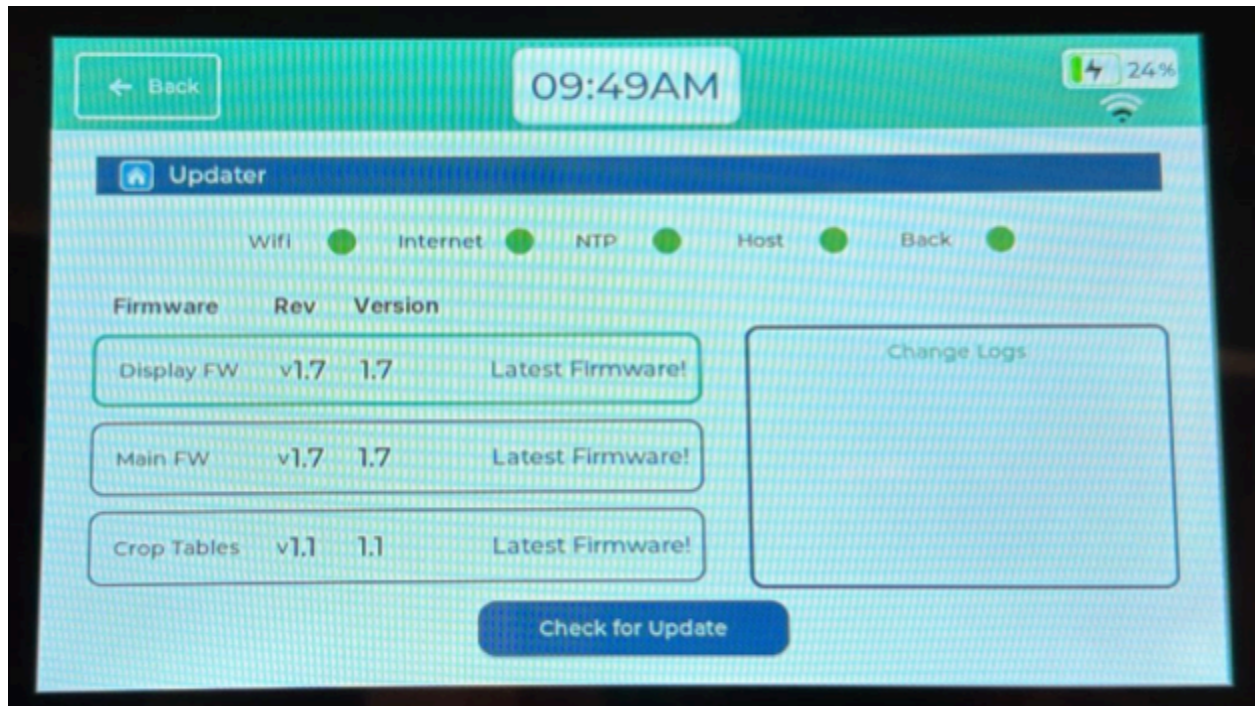

Check for the latest updates on this screen.

GPS Test

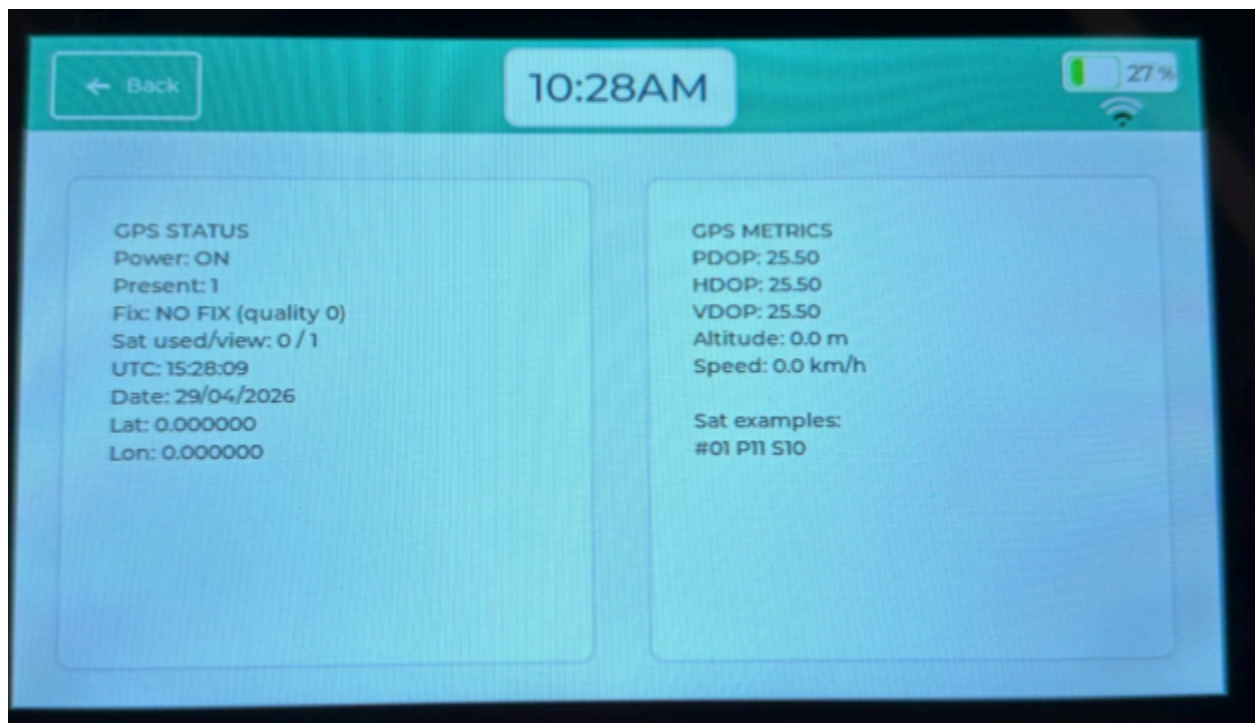

When values appear under Sat examples in real time, that means the GPS satellite is working.

Cable Programmer

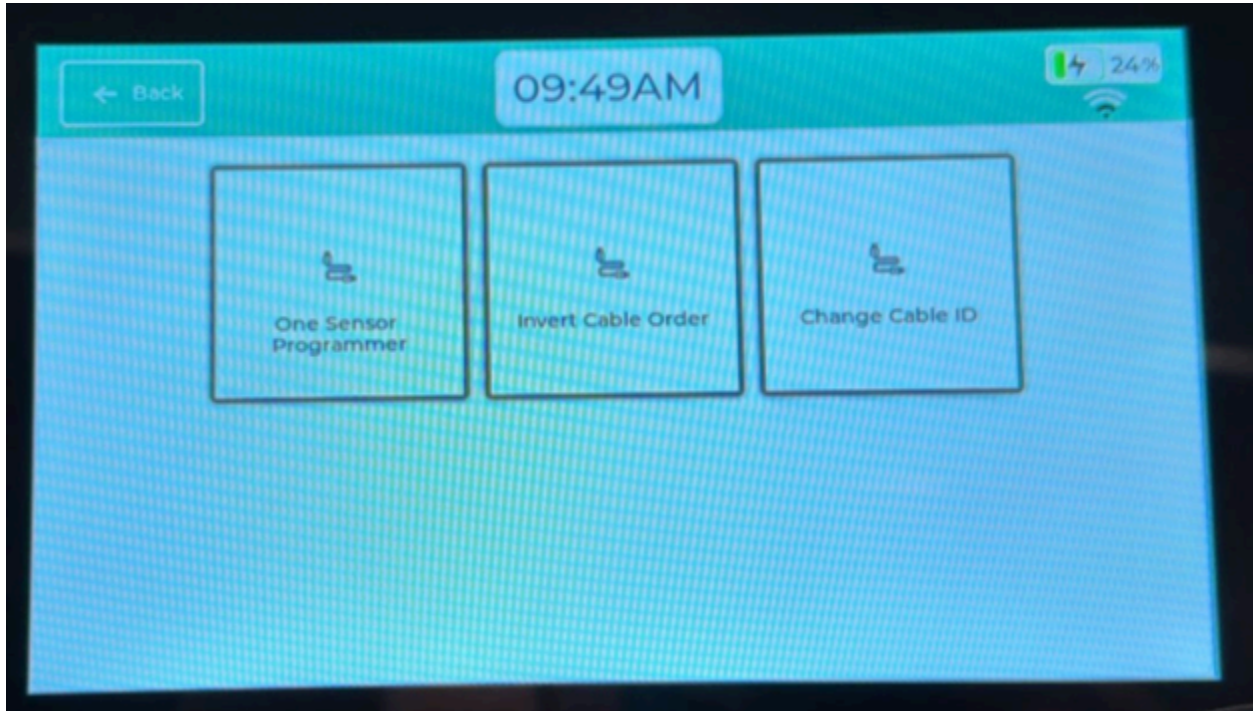

One Sensor Programmer

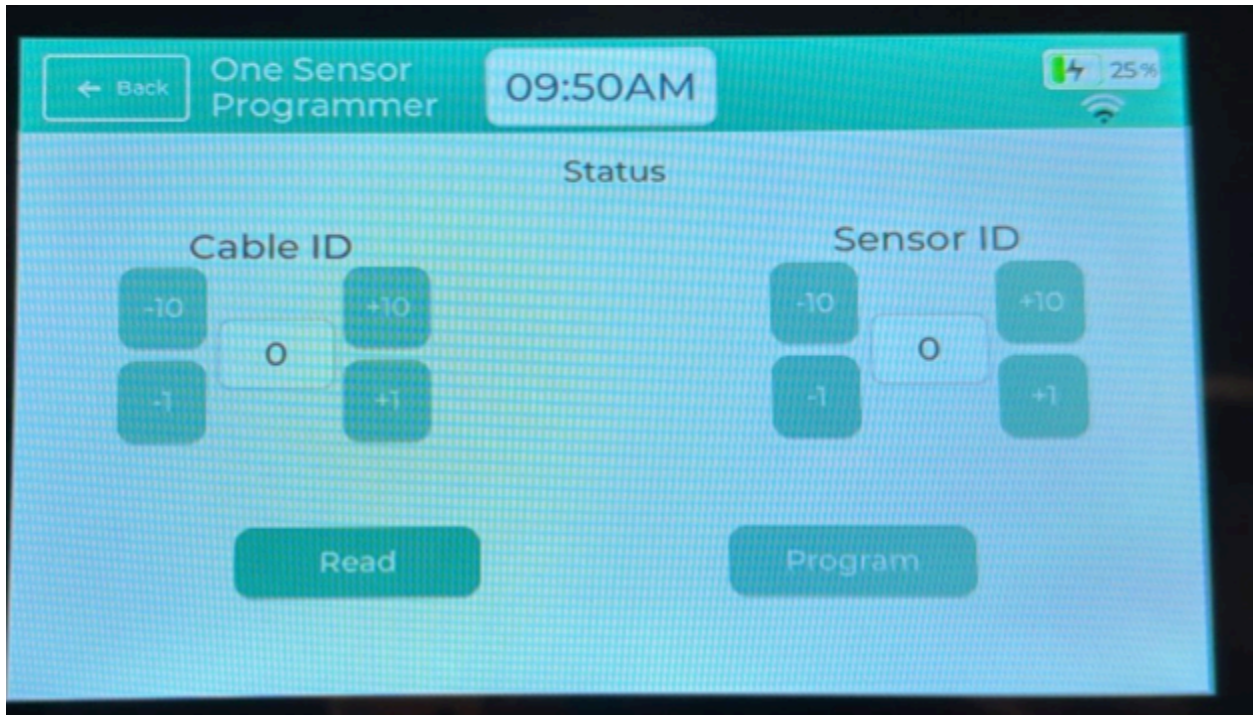

Program sensor position and cable id of a single sensor only. Useful for sensor repairs and replacements.

Invert Cable Order

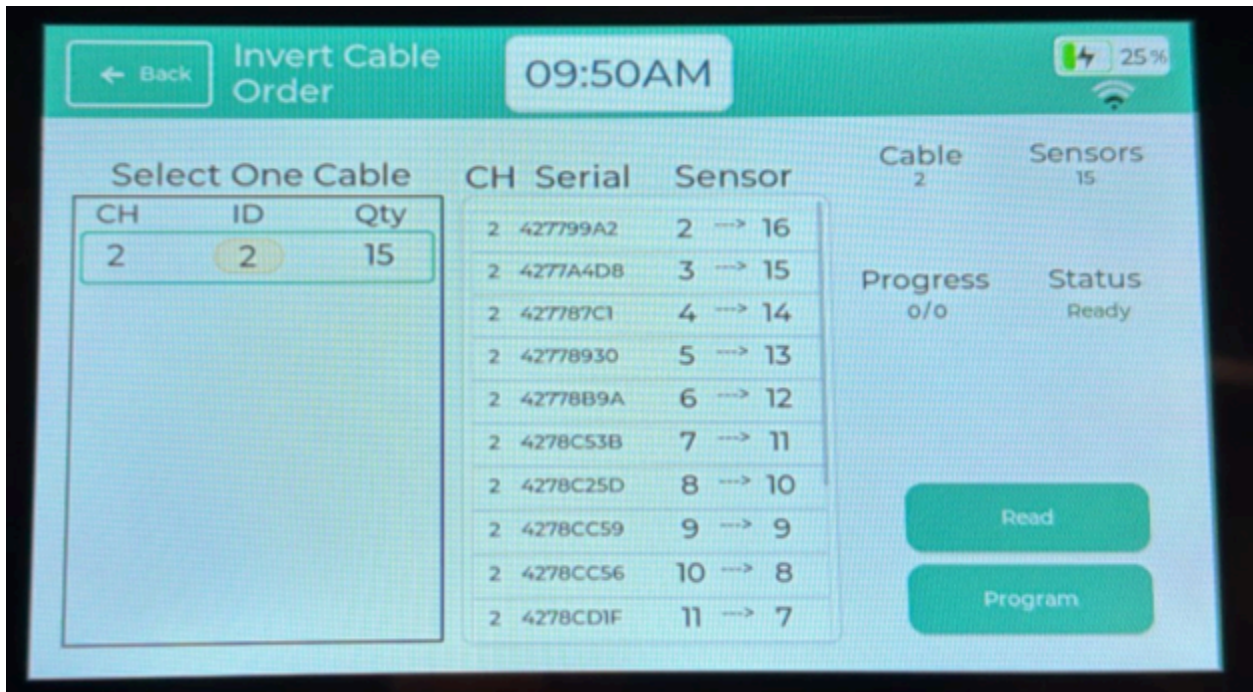

Inverts the sensor position order on a cable from bottom to top, to top to bottom.

Change Cable ID

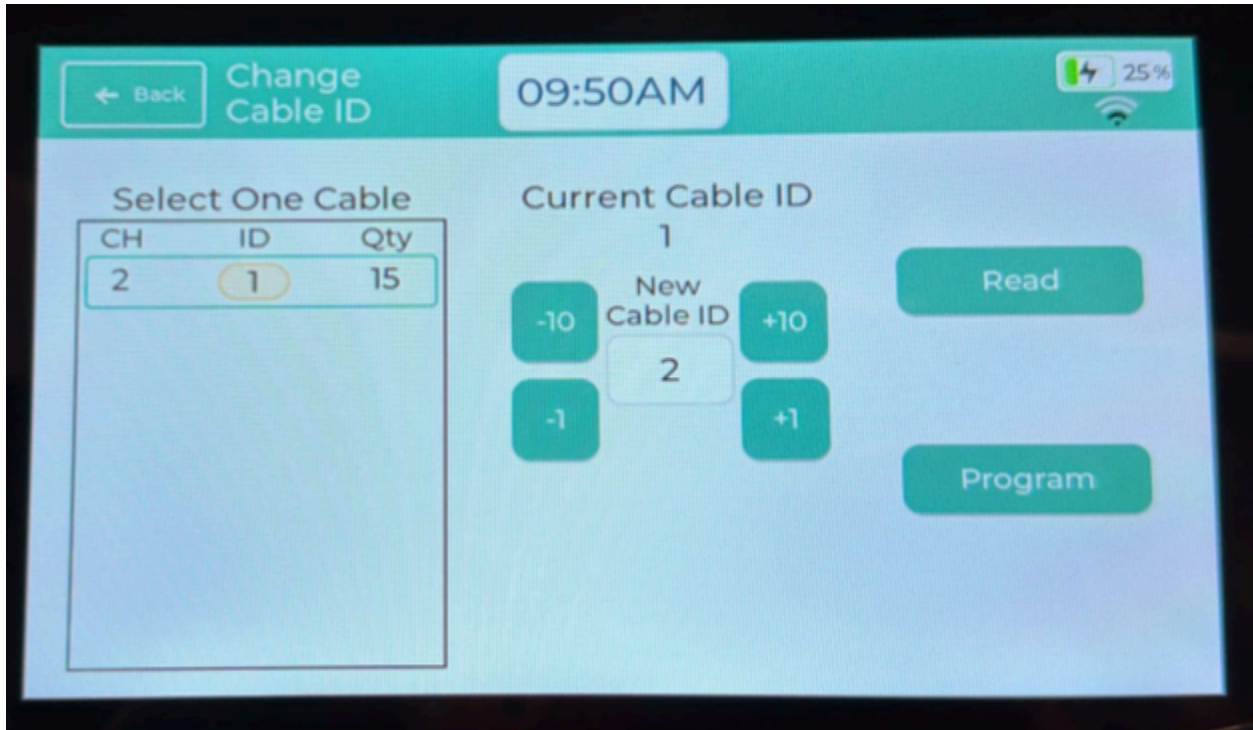

Program the cable ID

Cable Reader

The screenshot shows the 'Cable Reader' application interface. At the top, there is a 'Back' button, the title 'Cable Reader', the time '09:51AM', a 'Stop' button, and a battery status indicator at 25%. Below the header, there are two summary boxes for Channel 1 and Channel 2. Channel 1 shows 0 sensors, 0 OK, and 0 ERR. Channel 2 shows 15 sensors, 12 OK, and 0 ERR. The main data table lists 12 sensors with their IDs, types, cable numbers, and temperature/humidity readings.

CH	Sensor ID	Type	Cable	Sensor	Temp 1	Temp 2	AirRh(%)
2	427799A2	2	2	2	20.1C	20.3C	31.8%
2	4277A4D8	2	2	3	19.8C	20.1C	31.5%
2	4277B7C1	2	2	4	19.7C	20.0C	31.5%
2	4277B930	2	2	5	19.9C	20.2C	31.3%
2	4277B9A	2	2	6	19.9C	20.2C	31.5%
2	4278C53B	2	2	7	19.9C	20.1C	31.5%
2	4278C25D	2	2	8	20.0C	20.2C	31.3%
2	4278CC59	2	2	9	20.0C	20.2C	31.1%
2	4278CC56	2	2	10	19.9C	20.1C	31.4%
2	4278CD1F	2	2	11	20.1C	20.2C	31.2%
2	4278CAAA	2	2	12	19.9C	20.2C	31.7%

Click start to read a cable.

There are two 2-pin ports available: Channel 1 and Channel 2
Both ports can be used to read standard 2-pin grain bin cables.

Site (Farms)

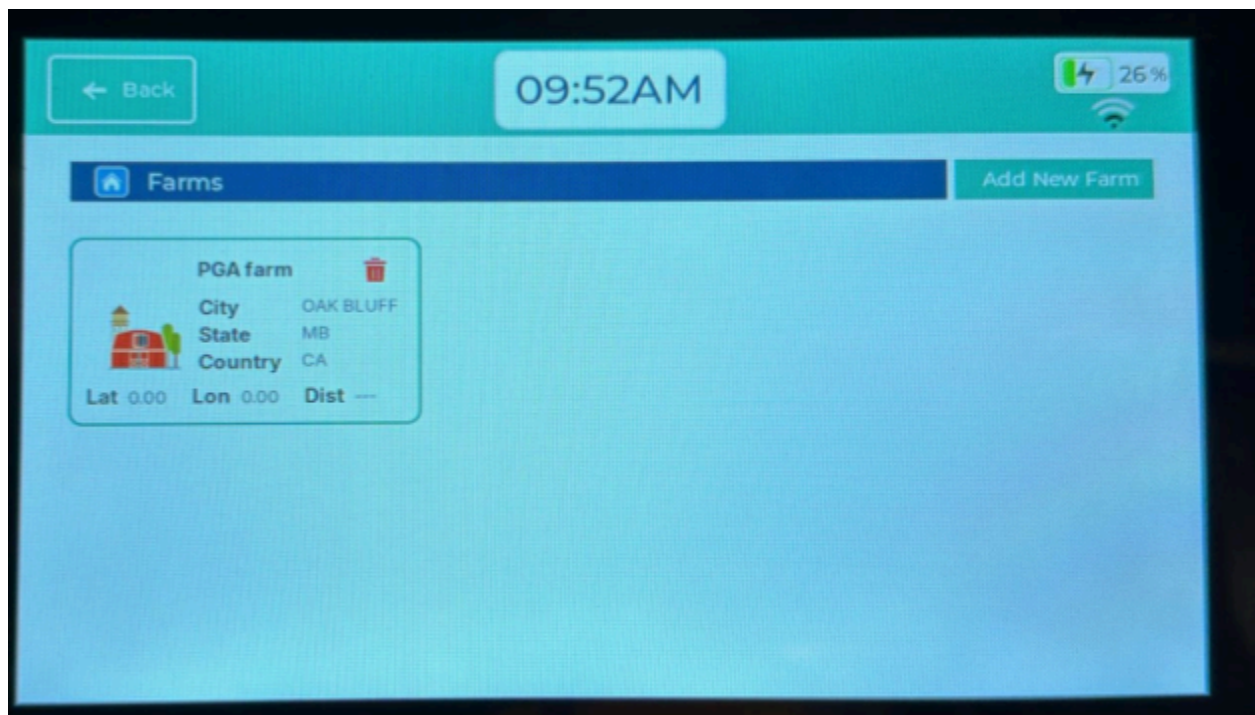
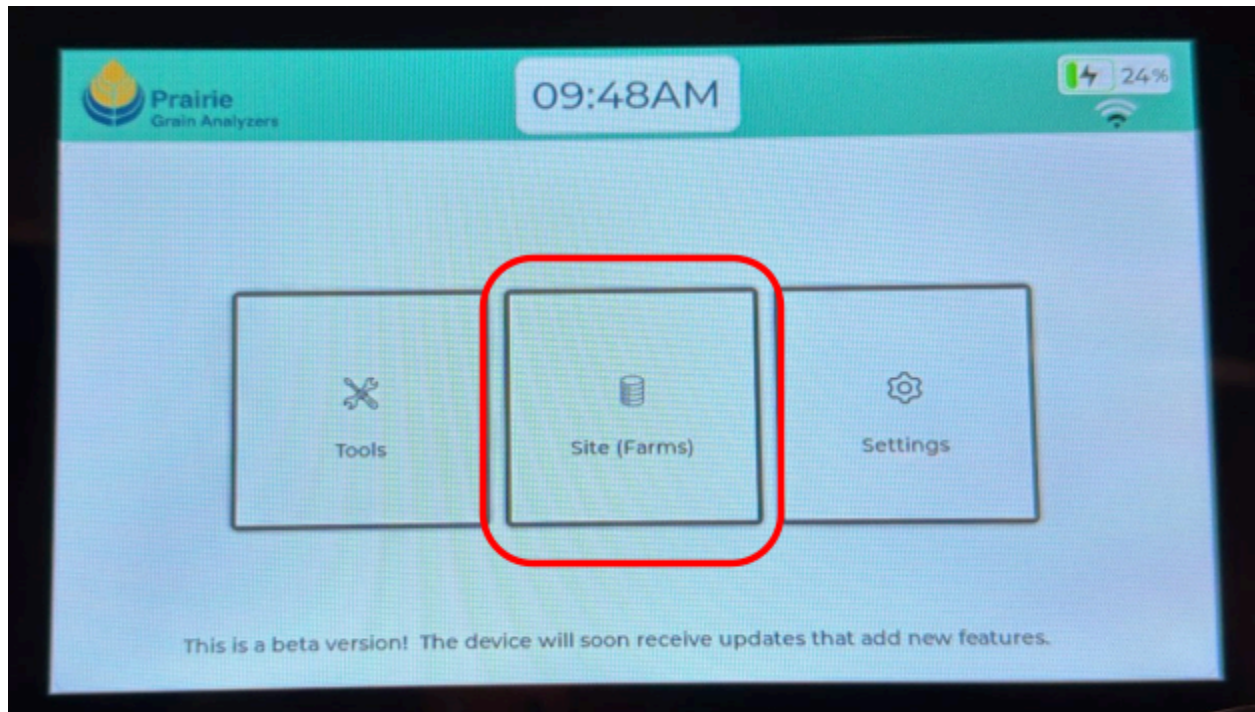

Displays the list of farms, sites, or groups of bins.

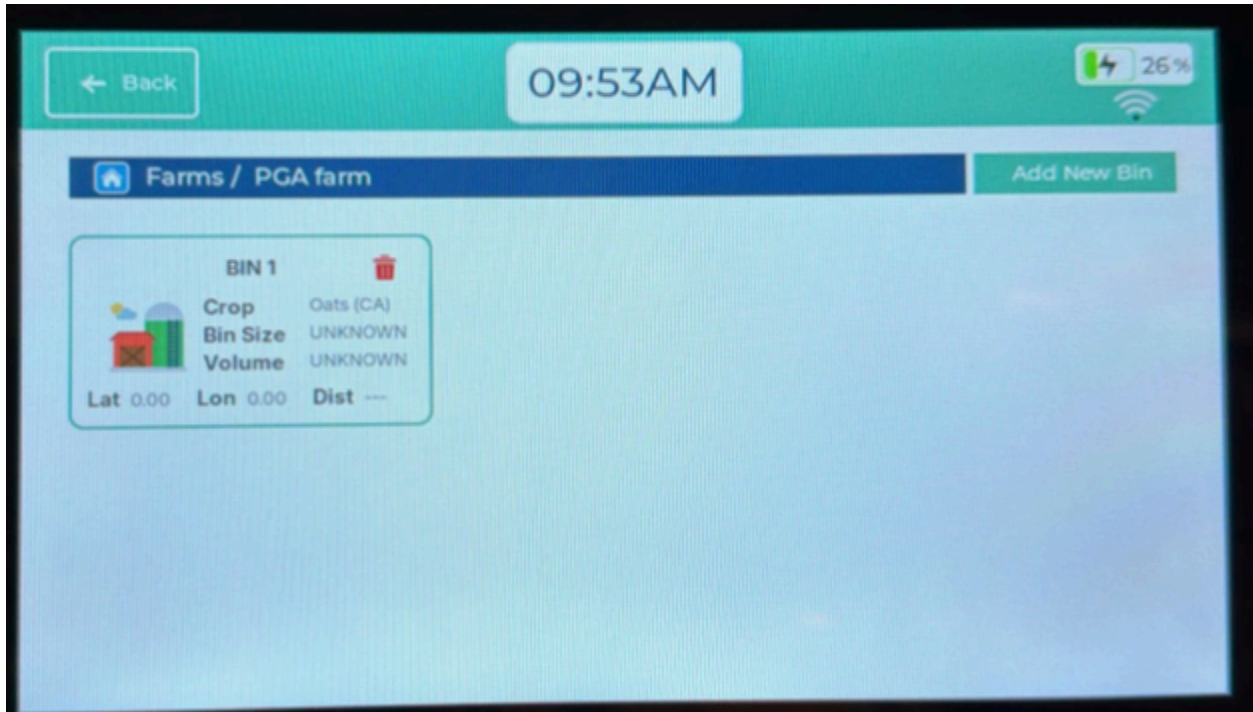

Displays the bins inside each farm.

Automatic Cable Detection

