



**SONR** **MUSIC**  
Instruction Manual

# QUICK START GUIDE

## Power ON

To turn on the device, press and hold the button for 3 sec until the LEDs are activated (—). LED animation displays the current battery level.

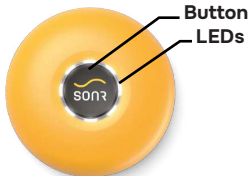

## Power OFF

To turn off, press and hold the button for 4 sec (—) until the LEDs turn off.



For the latest guides and videos visit <https://music.sonr.pro/faq> or scan the QR-code on this page.

## Playing Audio Files

To use the play/stop functions, press the button 1 time (•).

To use the next track function (go to the next audio file), press the button 2 times (••).

To use the previous track function (go to the previous audio file), press the button 3 times (•••).

To change between low and high volume, press the button 4 times (••••).

## NOTES AND WARNINGS



**Do not charge or keep the device in the sun and high temperatures.**

In case of overheating, the device will give an error code (4 flashing LEDs). In this case, unplug the charger and let SONR MUSIC cool down to room temperature before using or charging it again.



**Do not keep SONR MUSIC discharged.**

The device requires regular recharging at least once a week.



**Wipe SONR MUSIC dry after use.**

To increase the service life, it is recommended to keep the device dry.

**DO NOT PRESS ON THE SPEAKER RUBBER MEMBRANE**

**EXCESSIVE PRESSURE ON THE RUBBER MEMBRANE MAY DAMAGE THE BONE CONDUCTION SPEAKER.**



# STATUS



## **Power on**

LEDs flash clockwise and then show the charge level.



## **Power off**

LEDs light up, then half of the LEDs go out, after that LEDs flash counterclockwise.



## **Bluetooth pairing**

LEDs flash back and forth. When connected, the LEDs fill the circle.



## **Change to MP3 Mode**

LEDs light up, then half of the LEDs go out, after that the play animation is displayed.



## **Change to Bluetooth mode**

LEDs turn on, then half of the LEDs go out, after that the device search animation is displayed.

# SELECTING LISTENING MODES

## MP3

MP3 mode allows playback of songs and other audio files stored in the device's memory. Switching SONR MUSIC to MP3 mode is done by long pressing for 2 sec ( – ) and releasing when the animation starts.

The device starts playing the last listened track. In MP3 mode, audio files are played in the order they were transferred to the player. After the playlist ends, SONR MUSIC goes to the top of the list.

## Bluetooth

Bluetooth mode allows audio streaming of songs from a smartphone or other device that supports Bluetooth audio transmission.

Switching SONR MUSIC to Bluetooth mode is done by long pressing for 2 sec ( – ) and releasing when the animation starts.

After that SONR MUSIC searches and pairs with an available device.

To connect another device, turn off Bluetooth on the first paired device. The device will lose connection and return to the search mode. Pairing with a new gadget is completed when the animation stops.

Playback of audio files in Bluetooth mode is carried out by using: play / stop / next track / previous track.

## MUSIC IMPORT

SONR MUSIC supports audio files in formats: MP2, MP3, MP4, FLAC, M4A, AAC (Upon request WMA, WAV, APE can be added).

Connect SONR MUSIC to a computer. Do this with the magnetic cable that comes with the device. The removable disk “SONR MUSIC” will be displayed on the computer.

Open it to add or remove files.

**By default, there are 3 demo music files on the device.**

## GOGGLE CLIP

SONR MUSIC comes bundled with a goggle clip that can help the user attach the device to their swimmer goggles' strap. To attach the clip, remove the rubber clip from the device, place the strap over the top (button) side of the device, then push the ring over both the strap and the player.



# DESKTOP APPLICATION AND SYSTEM UPDATES

The SONR MUSIC desktop application gives the user access to settings and updates for your device.

Place the magnetic end of the cable on the SONR MUSIC charging pad. Connect the other end of the USB cable to the computer. Launch the application and update or change settings as needed.

To download the application, simply follow the link:

<https://music.sonr.pro/app>.

This will initiate the download of a zip archive. Unzip it, navigate to the SONR MUSIC App folder, and run SONR MUSIC.exe.

The application does not require installation!

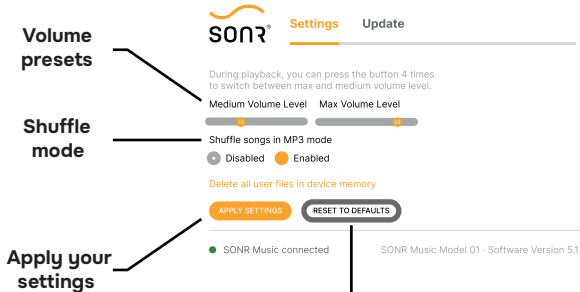

**If something goes wrong,  
just reset the settings**

Using the SONR MUSIC app is straightforward and hassle-free:

- Launch the application;
- Follow the instructions on the main screen;
- Go to the "Settings" tab;
- Configure your preferred volume level and song shuffle mode;
- Click the "Apply Settings" button. If the button becomes grayed out, it means the settings have been applied;
- If you wish to revert to the factory settings, click "Reset to defaults".



## CHARGING SONR MUSIC

Before the charging process, make sure that there is no water left on the magnetic connector. Wipe dry if necessary.

To start the charging process, place the magnetic USB cable on the corresponding magnetic connector on SONR MUSIC, and make sure that the contacts are magnetized.

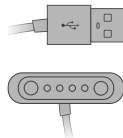

Connect the other end of the USB cable to a computer or power adapter that meets the following specifications: 5V 2A;  
When charging, LEDs flash clockwise showing the current charge level. After the battery is fully charged, all LEDs flash every 3 sec. The device is fully charged when the animation stops.

## TECHNICAL SPECIFICATIONS:

- Dimensions: 2,4 x 0,55 in (61 x 16 mm);
- Battery Life: up to 4 hours;
- Full Charge Time: up to 2 hours;
- Bluetooth audio 5.1 +BR +EDR +BLE. Supports SBC and AAC audio decoding;
- Supported File Formats: MP3, MP2, FLAC, M4A;
- Magnetic charging cable;
- LEDs indicate the battery level, power status, mode change;
- Memory: 16 GB;
- ATM5 waterproof standard.

## WARRANTY INFORMATION

SONR MUSIC is covered by warranty for 1 year after delivery of the product. The warranty is activated automatically from the day you receive the device.

**The warranty case may be considered only when complying with the following terms of use:**

- Read the instruction manual and use SONR MUSIC strictly for the intended purpose;
- Keep away from direct sunlight;
- Do not drop, avoid hitting the device;
- Do not open SONR MUSIC;
- Do not leave the device in the water unnecessarily;
- Do not wipe the device with liquids containing alcohol.

## ATTENTION!

- Do not charge SONR MUSIC when it is wet;
- Wipe dry SONR MUSIC after use;
- Be careful when transporting so as not to damage the device.

### **All rights reserved**

The image, design, trademark, name, and components that were used to manufacture the SONR MUSIC product, as well as its appearance, are protected by international intellectual property laws. The use of any of the above materials without the consent of the copyright holder will be prosecuted.