



# CSX

## Capital Program & Opportunities for Contractors and Suppliers

January 7, 2026





# LARGEST RAIL NETWORK EAST OF THE MISSISSIPPI

- CSX Network reaches **nearly two-thirds of the U.S. population**
- Approximately **20,000 route miles** across 26 states, the District of Columbia, and two Canadian provinces
- **Most advanced** intermodal terminals in North America
- **Connection to 240+** short-line partners and **70+** port terminals
- **Reliable service with transparency** through Trip Plans



# OF  
EMPLOYEES

23K+



TOTAL  
VOLUME

6.28M

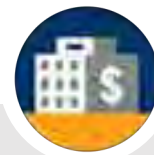

CAPITAL  
INVESTMENT

~\$2.5B

0.976  
gallon/kGTM

CSX was the first  
U.S. Class I  
railroad to cross  
this efficiency  
threshold (2024)

528  
miles

Distance CSX  
moves one ton of  
freight on a single  
gallon of fuel  
(2024)





## CREATE 75<sup>TH</sup> STREET PROJECT



- \$474 Million project to eliminate a significant bottleneck in the CSX corridor through Chicago, IL.
- Untangles an interlocking between 5 passenger and freight railroads with 106 trains per day.
- \$134M Federal INFRA grant (Trump Administration)
- **OPENED NOVEMBER 2025**



## CHICAGO CREATE P3 - 2023







## CHICAGO CREATE P3 - 2024





## CHICAGO CREATE P3 - 2025







## CHICAGO CREATE P-3 LOOKING WEST







## CHICAGO CREATE P3 – LOOKING SOUTH





## Howard Street Tunnel CIP – MD, PA, DE

- \$466M project to double-stack CSX I-95 corridor
- \$125M Federal INFRA grant
- 15 of 18 projects complete, 3 under construction
  - **Howard Street Tunnel (Oct 2025)**
  - Harford Road Bridge (March 2026)
  - North Avenue Bridge (March 2026)
- Double-stack clearance expected early Q2 2026

### BAYVIEW SOUTH STATUS



- Howard Street Tunnel
- Bridge Modifications
  - North Avenue
  - Guilford Avenue
  - Harford Road
- Track Lowering Sites
  - Mt. Royal Station
  - MTA Bridge
  - Sisson Street
  - Huntington Avenue
  - Charles Street
  - St. Paul/Calvert Street
  - Greenmount Avenue

### BAYVIEW NORTH STATUS



- Eastwick Interlocking
- Site 2: 58<sup>th</sup> Street– 68<sup>th</sup> Street
- Site 3: Boone Tunnel
- Site 4: Clifton Avenue
- Site 6: Chichester Road
- Site 7: 4th St. & Lancaster Ave.
- \*Mechanics Valley Road





# HOWARD STREET TUNNEL







## HOWARD STREET TUNNEL





## HOWARD STREET TUNNEL







# HOWARD STREET TUNNEL







## HOWARD STREET TUNNEL







## NORTH AVENUE BRIDGE



- Replace existing arch with single span, shallow girder bridge
- Required due to existing water main conflict
- Provide clearance for double stack and track profile adjustment
- Phased maintenance of traffic

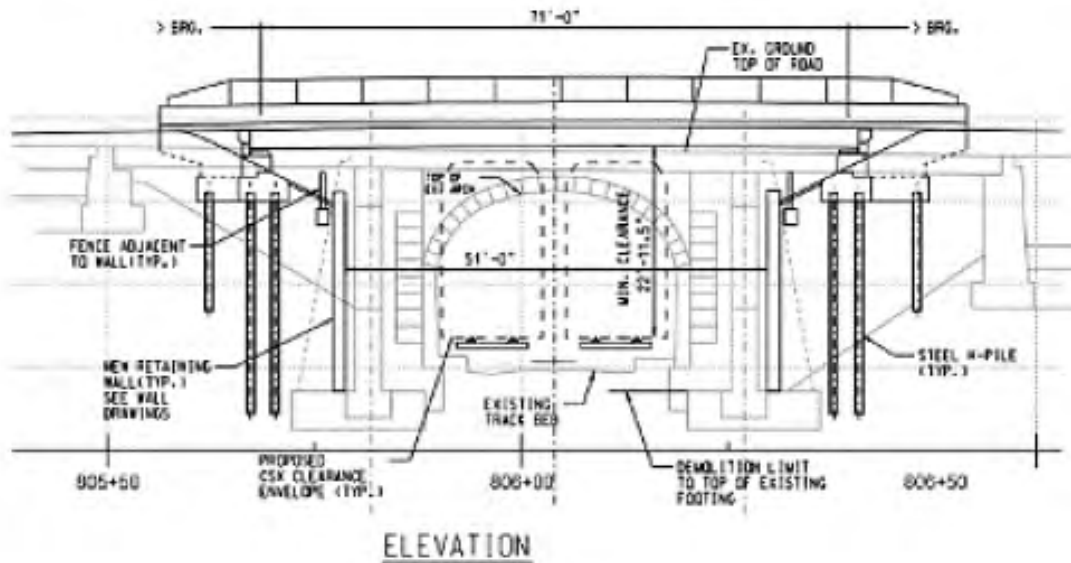



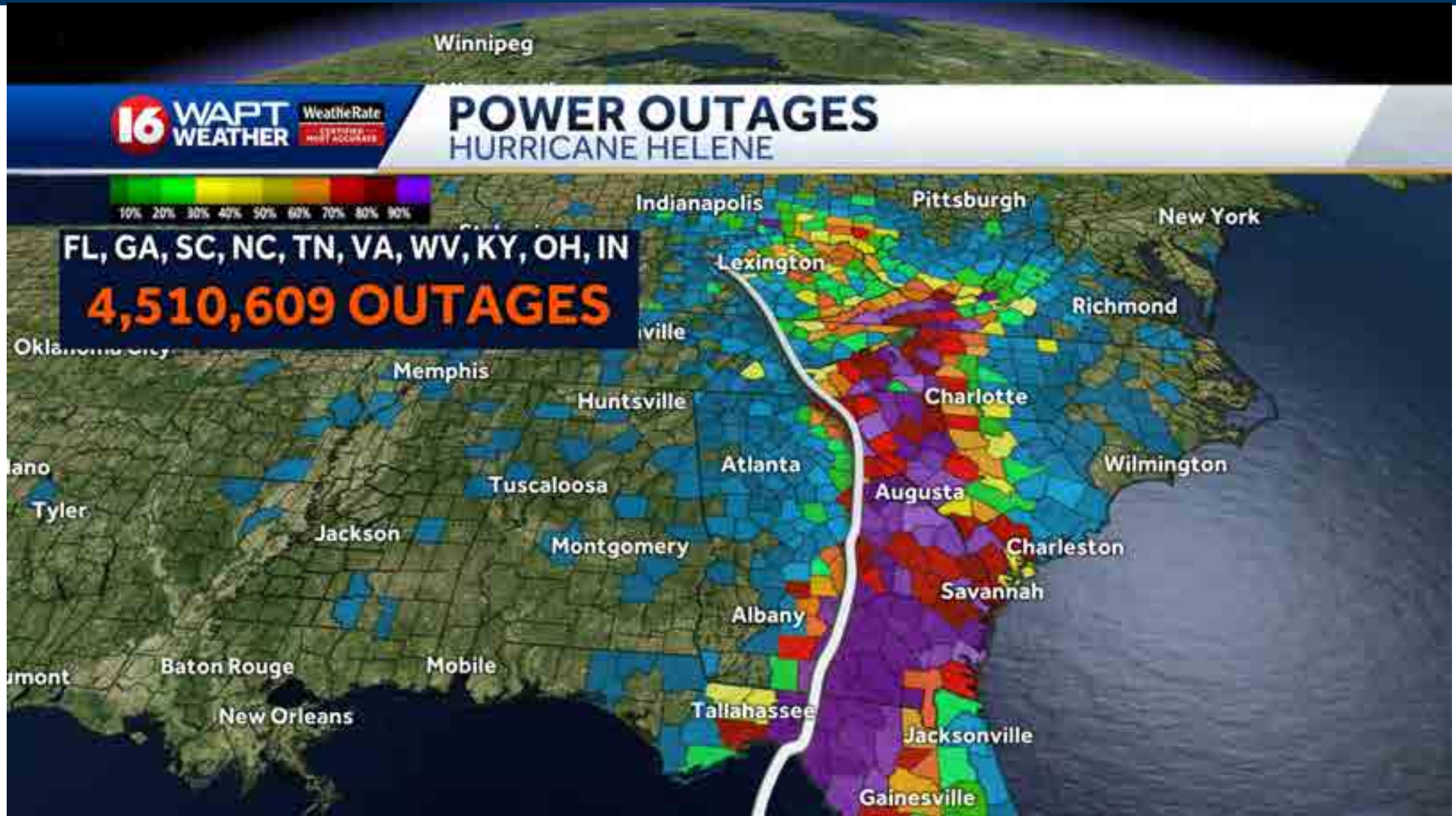





# Blue Ridge Subdivision





## COMMUNICATION & SIGNAL DAMAGE



SR-1314, MP Z-155.92, Relief, NC Crossing  
House Washed Away and Covered in Debris



Southbound Signal Cantilever, MP Z-161.02,  
Green Mountain, NC Washed Out/Destroyed





## STARTING AT THE FOUNDATION







# COMMUNICATION & SIGNAL REBUILD





## PROJECT TIMELINE

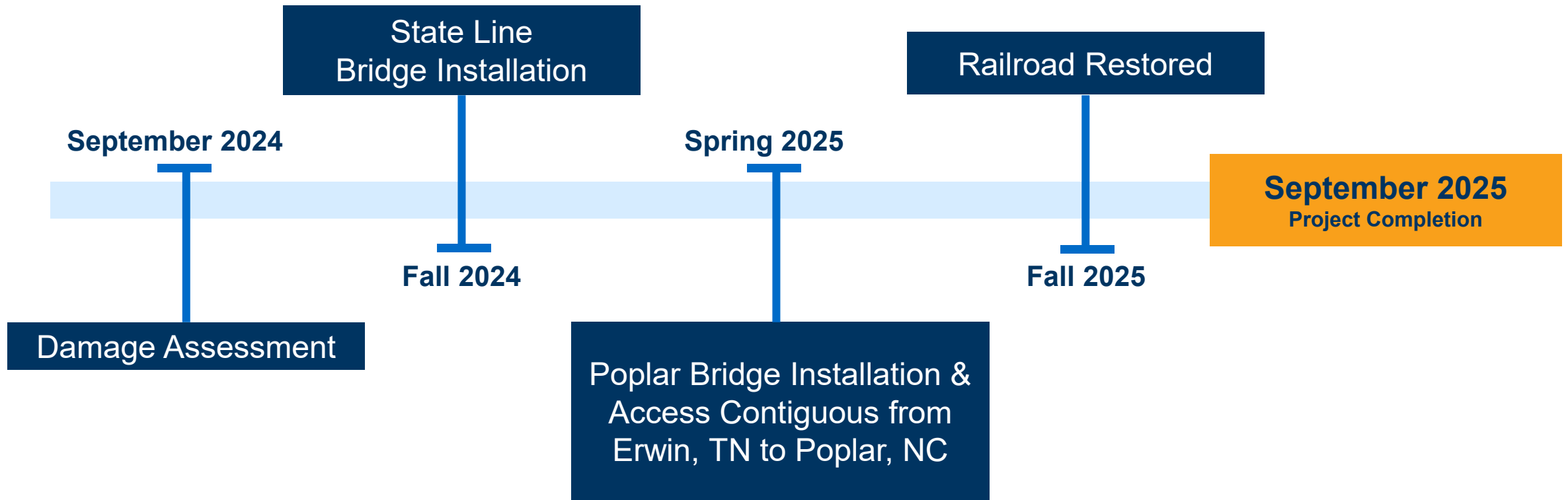





## CAPACITY PROJECTS

- Partnering with NNEPRA to add six additional miles of second main track on the Portland Subdivision in Maine.
- Fed-State Partnership Grant to install 124k ties, 1,290 switch ties, and surface 124 miles
- Partnering with Amtrak to add PTC to the Portland Sub.



NORTHERN NEW ENGLAND  
PASSENGER RAIL AUTHORITY







## NOTABLE UPCOMING COMMERCIAL PROJECTS

**NUCOR®**



**Novelis**



- CSX, VPRA, VRE, Amtrak partnering to expand passenger rail along RF&P
- Initial Program (Ph 1-2)
  - \$3.3B (2021-2030)
  - 11+ Projects
  - 39+ miles new track
- Future Phases
  - 11+ miles new track will create continuous VA owned/controlled track from DC to Spotsylvania
  - Future 3<sup>rd</sup> and 4<sup>th</sup> track from DC to NC
- Construction of early works began in mid 2024
- Alexandria 4<sup>th</sup> main roadbed and track construction contract awarded this month.

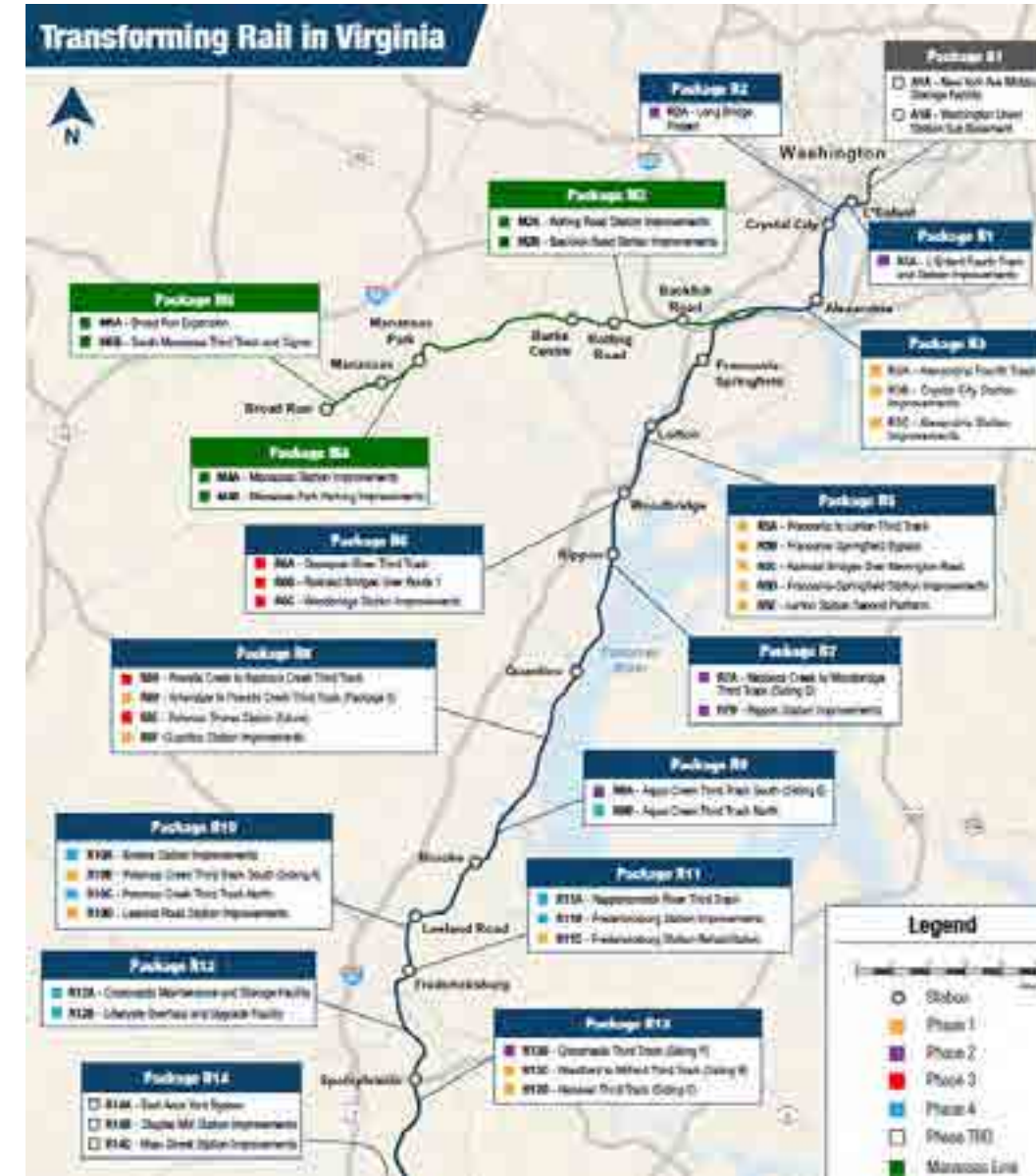



## NCDOT PARTNERSHIPS: POLKTON SIDING EXTENSION

LOCATION: Polkton, NC – Monroe Subdivision

SCOPE: Extend existing siding 5,200 feet.

TIMELINE: Completion in mid-2026.

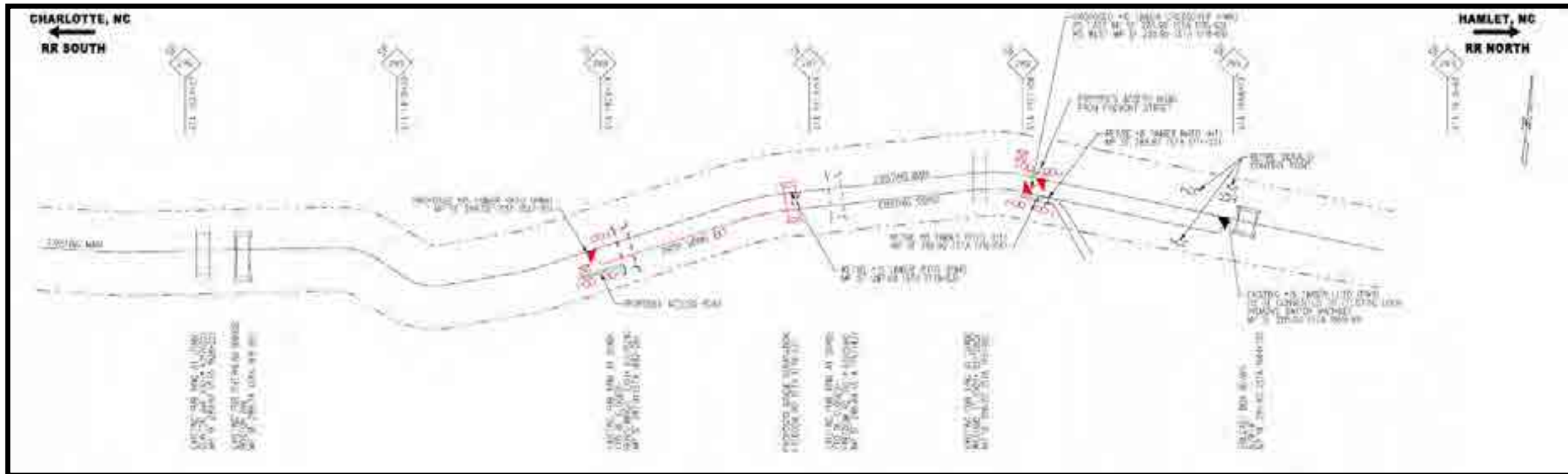





# NCDOT PARTNERSHIPS: WILMINGTON CURVE REALIGNMENT

LOCATION: Wilmington, NC – Wilmington Subdivision

SCOPE: Realign existing mainline to remove restrictive curve and allow for speed increase.

TIMELINE: Completion in mid-2026.





## JUNCTION CITY, GA

LOCATION: Junction City, GA – Fitzgerald Subdivision

SCOPE: Rebuild wye track and add siding tracks to improve network fluidity.

TIMELINE: Start construction early 2026

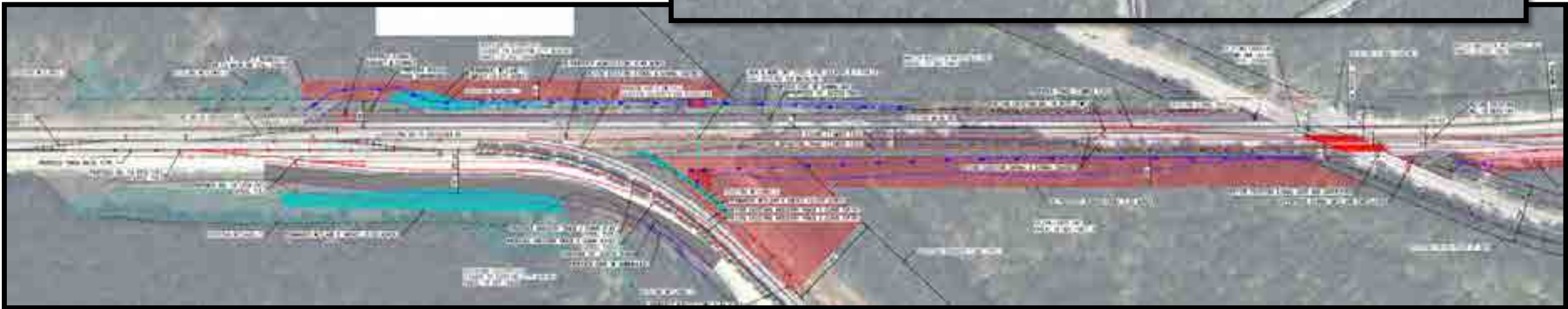







# MARTIN MARIETTA SIDING EXTENSION

LOCATION: Adairsville, GA – W&A Subdivision

SCOPE: Siding extension to 14,000 feet

TIMELINE: Design 2026. Start construction fall 2026.

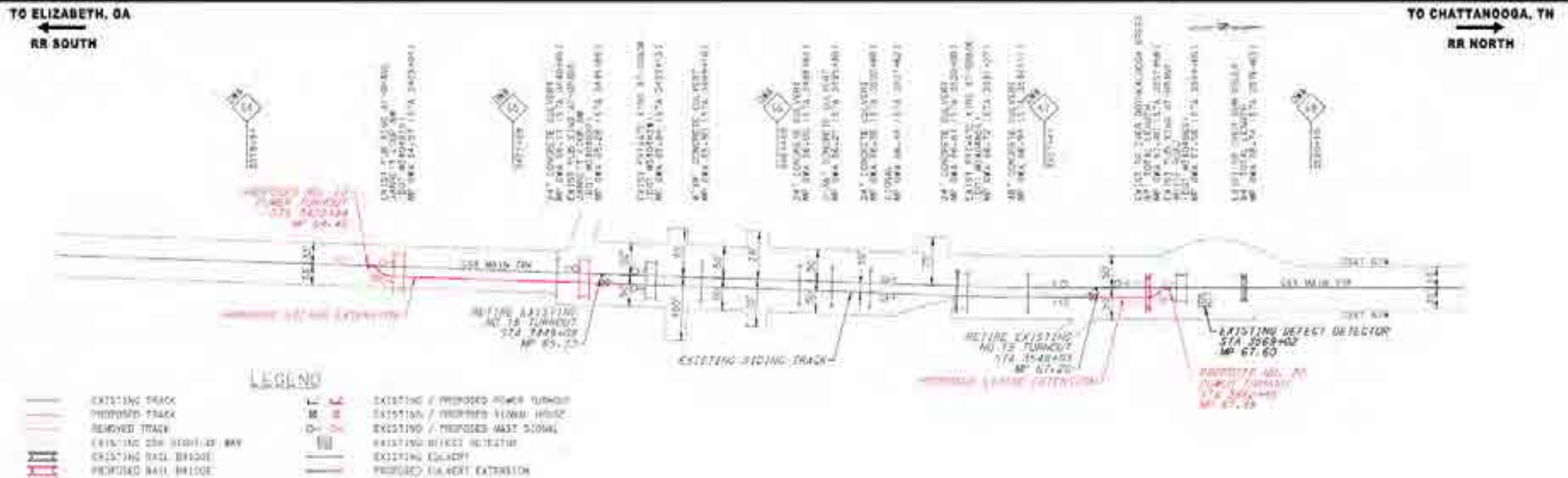



SUBSIDIARY  
TERMINAL  
TRACK  
MAINTENANCE  
PROGRAM

	Intermodal	TDSI	Transflo
Work Type	9 Terminals	5 Terminals	9 Terminals
Rail Relay	5,320 LF	10,140 LF	6,280 LF
Track Ties	13,250 EA	3,380 EA	6,460 EA
Switch Ties	1,290 EA	568 EA	750 EA
Surfacing	75,100 TF	29,100 TF	30,300 TF
Turnout Renewal	4 EA	0 EA	0 EA
Field Welds	159 EA	260 EA	36 EA
Crossing Renewal	864 TF	1,936 TF	554 TF

**CSX**