



**RECORD OF TITLE**  
**UNDER LAND TRANSFER ACT 2017**  
**FREEHOLD**  
**Search Copy**



  
R.W. Muir  
Registrar-General  
of Land

**Identifier** **OT155/225**

**Land Registration District** **Otago**

**Date Issued** 28 October 1909

**Prior References**

OT147/93

---

<b>Estate</b>	Fee Simple
<b>Area</b>	223 square metres more or less
<b>Legal Description</b>	Part Section 52-53 Block XIX City of Dunedin

**Registered Owners**

Christopher James Round and Andrea Jane Young

---

<b>Estate</b>	Fee Simple - 1/2 share
<b>Area</b>	3 square metres more or less
<b>Legal Description</b>	Part Section 52 Block XIX City of Dunedin

**Registered Owners**

Christopher James Round and Andrea Jane Young

---

**Interests**

49374 Transfer creating the following easements

Type	Servient Tenement	Easement Area	Dominant Tenement	Statutory Restriction
Party wall	Part Section 52 Block XIX City of Dunedin - CT OT155/224	Blue Transfer 49374	Part Section 52 Block XIX City of Dunedin - herein	
Drainage	Part Section 52-53 Block XIX City of Dunedin - herein	Blue line Transfer 49374	Part Section 52 Block XIX City of Dunedin - CT OT155/224	
Party wall	Part Section 52 Block XIX City of Dunedin - herein	Blue Transfer 49374	Part Section 52 Block XIX City of Dunedin - CT OT155/224	

11094780.3 Mortgage to Westpac New Zealand Limited - 1.5.2018 at 2:27 pm

EQUIVALENT MEIPI  
 AREA IS 223m<sup>2</sup>  
 53 3m<sup>2</sup>

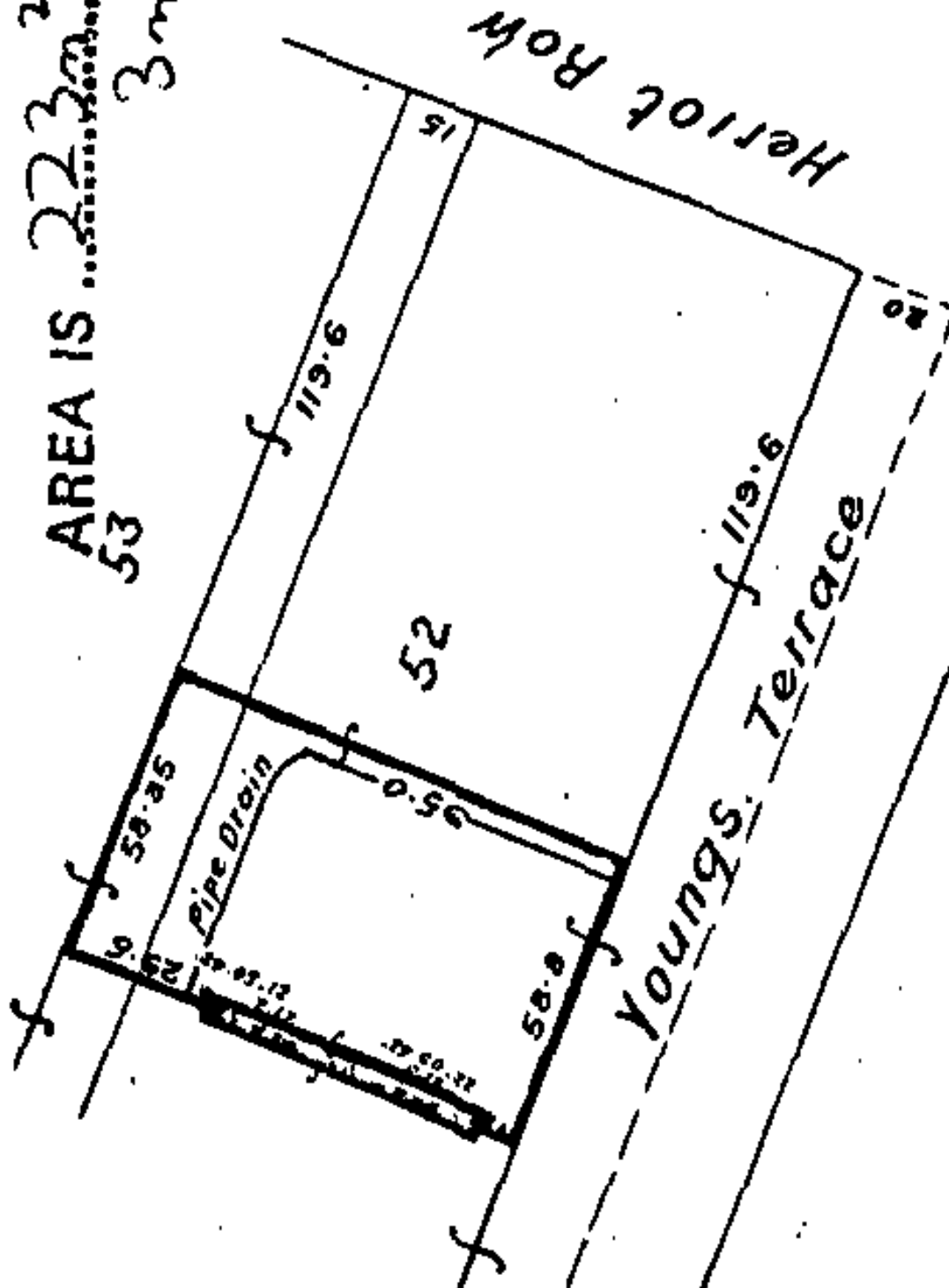

DI