



**RECORD OF TITLE  
UNDER LAND TRANSFER ACT 2017  
FREEHOLD  
Search Copy**



  
R. W. Muir  
Registrar-General  
of Land

**Identifier** OT274/190  
**Land Registration District** Otago  
**Date Issued** 20 December 1935

**Prior References**  
OT216/26

---

**Estate** Fee Simple  
**Area** 565 square metres more or less  
**Legal Description** Lot 4 Deposited Plan 3604  
**Registered Owners**  
Junghyun Shin

---

**Interests**

Subject to drainage rights over part appurtenant to Lots 1 and 2 DP 3604 created by Transfer 115982 - 20.12.1925 at 11.30 am  
3534 Order in Council imposing Building Line Restriction - 11.8.29 at 10.00 am  
10834140.4 Mortgage to Westpac New Zealand Limited - 10.7.2017 at 10:05 am

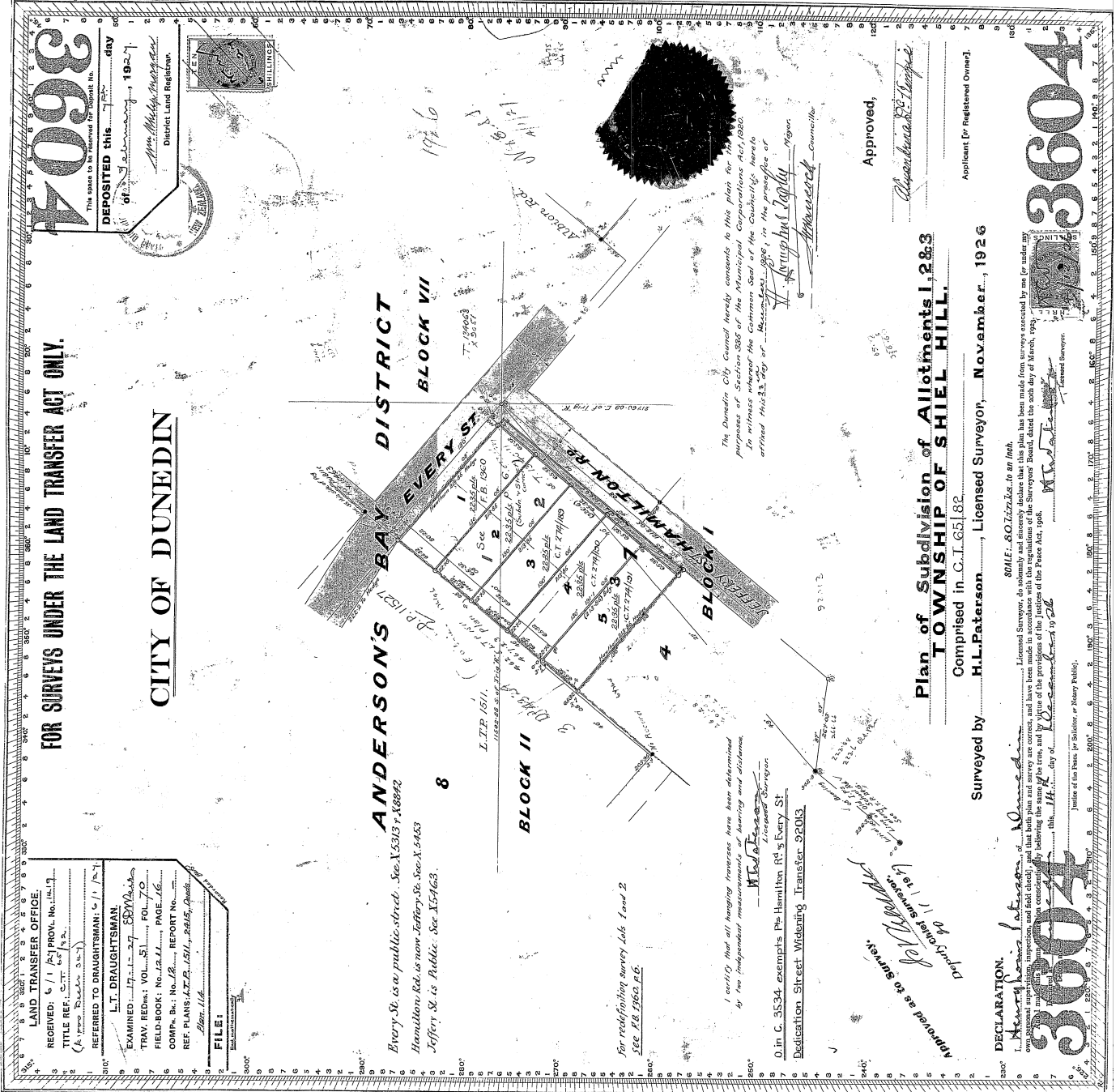

FOR SURVEYS UNDER THE LAND TRANSFER ACT ONLY.

CITY OF DUNEDIN

ANDERSON'S BAY DISTRICT  
BLOCK VII

BLOCK II

The Dunedin City Council hereby consents to this plan for the purposes of Section 385 of the Municipal Corporations Act, 1956. In witness whereof the Common Seal of the Corporation is hereunto set at Dunedin this 23rd day of November, 1926.

*H. J. Douglas* Mayor  
*H. J. Douglas* Mayor  
*H. J. Douglas* Mayor

Approved,

*H. J. Douglas*

Applicant [or Registered Owner]

Plan of Subdivision of Allotments 1, 2 & 3  
TOWNSHIP OF SHIEL HILL.

Surveyed by H.L. Paterson, Licensed Surveyor, November, 1926

SCALE: 80 Feet to an Inch

DECLARATION. I, H.L. Paterson, Licensed Surveyor, do solemnly and sincerely declare that this plan has been made from surveys executed by me [or under my own personal supervision, inspection and field check], and that both plan and survey are correct, and have been made in accordance with the regulations of the Surveyors' Board, dated the 20th day of March, 1925, and that the boundaries shown on the plan are correctly shown, and that the area of the land is correctly shown, and that the plan is a true and correct copy of the original plan, and that the plan is a true and correct copy of the original plan, and that the plan is a true and correct copy of the original plan.

3604

3604

LAND TRANSFER OFFICE.  
RECEIVED: 5/1/27 PROV. No. 1447  
TITLE REF.: C.T. 107/12  
(A. 1000 2000 3000)  
REFERRED TO DRAUGHTSMAN: 5/1/27  
L.T. DRAUGHTSMAN  
EXAMINED: 17/1/27  
TRAV. RED: VOL. 51, PAGE 70  
FIELD-BOOK: No. 1211, PAGE 16  
COMP. Bk.: No. 12, PAGE 16  
REF. PLANS: A.T.P. 1511, 2645, 2646  
FILE:

Every St. is a public street. Sec. X.5313 & X.4892  
Hamilton Rd. is now Jeffrey St. Sec. X.5443  
Jeffrey St. is Public. Sec. X.5463.

for redefining survey lots 1 and 2  
See P.B. 1922, 26.

I certify that all bearing distances have been determined by the independent measurements of bearing and distance.

*H.L. Paterson*  
H.L. Paterson

O. in C. 3534 exempts Pt Hamilton Rd's Every St  
Dedication Street Widening Transfer. 92013

Approved as to Survey  
*H.L. Paterson*  
6/21/27  
Dunedin

7093  
This plan to be returned for deposit No. 1926  
DEPOSITED this 19th day of November 1926  
*H.L. Paterson*  
District Land Registrar.