

VOX® ALCOVE TABLES

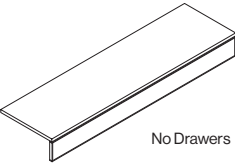

Self Edge



No Drawers

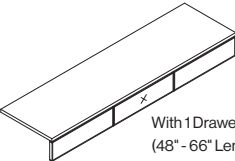

With 1 Drawer
(48" - 66" Lengths)

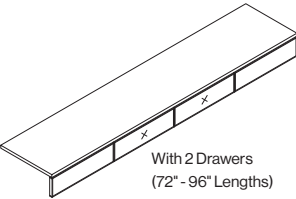

With 2 Drawers
(72" - 96" Lengths)

Model Number	L" x	D" x	H"	List Price
55331	48	20	6 ¼	1,815
55332	54	20	6 ¼	2,200
55333	60	20	6 ¼	2,470
55334	66	20	6 ¼	2,700
55335	72	20	6 ¼	2,950
55336	78	20	6 ¼	3,165
55337	84	20	6 ¼	3,400
55338	90	20	6 ¼	3,635
55339	96	20	6 ¼	3,915

55341	48	20	6 ¼	2,390
55342	54	20	6 ¼	2,780
55343	60	20	6 ¼	3,005
55344	66	20	6 ¼	3,255

55345	72	20	6 ¼	4,055
55346	78	20	6 ¼	4,295
55347	84	20	6 ¼	4,535
55348	90	20	6 ¼	4,765
55349	96	20	6 ¼	5,020

Product Description

Vox® Alcove are available in a range of sizes to meet most architectural requirements. The Vox® Alcove table has a 5" high fascia, with the option of incorporating one or two single drawers.

The Vox® style Alcove table has aluminum trim applied to the edges of the fascia and drawers. Tops are self-edged.

Drawer interior dimensions are 20" wide, 16" deep, and 2¾" high. No pull option is required to open the drawer. If a pull is desired, options are available on page 319.

Aluminum trim on the Vox Style Alcove table is available in all 5 anodized finishes. (See page 12)

All top surfaces, fascia fronts and drawer fronts are available in veneer or laminate.