

nienkämper

GATEWAY™ LOUNGE



2026

Prices include freight charges, blanket wrapped, dock delivered, from the manufacturing source to any location in the contiguous United States. Packing and/or crating are available, if required, upcharges apply.

GATEWAY™ LOUNGE

UPHOLSTERED LOUNGE ELEMENTS

Design - busk + hertzog

Upholstered Lounge Elements:

Dimensions:

- 10 basic upholstered elements make up the Gateway Lounge system.
- Convex bench element for sofa: 40"w x 24½"d x 17"h
- Convex sofa element: 40"w x 29½"d x 32"h
- Convex symmetric bench element: 40"w x 24½"d x 17"h
- Concave bench element for sofa: 41"w x 24½"d x 17"h
- Concave sofa element: 41"w x 29½"d x 32"h
- Concave symmetric bench element: 40"w x 24½"d x 17"h
- Straight bench for sofa element: 28"w x 24½"d x 17"h
- Straight sofa element: 28"w x 24½"d x 32"h
- Straight symmetric bench element: 28"w x 24½"d x 17"h
- 120° corner sofa element: 28"-48"w x 29½"d x 32"h

Fabrics:

Gateway Lounge elements are available in a range of both solid matching pattern and colors and contrasting combinations. COM is also acceptable in most cases (contact customer service for details).



Accessories:

Privacy Screens:

- Low and tall height integrated screens offer privacy and sound dampening to any convex, concave, straight & 120° corner sofa element.
- 120° corner sofa element standard has only one side with privacy screen, contact Customer Service if you require both sides with privacy screen.

Dimensions:

- Low height privacy screen: 34"h (for screen only), overall height with sofa is 44"h including 10"h overhang from floor.
- Tall height privacy screen: 49"h (for screen only), overall height with sofa is 59"h including 10"h overhang from floor.

Fabrics:

- Gateway Lounge Privacy Screens are available in COM and Knoll Textiles fabrics.



Screen Table:

- An optional, shallow 9" deep curved or straight table can be added to the low height privacy screen to allow for tiered seating and table top behind the sofa.
- 120° corner sofa element standard has only one side with screen table, contact Customer Service if you require both sides with screen table.

Dimensions:

- Convex/Concave Element: 42½"w x 9"d x ¾" thick
- Straight/120° Corner Element (one side only): 28"w x 9"d x ¾" thick

Finishes:

Top is ¾" thick with self edge available in Nienkämper standard veneers and finishes as well as plastic laminates.

Round Sofa Table:

A round table (14" dia) can also be added to any Gateway Lounge element, mounting to either front or back of the sofa or bench. The mounting bracket is silver powder coated finish as standard, other powder coat colors and chrome finish are also available with upcharge.

Dimensions:

Finishes: Tops are ¾" thick with self edge available in Nienkämper standard veneers and finishes as well as plastic laminates



UPHOLSTERY DETAILS

CUSTOMER'S OWN MATERIALS (COM):

Nienkämper reserves the right to determine the suitability of a particular COM on our furniture. If we determine, in our judgment, that the COM is inappropriate for use on a particular product we will notify the customer. If you have any questions on the appropriateness of your COM please submit a sample to Customer Service prior to your order.

KNOLLTEXTILES:

All Nienkämper seating available in fabric includes pricing for four grades of fabric, see the KnollTextiles grade columns throughout this book. All fabric orders should be made when ordering the furniture. For KnollTextiles samples contact the KnollTextiles Customer Service department at 1.866.565.5858.

All yardage requirements are noted for each model number and option, refer to the pricing charts in this book. All yardage requirements shown in our price list are based on 54" plain material. Fabrics which have a repeat that must be matched, or are less than 54" wide, will require more yardage. Check with Customer Service before ordering. There may be yardage savings for quantity orders of the same model. Check with Customer Service before ordering. ALL COM WILL BE CUT AND APPLIED AT OUR DISCRETION UNLESS SPECIAL CUTTING INSTRUCTIONS ARE INCLUDED IN WRITING WITH THE ORDER. FABRIC PATTERNS SHOULD BE IDENTIFIED AS APPLIED VERTICALLY OR HORIZONTALLY ON A FRAME. WE CANNOT BE HELD RESPONSIBLE FOR RECEIPT OF DEFECTIVE FABRIC AS WE APPLY ALL COM AS FIRST QUALITY GOODS.

Fabric	Plain	2" - 14"	15" - 24"	25" - 27"	28" - 36"
Width	Fabric	Repeat	Repeat	Repeat	Repeat
54"	0%	10%	15%	20%	25%
50"	10%	20%	25%	30%	35%
48"	15%	25%	30%	35%	40%
45"	40%	50%	55%	60%	65%
36"	50%	60%	65%	70%	75%

We cannot be held responsible if yardage supplied is insufficient to complete an order.

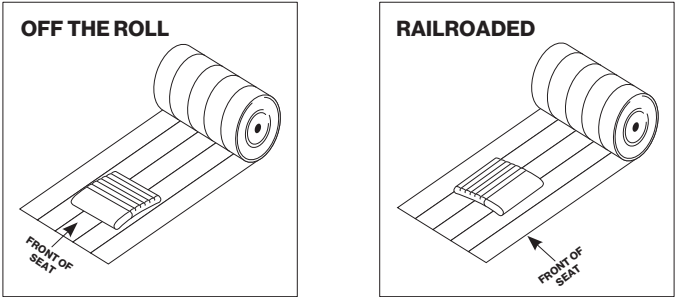

CUSTOMER'S OWN LEATHER:

All furniture listed in this price list that is available with leather has pricing in COL, refer to the COL column throughout this book. Leather is applied to avoid scars, however, some markings are inherent in this natural material. Square footage requirements are based on cow hides measuring 50 sq.ft. per hide. Consult Nienkämper's Customer Service Department for square footage requirements before ordering when using hides that do not meet these requirements. Application instructions must accompany all COL orders. In the absence of these instructions Nienkämper will determine the best method of upholstery.

SHIPPING YOUR MATERIALS:

For Canada
Customer supplied material must be sent prepaid to:

Nienkämper International, Inc.
257 Finchdene Square
Toronto, Ontario
Canada M1X 1B9

From all locations outside of Canada
Customer supplied material must be sent prepaid to:

Willson International Limited
c/o Nienkämper
257 Finchdene Square
Toronto, Ontario
Canada M1X 1B9

All packages must include a copy of a commercial invoice showing the exact yardage, value and fibre content of the fabric and must indicate our order confirmation number, or customer's purchase order number, and the furniture for which it is intended.

UPHOLSTERY DETAILS

An index of KnollTextiles fabric follows. Contact KnollTextiles customer service at 1.800.237.1625 for an updated listing. For fabric not graded in, please contact customer service for pricing.

ALPHABETICAL INDEX:

Category 1	
Fabric Name	Pattern #
Attire	466933
Boundary*	466735
Brigadoon*	466914
Chameleon*	466929
Commuter Cloth	466879
Contour*	466950
Cozy Cord*	466938
Crossroad	466672
Delite	466730
Diva	466722
Dottie	466799
Facet*	466804
Ferry	466850
Hourglass	466846
Infinite	466734
Instinct	466921
Journey	466866
Keaton	466851
Knoll Hopsack	466729
Little Devil	466916
Oh La La	466671
Olympia	466808
Plaid On*	466947
Prairie*	466762
Puff	466726
Shadow Play*	466759
Sonnet	466909
Summit	466694
Tinge*	466721
Topos*	466800
Utopia*	466867
Vast*	466945
Venue	466756
Vibe II*	466718
Westwood*	466757
Wild Thing*	466779
Winnow*	466960

Category 2	
Fabric Name	Pattern #
Atlas*	466702
Aurora, 1985	466954
Buzz	466719
Caliper*	466804
Circle Point*	466942
Cleo	466910
Code	466736
Color Field*	466712
Currents*	466951
Dactyl*	466673
Day Tripper	466913
Durand*	466895
Entwine	466937
Flower Power	466946
Greenwich*	466878
Homage*	466943
Hummingbird	466956
Island*	466765
Kiln*	466965
Knoll Felt	466830
Off the Grid	466725
Palisade*	466763
Pathway*	466941
Pico	466968
Placid*	466949
Premier*	466920
Prestini*	466953
Pullman	466917
Rebel	466922
Retreat*	466944
Seurat	466811
Smart*	466853
Tempest	466724
Utmost II	466931
Vice Versa*	466925
Whip*	466842
Woodland II*	466723
Wow Factor	466720

Category 3	
Fabric Name	Pattern #
Aegean	466769
Alter Ego	466792
Arrondissement	466711
Biscayne	466890
Cameo	466674
Circa	466753
Classic Boucle	466777
Color Collage	466716
Eclat Weave	466773
Fancy Twill	466717
Imprint	466923
In Stitches	466908
It's Complicated*	466771
Looped In	466948
Mococco, 1966	466967
Modern Tweed	466795
Nature Walk*	466770
Rivers	466806
Sherman	466841
Texnet*	466760
Vert	466955

Category 4	
Fabric Name	Pattern #
Altiplano	466974
Amore	466905
Arezzo	466776
Atelier	466882
Catwalk	466907
Chiseled	466919
Dapper	466803
Firefly	466901
Floressence	466924
In Step	466928
Rivington	466939
Stretch Appeal	466871
Striae Stripe	466930
Stripe It*	466683
Tara	466926
Ultrasuede	466793
Utrillo	466945

Not Graded In	
Fabric Name	Pattern #
Byron	466710
Cato	466862
Chic	466934
Cummings	466709
Digi Velvet	466816
Doily	466807
Dynamic	466845
Guisse	466727
Ita	466693
Knoll Velvet	466780
Limani	466906
Lowell	466707
North Island	466704
Sandis	466915

NOTE: Fabric with "*" is Bleach Cleanable with diluted household bleach.

FABRIC DETAILS

An index of KnollTextiles follows. Contact KnollTextiles customer service at 1.800.237.1625 for an updated listing. For fabric not graded in, please contact customer service for pricing.

NUMERICAL INDEX:

Category 1	
Fabric Name	Pattern #
Oh La La	466671
Crossroad	466672
Summit	466694
Vibe II*	466718
Tinge*	466721
Diva	466722
Puff	466726
Knoll Hopsack	466729
Delite	466730
Infinite	466734
Boundary*	466735
Venue	466756
Westwood*	466757
Shadow Play*	466759
Prairie*	466762
Wild Thing*	466779
Dottie	466799
Topos*	466800
Facet*	466804
Olympia	466808
Hourglass	466846
Ferry	466850
Keaton	466851
Journey	466866
Utopia*	466867
Commuter Cloth	466879
Sonnet	466909
Brigadoon*	466914
Little Devil	466916
Instinct	466921
Chameleon*	466929
Attire	466933
Cozy Cord*	466938
Vast*	466945
Plaid On*	466947
Contour*	466950
Winnow*	466960

Category 2	
Fabric Name	Pattern #
Dactyl*	466673
Atlas*	466702
Color Field*	466712
Buzz	466719
Wow Factor	466720
Woodland II*	466723
Tempest	466724
Off the Grid	466725
Code	466736
Palisade*	466763
Island*	466765
Caliper*	466804
Seurat	466811
Knoll Felt	466830
Whip*	466842
Smart*	466853
Greenwich*	466878
Durand*	466895
Cleo	466910
Day Tripper	466913
Pullman	466917
Premier*	466920
Rebel	466922
Vice Versa*	466925
Utmost II	466931
Entwine	466937
Pathway*	466941
Circle Point*	466942
Homage*	466943
Retreat*	466944
Flower Power	466946
Placid*	466949
Currents*	466951
Prestini*	466953
Aurora, 1985	466954
Hummingbird	466956
Kiln*	466965
Pico	466968

Category 3	
Fabric Name	Pattern #
Cameo	466674
Arrondissement	466711
Color Collage	466716
Fancy Twill	466717
Circa	466753
Texnet*	466760
Aegean	466769
Nature Walk*	466770
It's Complicated*	466771
Eclat Weave	466773
Classic Boucle	466777
Alter Ego	466792
Modern Tweed	466795
Rivers	466806
Sherman	466841
Biscayne	466890
In Stitches	466908
Imprint	466923
Looped In	466948
Vert	466955
Mococco, 1966	466967

Category 4	
Fabric Name	Pattern #
Stripe It*	466683
Arezzo	466776
Ultrasuede	466793
Dapper	466803
Stretch Appeal	466871
Atelier	466882
Firefly	466901
Amore	466905
Catwalk	466907
Chiseled	466919
Florescence	466924
Tara	466926
In Step	466928
Striae Stripe	466930
Rivington	466939
Utrillo	466945
Altiplano	466974

Not Graded In	
Fabric Name	Pattern #
Ita	466693
North Island	466704
Lowell LUXE	466707
Cummings	466709
Byron	466710
Guise	466727
Knoll Velvet	466780
Doily	466807
Digi Velvet	466816
Dynamic	466845
Cato	466862
Limani	466906
Sandis	466915
Chic	466934

NOTE: Fabric with "*" is Bleach Cleanable with diluted household bleach.

GATEWAY™ LOUNGE
PLAN VIEW

Gateway Lounge Elements Plan View

Convex Sofa

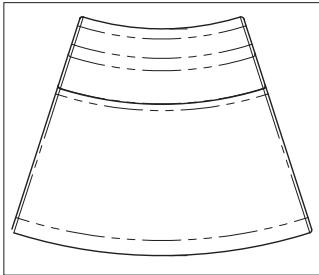

Concave Sofa

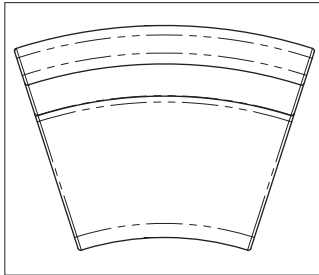

Straight Sofa

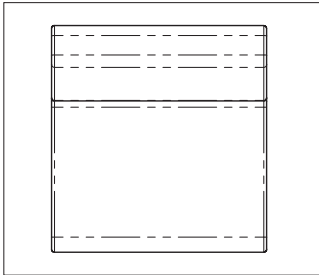

120° Corner Sofa

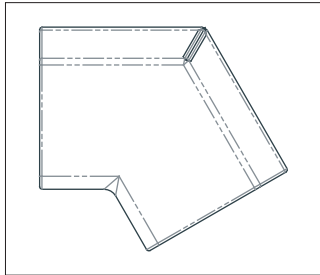

Convex Bench for Sofa

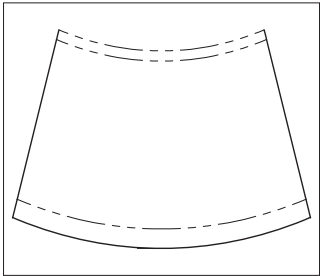

Concave Bench for Sofa

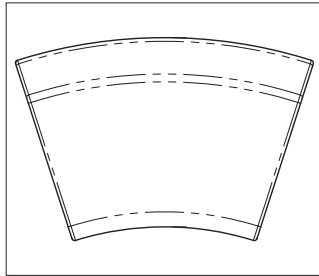

Straight Bench for Sofa

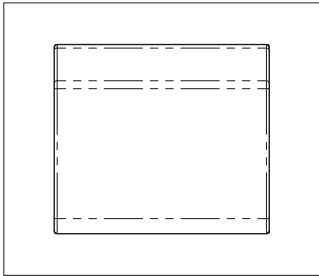

120° Corner Sofa

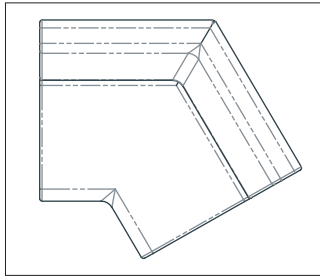

Convex Symmetric Bench

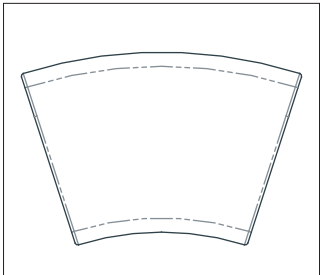

Concave Symmetric Bench

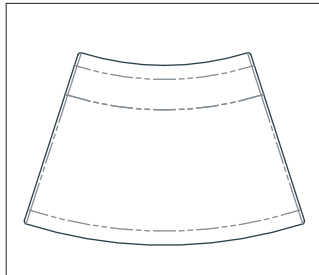

Straight Symmetric Bench

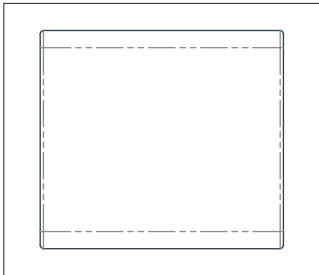

GATEWAY™ LOUNGE ELEVATION

Gateway Lounge Elements with Accessories

Side elevation shows Gateway Sofa with low height screen & 9" deep top

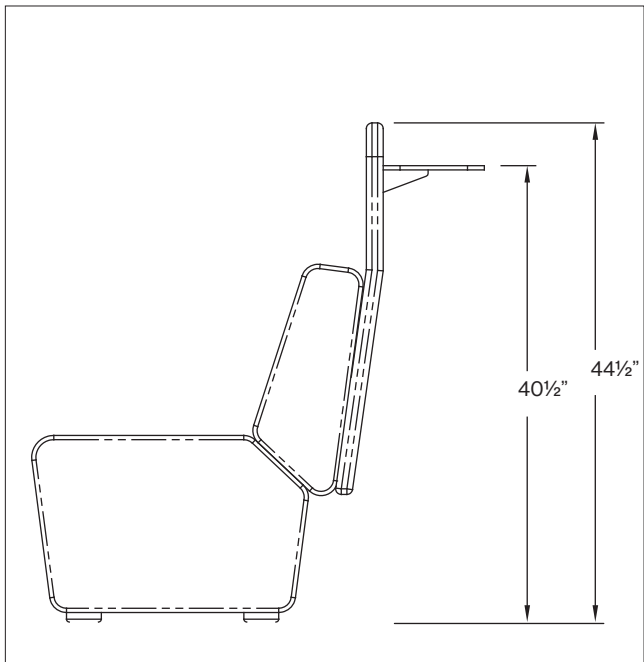

Side elevation shows Gateway Sofa with round table mounted to back

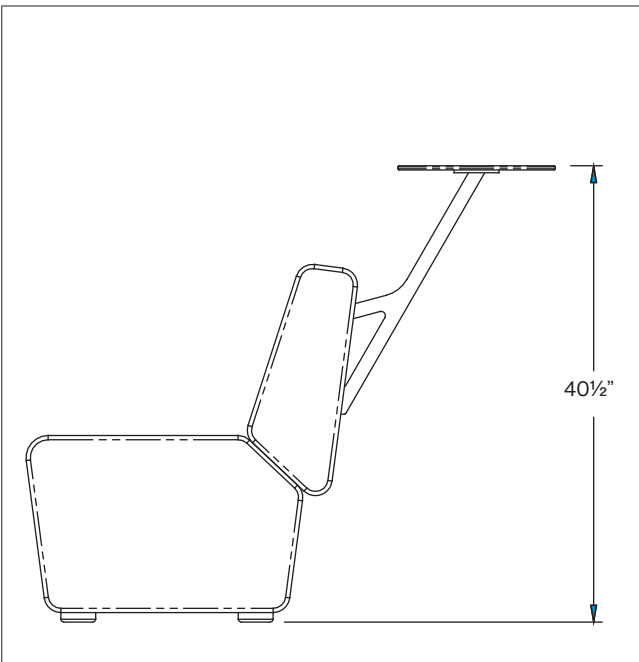

Side elevation shows Gateway Sofa with round table mounted to front

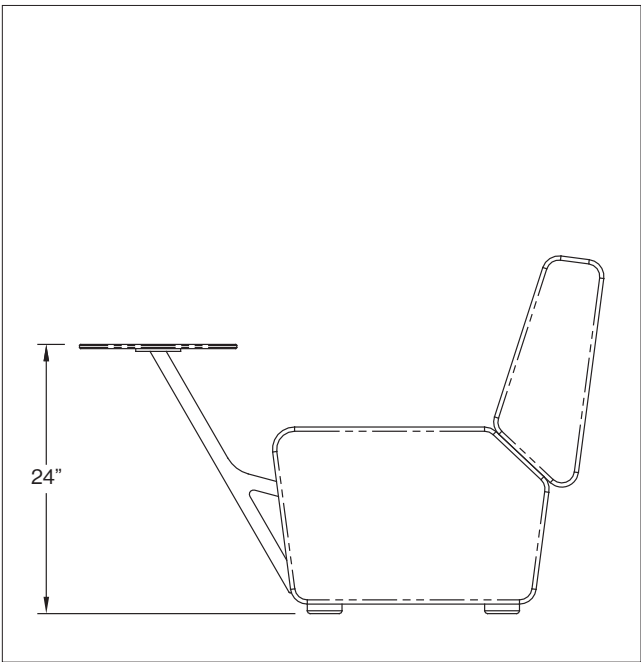

Side elevation shows Gateway Sofa with tall height screen

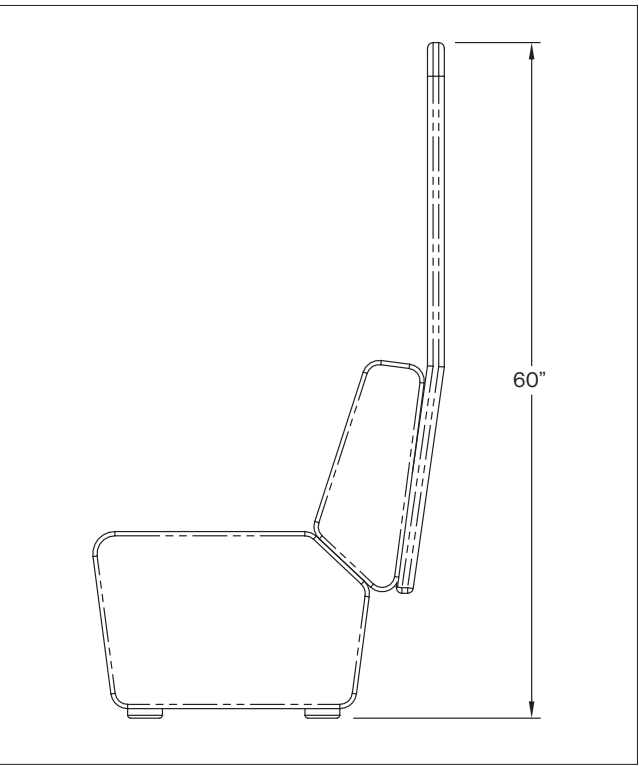

**GATEWAY™ LOUNGE
LAYOUT**

Gateway Lounge Elements Configuration

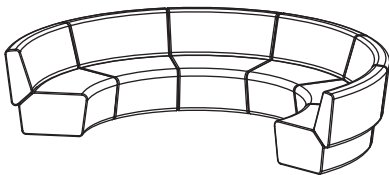
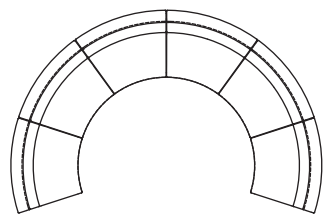

6 concave sofa elements

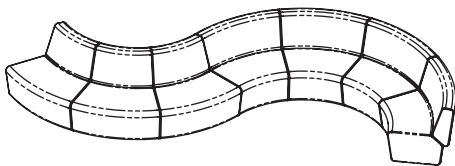
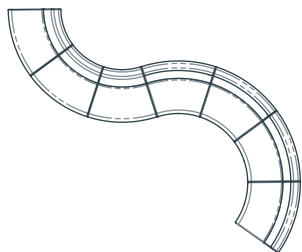

3 convex sofa elements
4 concave sofa elements

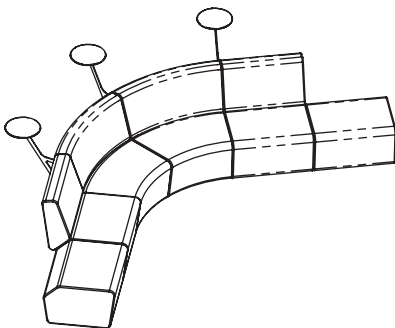
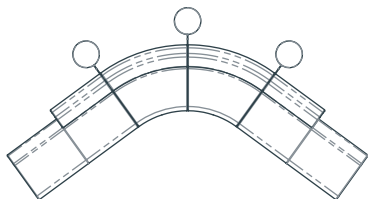

2 concave sofa elements
2 straight sofa elements
2 straight bench elements
3 round sofa tables

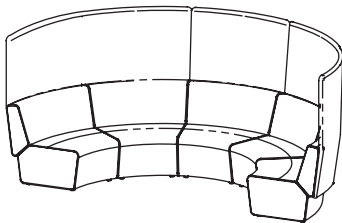
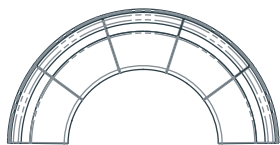

5 convex sofa elements
5 concave sofa elements

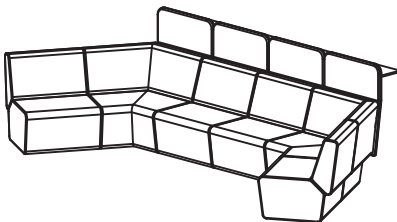
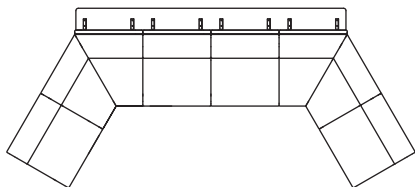





4 straight sofa elements
2 120 degree corner sofa elements
4 straight low screen with 9" deep top

GATEWAY™ LOUNGE ELEMENTS

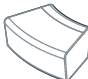
SOFA ELEMENTS

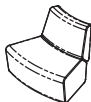
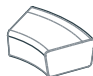
— US ONLY —

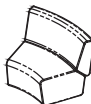





	Model	Seat				Fabric	Leather						KnollTextiles				
	Number	H"	W"	D"	H"	Yrds.	Sq. Ft.		COM	COL	Verde	Grano	Cremoso	1	2	3	4
CONVEX																	
SYMMETRIC BENCH ELEMENT																	
	11410	17	40	24 ⁵ / ₈	17	2 ¹ / ₄	108		2,590	2,720	3,685	3,940	4,340	2,855	3,030	3,240	3,445
BENCH ELEMENT FOR SOFA																	
	11411	17	40	24 ⁵ / ₈	17	2 ¹ / ₄	108		2,590	2,720	3,685	3,940	4,340	2,855	3,030	3,240	3,445
SOFA ELEMENT																	
	11412	17	40	29 ¹ / ₂	32	4 ¹ / ₂	108		4,595	4,830	6,755	7,280	8,070	5,115	5,475	5,900	6,300
CONCAVE																	
SYMMETRIC BENCH ELEMENT																	
	11420	17	28	24 ⁵ / ₈	17	2	108		2,590	2,720	3,685	3,940	4,340	2,855	3,030	3,240	3,445
BENCH ELEMENT FOR SOFA																	
	11413	17	28	24 ⁵ / ₈	17	2 ¹ / ₄	108		2,590	2,720	3,685	3,940	4,340	2,855	3,030	3,240	3,445
SOFA ELEMENT																	
	11414	17	41	29 ¹ / ₂	32	4 ¹ / ₂	108		4,595	4,830	6,755	7,280	8,070	5,115	5,475	5,900	6,300

Features:

- Gateway™ upholstered lounge elements include linear and curved modular components which enable the customer to create their own solution.
- Element styles are bench, sofa and sofa with integrated privacy screen.



GATEWAY™ LOUNGE ELEMENTS
SOFA ELEMENTS

— US ONLY —																
KnollTextiles																
	Model Number	Seat H"	W"	D"	H"	Fabric Yrds.	Leather Sq. Ft.	COM	COL	Verde	Grano	Cremoso	1	2	3	4
PRIVACY SCREEN																
	CONVEX	11421	Tall Height	42½	59	3	54	1,650	1,730	3,085	3,440	3,870	1,995	2,235	2,515	2,790
		11422	Low Height	42½	44	2	36	1,360	1,425	2,310	2,555	2,855	1,595	1,750	1,940	2,125
		11423	Low Height with 9" deep shelf	42½	44	2	36	1,940	2,040	2,920	3,165	3,475	2,170	2,330	2,515	2,700
CONCAVE																
		11424	Tall Height	42½	59	3	54	1,650	1,730	3,085	3,440	3,870	1,995	2,235	2,515	2,790
		11425	Low Height	42½	44	2	36	1,360	1,425	2,310	2,555	2,855	1,595	1,750	1,940	2,125
		11426	Low Height with 9" deep top	42½	44	2	36	1,940	2,040	2,920	3,165	3,475	2,170	2,330	2,515	2,700
STRAIGHT (for straight or 120° corner element)																
  		11427	Tall Height	28	59	3	54	1,195	1,255	2,610	2,955	3,430	1,540	1,775	2,060	2,335
		11428	Low Height	28	44	2	36	1,080	1,135	2,035	2,260	2,580	1,310	1,465	1,655	1,840
		11429	Low Height with 9" deep top	28	44	2	36	1,490	1,560	2,465	2,685	3,000	1,720	1,875	2,065	2,250
ROUND SOFA TABLE																
		11431		14 dia.				1,505								

- Feature:
- Privacy screens can be contrasting or matching fabrics
 - Table top is ¾" thick Self edge available in Nienkämper veneers & P-lam.

TERMS AND CONDITIONS OF SALE

PRICES

All prices are list prices, freight included, blanket-wrapped, dock delivered, from the manufacturing source to any location in the contiguous United States.

Brokerage is paid by Nienkämper for product shipped to the United States.

Due to existing conditions in regard to cost of labor and materials, we reserve the right to change prices without notice.

TERMS

Net 30 days from date of invoice to accredited buyers. Two per cent (2%) interest charged monthly on overdue accounts. Deposit of 50% is required with order. Terms will be established upon credit evaluation. Due to delays in processing references, first orders may be treated as C.B.D. orders.

ORDER CONFIRMATION

Orders are accepted upon issuance of our order confirmation and are subject to the terms set forth therein; notwithstanding any variance from the terms of the buyer's order form.

Nienkämper is not liable for any delay or failure to deliver caused by labor or transportation difficulties, accidents, acts of God, failure of sources of supply, or other causes beyond our control, and changes will affect the delivery date.

CHANGE OF ORDERS OR CANCELLATIONS

Changes or cancellations are subject to our ability to conform. A charge will be levied against cancelled or changed orders based on costs already incurred by Nienkämper. All changes must be in writing and submitted on a revised purchase order. Changes will affect the delivery date.

STORAGE

If goods cannot be accepted when ready, we may transfer them to storage (which is to be deemed as delivery for invoice purposes). The customer accepts risks and will be charged at prevailing rates.

FREIGHT

Prices include freight charges, blanket-wrapped, dock delivered, from the manufacturing source to any location in the contiguous United States. Packing and/or crating are available, if required, upcharges apply.

CLAIMS

All furniture is given to the carrier and signed for in good condition. It is the responsibility of the receiver to sign for the goods in the presence of the carrier and note the condition in which they are received. Freight claims should be filed with the carrier.

WARRANTY

There are no express or implied warranties, conditions and obligations of the manufacturer, whether statutory or otherwise that extend beyond the description on the face hereof. Our furniture is made to the highest standard and is warranted free from defects of material and workmanship for five years from the date of delivery. During the warranty period we will repair or replace such merchandise as shall prove to be defective, during normal usage in accordance with manufacturer's specifications. The manufacturer shall not be liable for defect wholly attributable to normal manufacturing process. Replacement or repair of the Product shall be the sole remedy of the Customer, and the manufacturer shall not be liable for any direct, indirect, incidental, or consequential loss or damage suffered by the Customer by reason of any defect in workmanship or manufacture of the Product or inability to use the Product. Moreover, this warranty does not cover accidental damage, abuse, alteration, ordinary wear and tear of Goods, negligence and misuse nor variations over which we have no control such as heat or humidity or damage to which the Goods are connected that is not attributable to the failure of the goods themselves. This warranty is null and void when the product is installed with hardware other than that supplied and/or when installed differently than recommended in the installation guide. Modification to the product or hardware may result in failure of the product and cause damage and/or injury.

WOOD FINISHES

Nienkämper offers a wide variety of standard light finishes on cherry, mahogany and figured anagré wood veneers, and a clear natural finish on figured anagré, figured sycamore, maple, bird's eye maple and curly maple.

Light finishes do not mask the grain and other characteristics of each wood species. It is important to understand that pieces of the same type of wood will not look identical when a light finish is used. The appearance of the finish will also depend on the natural color of the veneer. Cherry darkens over time as the wood ages. Pin knots and gum pockets are inherent traits.

Wood is a naturally variable raw material; its variances are not within the furniture manufacturer's control and are therefore not considered defects under this warranty.