

# nienkämper

## **GATEWAY™** LOUNGE



**2026**

Prices shown are List Prices, FOB our Toronto  
Factory- freight charges are extra. Packing and/  
or crating is available, if required, upcharges apply.

# GATEWAY™ LOUNGE

## UPHOLSTERED LOUNGE ELEMENTS

Design - busk + hertzog

### Upholstered Lounge Elements:

#### Dimensions:

- 10 basic upholstered elements make up the Gateway Lounge system.
- Convex bench element for sofa: 40"w x 24½"d x 17"h
- Convex sofa element: 40"w x 29½"d x 32"h
- Convex symmetric bench element: 40"w x 24½"d x 17"h
- Concave bench element for sofa: 41"w x 24½"d x 17"h
- Concave sofa element: 41"w x 29½"d x 32"h
- Concave symmetric bench element: 40"w x 24½"d x 17"h
- Straight bench for sofa element: 28"w x 24½"d x 17"h
- Straight sofa element: 28"w x 24½"d x 32"h
- Straight symmetric bench element: 28"w x 24½"d x 17"h
- 120° corner sofa element: 28"-48"w x 29½"d x 32"h

#### Fabrics:

Gateway Lounge elements are available in a range of both solid matching pattern and colors and contrasting combinations. COM is also acceptable in most cases (contact customer service for details).



### Accessories:

#### Privacy Screens:

- Low and tall height integrated screens offer privacy and sound dampening to any convex, concave, straight & 120° corner sofa element.
- 120° corner sofa element standard has only one side with privacy screen, contact Customer Service if you require both sides with privacy screen.

#### Dimensions:

- Low height privacy screen: 34"h (for screen only), overall height with sofa is 44"h including 10"h overhang from floor.
- Tall height privacy screen: 49"h (for screen only), overall height with sofa is 59"h including 10"h overhang from floor.

#### Fabrics:

- Gateway Lounge Privacy Screens are available in COM and Knoll Textiles fabrics.



### Screen Table:

- An optional, shallow 9" deep curved or straight table can be added to the low height privacy screen to allow for tiered seating and table top behind the sofa.
- 120° corner sofa element standard has only one side with screen table, contact Customer Service if you require both sides with screen table.

#### Dimensions:

- Convex/Concave Element: 42½"w x 9"d x ¾" thick
- Straight/120° Corner Element (one side only): 28"w x 9"d x ¾" thick

#### Finishes:

Top is ¾" thick with self edge available in Nienkämper standard veneers and finishes as well as plastic laminates.

### Round Sofa Table:

A round table (14" dia) can also be added to any Gateway Lounge element, mounting to either front or back of the sofa or bench. The mounting bracket is silver powder coated finish as standard, other powder coat colors and chrome finish are also available with upcharge.

**Dimensions:** 14" dia x ¾" thick

**Finishes:** Tops are ¾" thick with self edge available in Nienkämper standard veneers and finishes as well as plastic laminates



GATEWAY™ COLLECTION - UPHOLSTERY DETAILS

**CUSTOMER'S OWN MATERIALS (COM):** Nienkämper reserves the right to determine the suitability of a particular COM on our furniture. If we determine, in our judgment, that the COM is inappropriate for use on a particular product we will notify the customer. If you have any questions on the appropriateness of your COM please submit a sample to Customer Service prior to your order.

**KNOLL TEXTILES:** All Nienkämper seating available in fabric includes pricing for four grades of fabric, see the Knoll Textiles grade columns throughout this book. All fabric orders should be made when ordering the furniture. For Knoll Textiles samples contact the Knoll Textiles Customer Service department at 1.866.565.5858.

All yardage requirements are noted for each model number and option, refer to the pricing charts in this book. All yardage requirements shown in our price list are based on 54" plain material. Fabrics which have a repeat that must be matched, or are less than 54" wide, will require more yardage. Check with Customer Service before ordering. There may be yardage savings for quantity orders of the same model. Check with Customer Service before ordering. ALL COM WILL BE CUT AND APPLIED AT OUR DISCRETION UNLESS SPECIAL CUTTING INSTRUCTIONS ARE INCLUDED IN WRITING WITH THE ORDER. FABRIC PATTERNS SHOULD BE IDENTIFIED AS APPLIED VERTICALLY OR HORIZONTALLY ON A FRAME. WE CANNOT BE HELD RESPONSIBLE FOR RECEIPT OF DEFECTIVE FABRIC AS WE APPLY ALL COM AS FIRST QUALITY GOODS.

| Fabric | Plain  | 2" - 14" | 15" - 24" | 25" - 27" | 28" - 36" |
|--------|--------|----------|-----------|-----------|-----------|
| Width  | Fabric | Repeat   | Repeat    | Repeat    | Repeat    |
| 54"    | 0%     | 10%      | 15%       | 20%       | 25%       |
| 50"    | 10%    | 20%      | 25%       | 30%       | 35%       |
| 48"    | 15%    | 25%      | 30%       | 35%       | 40%       |
| 45"    | 40%    | 50%      | 55%       | 60%       | 65%       |
| 36"    | 50%    | 60%      | 65%       | 70%       | 75%       |

We cannot be held responsible if yardage supplied is insufficient to complete an order.

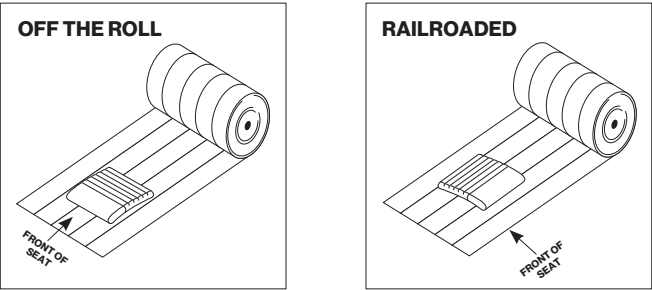

**CUSTOMER'S OWN LEATHER:** All furniture listed in this price list that is available with leather has pricing in COL, refer to the COL column throughout this book. Leather is applied to avoid scars, however, some markings are inherent in this natural material. Square footage requirements are based on cow hides measuring 50 sq.ft. per hide. Consult Nienkämper's Customer Service Department for square footage requirements before ordering when using hides that do not meet these requirements. Application instructions must accompany all COL orders. In the absence of these instructions Nienkämper will determine the best method of upholstery.

|                              |  |   |
|------------------------------|--|---|
| <b>FOR YOUR INFORMATION:</b> | For Canada   | From all locations outside of Canada  |
|                              | Customer supplied material must be sent prepaid to:  | Customer supplied material must be sent prepaid to:   |
|                              | Nienkämper International, Inc.<br>257 Finchdene Square<br>Toronto, Ontario<br>Canada M1X 1B9 | Willson International Limited<br>c/o Nienkämper<br>257 Finchdene Square<br>Toronto, Ontario<br>Canada M1X 1B9 |

All packages must include a copy of a commercial invoice showing the exact yardage, value and fibre content of the fabric and must indicate our order confirmation number, or customer's purchase order number, and the furniture for which it is intended.

# UPHOLSTERY DETAILS

An index of KnollTextiles fabric follows. Contact KnollTextiles customer service at 1.800.237.1625 for an updated listing. For fabric not graded in, please contact customer service for pricing.

## ALPHABETICAL INDEX:

| Category 1     |           |
|----------------|-----------|
| Fabric Name    | Pattern # |
| Attire         | 466933    |
| Boundary*      | 466735    |
| Brigadoon*     | 466914    |
| Chameleon*     | 466929    |
| Commuter Cloth | 466879    |
| Contour*       | 466950    |
| Cozy Cord*     | 466938    |
| Crossroad      | 466672    |
| Delite         | 466730    |
| Diva           | 466722    |
| Dottie         | 466799    |
| Facet*         | 466804    |
| Ferry          | 466850    |
| Hourglass      | 466846    |
| Infinite       | 466734    |
| Instinct       | 466921    |
| Journey        | 466866    |
| Keaton         | 466851    |
| Knoll Hopsack  | 466729    |
| Little Devil   | 466916    |
| Oh La La       | 466671    |
| Olympia        | 466808    |
| Plaid On*      | 466947    |
| Prairie*       | 466762    |
| Puff           | 466726    |
| Shadow Play*   | 466759    |
| Sonnet         | 466909    |
| Summit         | 466694    |
| Tinge*         | 466721    |
| Topos*         | 466800    |
| Utopia*        | 466867    |
| Vast*          | 466945    |
| Venue          | 466756    |
| Vibe II*       | 466718    |
| Westwood*      | 466757    |
| Wild Thing*    | 466779    |
| Winnow*        | 466960    |

| Category 2    |           |
|---------------|-----------|
| Fabric Name   | Pattern # |
| Atlas*        | 466702    |
| Aurora, 1985  | 466954    |
| Buzz          | 466719    |
| Caliper*      | 466804    |
| Circle Point* | 466942    |
| Cleo          | 466910    |
| Code          | 466736    |
| Color Field*  | 466712    |
| Currents*     | 466951    |
| Dactyl*       | 466673    |
| Day Tripper   | 466913    |
| Durand*       | 466895    |
| Entwine       | 466937    |
| Flower Power  | 466946    |
| Greenwich*    | 466878    |
| Homage*       | 466943    |
| Hummingbird   | 466956    |
| Island*       | 466765    |
| Kiln*         | 466965    |
| Knoll Felt    | 466830    |
| Off the Grid  | 466725    |
| Palisade*     | 466763    |
| Pathway*      | 466941    |
| Pico          | 466968    |
| Placid*       | 466949    |
| Premier*      | 466920    |
| Prestini*     | 466953    |
| Pullman       | 466917    |
| Rebel         | 466922    |
| Retreat*      | 466944    |
| Seurat        | 466811    |
| Smart*        | 466853    |
| Tempest       | 466724    |
| Utmost II     | 466931    |
| Vice Versa*   | 466925    |
| Whip*         | 466842    |
| Woodland II*  | 466723    |
| Wow Factor    | 466720    |

| Category 3        |           |
|-------------------|-----------|
| Fabric Name       | Pattern # |
| Aegean            | 466769    |
| Alter Ego         | 466792    |
| Arrondissement    | 466711    |
| Biscayne          | 466890    |
| Cameo             | 466674    |
| Circa             | 466753    |
| Classic Boucle    | 466777    |
| Color Collage     | 466716    |
| Eclat Weave       | 466773    |
| Fancy Twill       | 466717    |
| Imprint           | 466923    |
| In Stitches       | 466908    |
| It's Complicated* | 466771    |
| Looped In         | 466948    |
| Mococco, 1966     | 466967    |
| Modern Tweed      | 466795    |
| Nature Walk*      | 466770    |
| Rivers            | 466806    |
| Sherman           | 466841    |
| Texnet*           | 466760    |
| Vert              | 466955    |

| Category 4     |           |
|----------------|-----------|
| Fabric Name    | Pattern # |
| Altiplano      | 466974    |
| Amore          | 466905    |
| Arezzo         | 466776    |
| Atelier        | 466882    |
| Catwalk        | 466907    |
| Chiseled       | 466919    |
| Dapper         | 466803    |
| Firefly        | 466901    |
| Floressence    | 466924    |
| In Step        | 466928    |
| Rivington      | 466939    |
| Stretch Appeal | 466871    |
| Striae Stripe  | 466930    |
| Stripe It*     | 466683    |
| Tara           | 466926    |
| Ultrasuede     | 466793    |
| Utrillo        | 466945    |

| Not Graded In |           |
|---------------|-----------|
| Fabric Name   | Pattern # |
| Byron         | 466710    |
| Cato          | 466862    |
| Chic          | 466934    |
| Cummings      | 466709    |
| Digi Velvet   | 466816    |
| Doily         | 466807    |
| Dynamic       | 466845    |
| Guisse        | 466727    |
| Ita           | 466693    |
| Knoll Velvet  | 466780    |
| Limani        | 466906    |
| Lowell        | 466707    |
| North Island  | 466704    |
| Sandis        | 466915    |

NOTE: Fabric with "\*" is Bleach Cleanable with diluted household bleach.

## FABRIC DETAILS

An index of KnollTextiles follows. Contact KnollTextiles customer service at 1.800.237.1625 for an updated listing. For fabric not graded in, please contact customer service for pricing.

### NUMERICAL INDEX:

| Category 1     |           |
|----------------|-----------|
| Fabric Name    | Pattern # |
| Oh La La       | 466671    |
| Crossroad      | 466672    |
| Summit         | 466694    |
| Vibe II*       | 466718    |
| Tinge*         | 466721    |
| Diva           | 466722    |
| Puff           | 466726    |
| Knoll Hopsack  | 466729    |
| Delite         | 466730    |
| Infinite       | 466734    |
| Boundary*      | 466735    |
| Venue          | 466756    |
| Westwood*      | 466757    |
| Shadow Play*   | 466759    |
| Prairie*       | 466762    |
| Wild Thing*    | 466779    |
| Dottie         | 466799    |
| Topos*         | 466800    |
| Facet*         | 466804    |
| Olympia        | 466808    |
| Hourglass      | 466846    |
| Ferry          | 466850    |
| Keaton         | 466851    |
| Journey        | 466866    |
| Utopia*        | 466867    |
| Commuter Cloth | 466879    |
| Sonnet         | 466909    |
| Brigadoon*     | 466914    |
| Little Devil   | 466916    |
| Instinct       | 466921    |
| Chameleon*     | 466929    |
| Attire         | 466933    |
| Cozy Cord*     | 466938    |
| Vast*          | 466945    |
| Plaid On*      | 466947    |
| Contour*       | 466950    |
| Winnow*        | 466960    |

| Category 2    |           |
|---------------|-----------|
| Fabric Name   | Pattern # |
| Dactyl*       | 466673    |
| Atlas*        | 466702    |
| Color Field*  | 466712    |
| Buzz          | 466719    |
| Wow Factor    | 466720    |
| Woodland II*  | 466723    |
| Tempest       | 466724    |
| Off the Grid  | 466725    |
| Code          | 466736    |
| Palisade*     | 466763    |
| Island*       | 466765    |
| Caliper*      | 466804    |
| Seurat        | 466811    |
| Knoll Felt    | 466830    |
| Whip*         | 466842    |
| Smart*        | 466853    |
| Greenwich*    | 466878    |
| Durand*       | 466895    |
| Cleo          | 466910    |
| Day Tripper   | 466913    |
| Pullman       | 466917    |
| Premier*      | 466920    |
| Rebel         | 466922    |
| Vice Versa*   | 466925    |
| Utmost II     | 466931    |
| Entwine       | 466937    |
| Pathway*      | 466941    |
| Circle Point* | 466942    |
| Homage*       | 466943    |
| Retreat*      | 466944    |
| Flower Power  | 466946    |
| Placid*       | 466949    |
| Currents*     | 466951    |
| Prestini*     | 466953    |
| Aurora, 1985  | 466954    |
| Hummingbird   | 466956    |
| Kiln*         | 466965    |
| Pico          | 466968    |

| Category 3        |           |
|-------------------|-----------|
| Fabric Name       | Pattern # |
| Cameo             | 466674    |
| Arrondissement    | 466711    |
| Color Collage     | 466716    |
| Fancy Twill       | 466717    |
| Circa             | 466753    |
| Texnet*           | 466760    |
| Aegean            | 466769    |
| Nature Walk*      | 466770    |
| It's Complicated* | 466771    |
| Eclat Weave       | 466773    |
| Classic Boucle    | 466777    |
| Alter Ego         | 466792    |
| Modern Tweed      | 466795    |
| Rivers            | 466806    |
| Sherman           | 466841    |
| Biscayne          | 466890    |
| In Stitches       | 466908    |
| Imprint           | 466923    |
| Looped In         | 466948    |
| Vert              | 466955    |
| Mococco, 1966     | 466967    |

| Category 4     |           |
|----------------|-----------|
| Fabric Name    | Pattern # |
| Stripe It*     | 466683    |
| Arezzo         | 466776    |
| Ultrasuede     | 466793    |
| Dapper         | 466803    |
| Stretch Appeal | 466871    |
| Atelier        | 466882    |
| Firefly        | 466901    |
| Amore          | 466905    |
| Catwalk        | 466907    |
| Chiseled       | 466919    |
| Florescence    | 466924    |
| Tara           | 466926    |
| In Step        | 466928    |
| Striae Stripe  | 466930    |
| Rivington      | 466939    |
| Utrillo        | 466945    |
| Altiplano      | 466974    |

| Not Graded In |           |
|---------------|-----------|
| Fabric Name   | Pattern # |
| Ita           | 466693    |
| North Island  | 466704    |
| Lowell LUXE   | 466707    |
| Cummings      | 466709    |
| Byron         | 466710    |
| Guise         | 466727    |
| Knoll Velvet  | 466780    |
| Doily         | 466807    |
| Digi Velvet   | 466816    |
| Dynamic       | 466845    |
| Cato          | 466862    |
| Limani        | 466906    |
| Sandis        | 466915    |
| Chic          | 466934    |

**NOTE:** Fabric with "\*" is Bleach Cleanable with diluted household bleach.

**GATEWAY™ LOUNGE**  
**PLAN VIEW**

---

**Gateway Lounge Elements Plan View**

Convex Sofa

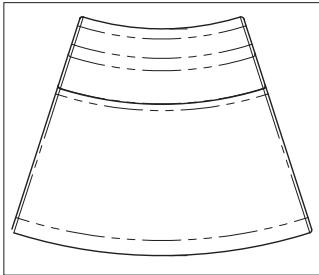

Concave Sofa

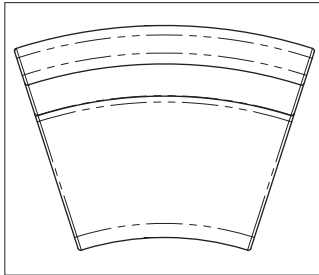

Straight Sofa

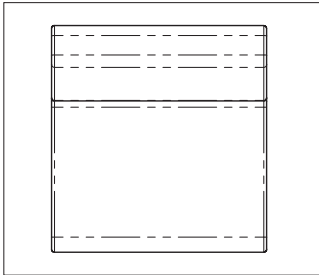

120° Corner Sofa

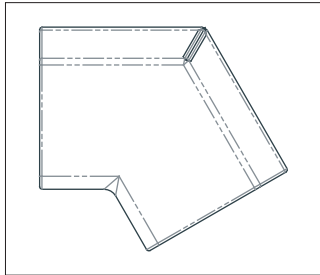

Convex Bench for Sofa

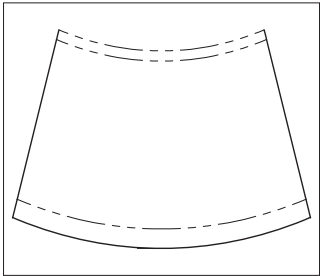

Concave Bench for Sofa

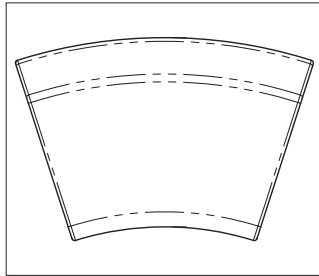

Straight Bench for Sofa

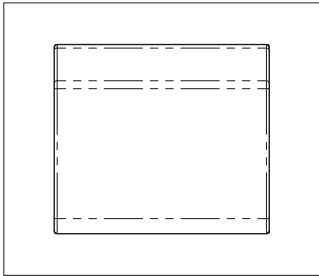

120° Corner Sofa

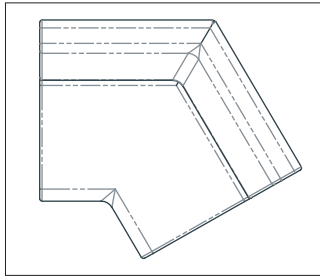

Convex Symmetric Bench

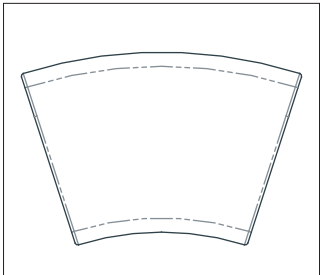

Concave Symmetric Bench

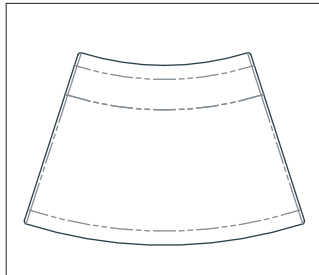

Straight Symmetric Bench

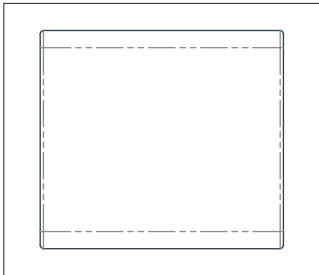

# GATEWAY™ LOUNGE ELEVATION

## Gateway Lounge Elements with Accessories

Side elevation shows Gateway Sofa with low height screen & 9" deep top

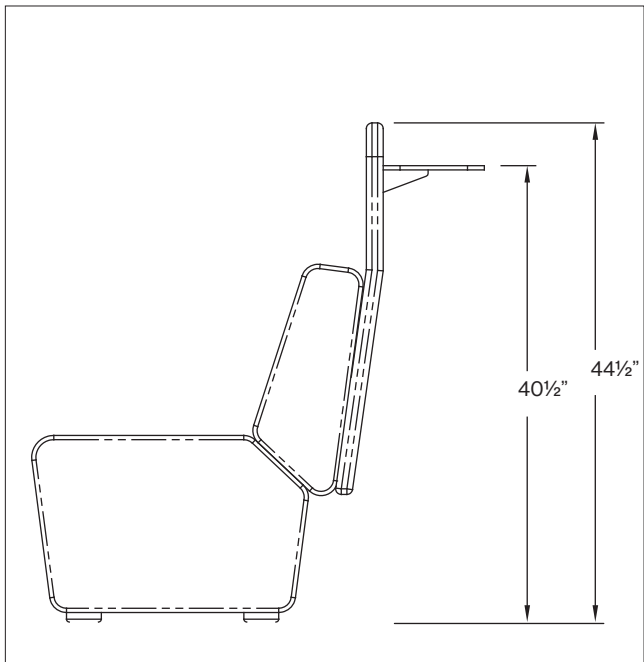

Side elevation shows Gateway Sofa with round table mounted to back

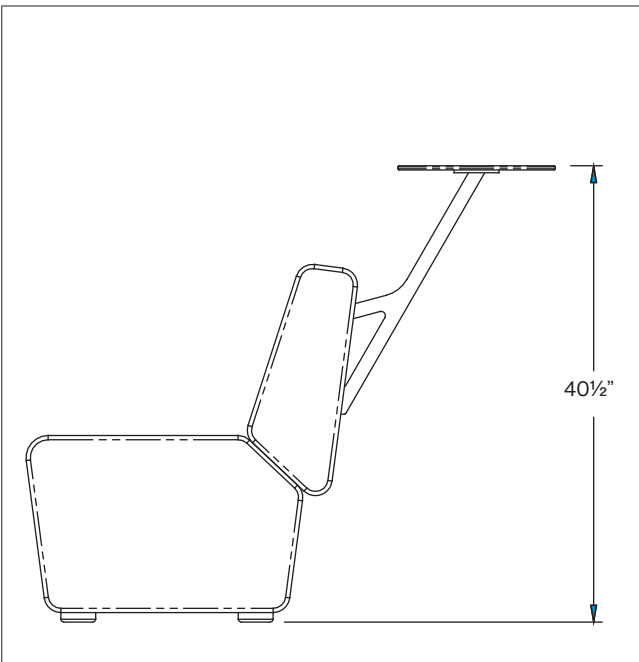

Side elevation shows Gateway Sofa with round table mounted to front

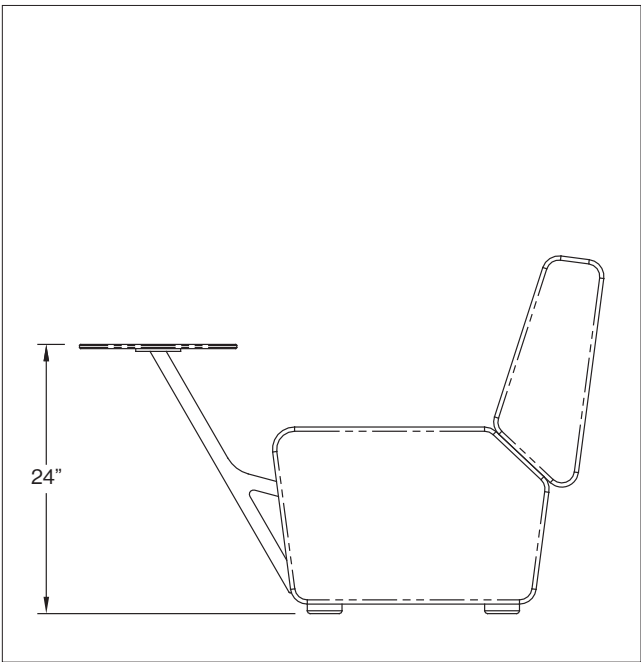

Side elevation shows Gateway Sofa with tall height screen

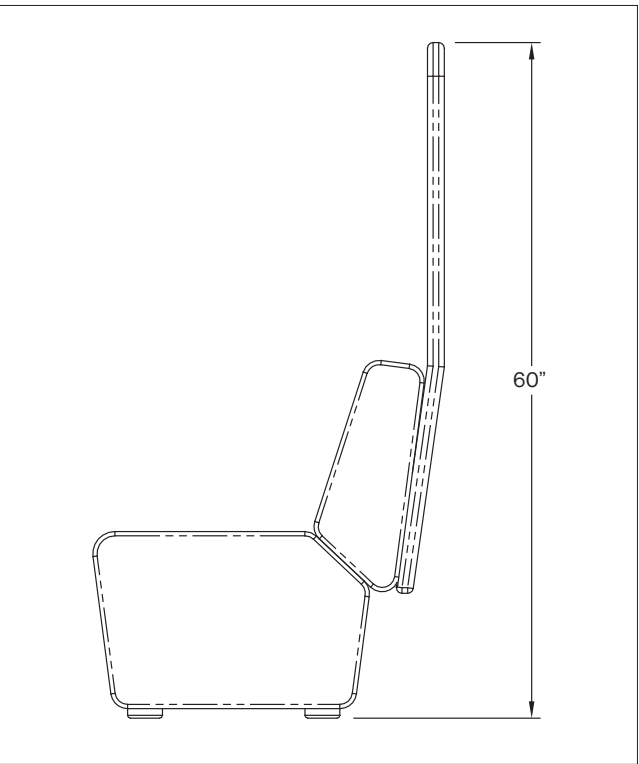



**GATEWAY™ LOUNGE  
LAYOUT**

---

**Gateway Lounge Elements Configuration**

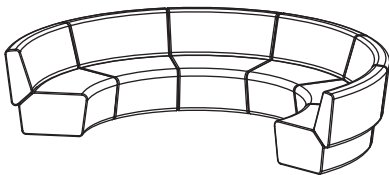
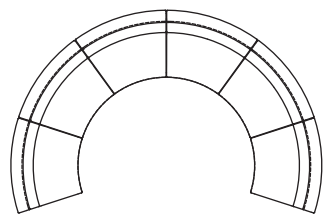

6 concave sofa elements

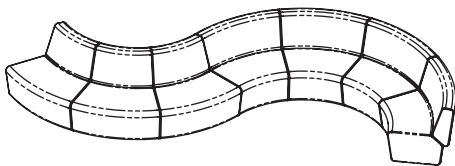
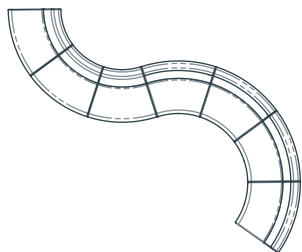

3 convex sofa elements  
4 concave sofa elements

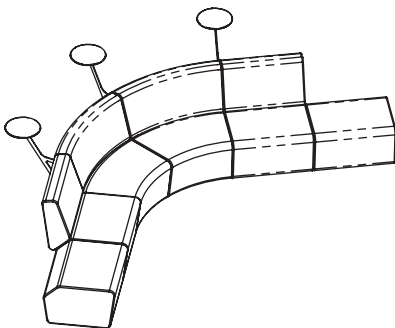
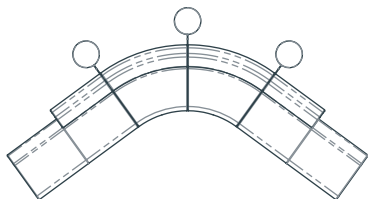

2 concave sofa elements  
2 straight sofa elements  
2 straight bench elements  
3 round sofa tables

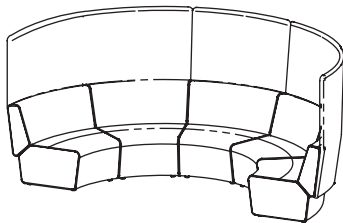
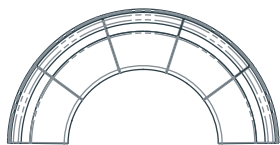

5 convex sofa elements  
5 concave sofa elements

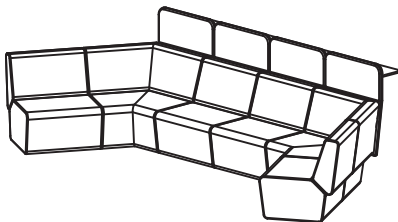
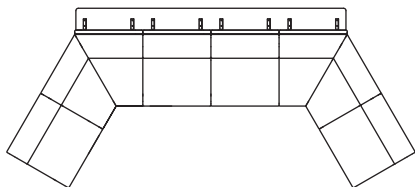

4 straight sofa elements  
2 120 degree corner sofa elements  
4 straight low screen with 9" deep top

GATEWAY™ LOUNGE ELEMENTS

SOFA ELEMENTS

— CND ONLY —

| Model<br>Number | Seat<br>H" | W" | D" | H" | Fabric |         | COM | COL | Verde | Grano | Cremoso | KnollTextiles |   |   |   |
|-----------------|------------|----|----|----|--------|---------|-----|-----|-------|-------|---------|---------------|---|---|---|
|                 |            |    |    |    | Yrds.  | Sq. Ft. |     |     |       |       |         | 1             | 2 | 3 | 4 |

CONVEX

SYMMETRIC BENCH ELEMENT



11410 17 40 24⅝ 17 2¼ 108

2,590 2,720 3,685 3,940 4,340 2,920 3,190 3,410 3,840

BENCH ELEMENT FOR SOFA



11411 17 40 24⅝ 17 2¼ 108

2,590 2,720 3,685 3,940 4,340 2,920 3,190 3,410 3,840

SOFA ELEMENT

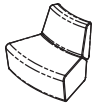

11412 17 40 29½ 32 4½ 108

4,595 4,830 6,755 7,280 8,070 5,260 5,795 6,230 7,090

CONCAVE

SYMMETRIC BENCH ELEMENT



11420 17 28 24⅝ 17 2 108

2,590 2,720 3,685 3,940 4,340 2,920 3,190 3,410 3,840

BENCH ELEMENT FOR SOFA



11413 17 28 24⅝ 17 2¼ 108

2,590 2,720 3,685 3,940 4,340 2,920 3,190 3,410 3,840

SOFA ELEMENT

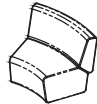

11414 17 41 29½ 32 4½ 108

4,595 4,830 6,755 7,280 8,070 5,260 5,795 6,230 7,090

Features:





- Gateway™ upholstered lounge elements include linear and curved modular components which enable the customer to create their own solution.
- Element styles are bench, sofa and sofa with integrated privacy screen.



GATEWAY™ LOUNGE ELEMENTS  
SOFA ELEMENTS

— CND ONLY —

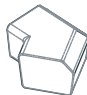





KnollTextiles

|   | Model<br>Number | Seat<br>H" | W"                             | D"                             | H" | Fabric<br>Yrds.               | Leather<br>Sq. Ft. | COM   | COL   | Verde  | Grano  | Cremoso | 1      | 2      | 3      | 4      |
|---|-----------------|------------|--------------------------------|--------------------------------|----|-------------------------------|--------------------|-------|-------|--------|--------|---------|--------|--------|--------|--------|
| <b>STRAIGHT</b>   |                 |            |                                |                                |    |                               |                    |       |       |        |        |         |        |        |        |        |
| SYMMETRIC BENCH ELEMENT   |                 |            |                                |                                |    |                               |                    |       |       |        |        |         |        |        |        |        |
|    | 11417           | 17         | 28                             | 24 <sup>5</sup> / <sub>8</sub> | 17 | 2 <sup>1</sup> / <sub>4</sub> | 108                | 2,465 | 2,490 | 3,520  | 3,805  | 4,180   | 2,795  | 3,065  | 3,285  | 3,715  |
| BENCH ELEMENT FOR SOFA  |                 |            |                                |                                |    |                               |                    |       |       |        |        |         |        |        |        |        |
|    | 11415           | 17         | 28                             | 24 <sup>5</sup> / <sub>8</sub> | 17 | 2 <sup>1</sup> / <sub>4</sub> | 108                | 2,465 | 2,490 | 3,520  | 3,805  | 4,180   | 2,795  | 3,065  | 3,285  | 3,715  |
| SOFA ELEMENT  |                 |            |                                |                                |    |                               |                    |       |       |        |        |         |        |        |        |        |
|    | 11416           | 17         | 28                             | 29 <sup>1</sup> / <sub>2</sub> | 32 | 4 <sup>1</sup> / <sub>2</sub> | 108                | 4,460 | 4,685 | 6,600  | 7,150  | 7,895   | 5,120  | 5,655  | 6,090  | 6,955  |
| <b>120 DEGREE</b>   |                 |            |                                |                                |    |                               |                    |       |       |        |        |         |        |        |        |        |
| BENCH ELEMENT FOR SOFA  |                 |            |                                |                                |    |                               |                    |       |       |        |        |         |        |        |        |        |
|   | 11418           |            | 34                             | 37 <sup>3</sup> / <sub>4</sub> | 17 | 5                             | 216                | 4,910 | 4,965 | 7,030  | 7,590  | 2,590   | 5,645  | 6,240  | 6,720  | 7,680  |
| SOFA ELEMENT  |                 |            |                                |                                |    |                               |                    |       |       |        |        |         |        |        |        |        |
|  | 11419           |            | 38 <sup>3</sup> / <sub>4</sub> | 31 <sup>3</sup> / <sub>4</sub> | 32 | 9                             | 216                | 8,900 | 9,345 | 13,195 | 14,290 | 15,780  | 10,225 | 11,295 | 12,160 | 13,885 |

- Features:**
- Gateway™ upholstered lounge elements include linear curved and corner modular components which enable the customer to create their own solution.
  - Element styles are bench, sofa and sofa with integrated privacy screen.

GATEWAY™ LOUNGE ELEMENTS  
SOFA ELEMENTS

— CND ONLY —  
KnollTextiles

|   | Model<br>Number | Seat<br>H"                       | W"      | D" | H" | Fabric<br>Yrds. | Leather<br>Sq. Ft. | COM   | COL   | Verde | Grano | Cremoso | 1     | 2     | 3     | 4     |
|---|-----------------|----------------------------------|---------|----|----|-----------------|--------------------|-------|-------|-------|-------|---------|-------|-------|-------|-------|
| PRIVACY SCREEN  |                 |                                  |         |    |    |                 |                    |       |       |       |       |         |       |       |       |       |
|    | CONVEX          |                                  |         |    |    |                 |                    |       |       |       |       |         |       |       |       |       |
|   | 11421           | Tall Height                      | 42½     |    | 59 | 3               | 54                 | 1,650 | 1,730 | 3,085 | 3,440 | 3,870   | 2,090 | 2,450 | 2,740 | 3,315 |
|   | 11422           | Low Height                       | 42½     |    | 44 | 2               | 36                 | 1,360 | 1,425 | 2,310 | 2,555 | 2,855   | 1,655 | 1,900 | 2,085 | 2,470 |
|   | 11423           | Low Height with<br>9" deep shelf | 42½     |    | 44 | 2               | 36                 | 1,940 | 2,040 | 2,920 | 3,165 | 3,475   | 2,235 | 2,475 | 2,665 | 3,045 |
| CONCAVE   |                 |                                  |         |    |    |                 |                    |       |       |       |       |         |       |       |       |       |
|    |                 |                                  |         |    |    |                 |                    |       |       |       |       |         |       |       |       |       |
|   | 11424           | Tall Height                      | 42½     |    | 59 | 3               | 54                 | 1,650 | 1,730 | 3,085 | 3,440 | 3,870   | 2,090 | 2,450 | 2,740 | 3,315 |
|   | 11425           | Low Height                       | 42½     |    | 44 | 2               | 36                 | 1,360 | 1,425 | 2,310 | 2,555 | 2,855   | 1,655 | 1,900 | 2,085 | 2,470 |
|   | 11426           | Low Height with<br>9" deep top   | 42½     |    | 44 | 2               | 36                 | 1,940 | 2,040 | 2,920 | 3,165 | 3,475   | 2,235 | 2,475 | 2,665 | 3,045 |
| STRAIGHT (for straight or 120° corner element)  |                 |                                  |         |    |    |                 |                    |       |       |       |       |         |       |       |       |       |
| <br><br> |                 |                                  |         |    |    |                 |                    |       |       |       |       |         |       |       |       |       |
|   | 11427           | Tall Height                      | 28      |    | 59 | 3               | 54                 | 1,195 | 1,255 | 2,610 | 2,955 | 3,430   | 1,635 | 1,990 | 2,280 | 2,860 |
|   | 11428           | Low Height                       | 28      |    | 44 | 2               | 36                 | 1,080 | 1,135 | 2,035 | 2,260 | 2,580   | 1,375 | 1,615 | 1,805 | 2,185 |
|   | 11429           | Low Height with<br>9" deep top   | 28      |    | 44 | 2               | 36                 | 1,490 | 1,560 | 2,465 | 2,685 | 3,000   | 1,780 | 2,025 | 2,215 | 2,595 |
| ROUND SOFA TABLE  |                 |                                  |         |    |    |                 |                    |       |       |       |       |         |       |       |       |       |
|    | 11431           |                                  | 14 dia. |    |    |                 |                    | 1,505 |       |       |       |         |       |       |       |       |

- Feature:
- Privacy screens can be contrasting or matching fabrics
  - Table top is ¾" thick Self edge available in Nienkämper veneers & P-lam.

# TERMS AND CONDITIONS OF SALE

---

## PRICES

All prices are list prices, FOB our Toronto Factory- freight charges are extra. Packing and/ or crating is available, if required, upcharges apply.

Due to existing conditions in regard to cost of labor and materials, we reserve the right to change prices without notice.

## TERMS

Net 30 days from date of invoice to accredited buyers. Two per cent (2%) interest charged monthly on overdue accounts. Deposit of 50% is required with order. Terms will be established upon credit evaluation. Due to delays in processing references, first orders may be treated as C.B.D. orders.

## ORDER CONFIRMATION

Orders are accepted upon issuance of our order confirmation and are subject to the terms set forth therein; notwithstanding any variance from the terms of the buyer's order form.

Nienkämper is not liable for any delay or failure to deliver caused by labor or transportation difficulties, accidents, acts of God, failure of sources of supply, or other causes beyond our control, and changes will affect the delivery date.

## CHANGE OF ORDERS OR CANCELLATIONS

Changes or cancellations are subject to our ability to conform. A charge will be levied against canceled or changed orders based on costs already incurred by Nienkämper. All changes must be in writing and submitted on a revised purchase order. Changes will affect the delivery date.

## STORAGE

If goods cannot be accepted when ready, we may transfer them to storage (which is to be deemed as delivery for invoice purposes). The customer accepts risks and will be charged at prevailing rates.

## FREIGHT

All prices are list prices, FOB our Toronto Factory- freight charges are extra.

Packing and/or crating are available, if required, upcharges apply.

## CLAIMS

All furniture is given to the carrier and signed for in good condition. It is the responsibility of the receiver to sign for the goods in the presence of the carrier and note the condition in which they are received. Freight claims should be filed with the carrier.

## WARRANTY

There are no express or implied warranties, conditions and obligations of the manufacturer, whether statutory or otherwise that extend beyond the description on the face hereof. Our furniture is made to the highest standard and is warranted free from defects of material and workmanship for five years from the date of delivery. During the warranty period we will repair or replace such merchandise as shall prove to be defective, during normal usage in accordance with manufacturer's specifications. The manufacturer shall not be liable for defect wholly attributable to normal manufacturing process. Replacement or repair of the Product shall be the sole remedy of the Customer, and the manufacturer shall not be liable for any direct, indirect, incidental, or consequential loss or damage suffered by the Customer by reason of any defect in workmanship or manufacture of the Product or inability to use the Product. Moreover, this warranty does not cover accidental damage, abuse, alteration, ordinary wear and tear of Goods, negligence and misuse nor variations over which we have no control such as heat or humidity or damage to which the Goods are connected that is not attributable to the failure of the goods themselves. This warranty is null and void when the product is installed with hardware other than that supplied and/or when installed differently than recommended in the installation guide. Modification to the product or hardware may result in failure of the product and cause damage and/or injury.

## WOOD FINISHES

Nienkämper offers a wide variety of standard light finishes on cherry, mahogany and figured anagré wood veneers, and a clear natural finish on figured anagré, figured sycamore, maple, bird's eye maple and curly maple.

Light finishes do not mask the grain and other characteristics of each wood species. It is important to understand that pieces of the same type of wood will not look identical when a light finish is used. The appearance of the finish will also depend on the natural color of the veneer. Cherry darkens over time as the wood ages. Pin knots and gum pockets are inherent traits.

Wood is a naturally variable raw material; its variances are not within the furniture manufacturer's control and are therefore not considered defects under this warranty.