

# AXIBO

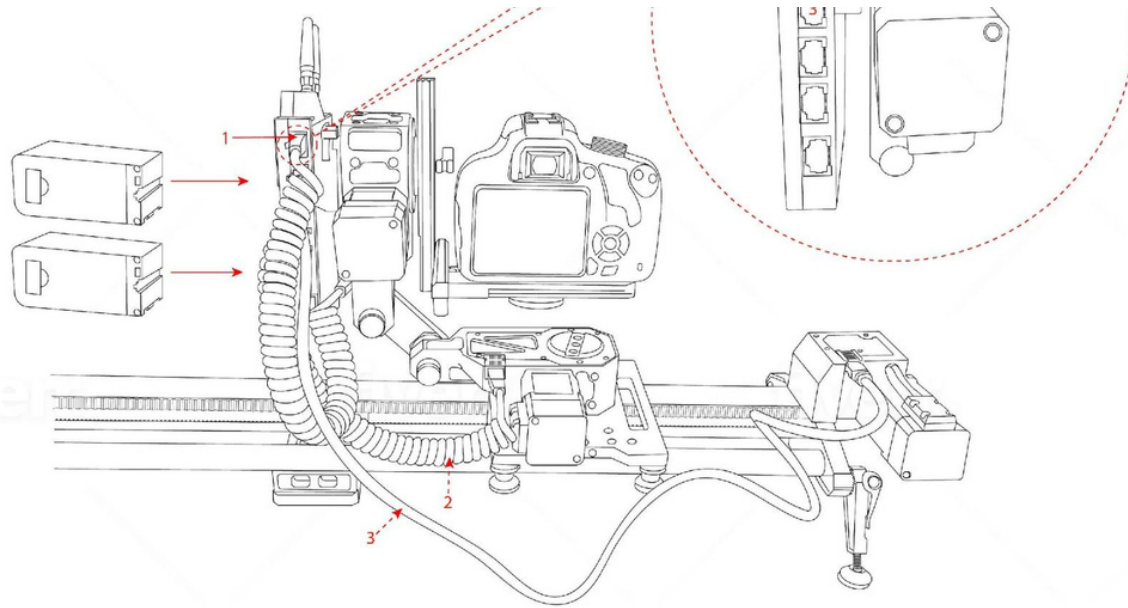

## PAN & TILT v4.0 SLIDER v3.0 PT4 & S3

### USER'S MANUAL

Thank you for choosing us to help you in your creation journey. To get rolling in under 5 mins, check out the following video.

[axibo.com/hello](https://axibo.com/hello)

# TABLE OF CONTENTS

---

- 1 What's in the box
- 2 System assembly A
- 3 System assembly B
- 4 System assembly C
- 5 Gamepad parallax
- 6 Using APP
- 7 Usage warnings

# WHAT'S IN THE BOX

---

1 Motorized Slider

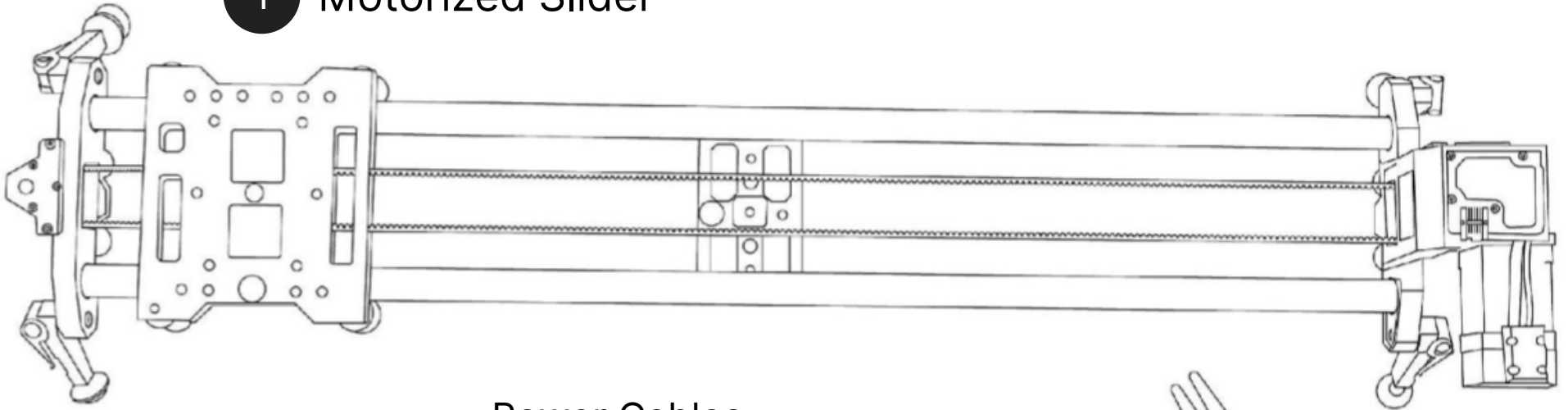

Power Cables

5

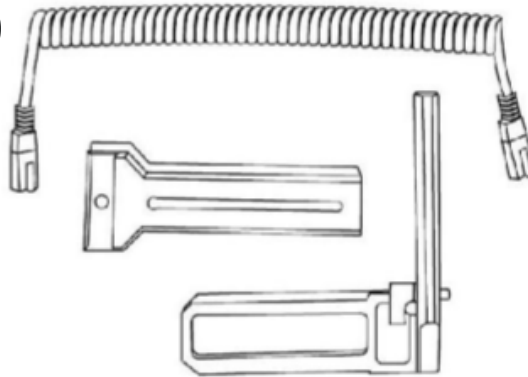

2

Pan/Tilt Head

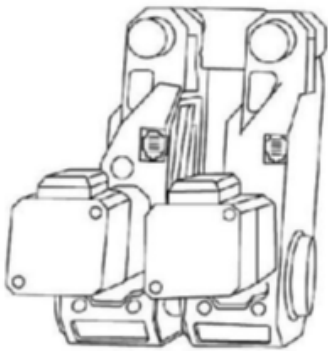

3 Adjustable Mounts

3



4

Edge Compute Module (ECM)

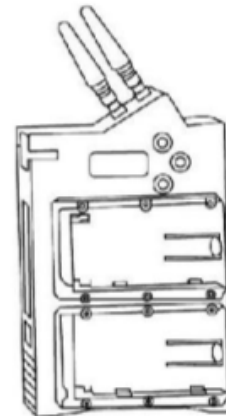

6

Controller

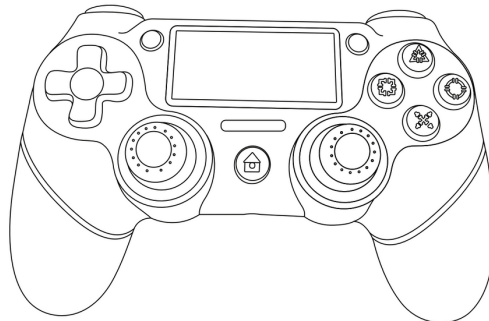

# SYSTEM ASSEMBLY

---

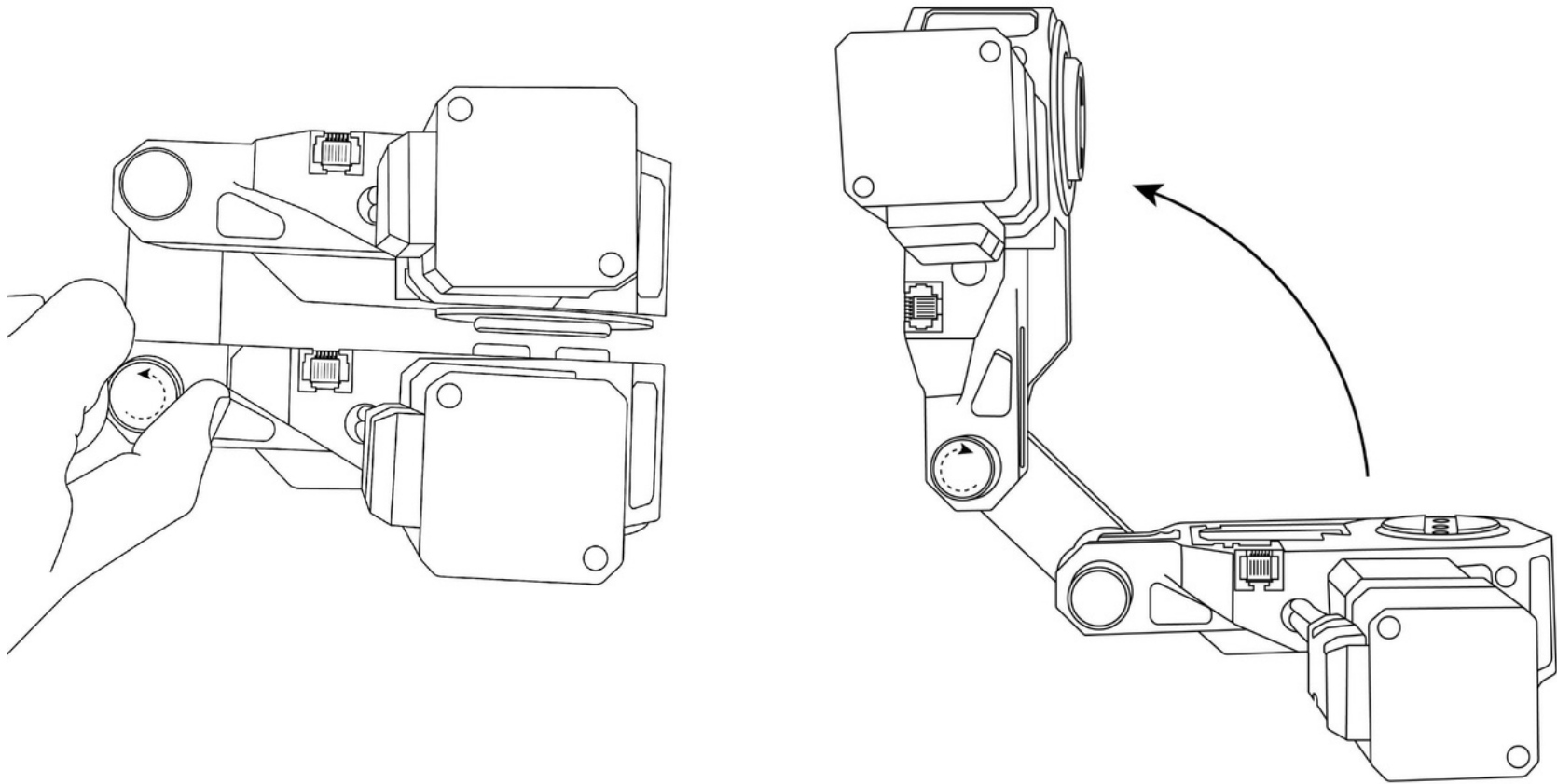

## **STEP 1**

LOOSEN FOLDING KNOBS & UNFOLD PT4

## **STEP 2**

SET THE DESIRED ANGLE, TIGHTEN KNOBS

# SYSTEM ASSEMBLY

---

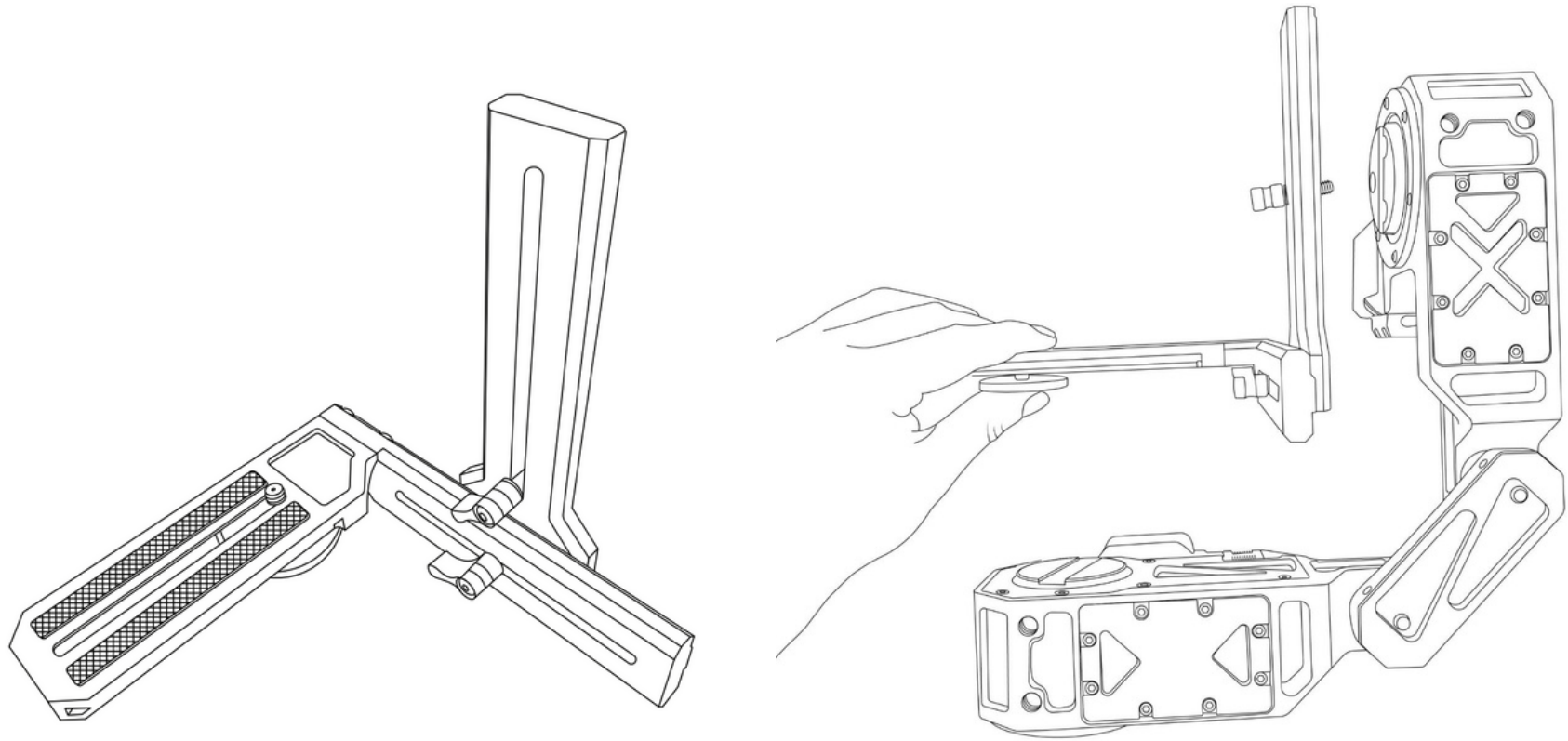

## **STEP 3**

UNFOLD MOUNTING BRACKETS AS SHOWN ABOVE

## **STEP 4**

ATTACH MOUNTING BRACKETS TO PT UNIT

# SYSTEM ASSEMBLY

---

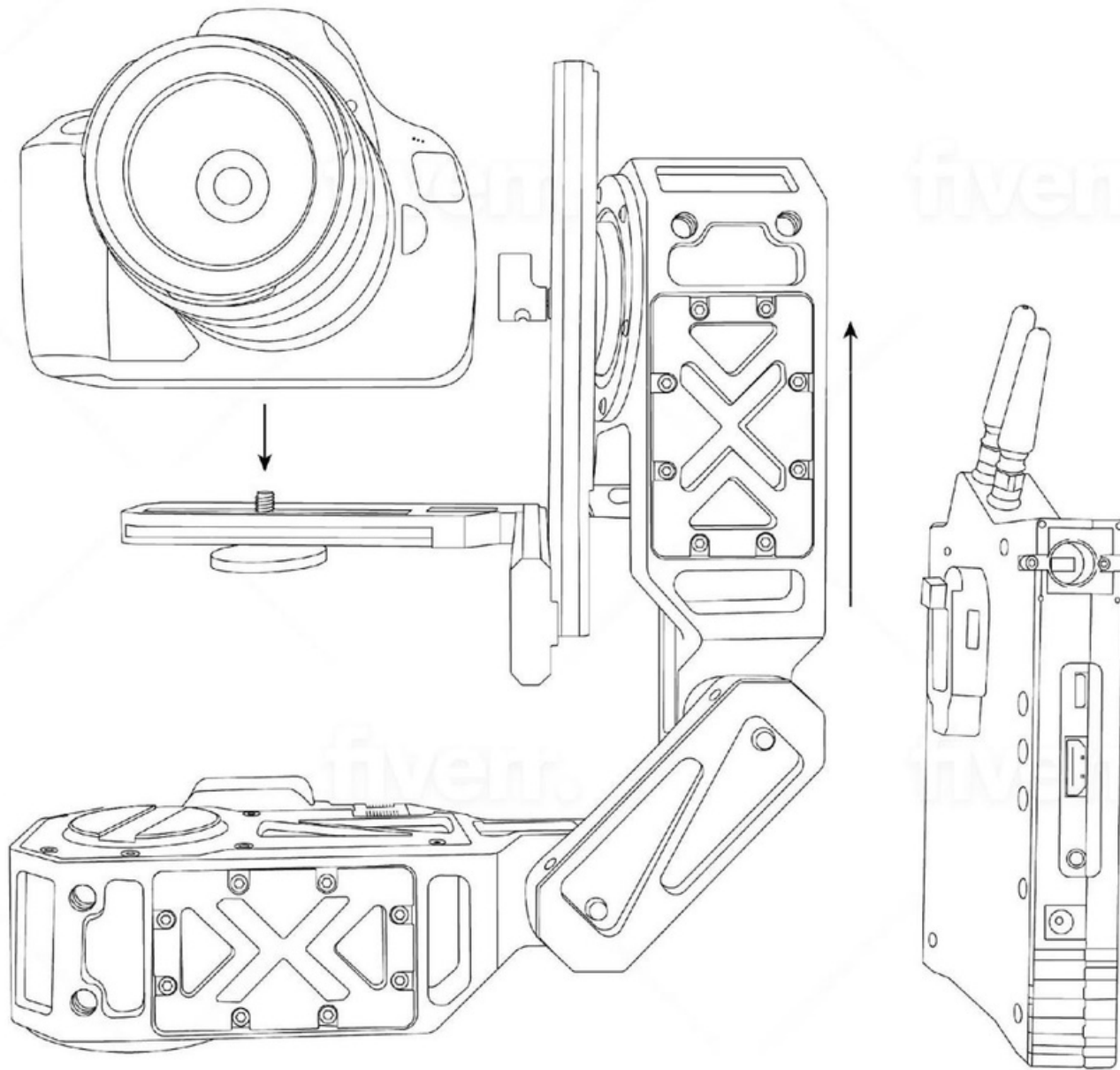

## **STEP 5**

INSTALL CAMERA ON MOUNT USING BOTTOM KNOB

## **STEP 6**

INSTALL CONTROLLER WITH CLIP ON PT4

# SYSTEM ASSEMBLY

---

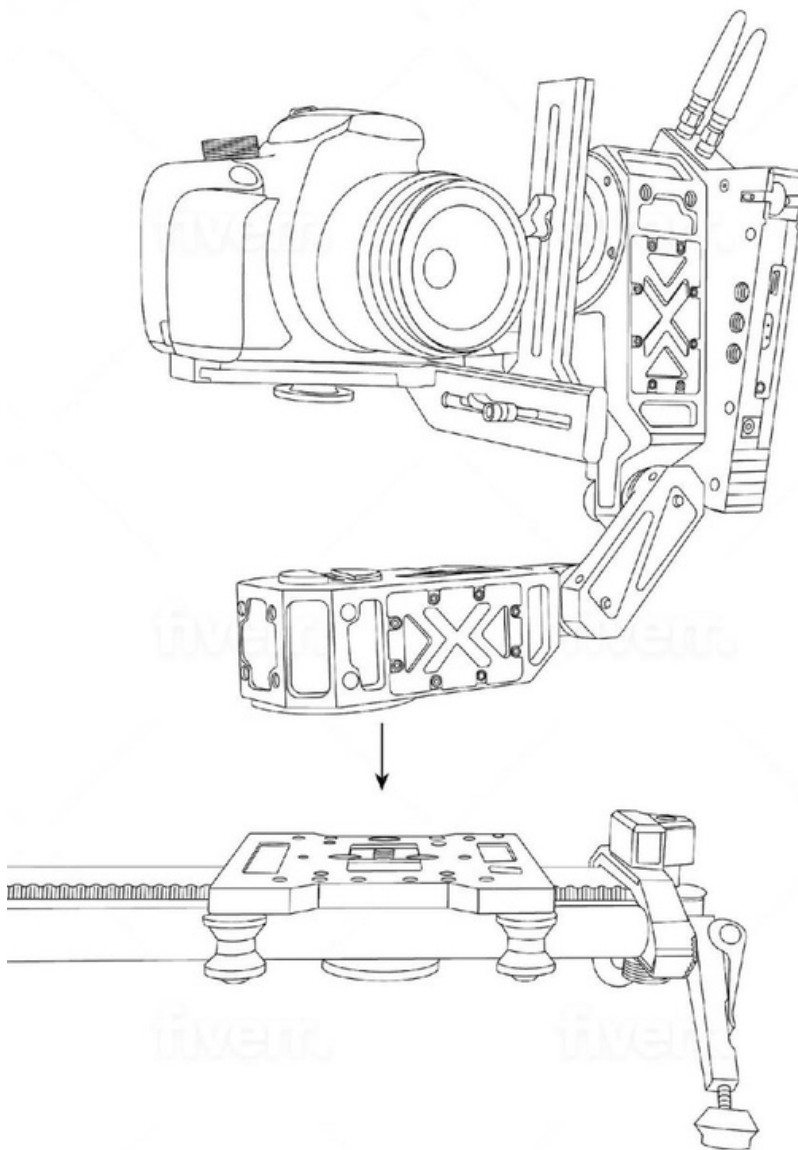

OR

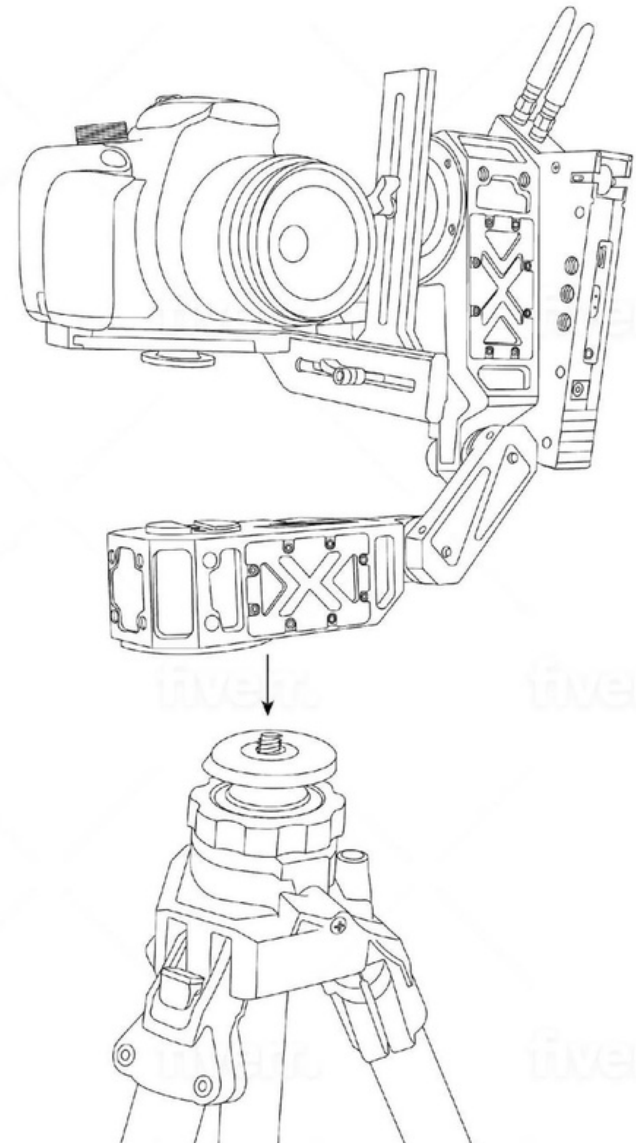

## STEP 7

MOUNT PT SYSTEM ON SLIDER USING KNOB UNDER SLIDER PLATE.

NOTE: CAN MOUNT DIRECTLY TO TRIPOD ALSO, IF NO SLIDER REQUIRED

# SYSTEM ASSEMBLY

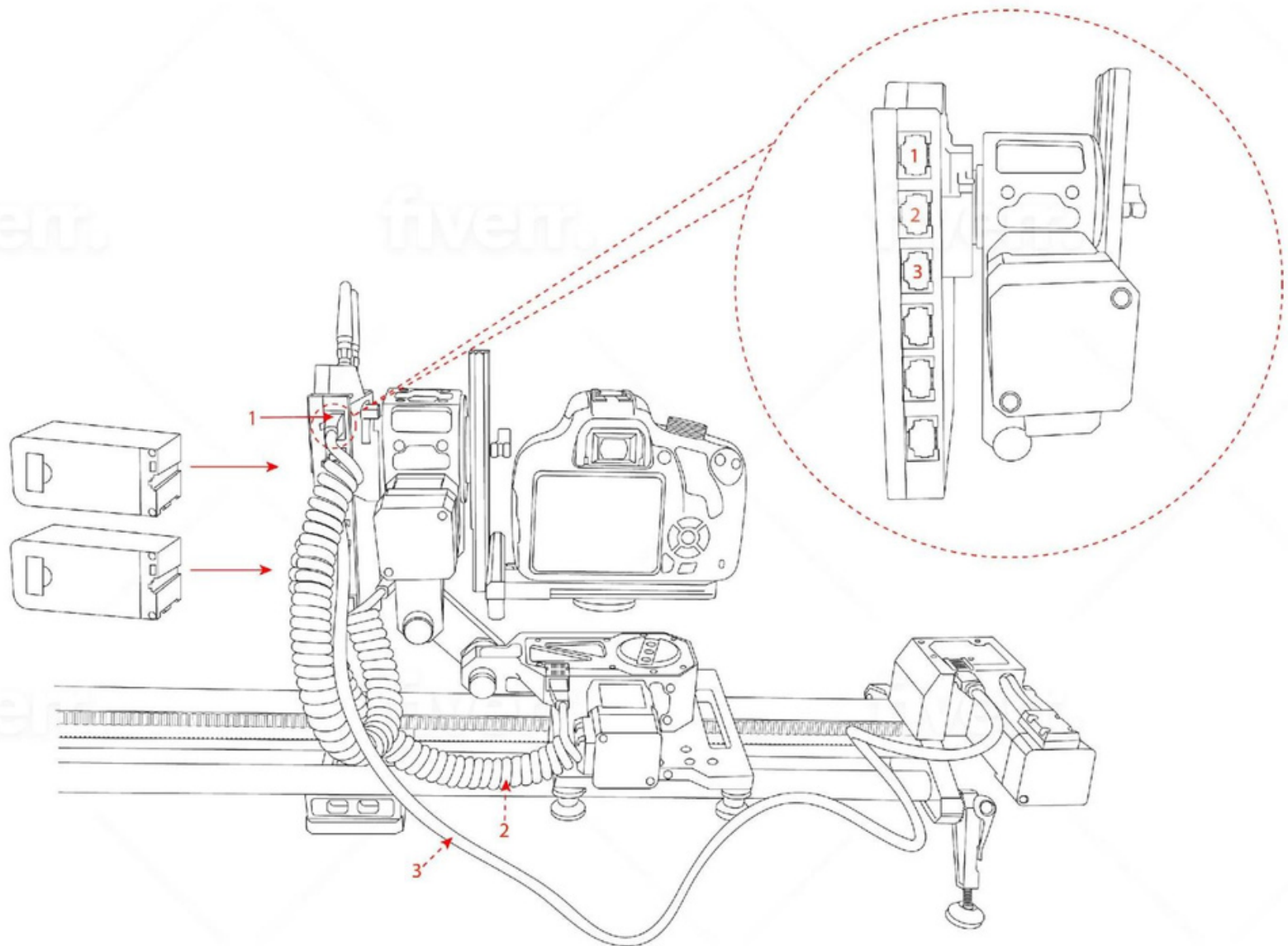

## STEP 6

PLUG IN ALL LINK CABLES TO BLACK CONNECTORS ON ECM. POWER WITH BATTERIES OR DC POWER SUPPLY (FRONT CONNECTOR ON ECM).

**NOTE:** THE LOWEST (6TH) CONNECTOR IS STRICTLY FOR ETHERNET & NOT TO POWER MOTOR MODULES.

# "HELLO AXIBO" GUIDE

## NOTES:

- CONTROLLER COMES **PRE-PAIRED** & APP IS NOT REQUIRED FOR THIS TUTORIAL
- JOG REFERS TO ANY MOVEMENT ON THE SYSTEM (PAN, TILT, SLIDE)

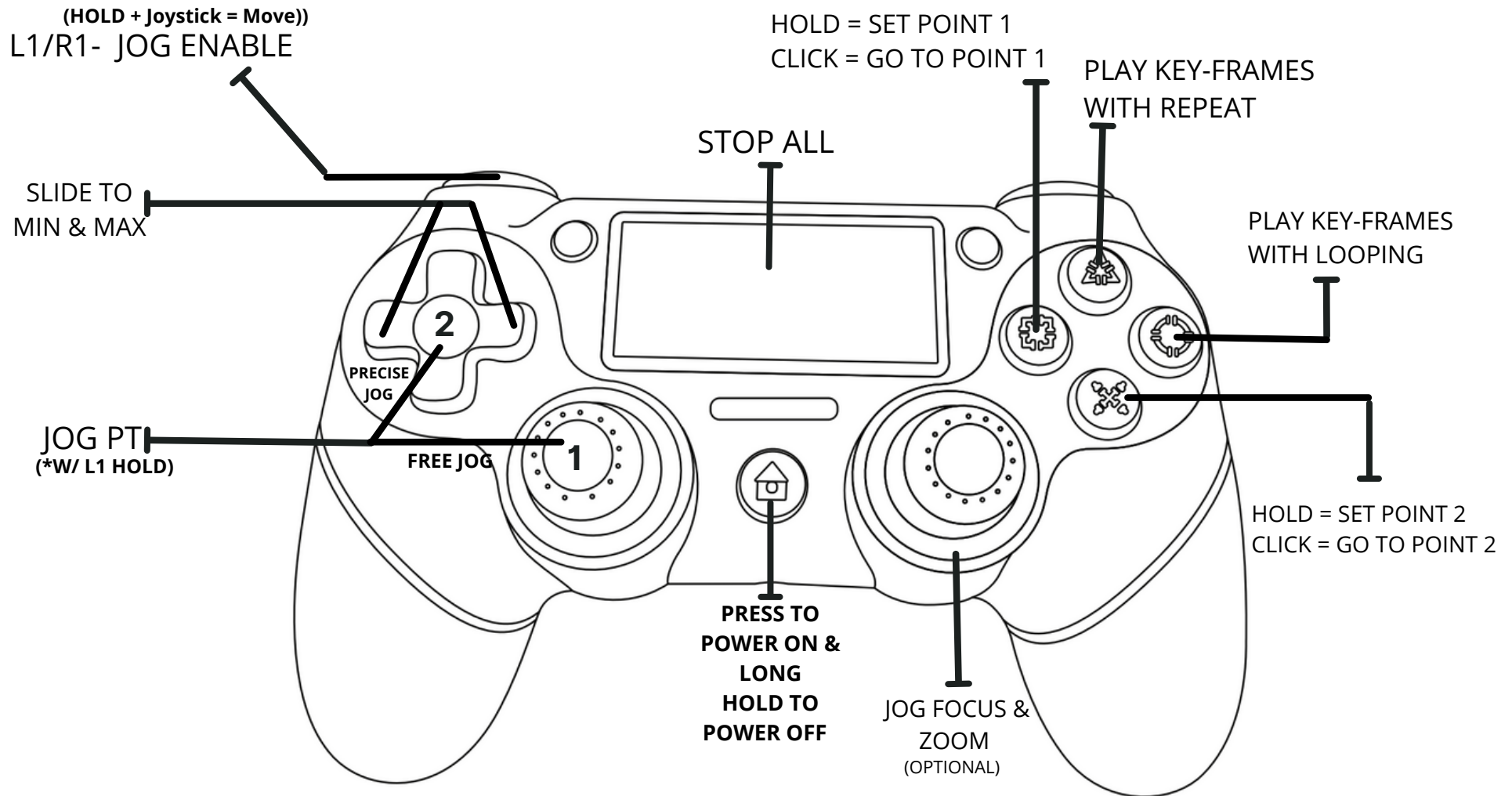

## LET'S SET UP A PARALLAX!

### STEP 1 - SET UP FIRST POINT

First let's send the slider to one end, we can do this by clicking the left key in arrow pad **\*(2)**. Now let's move the pan-tilt by holding down L-1 & using Joystick **\*(1)** or arrow keys in **\*(2)** to jog the pan & tilt around. To set a point hold down square you will controller led blink blue if point is successfully saved.

### STEP 2 - SET UP SECOND POINT

Hit the right arrow key on the arrow pad **\*(2)** this should move the slider to the opposite end. Jog the pan tilt as we did in step 1 to a position you like. To set a point hold down circle you will controller led blink blue if point is successfully saved.

### STEP 3 - CONFIRM POINTS ARE GOOD

You can click circle or square to send the system to the saved positions to make sure these positions are good.

### STEP 4 - PLAY KEY-FRAMES!

Simply click circle & this will launch key frames in looping mode. VOILÀ you are finished :)

# ACCESSING APP

---

**Our APP is what is known as a 'web app', to access it you simply need a browser (chrome recommended). Being a web app, it is universally compatible with all devices.**

## **Step 1:**

Ensure the system is powered on & cables are connected to all axes  
a. LCD on side can be used to see if system is on

## **Step 2:**

On your device (phone/computer/psp) open WiFi connections & connect to the WiFi the system is hosting

- a. **SSID:** AXIBO-xxxxxxx
- b. **PASS:** AXIBO12345

## **Step 3:**

- a. Open your web browser & go to the link **10.42.0.1**

# WARNINGS

---

**"AXIBO INC" is not responsible for how it's systems are used in any context. It ceases responsibilities from any misuse, injury, damages incurred through it's use.**

\*Avoid dropping or causing physical damage to any components

\*Strictly use the power supply original provided

\*Temperature & humidity related conditions may effect the performance of the system

\*If your system is unresponsive, power off completely & restart

\*Do not tamper with device internals, attempt at disassembly of internals will lead to faulty performance

\*Avoid water interaction with device