

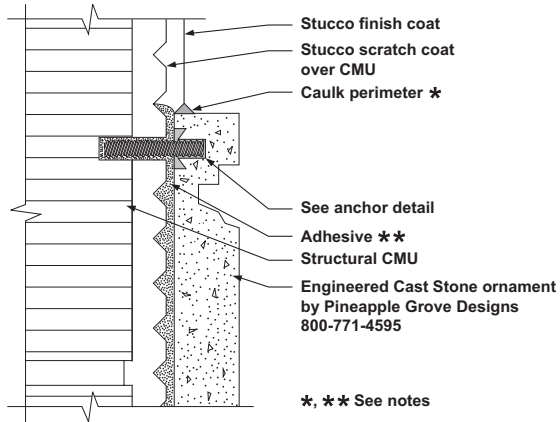
# INSTALLATION FIGURES

ENGINEERED CAST STONE - MEDALLIONS & FRIEZES • MASONRY INSERTS • CUSTOM ELEMENTS

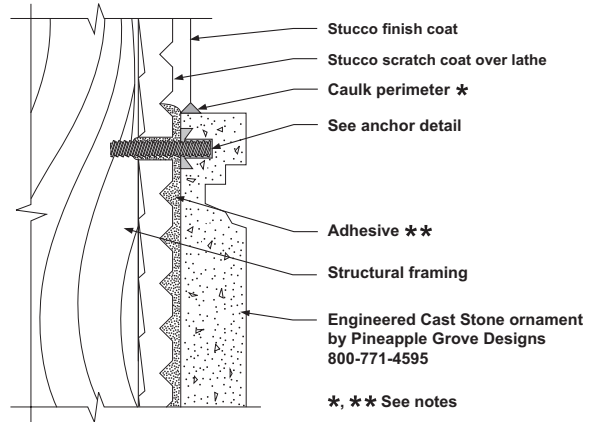
PINEAPPLE GROVE DESIGNS • SCULPTED ARCHITECTURAL ELEMENTS

INSTALLATION FIGURES

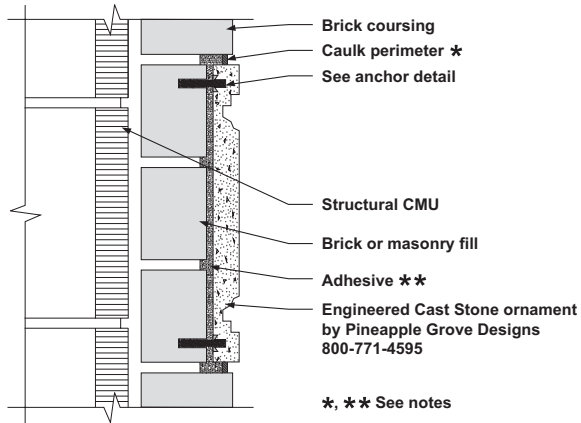
**FIGURE 1**  
**EXTERIOR MASONRY WALL APPLICATION**



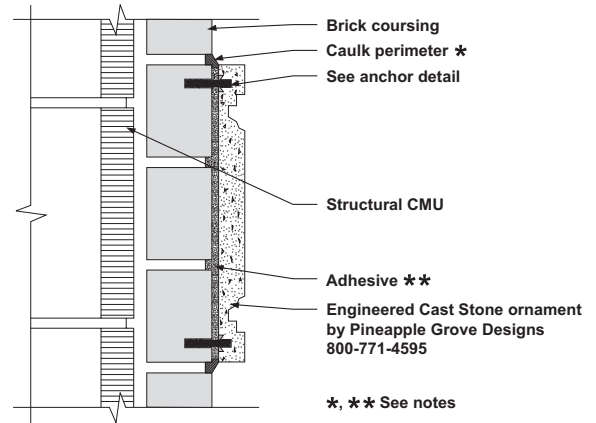
**FIGURE 2**  
**STUCCO OVER FRAMING APPLICATION**



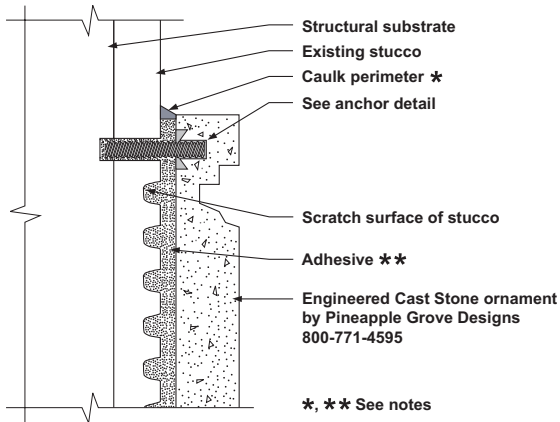
**FIGURE 3**  
**RECESSED BRICK WALL APPLICATION**



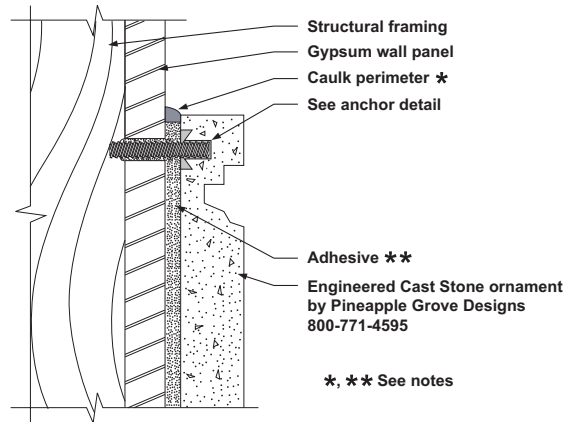
**FIGURE 3.1**  
**BRICK WALL SURFACE APPLICATION**



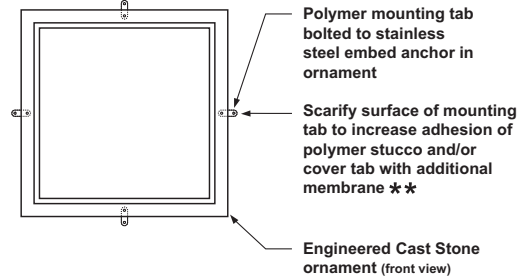
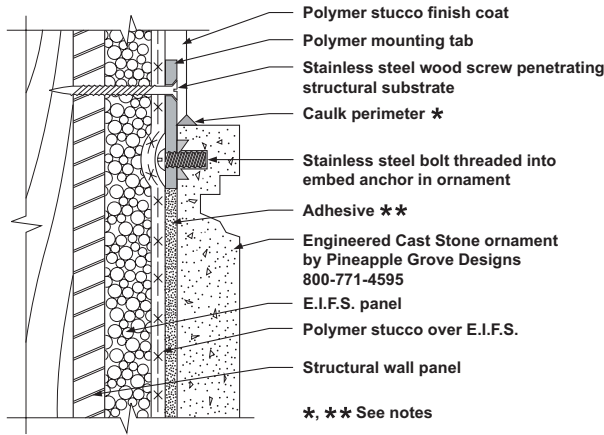
**FIGURE 4**  
**INSTALLATION OVER EXISTING STUCCO**



**FIGURE 5**  
**INTERIOR GYPSUM BOARD APPLICATION**

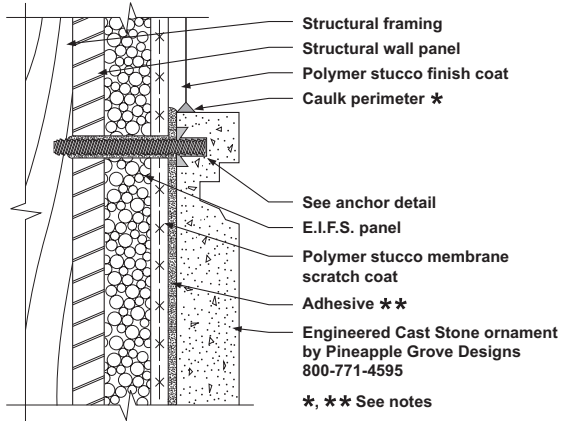


**FIGURE 6**  
**ANCHOR TAB FOR E.I.F.S. DETAIL**

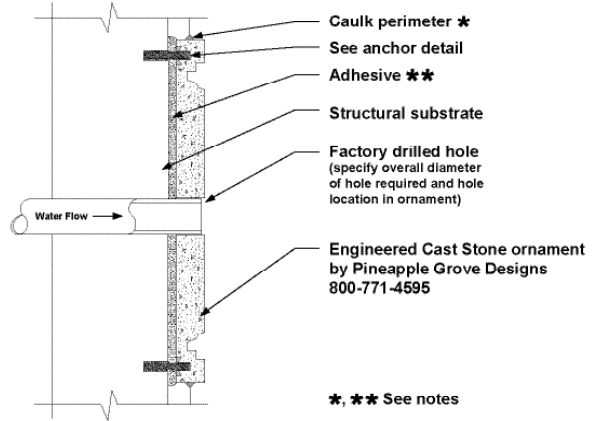


\*\* Consult with manufacturer of polymer stucco system for compatability and best practices

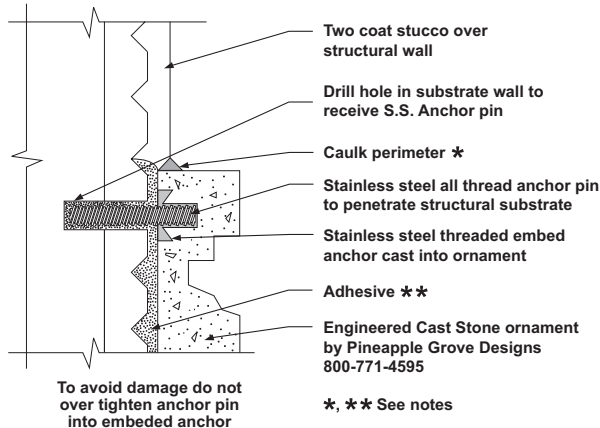
**FIGURE 7**  
**POLYMER STUCCO SYSTEM APPLICATION**



**FIGURE 8**  
**FOUNTAIN PIPE THROUGH ORNAMENT APPLICATION**



**FIGURE 9**  
**ANCHOR DETAIL**



**DETAIL NOTES FOR FIGURES 1-9**

**\* Caulk Note:** Caulk entire perimeter of ornament to prevent water penetration. Refer to caulk manufacturer for proper selection and application method of caulk.

**\*\* Adhesive Note:** Apply adhesive to 100% of back side of ornament. Refer to adhesive manufacturer for proper selection and application method of adhesive.

**Additional Notes:**

A foam or wood panel plug 1/2" larger than ornament may be temporarily installed in brick or stucco in all applications where the Engineered Cast Stone piece is not immediately available or construction conditions prohibit an early installation of ornament. Ornament installation is the same as illustrated after removal of plug.

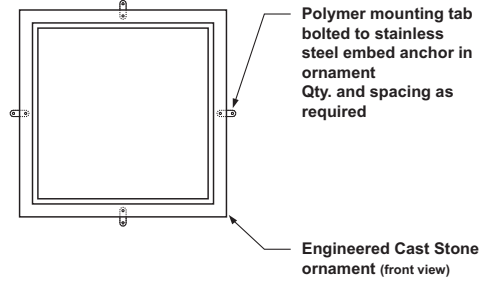
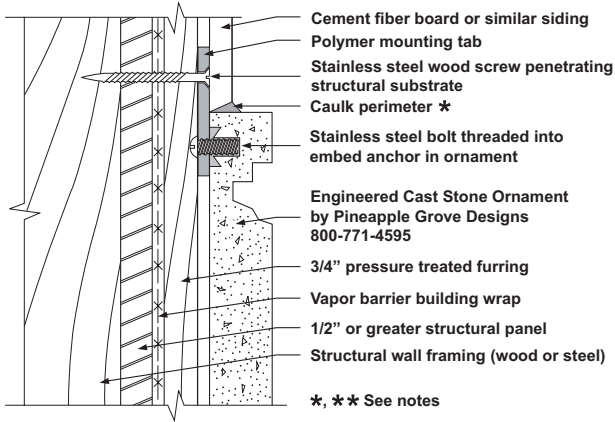
Ornaments are 1" thick unless otherwise noted.

Figures 1-9 are suggested installations only. The installation methods shown may not be appropriate for your project. Consult with your project Engineer for specific installation requirements.

# INSTALLATION FIGURES

ENGINEERED CAST STONE - MEDALLIONS & FRIEZES • MASONRY INSERTS • CUSTOM ELEMENTS

**FIGURE 10**  
**MOUNTING TAB FOR FRAME CONSTRUCTION**



\*\* Consult with project engineer for best methods and practices