

Water Activated Tape Machine Manual

MODEL: Auto WAT

VERSION: 2024

CONTENTS

Safety Notice	_____	2
Technical Data Sheet	_____	2
Structure Introduction	_____	3
Interface Operation Instruction	_____	4
Interface Operation Instruction	_____	5
Spacer Plate Installation Instructions	_____	6
Tape Installation Instructions	_____	6
Tank operation instructions	_____	7



Safety Notice

Voltage:100-240v

Direct sunlight and high temperatures should be avoided as much as possible

Cut off the Power immediately When Fault Occurs

Cut off the Power Under Cleaning or Maintenance

Please do not disassemble or repair the device without the guidance of technical personnel.

Technical Data Sheet

Application Voltage	Frequency	Output Voltage	Frequency
110-240V	110W	DC24V	50/60HZ

Speed	G.W.	Application Tape	Size
60cm/s	12.3KG	30-100mm	46.8*29.7*31CM

Structure Introduction

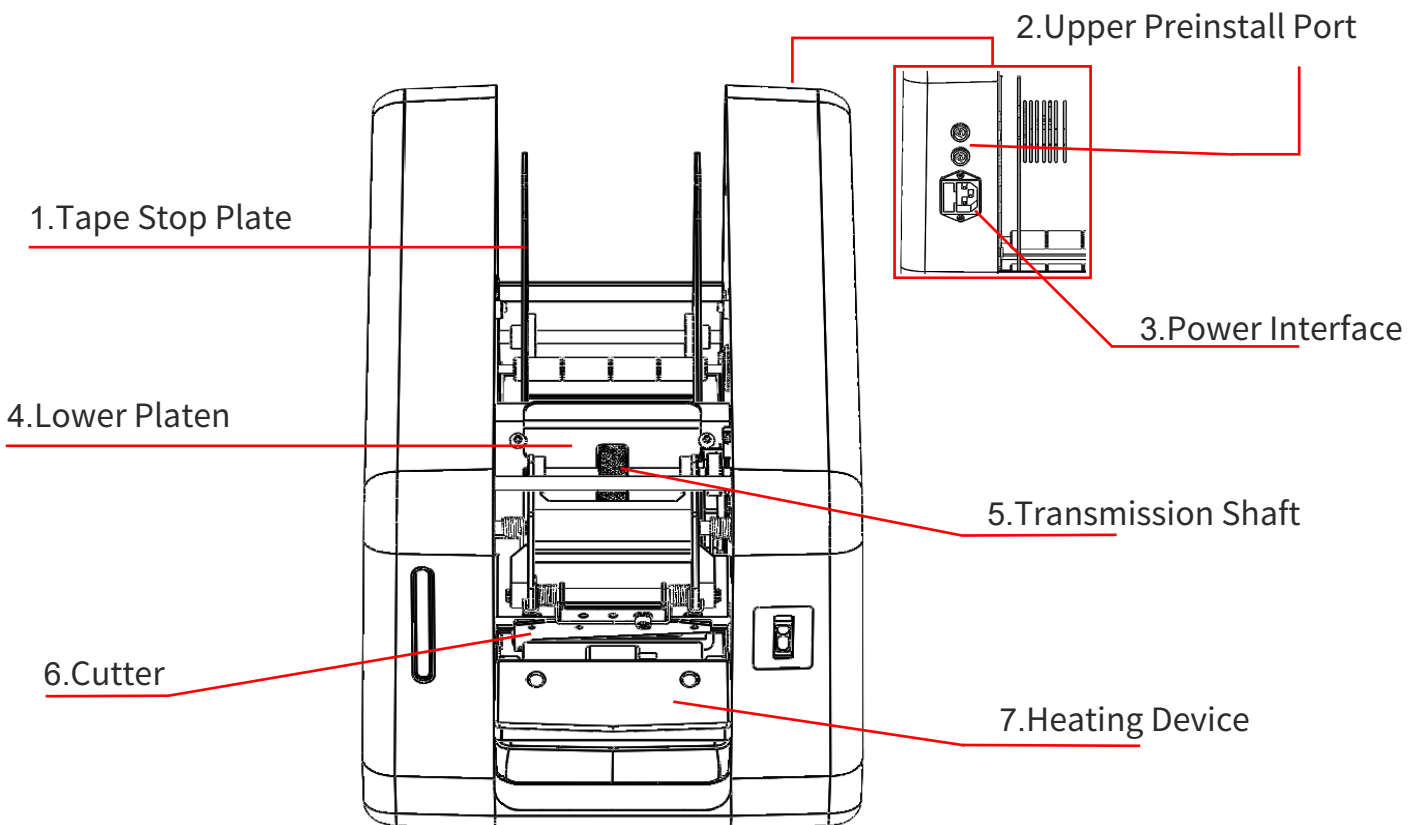
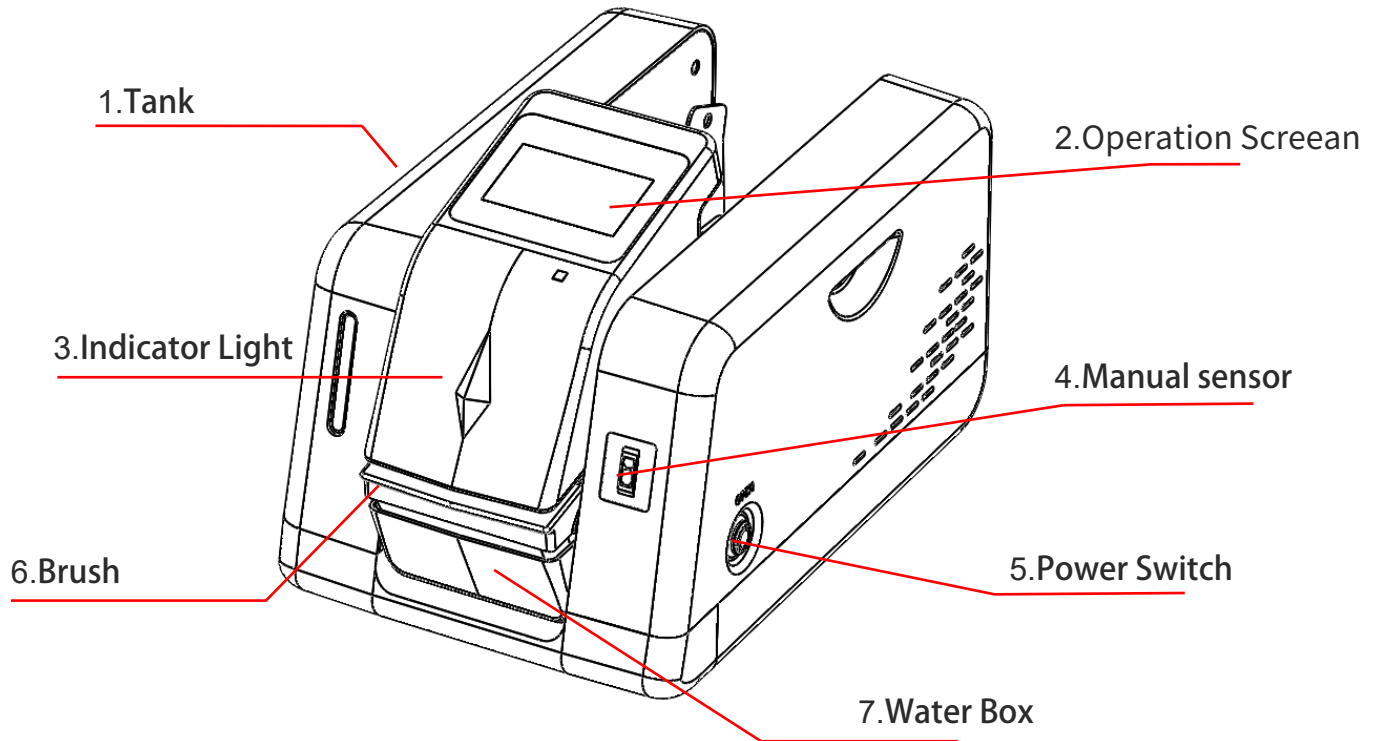

Interface Operation Instruction

Sealing Mode:

Loop mode:
For example, cycle through L1-L2-L3; Click the loop icon first then enter Length, click L1-L2-L3 to activate, press start to release tape, it will automatically come out after taking it out a length

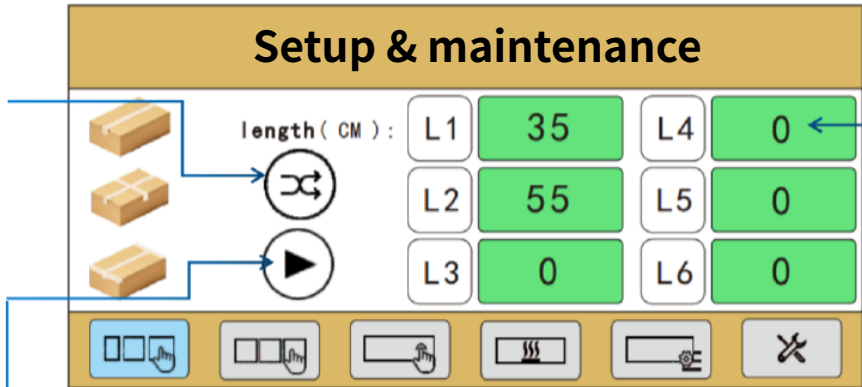

Start and Stop Buttons

Length Set range 10-999

Order of operation:
1.L1- Light - Enter length - Press Start;
2.L1- Light - Input length - press cycle to start; Start and stop buttons

Automatic mode:

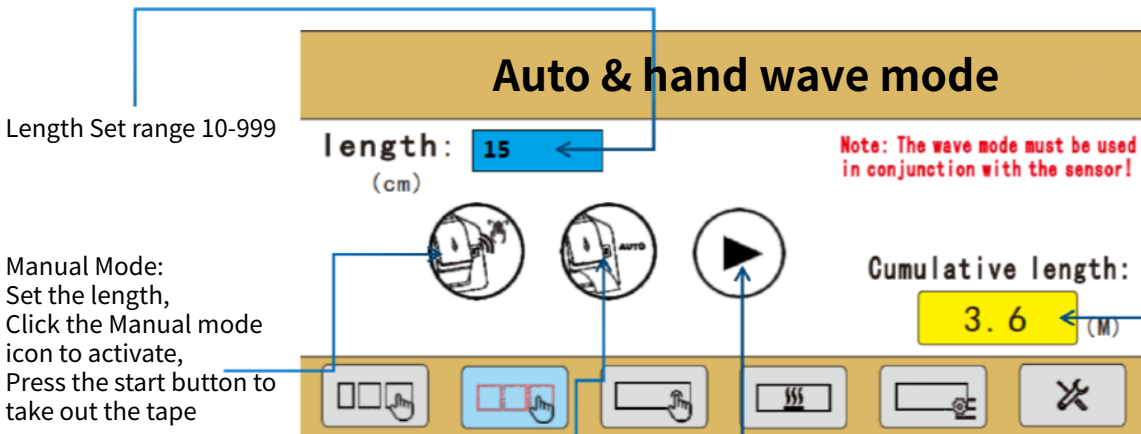

Length Set range 10-999

Manual Mode:
Set the length, Click the Manual mode icon to activate, Press the start button to take out the tape

Automatic mode:
Set the length and click automatic mode icon, press Start
Remove the tape and pull out the next piece of tape automatically

Start and Stop Buttons for Manual Mode and Automatic Mode

Total cumulative length

Manual Mode:

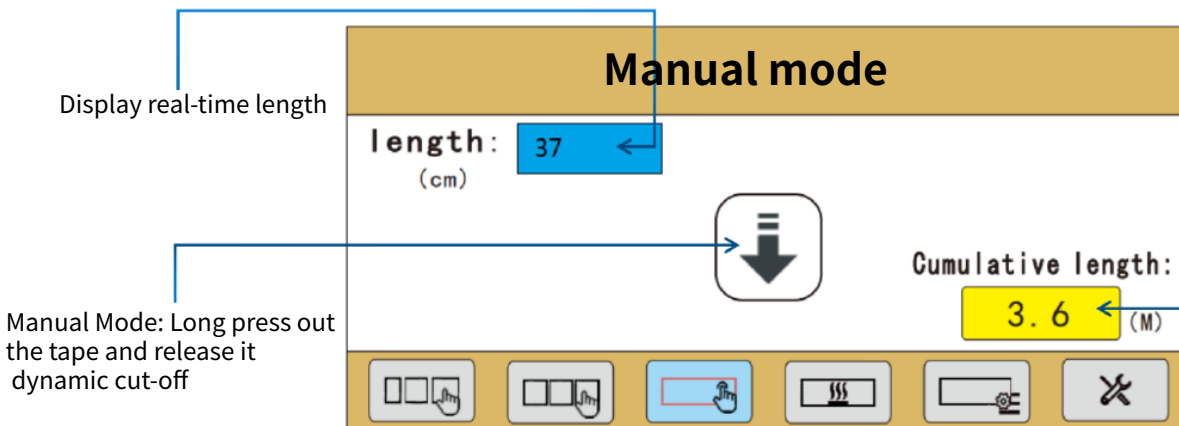

Display real-time length

Manual Mode: Long press out the tape and release it dynamic cut-off

Total cumulative length

Heating Mode:

Heating temperature control:
Click on the corresponding temperature and heating device
Start heating

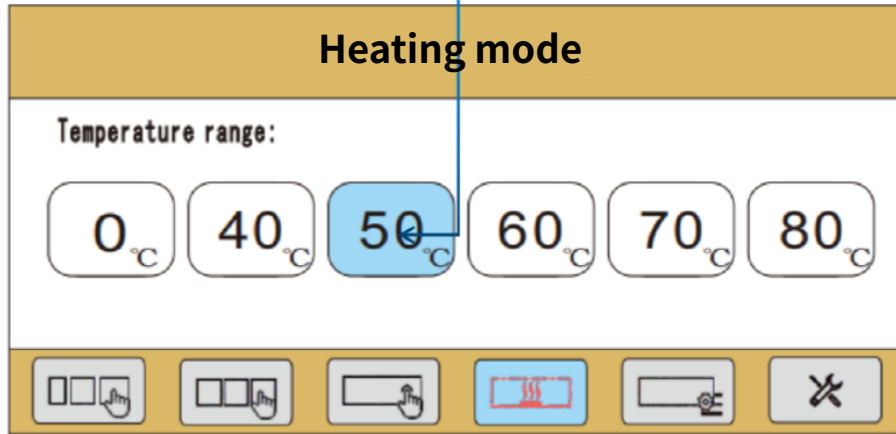

Installation tape:

Installation tape:
Put on the tape as shown in picture 3 on page 6 and hold it down
Icon until the tape sticks out

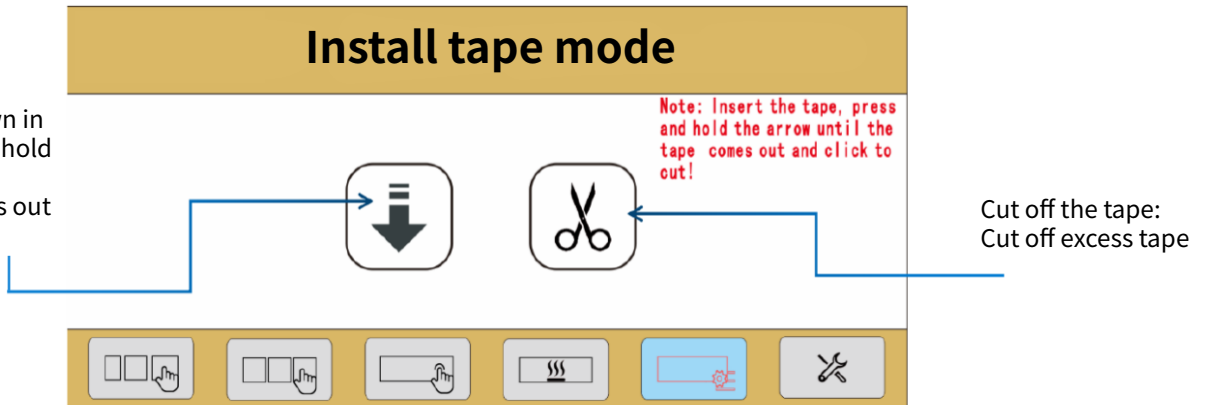

Function set:

LED light switch:
OFF :turns off the indicator light
NO: Turn on the indicator light

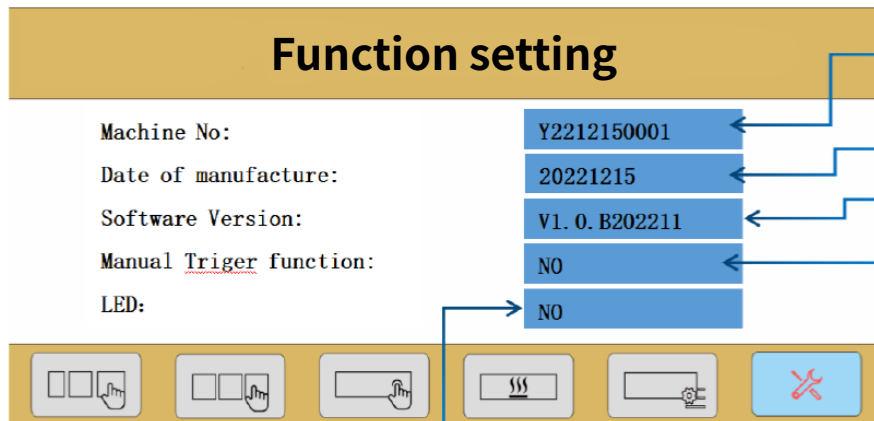

Equipment number

Date of production

Program version

Manual function:
OFF: Turn off the manual mode
NO : Turn on the manual mode
Note: Manual mode only works when it matched sensor

Spacer Plate Installation Instructions

Move the stop plate and install it according to the actual width of the tape.

Figure 1: Lift the upper end of the stop plate up parallel to the corresponding slot of the bevel.

Figure 2: Insert the upper end of the stop plate into the corresponding slot on the inclined plane.

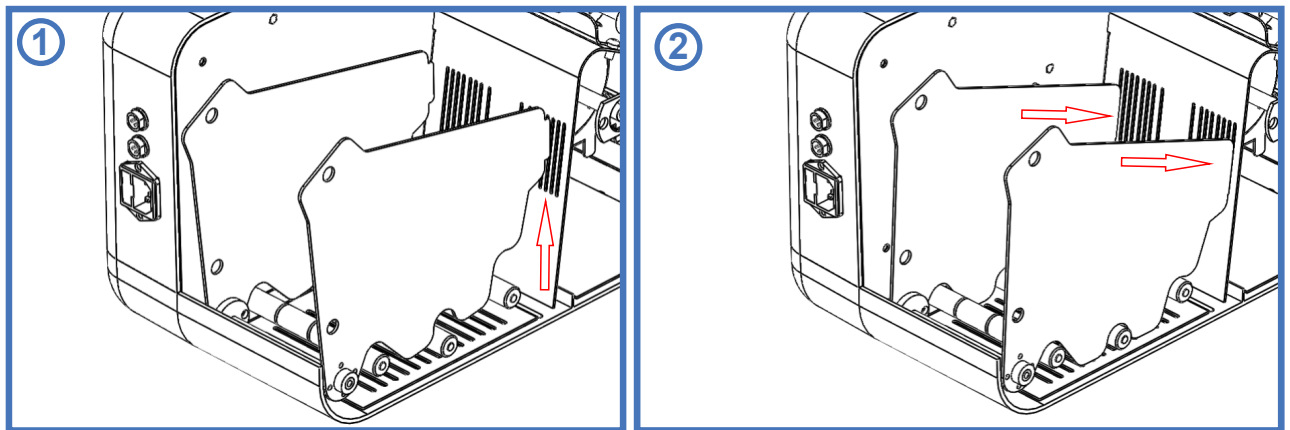

Tape Installation Instructions

Figure 1: Push the tape through the upper guide wheel until it reaches the cutter.

Push the tape through the upper guide wheel until it reaches the cutter.

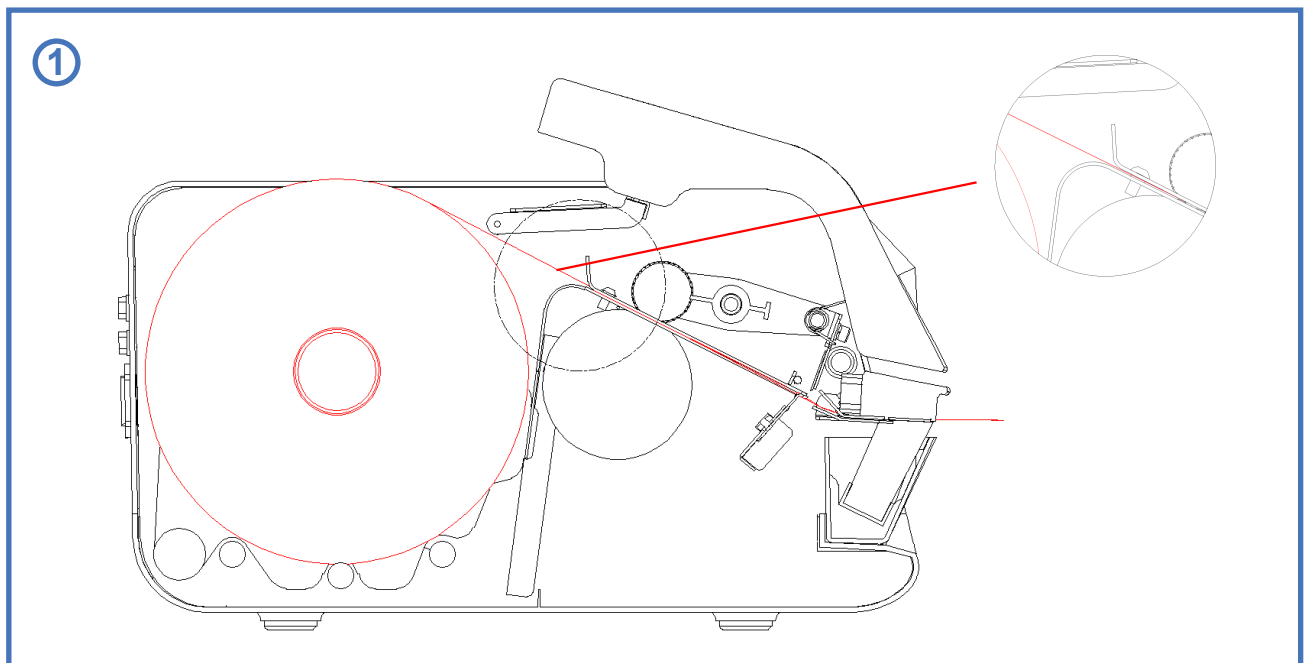

Tank operation instructions

Fill full the tank with water and place it in place.

Figure 1 : Remove tank from machine
Be sure to loosen the buckle and lift it upward when taking out the water tank

Unscrew the lid on the tank and pour the water into the tank

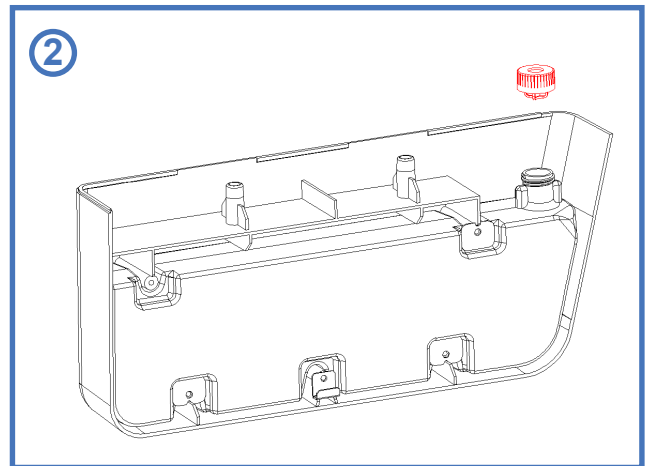
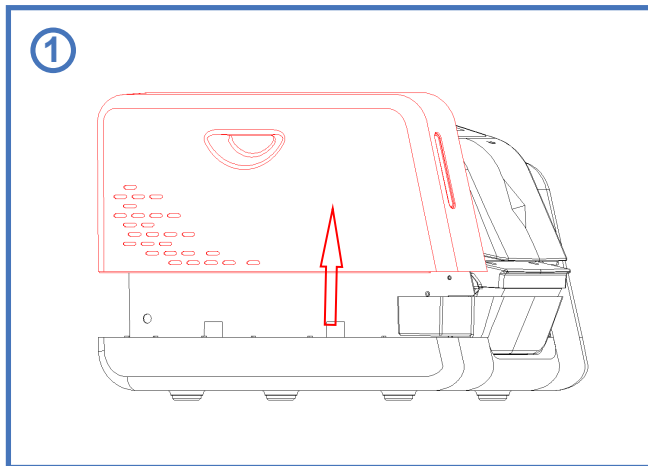

Figure 3 Screw back the cover of the water tank, and install the water tank back on the body in the corresponding position of the buckle.

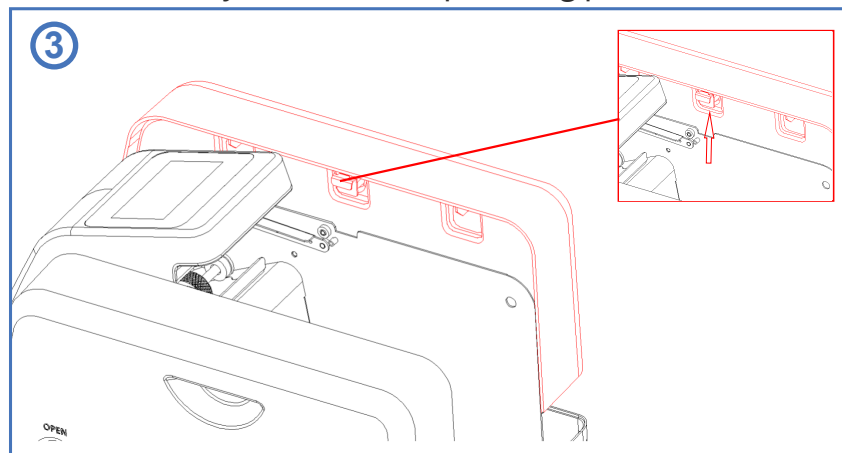

Figure 4 Connect the power cable to power on and press the power button to Start.

