

## Project Details

Name: \_\_\_\_\_ Location: \_\_\_\_\_  
 Specifier: \_\_\_\_\_ Date: \_\_\_\_\_  
 Additional Accessories: Rail Mounting Kit    Power Link Cable    Centipede Cable    Precision Screwdriver

## Part Number Specification | RGBW (5000K)

Model	Voltage	Color Temperature (check box)
TX1 - TRAX Reticular Array	24 - 24VDC Constant Voltage	RGBW - Billions of RGBW colors + dedicated 5000K

Example: TX1-24-RGBW. Customizable options available. See last page for full details.

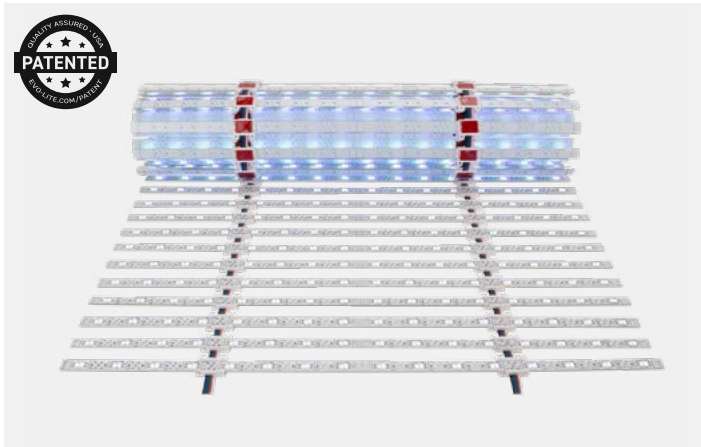

## TRAX Reticular Array (TX1)

### Reticular Backlighting System

#### RGBW (5000K)

**Product Description:** TRAX is the most advanced reticular lighting system ever created. With a product segment best snap-to-size shaping, color clarity, and ease-of-installation, TRAX delivers powerful results for medium to large projects.

### Highlights

- Enjoy billions of saturated RGBW colors, + dedicated 5000K white LEDs for everyday use
- 95+ CRI produces excellent color clarity
- Bright with up to 5,248 lumens per array (5000K only)
- Cut array to length and/or snap LED bars to-size with tool-free snapping increments between every single LED
- IP65 Rated for use in wet and dry locations
- One array covers 16 square feet
- Built in mounting clips or choose the optional rail mounting kit for ultra-fast installs

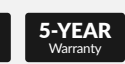

## Specifications | *Listed per full (24" x 96" nominal) TRAX Array.*

Input Voltage	24VDC Constant Voltage
Power Consumption	86 watts per array (5.4W/ft <sup>2</sup> ), 1.34 watts per LED bar, 0.021 watts per LED
Color Temperature	RGBW: billions of RGBW colors + dedicated 5000K white LEDs
CRI	Up to 95+ (5000K only)
Light Output	5,248 lumens per array, 82 lumens per LED bar (5000K only)
Efficiency	Up to 61 lumens per watt (5000K only)
LED Information	64 LEDs per LED bar, 4,096 per array
Wires	18AWG 5-wire (black wire +, red - / green - / blue - / white -)
Connections	Stripped wire ends, 12" length (x4)
Mounting	Integrated wire clips. Optional Rail Mounting Kit.
Operating / Working Temperature	<b>Operating:</b> -13°F to 140°F (-25°C to 60°C), <b>Working:</b> 95°F (35°C)
Surface Temperature	<b>LED:</b> 104°F (40°C), <b>PCB:</b> 90°F (32°C), <b>Resistor:</b> 93°F (34°C) (Measurements taken at ≥ 2 hours of operation)
Environment	IP65 - wet or dry locations
Dimensions	<b>Array:</b> 24" x 96" (610 x 2,438mm) (Nominal), <b>LED Bar:</b> 24" x 0.56" (610 x 14.2mm)
Coverage	16ft <sup>2</sup> per array
Cutting Increments	Snapping segments every 0.75" (19mm), see page 3.
Maximum Run	One full array (86 watts) per 24VDC Class 2 circuit
LED Bar Count / Spacing	64 LED bars per array, spaced 1.5" (38mm) apart on center
Weight	5.51lb per array (2.5kg)
Rated Life	50,000+ hours
Warranty	5-year warranty (view terms online at <a href="http://evo-lite.com/legal-documents">evo-lite.com/legal-documents</a> , section 19)

## Power & Controls

Compatible with all control protocols via associated power and control components. Quality tested for low-end light output consistency across all LEDs (100-0% dimming with tight ANSI bin control).

## Class 2 & UL Compliance

Use Class 2 power supplies with a maximum power output of 96W (per channel/circuit) to retain UL Class 2 Listing compliance. Best practices include allowing headroom for power supply longevity.

## Included With TRAX Array

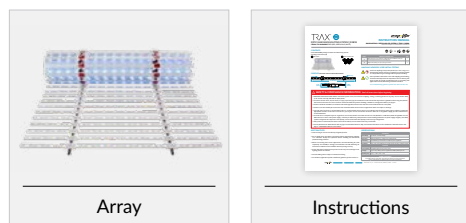

Array

Instructions

## Complete Your System | *View ordering section*

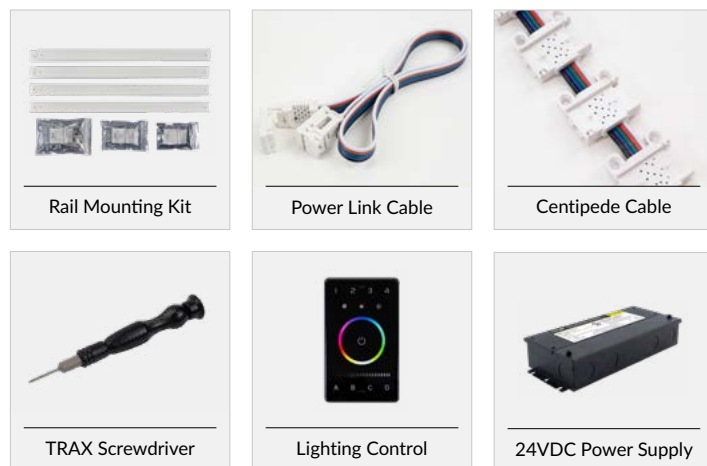

Rail Mounting Kit

Power Link Cable

Centipede Cable

TRAX Screwdriver

Lighting Control

24VDC Power Supply

## Technical Drawings

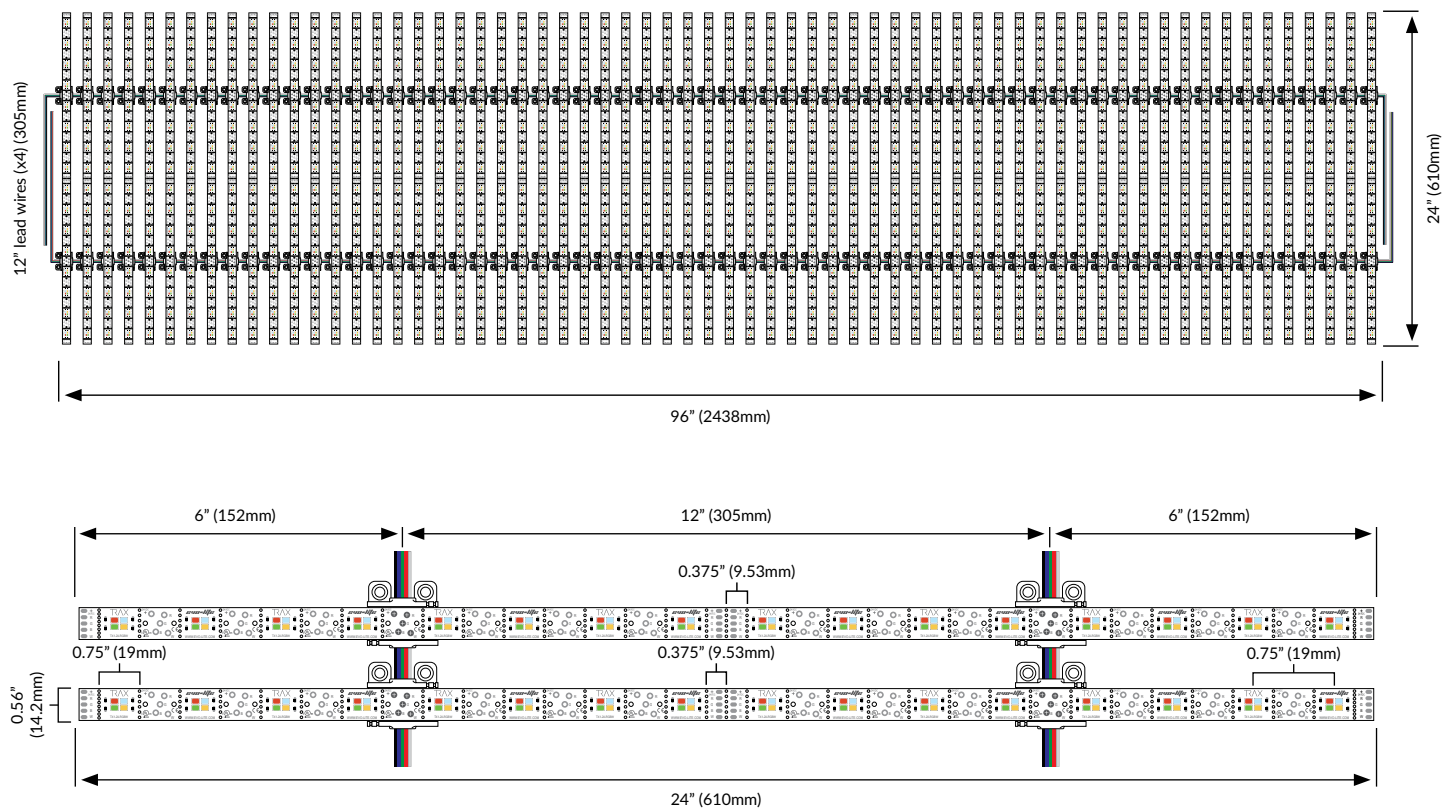

## Ordering | RGBW (5000K)

Model	Voltage	Color Temperature
TX1 - TRAX Reticular Array	24 - 24VDC Constant Voltage	RGBW - RGBW (5000K)

### Example Part Number

TX1	—	24	—	RGBW
Model		Voltage		Color Temperature

## Accessories | Sold Separately

ITEM	PART NUMBER	DESCRIPTION
Rail Mounting Kit	TX1-M-RMK	Rigid, quick-mount kit that fits a single, full sized TRAX Array. Contains 8 sections of 24" rails, 6 rail connectors, 16 rail mounting clips, and 4 rail end mounting clips.
Power Link Cable	TX1-24-RGBW-PLC	5-wire power link cable for RGBW arrays, 24" length. Connects array pieces or array to power.
Centipede Cable - custom length	TX1-RGBW-CPC-C	Connects floating LED bar pieces to array, custom length sold by the foot.
Centipede Cable - full array length	TX1-RGBW-CPC-64	Connects floating LED bar pieces to array, full array length (64 LED bars / 96" full array).

## Suggested Power Options | Sold Separately

ITEM	PART NUMBER	DESCRIPTION
24V, 5-IN-1 Dimmable LED Driver (1 circuit of 96W)	PS-5N1-1C2496-EVO	24VDC 5-IN-1 Dimmable LED Driver. Compatible with most control protocols: Triac / Phase, 0-10V, 1-10V, Potentiometer, and 10V PWM. 1 circuit of 96W.
24V, 5-IN-1 Dimmable LED Driver (2 circuits of 96W each)	PS-5N1-2C24192-EVO	24VDC 5-IN-1 Dimmable LED Driver. Compatible with most control protocols: Triac / Phase, 0-10V, 1-10V, Potentiometer, and 10V PWM. 2 circuits of 96W each.
24V, 5-IN-1 Dimmable LED Driver (4 circuits of 96W each)	PS-5N1-4C24384-EVO	24VDC 5-IN-1 Dimmable LED Driver. Compatible with most control protocols: Triac / Phase, 0-10V, 1-10V, Potentiometer, and 10V PWM. 4 circuits of 96W each.

## Suggested Control Options | Sold Separately

We stock and offer the most popular lighting control types and brands. This product is compatible with all control types via associated control components.

## TRAX Customization Options

All customizations maintain the UL Listing. Minimum order may apply.

- Voltage
- Power/efficiency/brightness
- Specific color temperatures
- IP Ratings
- Custom sizes/shapes
- LED pitch and placement
- PCB material type
- Pre-mounted to quick install substrates

## Custom Power Option Examples

Power (W/ft <sup>2</sup> )	Light Output (Lm/ft <sup>2</sup> ) (5000K only)	Total Array Lumens (1.24ft <sup>2</sup> ) (5000K only)
5.38	328	5,248 (standard)
4.03	246	3,936
2.69	164	2,624
1.34	82	1,312



Visit us online at [evo-lite.com](http://evo-lite.com) to explore the entire TRAX Reticular Backlighting System and our other lighting solutions!

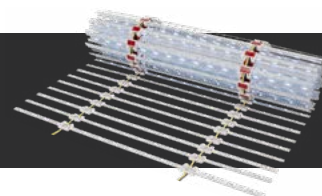

TRAX® is a patented product of Evo-Lite, LLC. For more information please visit [www.evo-lite.com/patent](http://www.evo-lite.com/patent)

This product comes with an advanced 5-year warranty. Please review section 19 of Terms & Conditions of Sale at [evo-lite.com/legal-documents#terms](http://evo-lite.com/legal-documents#terms)



WWW.EVO-LITE.COM • INFO@EVO-LITE.COM • 1-888-887-2980 • ©EVO-LITE, LLC • ARVADA, COLORADO, USA • V2-3725

