



**icon**

**THE SHOWHOME LOOK**

Available options included in your new home

# icon

Our icon collection has been curated to bring a showhome feel to your new home. With attention to detail and a focus on modern design trends, our collection offers elegance and timeless appeal.

Icon's sleek, modern and luxurious finishes have been carefully selected to elevate the look and feel of each space, allowing you to personalise your home to suit your individual taste. Add the same charm and quality found in showhomes to your dream design, creating a home that stands out from the rest.

---

**G&P BUILDERS**

with

**FISHER & PAYKEL**  **caesarstone**<sup>®</sup>

**Colorbond**<sup>®</sup> **paco jaansõn** **enhance**  
kitchen & bathroomware

*Beacon* **Bad und Küche BK** **ARTO**<sup>®</sup> **CORINTHIAN DOORS**  
LIGHTING

*Gainsborough* **PGH BRICKS & PAVERS** **ARCISAN**

**harmony**  **YDLSTONE**





**COOKTOP**  
Fisher & Paykel 900mm  
Black ceramic



**BUILT-IN OVEN**  
Fisher & Paykel 900mm multifunction  
Stainless steel



**RANGEHOOD**  
Fisher & Paykel 900mm undermount  
Stainless steel



**RANGEHOOD**  
Fisher & Paykel 900mm canopy  
Stainless steel



**SINK**  
Paco Jaanson Corsica undermount double bowl  
Stainless steel



**SINK**  
Paco Jaanson Corsica undermount single bowl  
Stainless steel



**DISHWASHER**  
Fisher & Paykel 600mm  
Stainless steel



**SINK**  
Badundkuche Arcko Granite u/o double bowl  
Black granite



**SINK**  
Badundkuche Arcko Granite u/o single bowl  
Black granite



**SINK MIXER**  
Vasari Pulldown g/neck pin or paddle lever  
Available in chrome, black, brushed nickel or brushed gold



**SINK MIXER**  
Harmony Bassini paddle lever  
Available in chrome, black, brushed nickel or brushed gold



**BENCHTOPS**  
Caesarstone / YDL standard range 20mm  
To all kitchen benchtops



**POT DRAWERS\***  
Three deep drawers  
2 sets



**CUTLERY BANK\***  
Four drawers  
1 set



**LOWERS + OVERHEADS\***  
Dishwasher & microwave space (if applicable)  
As per plan

\*For illustrative purposes only - cabinetry handles not shown in image. | u/o: undermount / overmount



**WALL BASIN / BATH MIXER**  
 Enhance Nobel pin lever  
 Available in chrome, black, brushed nickel or brushed gold



**WALL BASIN / BATH MIXER**  
 Harmony Bassini paddle lever  
 Available in chrome, black, brushed nickel or brushed gold



**WALL BASIN / BATH MIXER**  
 Enhance Nobel w/ backing plate pin lever  
 Available in chrome, black, brushed nickel or brushed gold



**WALL BASIN / BATH MIXER**  
 Harmony Bassini w/ backing plate paddle lever  
 Available in chrome, black, brushed nickel or brushed gold



**BASIN**  
 Arto 400 Round above counter  
 White



**BASIN**  
 Arto 7129 Square above counter  
 White



**BASIN MIXER**  
 Enhance Nobel pin lever  
 Available in chrome, black, brushed nickel or brushed gold

OR



**BASIN MIXER**  
 Harmony Bassini paddle lever  
 Available in chrome, black, brushed nickel or brushed gold

+



**BASIN**  
 Arto 7130B above counter w/ mixer hole  
 White



**PLUG + WASTE**  
 Arcisan 32mm  
 Available in chrome, white or black



**SHOWER MIXER**  
 Enhance Nobel pin lever  
 Available in chrome, black, brushed nickel or brushed gold



**SHOWER MIXER**  
 Harmony Bassini paddle lever  
 Available in chrome, black, brushed nickel or brushed gold



**SHOWER CEILING DROPPER**  
 Handel Plus 250mm round  
 Available in chrome, black, brushed nickel or brushed gold



**SHOWER CEILING DROPPER**  
 Harmony Rondo 250mm square  
 Available in chrome, black, brushed nickel or brushed gold



**BATH TUB**  
 Decina Novara inset  
 White



**SHOWER RAIL**  
 Enhance Nobel plus round  
 Available in chrome, black, brushed nickel or brushed gold



**SHOWER RAIL**  
 Harmony Rondo square  
 Available in chrome, black, brushed nickel or brushed gold



**COMBINATION SHOWER**  
 Harmony Handel Plus 250mm round  
 Available in chrome, black, brushed nickel or brushed gold



**COMBINATION SHOWER**  
 Harmony Rondo 250mm square  
 Available in chrome, black, brushed nickel or brushed gold



**DOUBLE TOWEL RAIL**  
 Enhance Meno Plus round  
 Available in chrome, black, brushed nickel or brushed gold



**DOUBLE TOWEL RAIL**  
 Harmony Rondo square  
 Available in chrome, black, brushed nickel or brushed gold



**TOILET ROLL HOLDER**  
 Enhance Meno Plus round  
 Available in chrome, black, brushed nickel or brushed gold



**TOILET ROLL HOLDER**  
 Harmony Rondo square  
 Available in chrome, black, brushed nickel or brushed gold



**TOILET SUITE**  
 Alpha Tornado  
 White

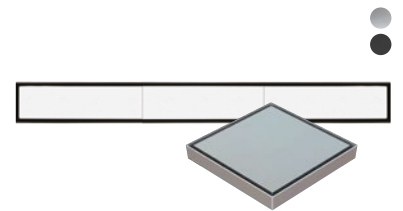

**FLOOR WASTE**  
 Tiled Bermuda/Bar Grate (where applicable)  
 Available in chrome or black



**BENCHTOPS**  
 Caesarstone / YDL standard range 20mm  
 To all bathroom benchtops



**CABINETRY\***  
 Soft closing  
 Drawers to ensuite only

\*For illustrative purposes only - cabinetry handles not shown in image.



**TUB**  
Portsea 45L Flushline  
Stainless steel



**TUB MIXER**  
Vasari Pulldown g/neck pin or paddle lever  
Available in chrome, black, brushed nickel or brushed gold



**TUB MIXER**  
Harmony Bassini paddle lever  
Available in chrome, black, brushed nickel or brushed gold



**WASHING MACHINE STOPS**  
¼ turn  
Chrome only



**BENCHTOP**  
Laminate standard range  
To laundry benchtop



**LOWERS\***  
Soft closing + washer/dryer space (if applicable)  
As per plan



**INTERNAL FAN & LIGHT**  
Aria 122cm  
Available in white or black



**INTERNAL/ALFRESCO FAN**  
Aria 122cm  
Available in white or black



**BAR GARAGE LIGHT**  
Dawn II Flush Mount  
White



**DOWNLIGHT**  
Eclipse LED  
White



**3-IN-1 BATHROOM HEATER**  
Thermalite  
Available in white or silver



**LED EXHAUST FAN**  
Skyline (if applicable)  
White



**EXTERIOR WALL LIGHT**  
Sentinel 2  
Available in stainless steel or black



**EXTERIOR WALL LIGHT**  
Riga  
Available in metallic black or stainless steel



**FLOODLIGHT**  
LEDLux Alert 2  
Available in white or black

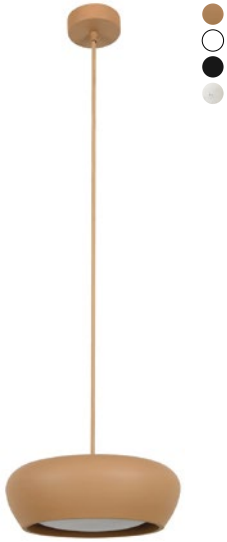

**PENDANT**  
Fjord 1 Light Squat  
Available in clay, white, black or stone

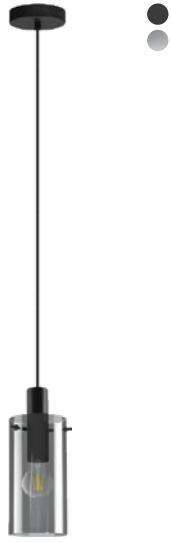

**PENDANT**  
Lamode  
Available in black or brushed chrome



**PENDANT**  
Callam Medium  
Available in bronze or black



**PENDANT**  
Solis 1  
Available in black or white



**PENDANT**  
July 1 Bottle  
Texture chalk



**PENDANT**  
July 1 Dome  
Texture chalk



**PENDANT**  
July 1 Round  
Texture chalk



**PENDANT**  
Surface LED 150mm  
Available in black or white

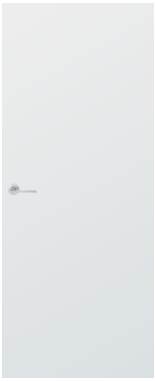

**INTERNAL DOOR**  
Flush Primed  
Painted



**INTERNAL DOOR**  
Motive MOTP 2  
Painted



**INTERNAL DOOR**  
Motive MOTP 2V  
Painted



**INTERNAL DOOR**  
Motive MOTP 3D  
Painted



**EXTERNAL DOOR**  
Backdoor 7 (if appl.)  
Painted



**ENTRY DOOR**  
Madison PMAD101  
Painted



**ENTRY DOOR**  
Madison PMAD104  
Painted



**ENTRY DOOR**  
Slimlite PSLM201  
Painted



**ENTRY DOOR**  
Slimlite PSLM204  
Painted



**WIDE ENTRY DOOR**  
PSLM PV208 (if appl.)  
Painted



**WIDE ENTRY DOOR**  
PMAD PV104 (if appl.)  
Painted



**WIDE ENTRY DOOR**  
PPENWS 1 (if appl.)  
Painted



**WIDE ENTRY DOOR**  
PPENWS 4 (if appl.)  
Painted



**WIDE ENTRY DOOR**  
PPENWS 2G (if appl.)  
Painted



**WIDE ENTRY DOOR**  
PPENWS 4G (if appl.)  
Painted



**WIDE ENTRY DOOR**  
AWOWS 21 (if appl.)  
Blonde oak - stained



**WIDE ENTRY DOOR**  
AWOWS 5VG (if appl.)  
Blonde oak - stained



**WIDE ENTRY DOOR**  
AWOWS 5G (if appl.)  
Blonde oak - stained



**WIDE ENTRY DOOR**  
AWOWS 19H (if appl.)  
Blonde oak - stained

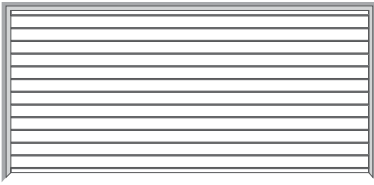

**GARAGE DOOR**  
Slimline  
Standard Colour Range (timber look range available POA)

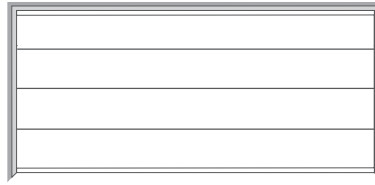

**GARAGE DOOR**  
Flatline  
Standard Colour Range (timber look range available POA)



**GARAGE DOOR**  
Glacier  
Standard Colour Range

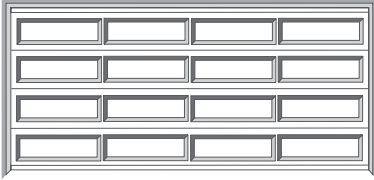

**GARAGE DOOR**  
Ranch  
Standard Colour Range

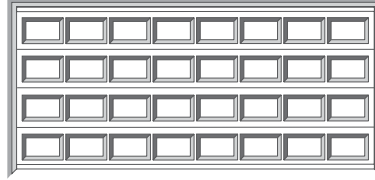

**GARAGE DOOR**  
Heritage  
Standard Colour Range



**ENTRANCE DOOR FURNITURE**  
Gainsborough Trilock Angular  
Available in satin chrome or matte black



**ENTRANCE DOOR FURNITURE**  
Gainsborough Trilock Align  
Available in satin chrome only



**INTERNAL DOOR FURNITURE**  
Gainsborough Neue Angular  
Available in satin chrome or matte black



**INTERNAL DOOR FURNITURE**  
Gainsborough Amelia Round  
Available in satin chrome or matte black



**INTERNAL CAVITY DOOR FURNITURE**  
Gainsborough Circular sliding set  
Available in satin chrome or matte black



**MOULDING**  
Pencil Round\*  
Painted

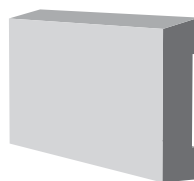

**MOULDING**  
Splayed\*  
Painted



**CORNICE**  
Cove 90mm  
Painted



**LETTERBOX**  
Pre-fabricated  
Painted



**ANTENNA**  
Provisions  
As per spec



**NBN**  
Provisions  
As per spec

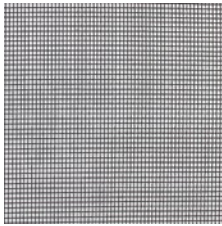

**FLYSCREENS**  
Not including hinged doors  
Black



**ROOF, FASCIAS & GUTTERS**  
Colorbond  
Select Colorbond ranges only



**WATER TANK/S**  
Poly  
If applicable



**CLOTHESLINE**  
Daytek Single Fold Down  
Available in light grey or anthracite black



**HOT WATER SYSTEM**  
Rheem (setup dependent on home size)  
Grey



**DRIVEWAY**  
Exposed aggregate or plain brushed concrete  
Type & quantity as per plan/spec



**CONCRETE TO PORCH & ALFRESCO**  
Broom finish  
Quantity as per plan/spec



**CONVENTIONAL FOOTINGS & SLAB**  
M site with cut/fill to suit\*  
As per plan/spec



**INSULATION**  
R3.0 batts, Anticon blanket & R1.5 wall batts  
As per spec



**FRAME & TRUSSES**  
T2 Treated Timber  
As per spec



**TERMITE MANAGEMENT**  
Termimesh system  
As per plan/spec



**HSTP**  
Taylex  
If applicable



**BRICK**  
Girraween - single height  
Lifestyle



**BRICK**  
Perisher - single height  
Lifestyle



**BRICK**  
Perisher - double height  
Lifestyle

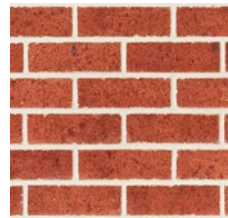

**BRICK**  
St George - single height  
Hinterlands



**BRICK**  
Airlie - single height  
Horizon



**BRICK**  
Emerald - single height\*  
Horizon

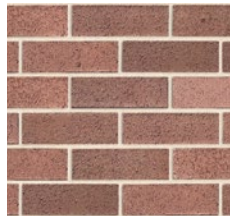

**BRICK**  
Chinchilla - single height\*  
Horizon

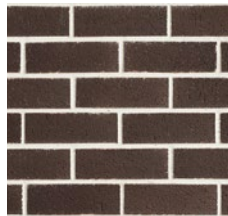

**BRICK**  
Breaking Dawn - single height  
Lunar



**BRICK**  
Crescent - single height  
Lunar

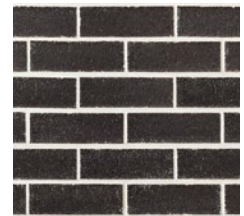

**BRICK**  
Eclipse - single height  
Lunar



**BRICK**  
Grey Stone - single height  
Lunar



**BRICK**  
Frost - single height  
Naturals



**BRICK**  
Moon Dust - single height  
Naturals



**BRICK**  
Elkhorn - single height  
Shoreline



**BRICK**  
Ocean Mist - single height  
Shoreline



**BRICK**  
Ocean Mist - double height  
Shoreline



**BRICK**  
Sea Whip - single height  
Shoreline



**BRICK**  
Sea Fossil - single height  
Shoreline



**BRICK**  
Driftwood grey - single height  
Coastal Hamptons



**BRICK**  
Montauk - single height  
Coastal Hamptons

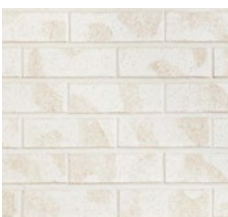

**BRICK**  
Washed White - single height  
Coastal Hamptons



**BRICK**  
Agave - single height  
Zen

\*Flashing (dark markings) can feature within this collection.



**COOKTOP**  
Fisher & Paykel Induction 600mm\*  
Black glass



**COOKTOP**  
Fisher & Paykel Induction 900mm\*  
Black glass



**COOKTOP**  
Fisher & Paykel Gas 900mm\*  
Stainless steel



**FREESTANDING COOKER**  
Fisher & Paykel 90cm Dual Fuel\*  
Black



**BATHTUB**  
Decina Prezzo freestanding\*  
White



**BATHTUB**  
Cortona wall faced  
White



**FREESTANDING BATH SPOUT**  
Round\*  
Available in chrome, black, brushed nickel or brushed brass



**TILING**  
600 x 600mm Cushion Edge  
In lieu of 450 x 450mm

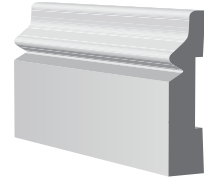

**MOULDING†**  
QLD Colonial\*  
Painted

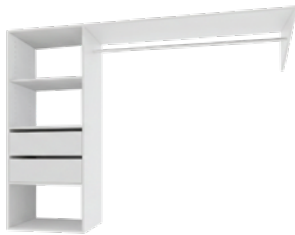

**WARDROBE FITOUT**  
Type D\*  
As per plan/spec

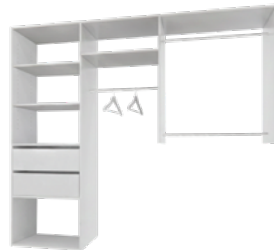

**WARDROBE FITOUT**  
Type E\*  
As per plan/spec



**WARDROBE FITOUT**  
Type F\*  
As per plan/spec



**INTERNAL DOOR FURNITURE**  
Gainsborough Avant Alba lever set\*  
Available in stainless steel, matte black, satin brass



**ENTRANCE DOOR FURNITURE**  
Gainsborough Trilock Omni pull handle\*  
Available in stainless steel, matte black, satin brass



**INTERNAL DOOR**  
Deco 10s\*  
Painted



**INTERNAL DOOR**  
Deco 11s\*  
Painted

## NCC 2022

- All of our homes are designed and built to meet NCC 2022 requirements. This includes requirements for; liveable housing, heat pump hot water system, 7 Star NatHERS rating to all orientations and ceiling fans to all habitable rooms.

## PEACE OF MIND

- Termimesh stainless steel termite protection
- H2F/T2 green/blue treated pine framing timber
- Colorbond roof, fascias and gutters as standard - choose from Colorbond classic and contemporary colour range
- Standard building and plumbing approval fees included
- HIA building contract and indemnity 12 month maintenance period
- Engineered traditional/conventional steel reinforced concrete footings and slab to M soil classification
- Allowance for up to 1 metre cut and fill (urban blocks) as standard
- Allowance for up to 1.5 metre cut and fill (acreage blocks) as standard
- Full colour consultancy (1 x exterior colour meeting & 1 x interior colour meeting)
- 3 coats of quality paint to internal areas including 2 coat system to external areas
- R3.0 ceiling batts to ceiling areas including garage, alfresco and porch
- R1.5 wall batts to all external walls
- Key locks to all windows and sliding doors
- Electric hot water system - Heat Pump

## INTERNAL

- 8'6" foot (2590mm) ceiling heights throughout
- 90mm boral cornice throughout as standard
- Choice of quality Corinthian pine architraves and skirting
- Choice of Corinthian range of entry doors: Madison, Slimlite and Wide Entry - painted or stained (5VG/5G doors only) - door size dependant on plan
- Choice of Gainsborough G2 series - contemporary external trilock to entry door: align or angular
- Choice of Corinthian Flush Primed or Motive door to internal doors - painted
- Choice of Gainsborough G2 Series - contemporary internal lever and privacy sets throughout: round or angular
- Choice of panel-lift garage door profiles in range of Colorbond colours with door motor and 3 remotes (1 x wall remote & 2 x keychain remotes)
- Built-in robes in all bedrooms with shelf and rail (option for robe fitout)
- Vinyl sliding doors to bedroom robes as standard (option for mirrored sliding doors\*)
- Family size linen cupboard/s
- Icon carpet range with 8mm Dunlop Red/10mm Airstep underlay to all bedrooms and robes/WIR (media and study if applicable)
- Extensive range of icon tiles up to 450mm x 450mm ceramic cushion edge or icon vinyl planking to all main floor areas, hallways and linen cupboard/s (activity and study if applicable)

## KITCHEN APPLIANCES

- 900mm electric cooktop
- 900mm undermount or canopy rangehood
- 900mm electric oven
- 600mm dishwasher

## KITCHEN FIXTURES & FINISHES

- Choice of kitchen sink/s
- Pulldown g/neck sink mixer

## KITCHEN BENCHTOPS

- 20mm Caesarstone to kitchen and island benchtops with wide selection of colours from builders' range: Caesarstone and YDL Stone standard range.

## KITCHEN JOINERY

- Overhead cupboards as indicated on plans and bulkhead over refrigerator space
- Floor cupboards throughout kitchen
- 1 set of 4 x cutlery stack soft closing drawers
- 2 sets of 3 x pot soft closing drawers up to 1000mm wide
- Microwave space with 1x pot drawer in lower cabinet (if applicable)
- Choice of melamine colours for cupboards: Polytec - matte, sheen, abstract and timberprint
- Range of stylish handles to all drawers and cupboards with option for seamless look POA\* - no handles to overhead cupboards only
- Pantry with 4 shelves
- PVC edges to all drawers and cupboards
- Dishwasher recess with water and power connections underneath bench through cupboards

## ENSUITE, BATHROOM & POWDER BENCHTOPS

- 20mm Caesarstone to ensuite, bathroom and powder room (if applicable: powder room POA\*) with wide selection of colours from builders' range: Caesarstone and YDL Stone standard range.

## ENSUITE, BATHROOM & POWDER JOINERY

- Full length vanity cupboards
- 1 set of 3 x drawers to ensuite vanity only
- Range of stylish handles to all drawers and cupboards with option for seamless look POA\*
- Wide choice of melamine colours for cupboards: Polytec - matte, sheen, abstract, timberprint

## ENSUITE, BATHROOM & POWDER FIXTURES & FINISHES

- Choice of ceramic white basins
- Back to wall toilet suite with soft closing lid
- Choice of stylish mixer taps
- Choice of shower outlets
- Quality ceramic wall and floor tiles from icon range
- 2000mm high tiling to shower area
- 600mm high tiling above bath tub
- Tiled floors and skirting throughout including 300mm high tiled splashback above vanities (powder room if applicable)
- Full length mirror to above vanity (frameless or microframe)
- Perimeter frame, clear laminated glass shower screens with pivot door as standard
- Privacy latch to bathroom and toilet doors
- Bermuda tile waste or bar grate (where applicable)
- Deflector on all shower screen doors as per liveability laws

## EXTERNAL

- Flyscreens to all sliding doors and windows
- Extensive range of PGH bricks with natural mortar
- Modena rendered and painted letterbox
- Wall mounted folding clothesline
- Plain concrete (broom finish) to alfresco and porch with option to upgrade to builders' range of exposed aggregates POA\*
- 2 external garden taps as standard
- Sewer treatment plant (acreage blocks)
- Concrete driveway:
  - Residential blocks - up to 50m<sup>2</sup> of exposed aggregate concrete from builders' range
  - Acreage blocks - up to 85m<sup>2</sup> of plain concrete (broom finish)

## BRICK DISCLAIMER

Clay bricks are made from naturally occurring minerals. Variations in colour, texture and size are natural characteristics of clay products and production variations can occur from batch to batch. Colours shown are indicative only.

## TYPICAL ELECTRICAL QUANTITIES

- Lighting plan provided with quotation and selections available
- 6-8 downlights to dining/family/kitchen area
- 2-3 pendant lights to kitchen island bench
- 2-4 downlights to media, multi-purpose areas (if applicable)
- 1 fan/light per bedroom
- 1 fan to each living area (media, study, activity etc. where applicable)
- 3-in-1 fan/light unit to ensuite and main bathroom
- 1 downlight to laundry, WC, walk-in linen/s and walk-in robe/s (PWD room if applicable)
- 1 bar light to garage
- Downlights to hallway/s and entryway
- 3-5 downlights to external areas including porch and alfresco
- Outdoor fan to alfresco as standard
- 2-3 double powerpoints to kitchen including island bench (if required)
- 2 double powerpoints per dining and family including living areas (media, activity, rumpus - if applicable)
- 2 double powerpoints per bedroom including study (if applicable)
- 1 double powerpoint to ensuite, main bathroom, laundry and garage (PWD room if applicable)
- 1 weatherproof double powerpoint for external use
- 5 predetermined single powerpoints for fridge, microwave and dishwasher spaces, garage door motor and rangehood
- 2 TV points with TV antenna (if applicable)
- 2 phone or data points with NBN connection plate only (if applicable) - available upgrade to NBN data box (POA)
- Allowance for three phase underground power as standard (dependant on available power supply)
- Allowance for heat pump HWS connections
- Allowance for connections: NBN/fibre optics (if applicable), air conditioning, home sewer treatment plant and water tanks (if applicable)

Disclaimer: electrical inclusions are largely dependent on the style (i.e. high/raked ceiling) and size of the dwelling. Quantities and allowances will be proportionalised in accordance with these.

## OTHER ITEMS WE CAN ASSIST WITH

- Water tanks
- Air conditioning

## DEFINITIONS

POA: Price On Application

HSTP: Home Sewerage Treatment Plant

NBN: National Broadband Network

## EXAMPLE OF ELECTRICAL PLAN

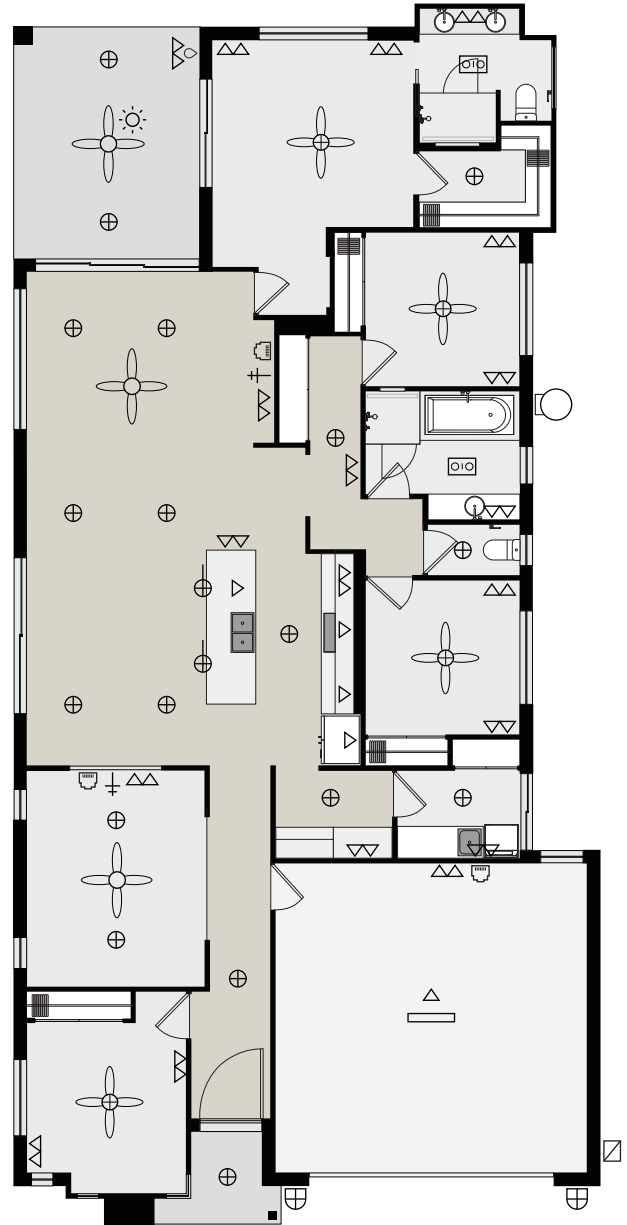

## PLAN KEY

⊕	LED DOWNLIGHT	⊕	3-IN-1 TASTIC
△	SINGLE POWER POINT	⊕	AERIAL
△△	DOUBLE POWER POINT	⊕	DATA POINT
△△	WATERPROOF POWER POINT	⊕	PENDANT
⊕	FAN WITH LED LIGHT	⊕	METER BOX
⊕	FAN	⊕	PILLAR LIGHT
⊕	OUTDOOR FAN	⊕	HEAT PUMP HWS
—	LED BAR LIGHT		



# icon

G & P Builders Pty. Ltd. | QBCC 22485

Icon Inclusion Range

The colours and finishes of products shown in this booklet are an indication of the actual colour/finish.

Tel (07) 3463 9463  
Web [www.gpbuilder.com.au](http://www.gpbuilder.com.au)  
Email [info@gpbuilder.com.au](mailto:info@gpbuilder.com.au)

Office  
15/21 Technology Drive  
Augustine Heights QLD 4300

f@gpbuilder @gpbuilder

