



icon

THE SHOWHOME LOOK
Available options included in your new home

icon

Our icon collection has been curated to bring a showhome feel to your new home. With attention to detail and a focus on modern design trends, our collection offers elegance and timeless appeal.

Icon's sleek, modern and luxurious finishes have been carefully selected to elevate the look and feel of each space, allowing you to personalise your home to suit your individual taste. Add the same charm and quality found in showhomes to your dream design, creating a home that stands out from the rest.

G&P BUILDERS

with

FISHER & PAYKEL  **caesarstone**[®]

Colorbond[®] **paco jaansõn** **enhance**
kitchen & bathroomware

Beacon **Bad und Küche BK** **ARTO**[®] **CORINTHIAN DOORS**
LIGHTING

Gainsborough **PGH BRICKS & PAVERS** **ARCISAN**

harmony  **YDLSTONE**





COOKTOP
Fisher & Paykel 900mm
Black ceramic



BUILT-IN OVEN
Fisher & Paykel 900mm multifunction
Stainless steel



RANGEHOOD
Fisher & Paykel 900mm undermount
Stainless steel



RANGEHOOD
Fisher & Paykel 900mm canopy
Stainless steel



SINK
Paco Jaanson Corsica undermount double bowl
Stainless steel



SINK
Paco Jaanson Corsica undermount single bowl
Stainless steel



DISHWASHER
Fisher & Paykel 600mm
Stainless steel



SINK
Badundkuche Arcko Granite u/o double bowl
Black granite



SINK
Badundkuche Arcko Granite u/o single bowl
Black granite



SINK MIXER
Vasari Pulldown g/neck pin or paddle lever
Available in chrome, black, brushed nickel or brushed gold



SINK MIXER
Harmony Bassini paddle lever
Available in chrome, black, brushed nickel or brushed gold



BENCHTOPS
Caesarstone / YDL standard range 20mm
To all kitchen benchtops



POT DRAWERS*
Three deep drawers
2 sets



CUTLERY BANK*
Four drawers
1 set



LOWERS + OVERHEADS*
Dishwasher & microwave space (if applicable)
As per plan

*For illustrative purposes only - cabinetry handles not shown in image. | u/o: undermount / overmount



WALL BASIN / BATH MIXER
Enhance Nobel pin lever
Available in chrome, black, brushed nickel or brushed gold



WALL BASIN / BATH MIXER
Harmony Bassini paddle lever
Available in chrome, black, brushed nickel or brushed gold



WALL BASIN / BATH MIXER
Enhance Nobel w/ backing plate pin lever
Available in chrome, black, brushed nickel or brushed gold



WALL BASIN / BATH MIXER
Harmony Bassini w/ backing plate paddle lever
Available in chrome, black, brushed nickel or brushed gold



BASIN
Arto 400 Round above counter
White



BASIN
Arto 7129 Square above counter
White



BASIN MIXER
Enhance Nobel pin lever
Available in chrome, black, brushed nickel or brushed gold

OR



BASIN MIXER
Harmony Bassini paddle lever
Available in chrome, black, brushed nickel or brushed gold

+



BASIN
Arto 7130B above counter w/ mixer hole
White



PLUG + WASTE
Arcisan 32mm
Available in chrome, white or black



SHOWER MIXER
Enhance Nobel pin lever
Available in chrome, black, brushed nickel or brushed gold



SHOWER MIXER
Harmony Bassini paddle lever
Available in chrome, black, brushed nickel or brushed gold



SHOWER CEILING DROPPER
Handel Plus 250mm round
Available in chrome, black, brushed nickel or brushed gold



SHOWER CEILING DROPPER
Harmony Rondo 250mm square
Available in chrome, black, brushed nickel or brushed gold



BATH TUB
Decina Novara inset
White



SHOWER RAIL
 Enhance Nobel plus round
 Available in chrome, black, brushed nickel or brushed gold



SHOWER RAIL
 Harmony Rondo square
 Available in chrome, black, brushed nickel or brushed gold



COMBINATION SHOWER
 Harmony Handel Plus 250mm round
 Available in chrome, black, brushed nickel or brushed gold



COMBINATION SHOWER
 Harmony Rondo 250mm square
 Available in chrome, black, brushed nickel or brushed gold



DOUBLE TOWEL RAIL
 Enhance Meno Plus round
 Available in chrome, black, brushed nickel or brushed gold



DOUBLE TOWEL RAIL
 Harmony Rondo square
 Available in chrome, black, brushed nickel or brushed gold



TOILET ROLL HOLDER
 Enhance Meno Plus round
 Available in chrome, black, brushed nickel or brushed gold



TOILET ROLL HOLDER
 Harmony Rondo square
 Available in chrome, black, brushed nickel or brushed gold



TOILET SUITE
 Alpha Tornado
 White

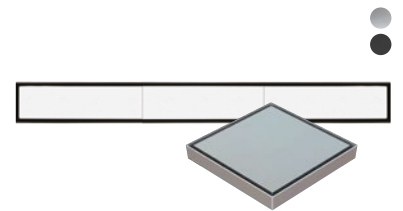

FLOOR WASTE
 Tiled Bermuda/Bar Grate (where applicable)
 Available in chrome or black



BENCHTOPS
 Caesarstone / YDL standard range 20mm
 To all bathroom benchtops



CABINETRY*
 Soft closing
 Drawers to ensuite only

*For illustrative purposes only - cabinetry handles not shown in image.



TUB
Portsea 45L Flushline
Stainless steel



TUB MIXER
Vasari Pulldown g/neck pin or paddle lever
Available in chrome, black, brushed nickel or brushed gold



TUB MIXER
Harmony Bassini paddle lever
Available in chrome, black, brushed nickel or brushed gold



WASHING MACHINE STOPS
¼ turn
Chrome only



BENCHTOP
Laminate standard range
To laundry benchtop



LOWERS*
Soft closing + washer/dryer space (if applicable)
As per plan



INTERNAL FAN & LIGHT
Aria 122cm
Available in white or black



INTERNAL/ALFRESCO FAN
Aria 122cm
Available in white or black



BAR GARAGE LIGHT
Dawn II Flush Mount
White



DOWNLIGHT
Eclipse LED
White



3-IN-1 BATHROOM HEATER
Thermalite
Available in white or silver



LED EXHAUST FAN
Skyline (if applicable)
White



EXTERIOR WALL LIGHT
Sentinel 2
Available in stainless steel or black



EXTERIOR WALL LIGHT
Riga
Available in metallic black or stainless steel



FLOODLIGHT
LEDLux Alert 2
Available in white or black

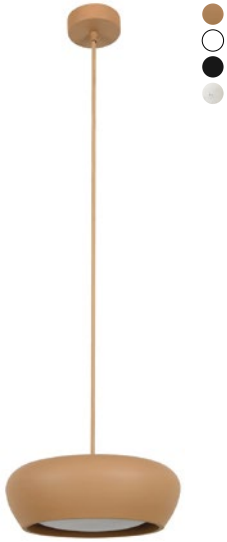

PENDANT
Fjord 1 Light Squat
Available in clay, white, black or stone

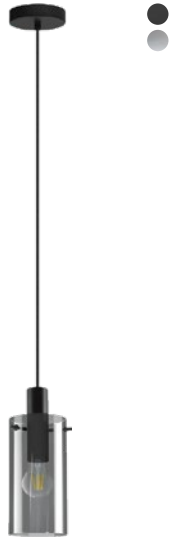

PENDANT
Lamode
Available in black or brushed chrome



PENDANT
Callam Medium
Available in bronze or black



PENDANT
Solis 1
Available in black or white



PENDANT
July 1 Bottle
Texture chalk



PENDANT
July 1 Dome
Texture chalk



PENDANT
July 1 Round
Texture chalk



PENDANT
Surface LED 150mm
Available in black or white

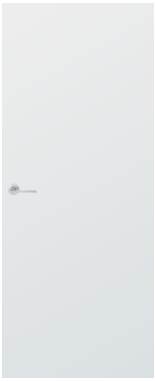

INTERNAL DOOR
Flush Primed
Painted



INTERNAL DOOR
Motive MOTP 2
Painted



INTERNAL DOOR
Motive MOTP 2V
Painted



INTERNAL DOOR
Motive MOTP 3D
Painted



EXTERNAL DOOR
Backdoor 7 (if appl.)
Painted



ENTRY DOOR
Madison PMAD101
Painted



ENTRY DOOR
Madison PMAD104
Painted



ENTRY DOOR
Slimlite PSLM201
Painted



ENTRY DOOR
Slimlite PSLM204
Painted



WIDE ENTRY DOOR
PSLM PV208 (if appl.)
Painted



WIDE ENTRY DOOR
PMAD PV104 (if appl.)
Painted



WIDE ENTRY DOOR
PPENWS 1 (if appl.)
Painted



WIDE ENTRY DOOR
PPENWS 4 (if appl.)
Painted



WIDE ENTRY DOOR
PPENWS 2G (if appl.)
Painted



WIDE ENTRY DOOR
PPENWS 4G (if appl.)
Painted



WIDE ENTRY DOOR
AWOWS 21 (if appl.)
Blonde oak - stained



WIDE ENTRY DOOR
AWOWS 5VG (if appl.)
Blonde oak - stained



WIDE ENTRY DOOR
AWOWS 5G (if appl.)
Blonde oak - stained



WIDE ENTRY DOOR
AWOWS 19H (if appl.)
Blonde oak - stained

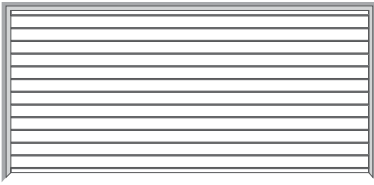

GARAGE DOOR
Slimline
Standard Colour Range (timber look range available POA)

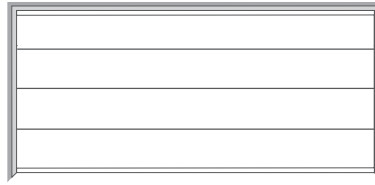

GARAGE DOOR
Flatline
Standard Colour Range (timber look range available POA)



GARAGE DOOR
Glacier
Standard Colour Range

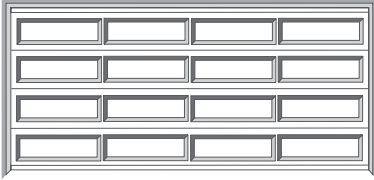

GARAGE DOOR
Ranch
Standard Colour Range

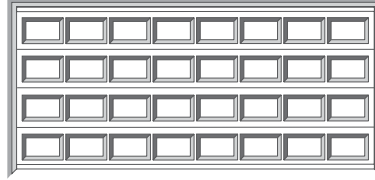

GARAGE DOOR
Heritage
Standard Colour Range



ENTRANCE DOOR FURNITURE
Gainsborough Trilock Angular
Available in satin chrome or matte black



ENTRANCE DOOR FURNITURE
Gainsborough Trilock Align
Available in satin chrome only



INTERNAL DOOR FURNITURE
Gainsborough Neue Angular
Available in satin chrome or matte black



INTERNAL DOOR FURNITURE
Gainsborough Amelia Round
Available in satin chrome or matte black



INTERNAL CAVITY DOOR FURNITURE
Gainsborough Circular sliding set
Available in satin chrome or matte black



MOULDING
Pencil Round*
Painted

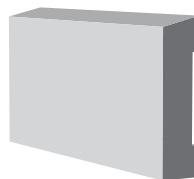

MOULDING
Splayed*
Painted



CORNICE
Cove 90mm
Painted

*Skirting profiles - 68mm (H) x 12mm (D) | Architrave profiles - 42mm (H) x 12mm (D).



LETTERBOX
Pre-fabricated
Painted



ANTENNA
Provisions
As per spec



NBN
Provisions
As per spec

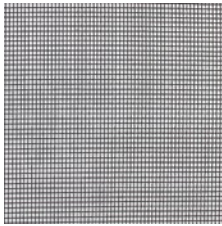

FLYSCREENS
Not including hinged doors
Black



ROOF, FASCIAS & GUTTERS
Colorbond
Select Colorbond ranges only



WATER TANK/S
Poly
If applicable



CLOTHESLINE
Daytek Single Fold Down
Available in light grey or anthracite black



HOT WATER SYSTEM
Rheem (setup dependent on home size)
Grey



DRIVEWAY
Exposed aggregate or plain brushed concrete
Type & quantity as per plan/spec



CONCRETE TO PORCH & ALFRESCO
Broom finish
Quantity as per plan/spec



CONVENTIONAL FOOTINGS & SLAB
M site with cut/fill to suit*
As per plan/spec



INSULATION
R3.0 batts, Anticon blanket & R1.5 wall batts
As per spec



FRAME & TRUSSES
T2 Treated Timber
As per spec



TERMITE MANAGEMENT
Termimesh system
As per plan/spec



HSTP
Taylex
If applicable



BRICK
Girraween - single height
Lifestyle



BRICK
Perisher - single height
Lifestyle



BRICK
Perisher - double height
Lifestyle

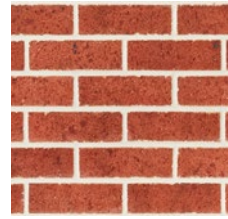

BRICK
St George - single height
Hinterlands



BRICK
Airlie - single height
Horizon



BRICK
Emerald - single height*
Horizon

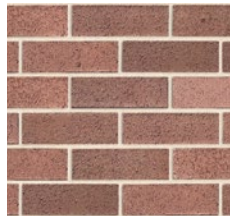

BRICK
Chinchilla - single height*
Horizon

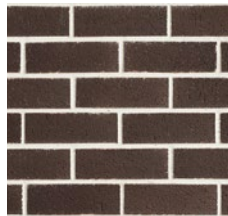

BRICK
Breaking Dawn - single height
Lunar



BRICK
Crescent - single height
Lunar



BRICK
Eclipse - single height
Lunar



BRICK
Grey Stone - single height
Lunar



BRICK
Frost - single height
Naturals



BRICK
Moon Dust - single height
Naturals



BRICK
Elkhorn - single height
Shoreline



BRICK
Ocean Mist - single height
Shoreline



BRICK
Ocean Mist - double height
Shoreline



BRICK
Sea Whip - single height
Shoreline



BRICK
Sea Fossil - single height
Shoreline



BRICK
Driftwood grey - single height
Coastal Hamptons



BRICK
Montauk - single height
Coastal Hamptons

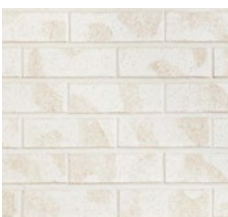

BRICK
Washed White - single height
Coastal Hamptons



BRICK
Agave - single height
Zen



COOKTOP
Fisher & Paykel Induction 600mm*
Black glass



COOKTOP
Fisher & Paykel Induction 900mm*
Black glass



COOKTOP
Fisher & Paykel Gas 900mm*
Stainless steel



FREESTANDING COOKER
Fisher & Paykel 90cm Dual Fuel*
Black



BATHTUB
Decina Prezzo freestanding*
White



BATHTUB
Cortona wall faced
White



FREESTANDING BATH SPOUT
Round*
Available in chrome, black, brushed nickel or brushed brass



TILING
600 x 600mm Cushion Edge
In lieu of 450 x 450mm

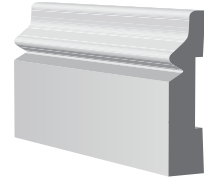

MOULDING†
QLD Colonial*
Painted

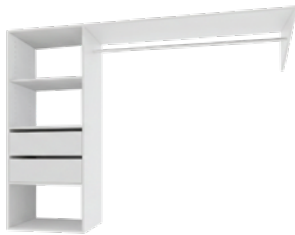

WARDROBE FITOUT
Type C*
As per plan/spec

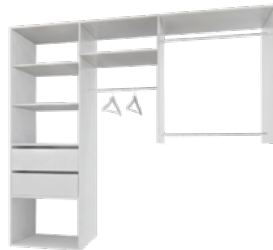

WARDROBE FITOUT
Type E*
As per plan/spec



WARDROBE FITOUT
Type F*
As per plan/spec



INTERNAL DOOR FURNITURE
Gainsborough Avant Alba lever set*
Available in stainless steel, matte black, satin brass



ENTRANCE DOOR FURNITURE
Gainsborough Trilock Omni pull handle*
Available in stainless steel, matte black, satin brass



INTERNAL DOOR
Deco 10s*
Painted



INTERNAL DOOR
Deco 11s*
Painted

NCC 2022

- All of our homes are designed and built to meet NCC 2022 requirements. This includes requirements for; liveable housing, heat pump hot water system, 7 Star NatHERS rating to all orientations and ceiling fans to all habitable rooms.

PEACE OF MIND

- Termimesh stainless steel termite protection
- H2F/T2 green/blue treated pine framing timber
- Colorbond roof, fascias and gutters as standard - choose from Colorbond classic and contemporary colour range
- Standard building and plumbing approval fees included
- HIA building contract and indemnity 12 month maintenance period
- Engineered traditional/conventional steel reinforced concrete footings and slab to M soil classification
- Allowance for up to 1 metre cut and fill (urban blocks) as standard
- Allowance for up to 1.5 metre cut and fill (acreage blocks) as standard
- Full colour consultancy (1 x exterior colour meeting & 1 x interior colour meeting)
- 3 coats of quality paint to internal areas including 2 coat system to external areas
- R3.0 ceiling batts to ceiling areas including garage, alfresco and porch
- R1.5 wall batts to all external walls
- Key locks to all windows and sliding doors
- Electric hot water system - Heat Pump

INTERNAL

- 8'6" foot (2590mm) ceiling heights throughout
- 90mm boral cornice throughout as standard
- Choice of quality Corinthian pine architraves and skirting
- Choice of Corinthian range of entry doors: Madison, Slimlite and Wide Entry - painted or stained (5VG/5G doors only) - door size dependant on plan
- Choice of Gainsborough G2 series - contemporary external trilock to entry door: align or angular
- Choice of Corinthian Flush Primed or Motive door to internal doors - painted
- Choice of Gainsborough G2 Series - contemporary internal lever and privacy sets throughout: round or angular
- Choice of panel-lift garage door profiles in range of Colorbond colours with door motor and 3 remotes (1 x wall remote & 2 x keychain remotes)
- Built-in robes in all bedrooms with shelf and rail (option for robe fitout)
- Vinyl sliding doors to bedroom robes as standard (option for mirrored sliding doors*)
- Family size linen cupboard/s
- Icon carpet range with 8mm Dunlop Red/10mm Airstep underlay to all bedrooms and robes/WIR (media and study if applicable)
- Extensive range of icon tiles up to 450mm x 450mm ceramic cushion edge or icon vinyl planking to all main floor areas, hallways and linen cupboard/s (activity and study if applicable)

KITCHEN APPLIANCES

- 900mm electric cooktop
- 900mm undermount or canopy rangehood
- 900mm electric oven
- 600mm dishwasher

KITCHEN FIXTURES & FINISHES

- Choice of kitchen sink/s
- Pulldown g/neck sink mixer

KITCHEN BENCHTOPS

- 20mm Caesarstone to kitchen and island benchtops with wide selection of colours from builders' range: Caesarstone and YDL Stone standard range.

KITCHEN JOINERY

- Overhead cupboards as indicated on plans and bulkhead over refrigerator space
- Floor cupboards throughout kitchen
- 1 set of 4 x cutlery stack soft closing drawers
- 2 sets of 3 x pot soft closing drawers up to 1000mm wide
- Microwave space with 1x pot drawer in lower cabinet (if applicable)
- Choice of melamine colours for cupboards: Polytec - matte, sheen, abstract and timberprint
- Range of stylish handles to all drawers and cupboards with option for seamless look POA* - no handles to overhead cupboards only
- Pantry with 4 shelves
- PVC edges to all drawers and cupboards
- Dishwasher recess with water and power connections underneath bench through cupboards

ENSUITE, BATHROOM & POWDER BENCHTOPS

- 20mm Caesarstone to ensuite, bathroom and powder room (if applicable: powder room POA*) with wide selection of colours from builders' range: Caesarstone and YDL Stone standard range.

ENSUITE, BATHROOM & POWDER JOINERY

- Full length vanity cupboards
- 1 set of 3 x drawers to ensuite vanity only
- Range of stylish handles to all drawers and cupboards with option for seamless look POA*
- Wide choice of melamine colours for cupboards: Polytec - matte, sheen, abstract, timberprint

ENSUITE, BATHROOM & POWDER FIXTURES & FINISHES

- Choice of ceramic white basins
- Back to wall toilet suite with soft closing lid
- Choice of stylish mixer taps
- Choice of shower outlets
- Quality ceramic wall and floor tiles from icon range
- 2000mm high tiling to shower area
- 600mm high tiling above bath tub
- Tiled floors and skirting throughout including 300mm high tiled splashback above vanities (powder room if applicable)
- Full length mirror to above vanity (frameless or microframe)
- Perimeter frame, clear laminated glass shower screens with pivot door as standard
- Privacy latch to bathroom and toilet doors
- Bermuda tile waste or bar grate (where applicable)
- Deflector on all shower screen doors as per liveability laws

EXTERNAL

- Flyscreens to all sliding doors and windows
- Extensive range of PGH bricks with natural mortar
- Modena rendered and painted letterbox
- Wall mounted folding clothesline
- Plain concrete (broom finish) to alfresco and porch with option to upgrade to builders' range of exposed aggregates POA*
- 2 external garden taps as standard
- Sewer treatment plant (acreage blocks)
- Concrete driveway:
 - Residential blocks - up to 50m² of exposed aggregate concrete from builders' range
 - Acreage blocks - up to 85m² of plain concrete (broom finish)

BRICK DISCLAIMER

Clay bricks are made from naturally occurring minerals. Variations in colour, texture and size are natural characteristics of clay products and production variations can occur from batch to batch. Colours shown are indicative only.

TYPICAL ELECTRICAL QUANTITIES

- Lighting plan provided with quotation and selections available
- 6-8 downlights to dining/family/kitchen area
- 2-3 pendant lights to kitchen island bench
- 2-4 downlights to media, multi-purpose areas (if applicable)
- 1 fan/light per bedroom
- 1 fan to each living area (media, study, activity etc. where applicable)
- 3-in-1 fan/light unit to ensuite and main bathroom
- 1 downlight to laundry, WC, walk-in linen/s and walk-in robe/s (PWD room if applicable)
- 1 bar light to garage
- Downlights to hallway/s and entryway
- 3-5 downlights to external areas including porch and alfresco
- Outdoor fan to alfresco as standard
- 2-3 double powerpoints to kitchen including island bench (if required)
- 2 double powerpoints per dining and family including living areas (media, activity, rumpus - if applicable)
- 2 double powerpoints per bedroom including study (if applicable)
- 1 double powerpoint to ensuite, main bathroom, laundry and garage (PWD room if applicable)
- 1 weatherproof double powerpoint for external use
- 5 predetermined single powerpoints for fridge, microwave and dishwasher spaces, garage door motor and rangehood
- 2 TV points with TV antenna (if applicable)
- 2 phone or data points with NBN connection plate only (if applicable) - available upgrade to NBN data box (POA)
- Allowance for three phase underground power as standard (dependant on available power supply)
- Allowance for heat pump HWS connections
- Allowance for connections: NBN/fibre optics (if applicable), air conditioning, home sewer treatment plant and water tanks (if applicable)

Disclaimer: electrical inclusions are largely dependent on the style (i.e. high/raked ceiling) and size of the dwelling. Quantities and allowances will be proportionalised in accordance with these.

OTHER ITEMS WE CAN ASSIST WITH

- Water tanks
- Air conditioning

DEFINITIONS

POA: Price On Application

HSTP: Home Sewerage Treatment Plant

NBN: National Broadband Network

EXAMPLE OF ELECTRICAL PLAN

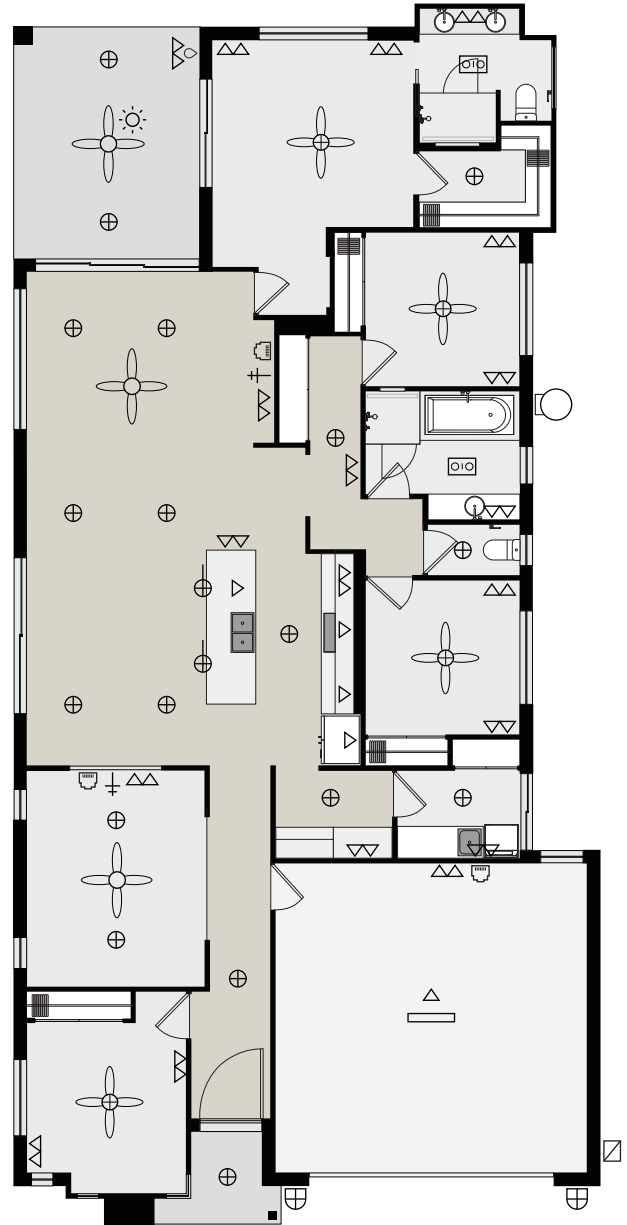

PLAN KEY

⊕	LED DOWNLIGHT	⊕	3-IN-1 TASTIC
△	SINGLE POWER POINT	⊕	AERIAL
△△	DOUBLE POWER POINT	⊕	DATA POINT
△△	WATERPROOF POWER POINT	⊕	PENDANT
⊕	FAN WITH LED LIGHT	⊕	METER BOX
⊕	FAN	⊕	PILLAR LIGHT
⊕	OUTDOOR FAN	⊕	HEAT PUMP HWS
—	LED BAR LIGHT		



icon

G & P Builders Pty. Ltd. | QBCC 22485

Icon Inclusion Range

The colours and finishes of products shown in this booklet are an indication of the actual colour/finish.

Tel (07) 3463 9463
Web www.gpbuilder.com.au
Email info@gpbuilder.com.au

Office
15/21 Technology Drive
Augustine Heights QLD 4300

f@gpbuilder @gpbuilder

