

eggemann

15 square

eggsmann kitchens are timeless and individual – the architectural kitchens, cooking studios and the own brand UNIQUE by eggsmann tend to manage without wall units. This is where 15 square comes in. As an all-rounder the new system is designed for use in recesses, it can be suspended from the ceiling or placed on a cooking island. A generous kitchen, a living space, a study or a library, all can also benefit from the beautiful floor-to-ceiling shelf 15 square.

The delicate aluminium profile in black or anodised natural colour forms the basis of the system. Modules combine the profile in five different widths. The aluminium intermediate shelves can be replaced by two bars which serve as holders for stainless steel receptacles for bottles, paper dispensers, cooking book holders or herb boxes. Additional accessories are holders for wine glasses, shelves with storage jars or porcelain boxes; wooden containers and knife holders in smoked oak, ash or aluminium coloured optimizes the features of the system.

A railing bar (VA, 14 mm) which can be integrated in the recess makes it possible to place essential kitchen utensils within easy reach. A power strip with USB connections (for smartphone, tablet or TV) round off the features and make for enjoyable contemporary kitchen work.

The installation of 15 square on an island or suspended from the ceiling can be used from two sides which is ideal for cooking and preparing food in company.

As a room divider or as bookshelf 15 square can be tensed up between ceiling and floor. As easy as that. If preferred, there is also the chance to add 4 mm wooden or glass rear panels.

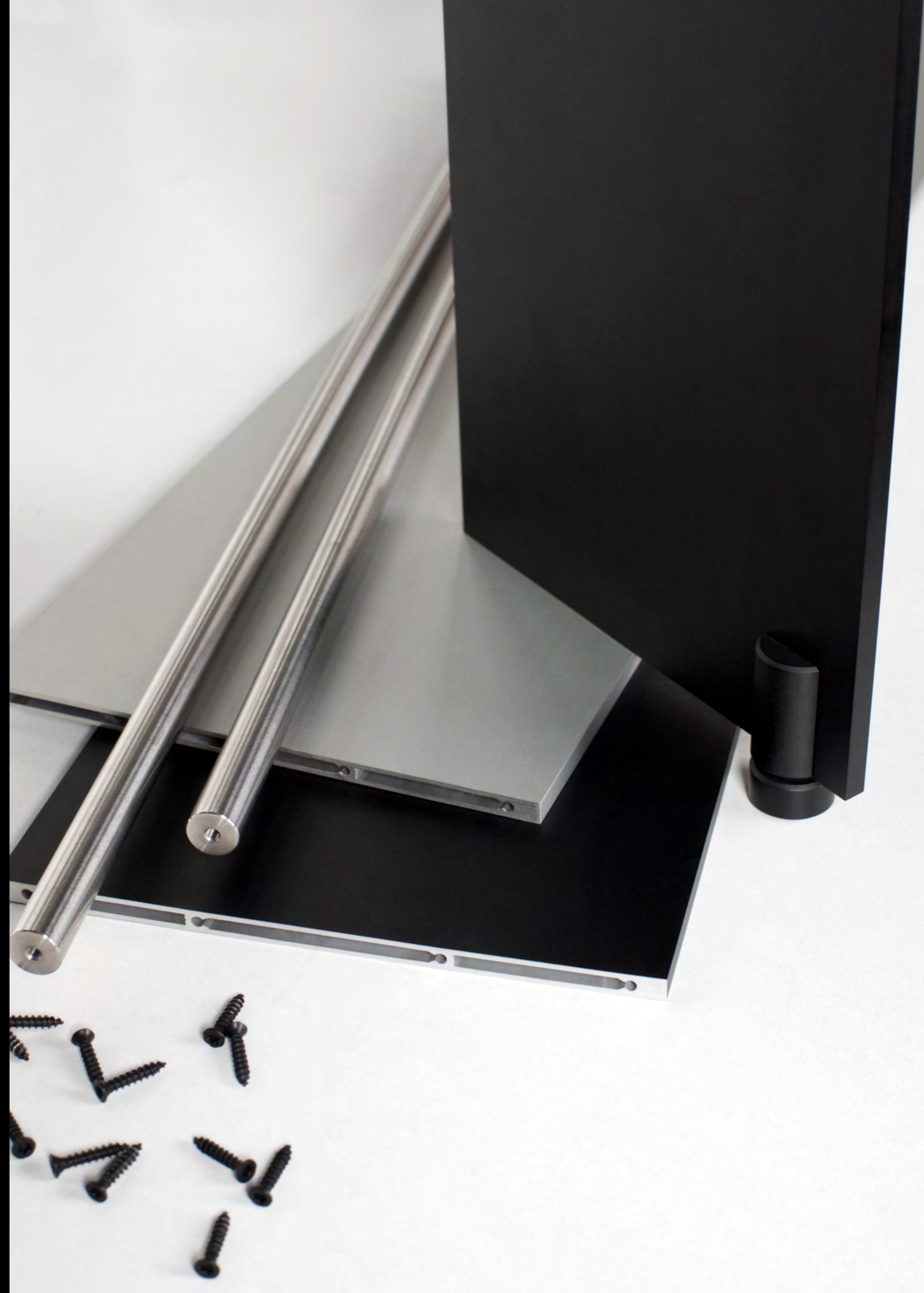

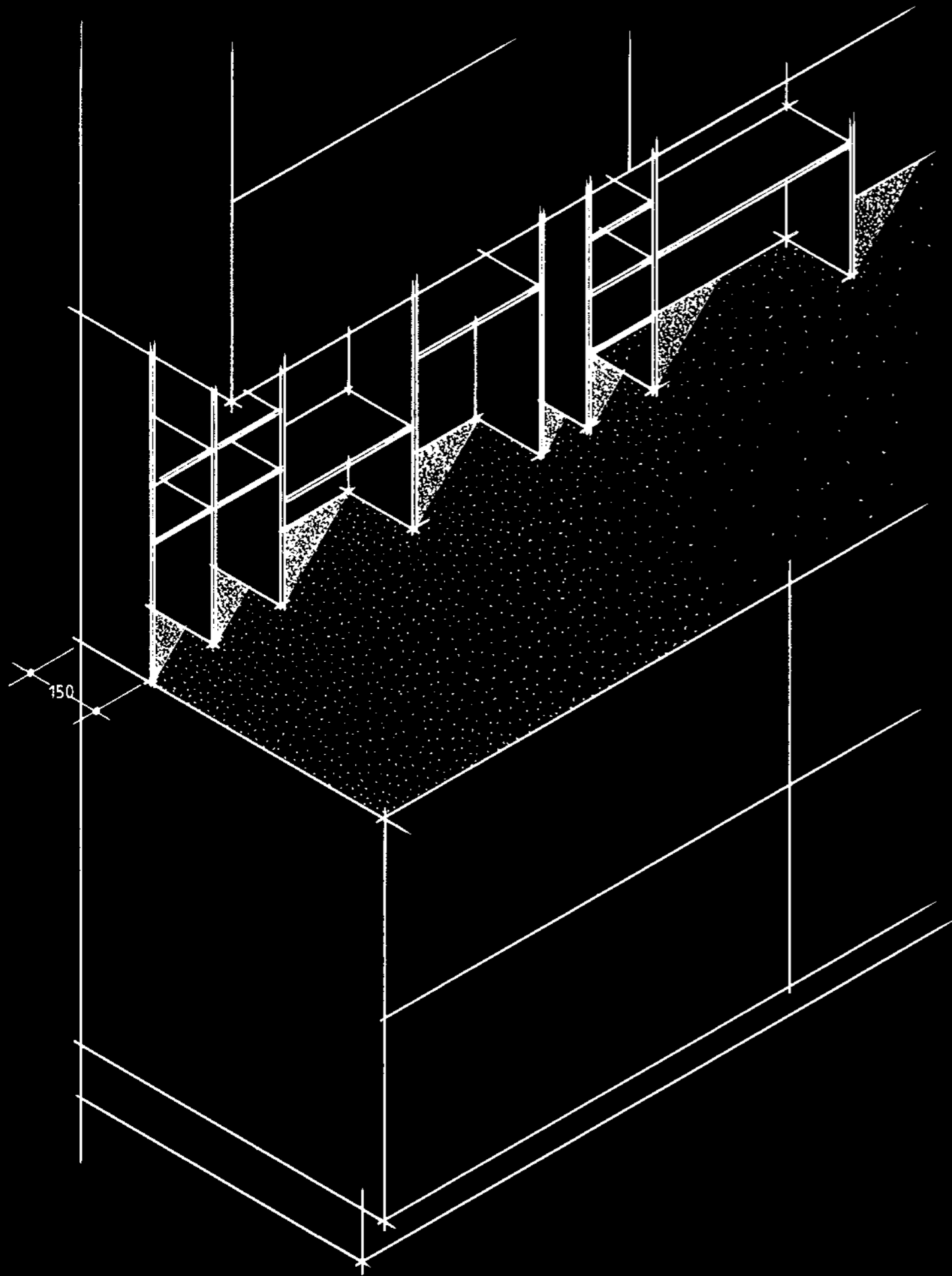



A built-in spice rack containing ten glass jars with different colored spices, arranged in two rows of five.

A built-in coffee machine with a white body and a black handle, mounted on the wall.

A built-in shelf holding a cookbook with a colorful cover, next to a small white tray.

A built-in knife block containing several knives with black handles.

A built-in shelf holding a few lemons and a small white container.

A built-in beer tap with a stainless steel body and a glass handle, with two glasses of beer on a tray in front of it.

A built-in sink with a white countertop and a stainless steel faucet, with a whisk and other kitchen tools hanging on the wall above it.

A built-in planter box containing fresh green herbs.

A built-in shelf holding several bottles of wine or spirits.

A built-in coffee machine with a stainless steel body and a glass handle, mounted on the wall.

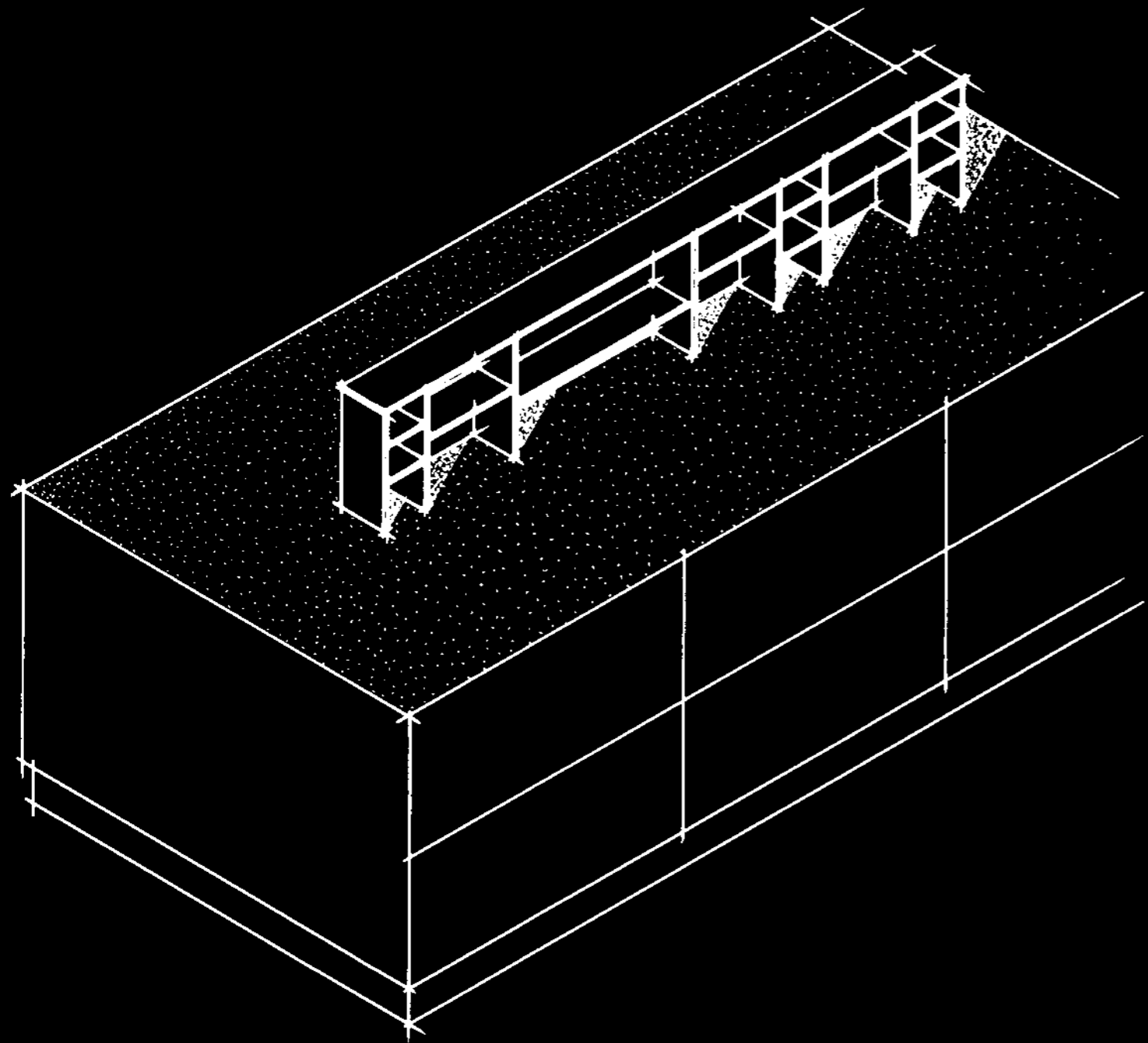



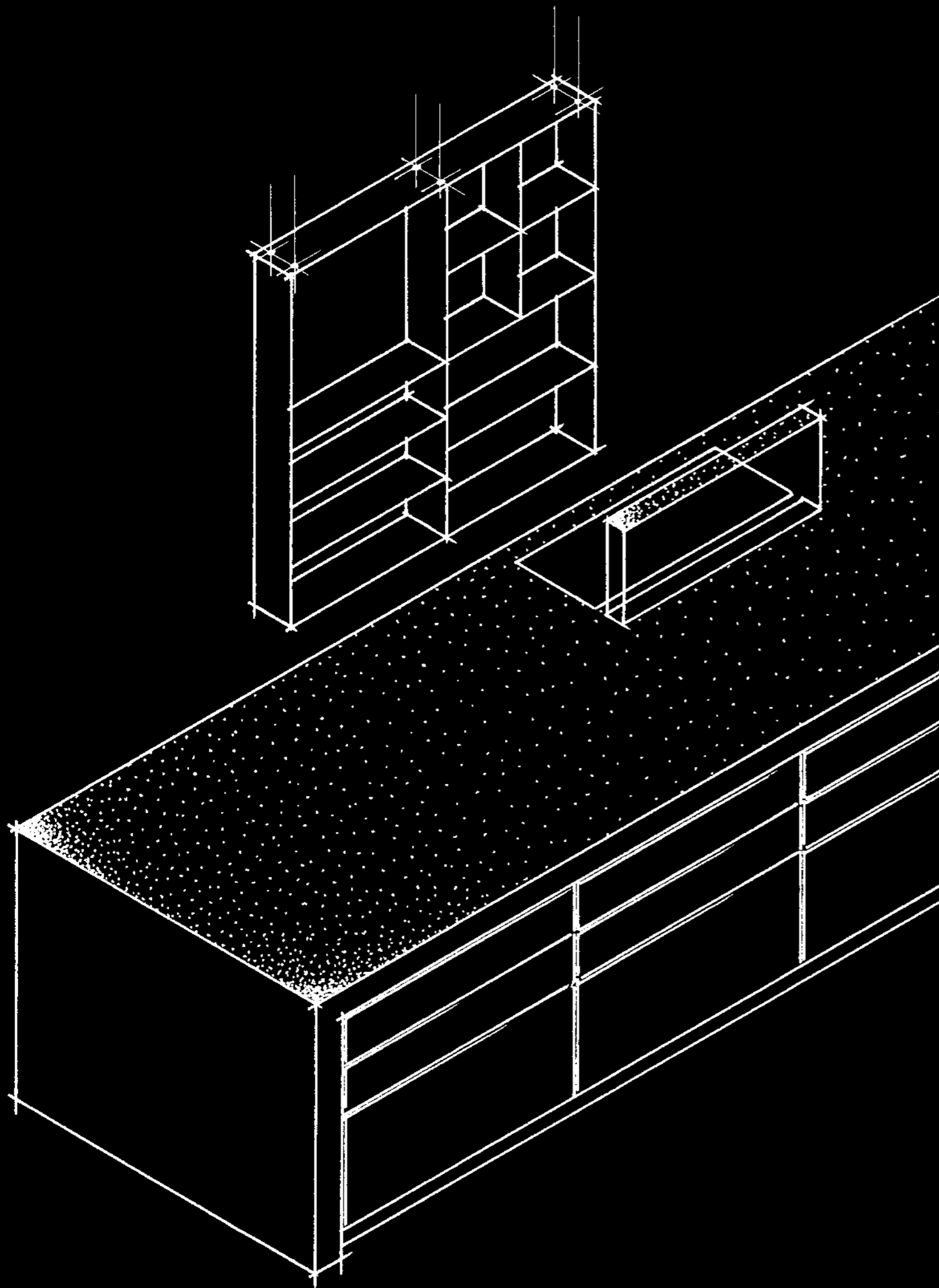



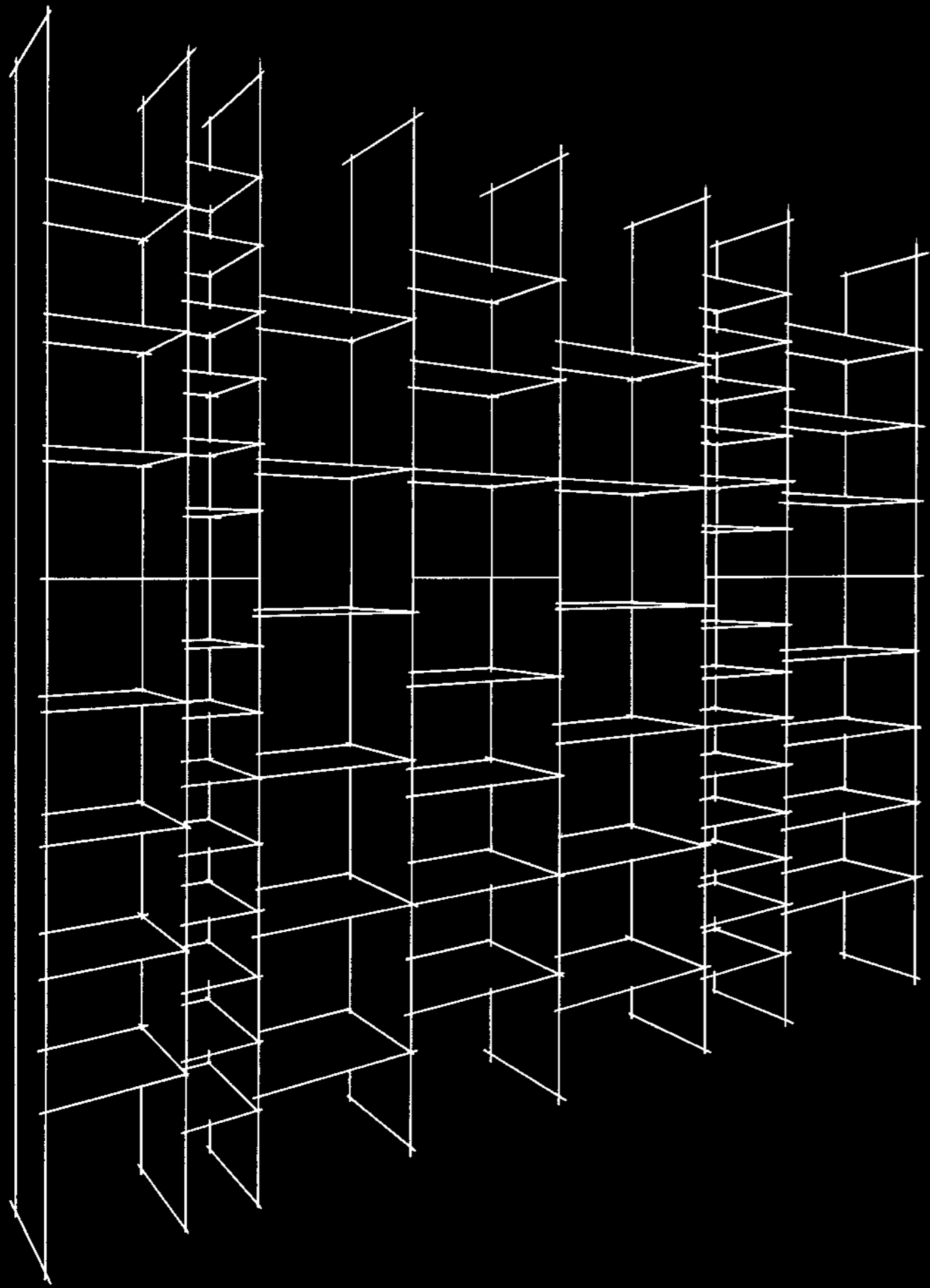



EGGERSMAN NUNDCAP
KOOPERIERE NSEITNUN
MEHRSIEBZE INJAHREN
UNDHABENI LAUFEDER
ZEITGEMEIN SAMEINIGE
SPANNENDE INDBEMER
KENSWERTE PROIEKTE
REALISIERT UND TOLLE
NEUEPRODUKTEENTWI
CKELTES WARUNSEINE
GROSSEFREUDEEGGER
INILLES WEG
GRENZ
IRSA GENDAN



