

Senza Door System

The Senza Door System is a flush-mount garage door engineered for seamless architectural integration. Unlike traditional doors installed behind the garage opening, the Senza system installs between the jambs and beneath the header, allowing exterior wall cladding to continue uninterrupted across the door surface. The result is a garage door that becomes part of the architecture — virtually invisible once installed.



🏠 Architectural Freedom

Preserves original architectural intent without compromise. Facade remains uninterrupted by large functional elements.

🏠 Minimalist Design

Clean, uninterrupted lines define the visual language. Delivers a true expression of modern minimalist architecture.

🏠 Seamless Integration

Cladding applies directly to the engineered door face. Maintains consistent installation with surrounding wall systems.

Senza System Features

✔ Integrated System

Door, hardware, and cladding substrate engineered together.

✔ Weather Protection

Integrated barrier with concealed weather-seal.

✔ Cladding Compatibility

Compatible with many exterior cladding systems.

✔ Reinforced Door Face

Aluminum reinforcement increases door-face rigidity.

✔ Solid Spring Technology

Sag-resistant spring system.

✔ Insulated Steel Core

2" Thick Foam Injected Polyurethane (R-18.00).



Design Integration

Flush-mount doors must be integrated into the architectural design **early in the construction process**.

Because the Senza system installs within the structural opening, proper coordination of framing, rough openings, and cladding systems is essential.

Early planning ensures the final result is a **fully integrated architectural facade**.

Spring Assembly: Header-Mount

Maximum Size: 18' x 10'
Maximum Weight: 1200 lbs
Minimum Headroom (mHR): 10"

Clear Opening Height Calculation:
 C/O Height = R/O Height - 1"

- Benefits**
- Maximizes clear opening for a given rough opening
 - Suitable for retrofits and existing openings
 - More economical spring assembly

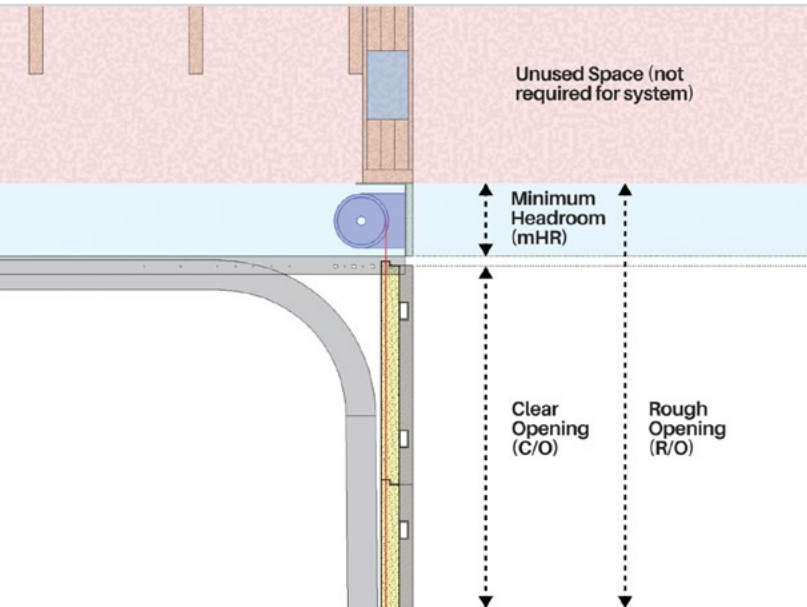
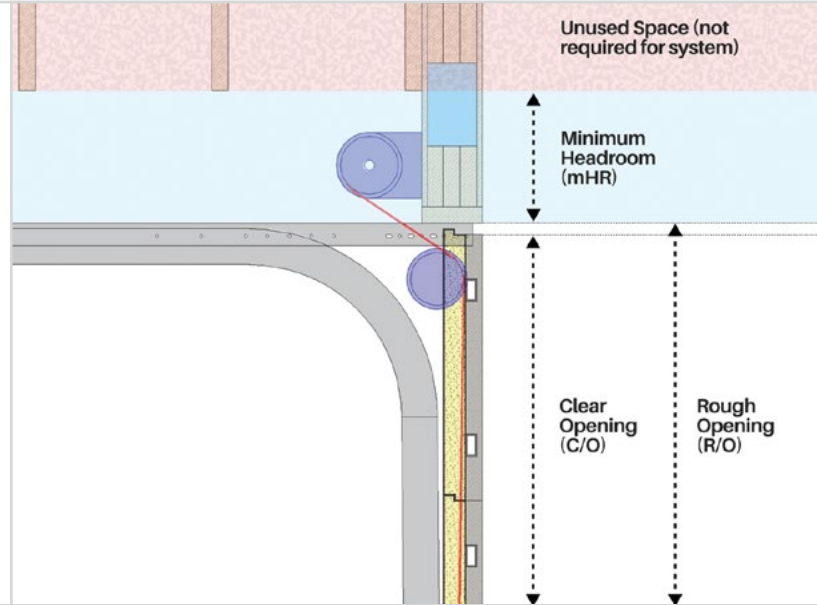

Spring Assembly: Front-Mount

Maximum Size: 22' x 14'
Maximum Weight: 2200 lbs
Minimum Headroom (mHR): 8" *
 *located below header for front-mount spring assemblies

Clear Opening Height Calculation:
 C/O Height = R/O Height - mHR - 1"

- Benefits**
- Supports larger and heavier doors
 - More robust mechanical design
 - Simpler operation similar to traditional doors

Track Mount: Steel Jamb

Steel jamb are critical to the performance of flush-mount doors. They provide the structural mounting surface required to install the track system **within the opening** while maintaining long-term stability.

Because the door installs inside the rough opening, the finished clear opening will be slightly reduced relative to the initial framing.

Clear Opening Width Calculation:
 C/O Width = R/O Width - 11"

