

### YOUR KIT INCLUDES:

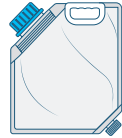

(1) 0.1 Micron Absolute  
Dual-Threaded Mini



(2) 1 Gallon  
Water Bladder

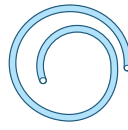

(3) Gravity  
Hose



(4) Tube  
Adapters



(5) Cleaning  
Plunger



(6) Cleaning  
Coupling



(7) Hose  
Guide

### HOW TO USE YOUR GRAVITY FILTER

#### Step 1

Assemble the gravity tube and tube adapters by inserting the adapters on both sides of the tube.



#### Step 2

Screw the Mini filter onto to the gray adapter on the gravity tube. You're now ready to collect water in the bladder.



#### Step 3

Unscrew the large blue cap and fill the water bladder with fresh water. When done filling, screw the blue cap back onto the bladder.

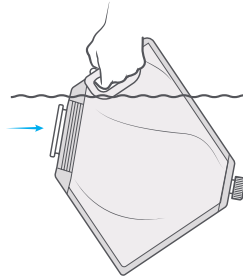

#### Step 4

Holding the bladder upside down, unscrew the small white cap and screw on the assembled gravity tube and Mini filter.

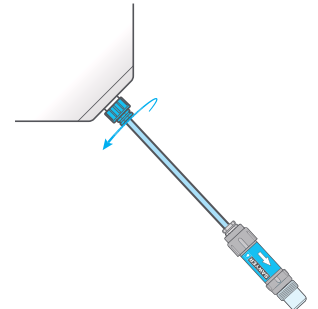

#### Step 5

To purge the air from the tube, lower the filter below the bladder and slightly untwist the filter until water fills the tube. Re-tighten the filter and wipe off any drips that may be on the filter.

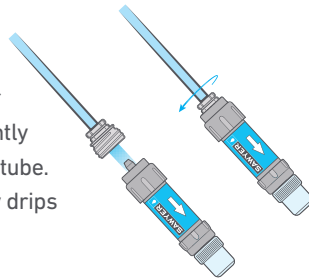

#### Step 6

Hang the bladder from the handle or set it on a flat surface.

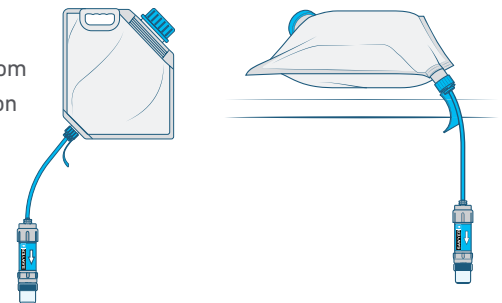

#### Step 7

Open the white push-pull cap on the filter to begin the flow of water.

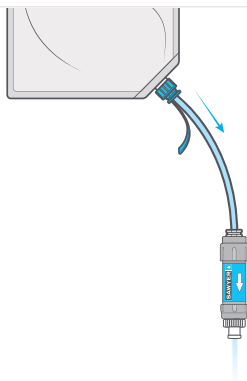

**Tip:** The greater the distance between the bladder and the filter, the faster water will flow.

**Tip:** The hose guide can be used to prevent the hose from kinking. Attach it to the neck of the blue adapter if you wish to use it.

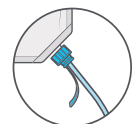

## CLEANING INSTRUCTIONS WITH CLEANING PLUNGER

### Step 01

Remove the Mini Filter from the tube.

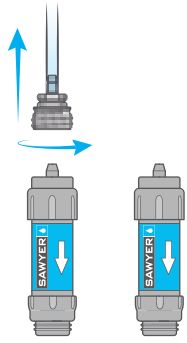

### Step 02

Fill the Cleaning Plunger with clean, filtered water. Place the tip of the Plunger on the output end of the filter.



### Step 03

Forcefully backwash the filter a couple times with clean water.

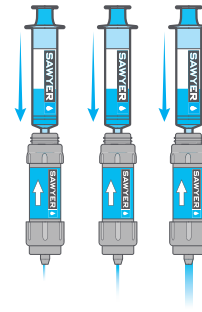

### Step 04

Fill the Cleaning Plunger and push water forward through the filter to loosen up any dirt. Repeat backwashing forwards and backwards until the filter is fully cleaned.

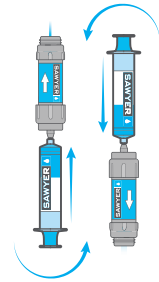

## CLEANING INSTRUCTIONS WITH CLEANING COUPLING

### Step 01

Find a clean plastic bottle that will thread onto the Cleaning Coupling. Fill the bottle with clean, filtered water.

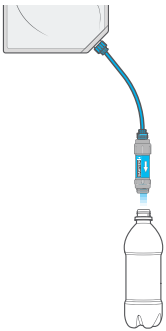

### Step 02

Remove the Push-Pull Cap and screw the Cleaning Coupling onto the filter threads.

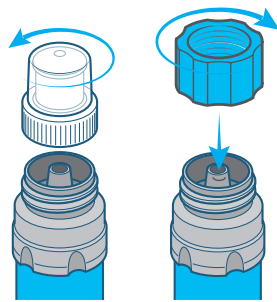

### Step 03 & 04

Screw the filter with the attached Cleaning Coupling onto the plastic bottle. Squeeze forcefully and repeat as necessary until the filter is clean.

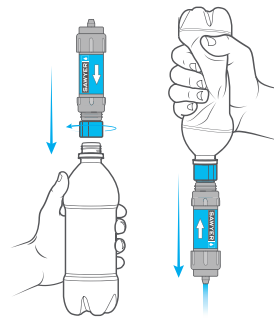

## MORE CLEANING TIPS

### SANITATION

Sawyer recommends occasionally sanitizing your filter. To do this, backwash the filter with a standard bleach solution (fragrance free and no more than one cap of bleach per quart of water). Let air dry in a cool dry place before using.

### CLOGGED FILTERS

If your filter is still flowing slow after backwashing, soak the filter in hot clean water (not hotter than you can put your hand into) for about an hour and then backwash using hot clean water. **REMEMBER** to backwash **FORCEFULLY!** When using the Cleaning Plunger, do not be gentle, it will only form paths of least resistance instead of blowing out the particulates that may be trapped in your filter.

### CALCIUM BUILD UP

If after above steps your filter still seems to be clogged, it could be dried calcium. Soak the filter in vinegar for 1/2 hour and then backwash with hot clean water (not hotter than you can put your hand into). Repeat until the flow is restored – it may take several times.