

### LEGEND



BUILDING ENVELOPE

A

SMALL LOT HOUSING

CODE TYPE A

1. THE BUILDING ENVELOPES AND GARAGE ENVELOPES ON THIS PLAN ARE SHOWN ENCLOSED BY THICK CONTINUOUS LINES.
2. THIS DIAGRAM IS TO BE READ IN CONJUNCTION WITH THE MEMORANDUM OF COMMON PROVISIONS.
3. THE BUILDING CAN BE BUILT ON EITHER SIDE BOUNDARY WHERE NOTED AS "0 or 1" ON THIS DIAGRAM BUT MUST MAINTAIN A MINIMUM 1m SET BACK ON THE OPPOSITE BOUNDARY.

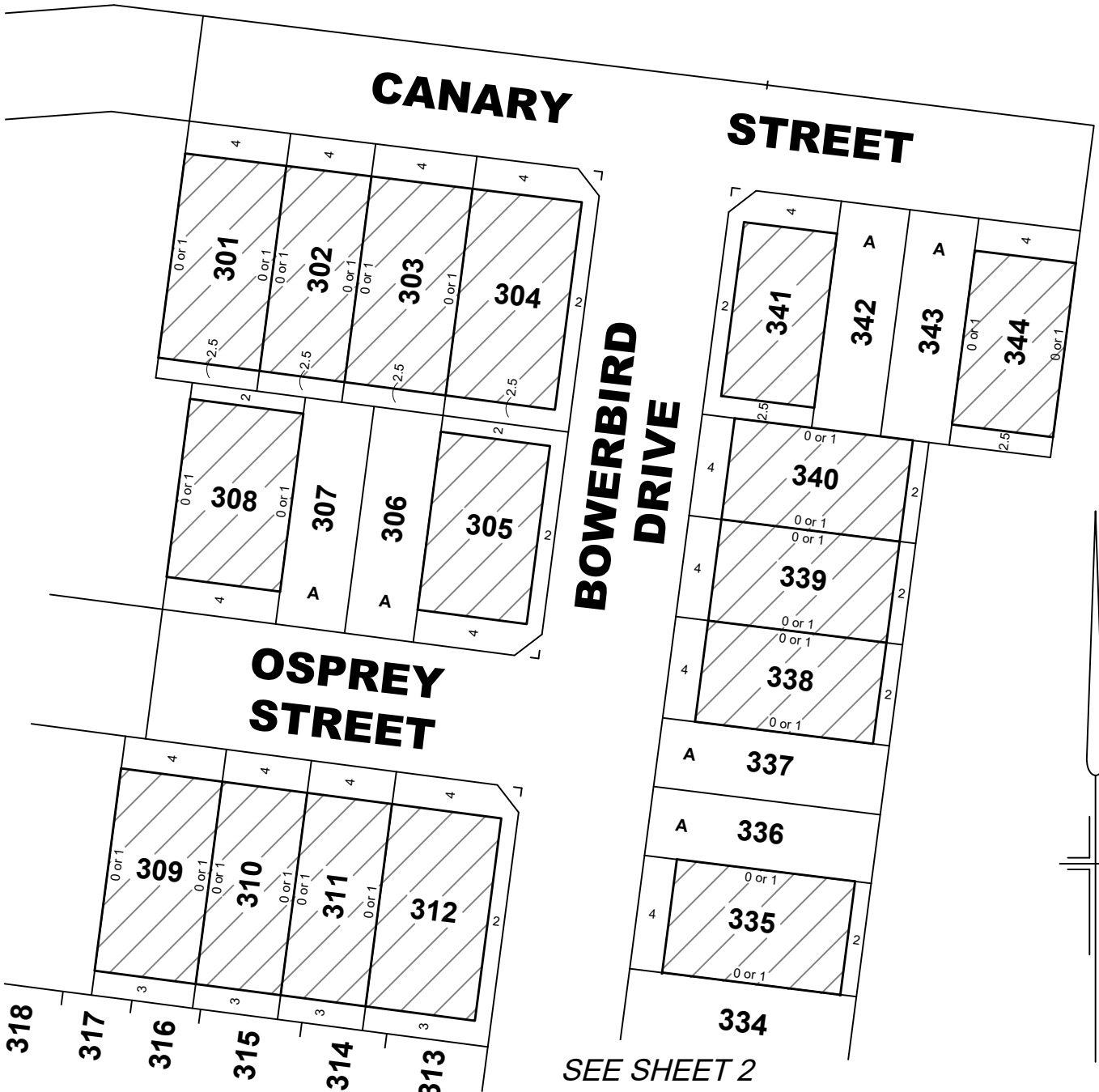

**REEDS**  
CONSULTING

Reeds Consulting Pty Ltd  
Lvl 16, 501 Standon Street  
Melbourne Victoria 3000  
p (03) 8640 3000  
www.reedsconsulting.com.au  
survey@reedsconsulting.com.au

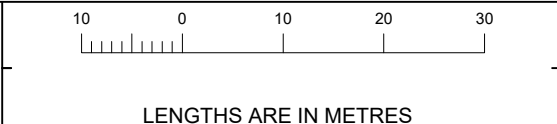

ORIGINAL  
SCALE SHEET SIZE  
1:750 A4

SHEET 1  
REF: **22902/3**  
VERSION: **D** 22902-3-MCP-D.dwg  
DATE: 28/11/2025

SEE SHEET 1

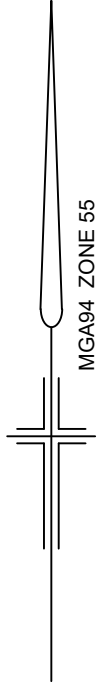

**LEGEND**

-  BUILDING ENVELOPE
- A** SMALL LOT HOUSING CODE TYPE A

1. THE BUILDING ENVELOPES AND GARAGE ENVELOPES ON THIS PLAN ARE SHOWN ENCLOSED BY THICK CONTINUOUS LINES.
2. THIS DIAGRAM IS TO BE READ IN CONJUNCTION WITH THE MEMORANDUM OF COMMON PROVISIONS.
3. THE BUILDING CAN BE BUILT ON EITHER SIDE BOUNDARY WHERE NOTED AS "0 or 1" ON THIS DIAGRAM BUT MUST MAINTAIN A MINIMUM 1m SET BACK ON THE OPPOSITE BOUNDARY.

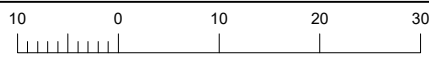

LENGTHS ARE IN METRES

ORIGINAL SCALE  
 1:750  
 SHEET SIZE  
 A4

SHEET 2  
 REF: **22902/3**  
 VERSION: **D** 22902-3-MCP-D.dwg  
 DATE: 28/11/2025