

May 2026

Press Release

For Immediate release

*moifani*

*Can One Table Fit Every Way You Live?*  
**moifani Debuts "pombo" at 3daysofdesign, Copenhagen.**

Wildersgade 51, Christianshavn – 10–12 June 2026



*When a camera designer designs furniture — A dining collection defined by functional precision.*

**About the Brand -moifani-**

moifani was born from an unlikely dialogue: a furniture manufacturer from Okawa — the town that has shaped Japanese woodworking for generations — and an industrial designer whose first language was cameras. Together, SHIKI and SATEREO make solid-wood furniture that begins with observation and ends with craft: precision-formed, hand-finished, and built to last a lifetime.

**About the Collection -pombo-**

pombo — Portuguese for 'pigeon' — is moifani's second collection: a dining table and chair for the way most people actually live today. While furniture has long been designed around the four-person family, the urban majority is now one to three people. pombo is a direct response — compact in footprint, generous in feel, flexible enough to adapt as life changes.

**Our approach**

We don't start with a shape. We start with a question. Every decision in pombo — the asymmetry of the table, the angle of the backrest, the Beak Armrest — traces back to something observed, measured, or tested. This is what it looks like when industrial design thinking meets the material intelligence of Okawa craft.

## THE TABLE — SPACE EFFICIENCY BY DESIGN

pombo' s table is asymmetrical — neither round nor rectangular. Its form adapts with its orientation: repositioned to a corner, a window, or an open wall, it changes character entirely. One table serves every household size.

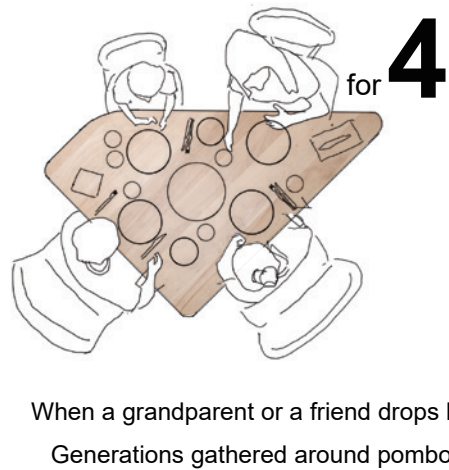
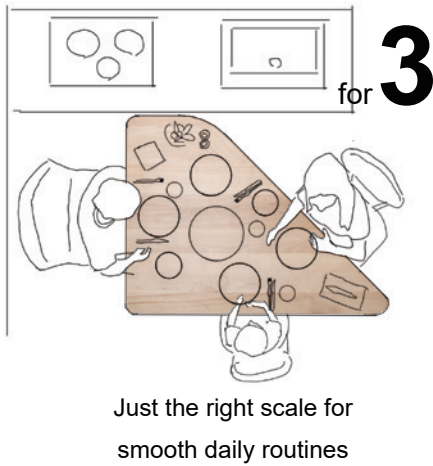
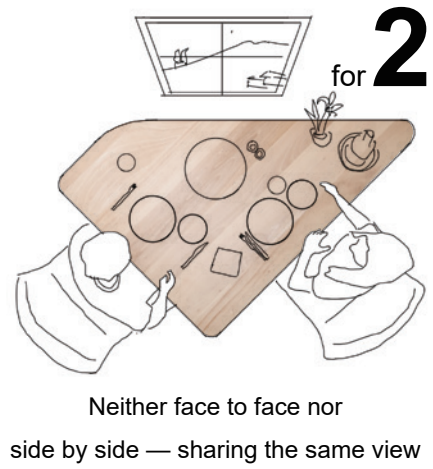
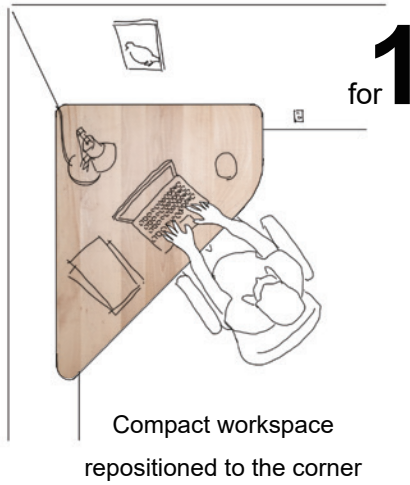

## THE CHAIR — THE RESEARCH BEHIND THE BEAK ARMREST

The Beak Armrest — a slim, horizontal form at elbow height, derived from observing postures people naturally adopt when they settle in for longer than a meal — is pombo's answer. It provides just enough support to shift the body from 'passing through' to 'staying a while': a second coffee, reading, studying, knitting, holding a child. The chair remains genuinely compact; its enveloping backrest completes the sense of being held without enclosure.

### NO ARMREST

- Short dwell time
- + Compact footprint

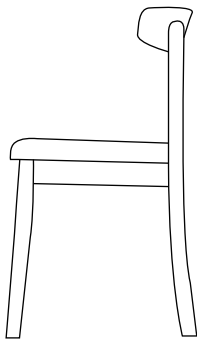

In and out. Not a place where one tends to linger.

### FULL ARMREST

- + Long dwell time
- Bulky, space-consuming

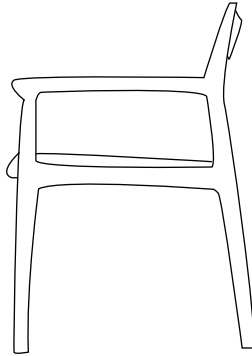

Comfortable for hours, but practically a small sofa.

### BEAK ARMREST

- + Long dwell time
- + Compact footprint

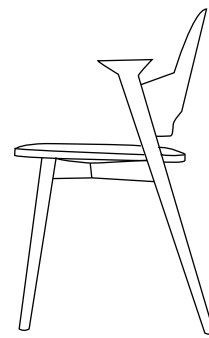

A horizontal 'just-enough' rest for the elbow and forearm. No bulk. Stays all day.



*moifani* 3daysofdesign

**Brand:** moifani

**Collection:** pombo — dining chair & table

**Exhibition:** Wildersgade 51, Christianshavn

**Manufacturer:** SHIKI — Okawa, Fukuoka, Japan

**Design:** SATEREO (Keita Sato) — Lisbon, Portugal

**Press Contact:** Ryota Nishida  
[r-nishida@i-shiki.jp](mailto:r-nishida@i-shiki.jp)  
+81 70 4808 1324

**High-Resolution Images:** <https://x.gd/NHbIM>

**Web:** <https://i-shiki.jp/en/pages/moifani>

## COME SEE pombo IN COPENHAGEN

The Perch — Wildersgade 51, Christianshavn | 3daysofdesign 2026 — 10–12 June 2026

### EXPERIENCE JAPANESE HYGGE

An intimate tasting of moifani's world — daily 14:00–16:00

A 1790 building, dim light, solid wood. Come and sit.