

The perfect solution for barns and stables in the equine market.

The Sentry™ 801.47 Stable Day Yard Door is the perfect solution for barns and stables in the equine market.

This fully powder coated, split swing stable door can be opened just at the top to allow the horse some fresh air and a view. It can also be used as a standard exit door into an exercise area or paddock.

Our stable doors come with steel panels for longevity and are prehung, making them easy to install — and the number one day yard door choice for every stable or stable complex.

Available in the complete Classic & Contemporary ranges of COLORBOND steel colours, with standard door size of 2400mm(h) x 1100mm(w), with custom sizes available.

- Pre-Hung
- Split Swing Door
- Heavy Duty Pad-Bolt Latch
- Fully Powder Coated
- Heavy Duty Adjustable Hinges
- Internal Form Ply Lining
- Made in Australia
- Easy to Install
- Allows for Additional Airflow
- Stable Safe Compliant

Applications

Barns and stables
Equine market and businesses
Other live stock



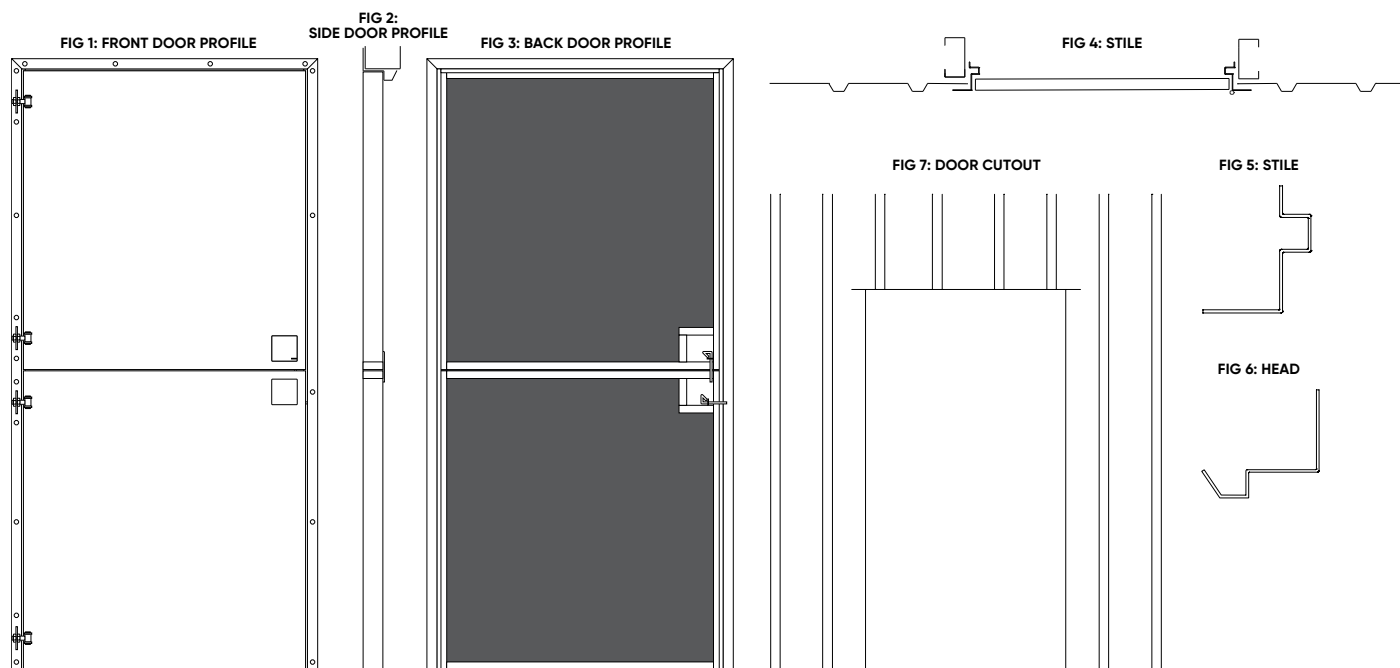

The Sentry™ 801.47 stable door is a metal-clad door, comprising of RHS frame with a steel skin and internal 18mm black ply cladding, pre-hung into a 47 series 3-sided jamb.

AVAILABLE SIZES

- 2400mm (h) x 1100mm (w)

APPLICATIONS

Steel structures – barns and stables.

AVAILABLE COLOURS

Available in the complete classic & contemporary ranges of COLORBOND® steel colours.

ADDITIONAL FINISHES

- Colorbond® Matt
- Colorbond® Ultra
- Galvanised Steel
- Zincanneal® Steel
- Metaprep Primer for corrosive environments

SUPPLIED IN SET

- Pre-hung split swing door set
- Cardboard packers between door and jamb

A. PRODUCT CHECK AND SITE

Required: Cutting tool and framing materials for structure cladding.

Note: Keep the door packers in place until the door and jamb set is fully fitted.

- Check your door and jamb set for quality and craftsmanship.
 - If there is damage or fault, contact your supplier immediately.
 - Note:** If you proceed to install a door, the opportunity to claim a replacement on the basis of damage or fault will be limited.
- Decide where your door goes.
 - A Trimdek or Monoclad profile is ideal.
 - All corners of the cut must be safely in the valley of the cladding profile.
 - Ensure there is no structural steel behind the planned cut area.
- Cut the required opening out of the cladding.
 - The required size depends on the size of the door to be installed.

	801.47.1100
DOOR SIZE	2400mm (h) x 1100mm (w)
REQ. OPENING	2415mm (h) x 1123mm (w)

- Extend the horizontal cut across the top about 50mm beyond the intersection with each vertical cut (see Fig. 7).
 - This extended cut allows the top architrave (and optional J-mould weather strip) to slide behind the shed cladding.
- Frame out your door opening with a material as recommended by your shed/garage supplier/erector.

B. DOOR SET INSTALLATION

Note: Door packers must not be removed until door jamb is fully fastened off.

- Make sure top architrave slides behind the shed cladding.
- Once the door is in place (minimum of 10-gauge screws) put one screw in at the top hinge.
 - At this point get the hinge side of the door square/plumb then insert a screw at the bottom hinge and another at lock height (be sure that the door has not moved during this action).
 - Get all gaps even so the whole door is square/plumb, then screw the lock side to match.
 - Continue to screw off the hinge side of the door until complete.
- When screwing off the latch side of the door, again check to make sure the jamb is still square/plumb.
 - The door can drop under its own weight at this point, so if it is not square/plumb it can result in the door not shutting properly and catching.
- Once this is finished, we recommend completing the fixing process on the other side.
 - Note:** 19 screws are the minimum required, however we recommend fixing on the back. If more screws are used these 19 are still required at these points level with hinges and lock (see Fig. 1 and 2).
- (Optional) Cut the j-mould weather strip (sold separately) to the desired length and slide in between the jamb architrave and the structure cladding. The recommended minimum length for the j-mould weather strip should be the width of the jamb from outside to outside.

C. AFTER DOOR INSTALLATION

After the door set is fixed in place:

- Remove packers.
- Remove the protective covering from surfaces. (The longer it remains on, the harder it may be to remove cleanly.)

D. AFTER CARE

To get the most out of your investment, cleaning should occur:

- In rural or normal urban environments, every six (6) months.
- In areas of high pollution, such as industrial areas or coastal environments, every three (3) months.
- In particularly hazardous or corrosive environments such as beachfronts, severe marine environments, areas of high industrial pollution, monthly.

Hinges, Locks, and furniture should also be regularly inspected and cleaned in accordance with the above schedule.

DO NOT use harsh solvents, abrasive cleaners (turps, petrol, kerosene, paint thinners) or scourers on any products. Carry out cleaning in shade and during cooler temperatures using a soft cloth and gentle wiping only.

We recommend that your locks only be serviced by a qualified locksmith.

PRODUCT FILE CODE	DOOR SIZE HxW	DOOR THICKNESS (MM)	OVERALL PRODUCT INSERT HxW	OVERALL EXT. ARCHITRAVE HxW	OVERALL INT. ARCHITRAVE HxW	REVEAL FOR DOOR HxW	CLEAR OPENING REQUIRED HxW	WALL OPENING SIZE HxW	DOOR OPENING ANGLE
801.47.1100	2400 x 1098	35	2410 x 1120	2454 x 1207	-	2406 x 1111	2391 x 1081	2415 x 1123	180°

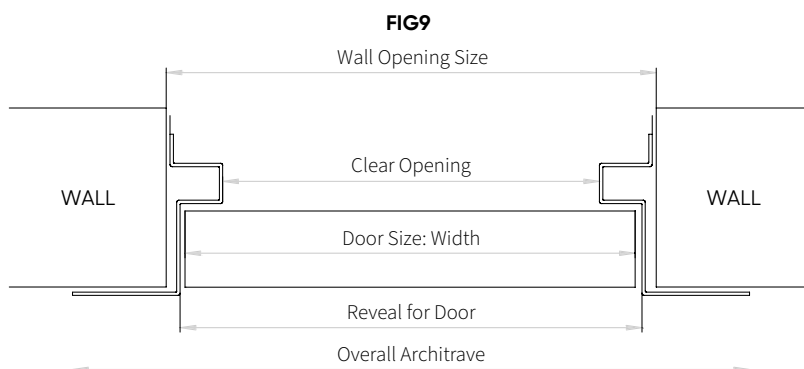
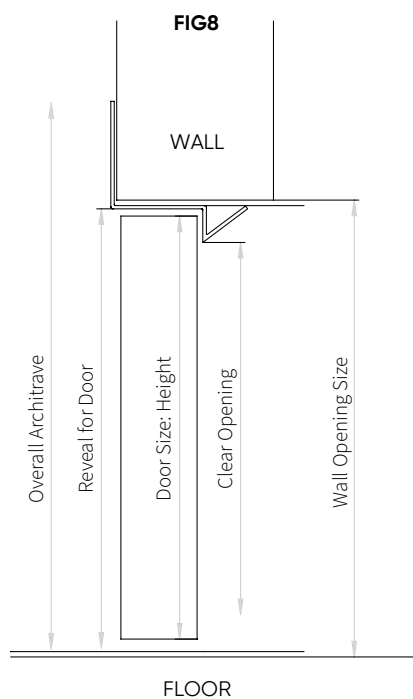

KNOW YOUR HANDING

'Handing' describes where the hinges are on a door that is opening towards you. When you order a new door, it is important to know its handing so that it suits your installation.

HOW DO YOU TELL?

If you open a door towards you and the hinges are on your left, the door is **left-hand hinged**.

If you open a door towards you and the hinges are on your right, the door is **right-hand hinged**.

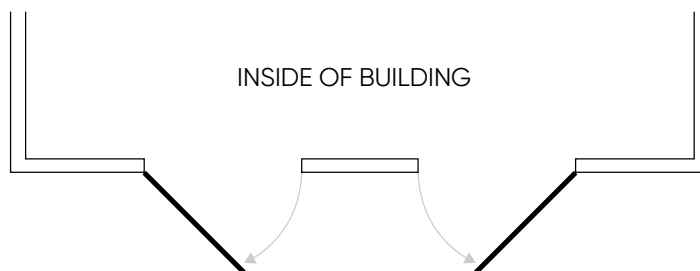

OUTSIDE OF BUILDING

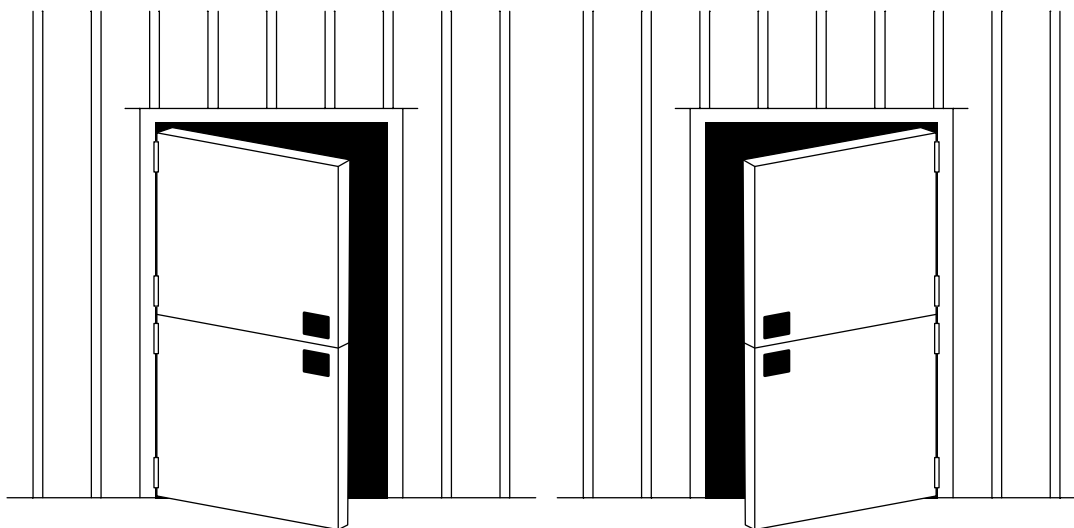

Larnec Doors provide a 24 month warranty on all products. The warranty does not cover the product if incorrectly installed, used or maintained, damage from environmental conditions, fair wear and tear, accidents or salt corrosion.