

Kia EV6



Movement that inspires



OCTOBER 2025

Overseas Model Shown.

The all-new Kia EV6.
The best just got better.

With a sleek, athletic exterior, intelligent interior design and capable performance and handling, the all-new Kia EV6 continues to redefine what an all-electric crossover SUV can be.

Kia EV6. Be inspired by every journey.



Dedicated to the drive.

The all-new EV6 gives you the option of 168 kW single motor Rear-Wheel Drive or dual motor All-Wheel Drive with up to 239 kW, that can accelerate from 0 to 100 km / h in just 5.3 seconds*. The EV6 is capable of towing up to 1,800kg (braked), provided there is more than 35% of charge left in the battery.



* Earth LR AWD & GT-Line LR AWD.
Overseas Model Shown.



The 24" Panoramic Display provides crystal clear driver information, navigation and entertainment with Apple CarPlay® & Android Auto™.



The available Head-up Display* shows key vehicle information, including speed and turn-by-turn directions.

*Earth & GT-Line models only.



Overseas Model Shown.

Quiet confidence.

The EV6's luxuriously minimalist interior offers a supremely spacious, secure and sustainable driving environment that protects you with a suite of advanced safety technologies.

Heated and ventilated* front seats, generous amounts of legroom and a panoramic sunroof** all enhance the feeling of calm and spaciousness.

*Ventilated Front Seats on GT-Line only.
 **Panoramic Sunroof optional extra on GT-Line only.



Overseas Model Shown with driver's knee airbag & 2nd row thorax / pelvis airbags, not fitted to local models.



Overseas Model Shown.
 Panoramic Sunroof Optional Extra on GT-Line only.

The power to charge endless possibilities.

Connected to an ultra-fast DC charger it takes as little as 18 minutes* to charge the EV6 from 10 to 80%.

The EV6's Smart Regenerative Braking system harnesses braking energy to improve driving range and automatically adjusts braking levels by analysing to the road gradient and the vehicle ahead of you.



*Estimated charge time on 300kW hyper charger. Max DC charge rate of up to 240kW may vary according to the condition and durability of the high voltage battery, charger specifications and ambient temperature. Overseas Model Shown.

Need to charge an eBike, power a fridge or even an espresso maker? The V2L^ outlet provides instant power wherever you are.

^V2L Adaptor is available for purchase as a vehicle accessory from your local Kia dealer. Not all features are available on all models.



Overseas Model Shown.

An EV for everyone.

Inspiration comes in many forms. Kia offers a whole family of advanced electric vehicles to fit your needs and lifestyle.

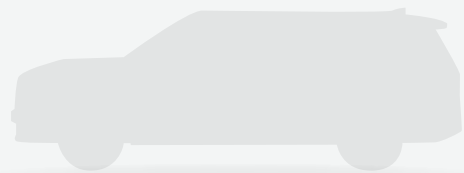

EV9



EV5



EV6



EV4



EV3

Kia Connect™

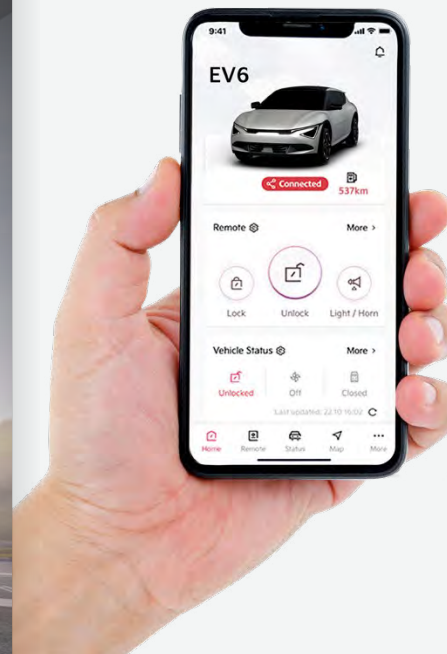

The Kia Connect app is your digital co-pilot.

Use it to set a comfortable cabin temperature before you get in, remotely lock or unlock your EV6 and locate nearby charging stations. There's even a Valet Mode that keeps an eye on your EV6 when you hand over the keys to someone else.



Over-the-Air (OTA) wireless software updates.

Kia Connect ensures your car always has the latest performance and safety software with Over-the-Air updates.

Receive OTA updates as you drive to improve key vehicle functions, such as powertrain, drivetrain, infotainment system, battery and the advanced driver assistance systems (ADAS).

Just accept the OTA update in your EV6 and you can be confident of having the latest safety and performance features without the need to visit a dealership or service centre.

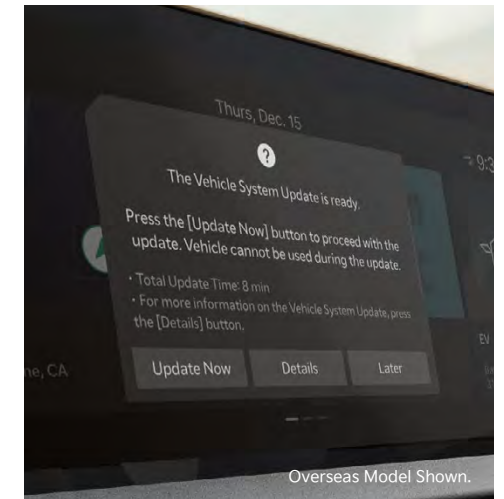

Overseas Model Shown.

Putting the tech into protection.

Wherever you go, day or night, advanced safety systems are constantly working to protect you and your EV6.



Blind Spot View Monitor*

When you activate the turn signal, side mirror-mounted cameras display an uninterrupted view of your blind spots on the instrument cluster.

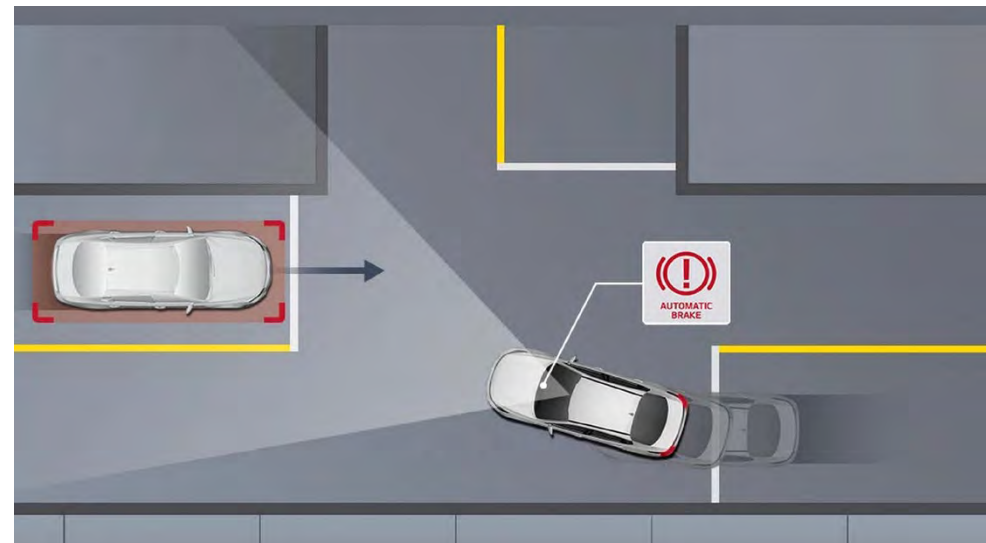

Autonomous Emergency Braking with Junction Turning

Using radar and camera data, the AEB system senses the potential for a collision with a pedestrian, car or cyclist ahead, and applies emergency braking to avoid or reduce the effects of a collision.

When making a right turn across an intersection, the Junction Turning system will detect potential oncoming traffic and automatically apply the brakes to prevent or reduce the effects of a possible collision.

*Earth & GT-Line models only.

Wheels.



19" Alloy
(Light & Earth models)



20" Alloy
(GT-Line model)

Interior Colours.

Light & Earth

SATURN BLACK



GT-Line

SATURN BLACK / OFF WHITE



Light & Earth will be the same colour but different materials.
Light = Cloth & Composite Leather.
Earth = Composite Leather.

Exterior Colours.

All colours and trim materials are based on data available at the time of publication and subject to change without notice.



Snow White Pearl
(GT-Line only)



Aurora Black Pearl



Runway Red



Yacht Blue
(Light & Earth)



Interstella Gray
(Light & Earth)



Glacier
(Light & Earth)



Wolf Gray
(GT-Line only)



Yacht Blue Matt
(GT-Line only)

Specifications.

EV6 (continued)

Specifications key:

- = included
- = not included
- LR - Long Range

	LIGHT LR RWD	EARTH LR AWD	GT-LINE LR AWD
MECHANICAL			
Electric Motor Type	Permanent Magnet Synchronous Motor (PMSM)		
Battery Type	Lithium-Ion		
Battery Capacity	84.0kWh		
Maximum Available Power	168 kW	239 kW	
Maximum Available Torque	350 Nm	605 Nm	
Combined Energy Efficiency	15.9 kWh / 100km	17.0 kWh / 100km	17.7 kWh / 100km
CO ₂ Emissions	0 g / km		
ALL ELECTRIC RANGE & PERFORMANCE			
Maximum Range - WLTP Combined*	582 km	546 km	522 km
Maximum Speed	186 km / h	188 km / h	
0 - 100km / h	7.7 sec	5.3 sec	
TRANSMISSION			
Gearbox	Single Speed Reduction Gear		
Final Gear Ratio (Constant)	10.65		
Shift Controller Type	E-Shift Dial (Shift-By-Wire)		
Drivetrain	Rear Wheel Drive (RWD)	All Wheel Drive (AWD)	
ON BOARD CHARGER			
Maximum Power	10.5 kW		
CHARGING TIME**			
AC Charge with ICCB up to 100% (230V / 12A)	Est. 34 h 40 min		
AC Charge 10% to 100% (11kW Charger)	Est. 7 h 35 min		
DC Charge 10% to 80% (50kW Charger)	Est. 81 min		
DC Hyper Charge 10% to 80% (240kW Max DC Charge Rate)	Est. 18 min		
CHARGING CABLES / INPUT			
Charging cable with ICCB (In-Cable Control Box) included - for home charging	●	●	●
Type 2 to Type 2 Mennekes cable included - for AC public charging	●	●	●
SUSPENSION			
Front Suspension	McPherson Strut + Single Lower Arm Type		
Rear Suspension	Multi-link (5-Link)		
WHEELS & TYRES			
Tyres / Wheels	235 / 55 R19	235 / 55 R19	255 / 45 R20
Wheels Size / Type	19" Alloy	19" Alloy	20" Alloy
Tyre Pressure Monitoring System (TPMS)	●	●	●
Spare Wheel Type	Tyre Mobility Kit (TMK)		
BRAKES			
Braking System	325mm Ventilated Front Discs, 325mm Solid Rear Discs		
Electronic Parking Brake with Auto Hold	●	●	●
STEERING			
Steering System	Rack-mounted Motor Driven Power Steering (R-MDPS)		
Drive Mode Select System	●	●	●
Minimum Turning Radius	5.81m		
Steering Wheel Turn (Lock to Lock)	2.67		
Steering Wheel Adjustment	Tilt and Telescopic		

Specifications.

EV6 (continued)

Specifications key:

- = included
- = not included
- LR - Long Range

	LIGHT LR RWD	EARTH LR AWD	GT-LINE LR AWD
SAFETY FEATURES			
Safety Rating	ANCAP Rating - Pending Final Confirmation		
Anti-Lock Braking System (ABS)	●	●	●
Electronic Stability Control (ESC) & Vehicle Stability Management (VSM)	●	●	●
Multi-Collision Brake System (MCB)	●	●	●
Hill-Start Assist Control (HAC)	●	●	●
Forward Collision Avoidance Assist (FCA); Car / Pedestrian / Cyclist / Junction Turning	●	●	●
Lane Keep Assist System (LKA)	●	●	●
Lane Follow Assist System (LFA)	●	●	●
Driver In Cabin Status Monitor - Camera Type	●	●	●
Blind Spot Collision Avoidance Assist - Rear (BCA)	●	●	●
Rear Cross Traffic Collision Avoidance Assist (RCCA)	●	●	●
Parking Collision Avoidance Assist (PCA) - Reverse, Forward & Side	-	●	●
Blind Spot View Monitor (BVM)	-	●	●
Smart Cruise Control (SCC) with Stop & Go	●	●	●
Intelligent Speed Limit Assist (ISLA)	●	●	●
Manual Speed Limit Assist (MSLA)	●	●	●
e-Call (SOS Call)	●	●	●
Driver & Front Passenger Airbags	●	●	●
Front Centre-Side Airbag	●	●	●
Front Side Airbags	●	●	●
Curtain Airbags (1st & 2nd Rows)	●	●	●
Front Seatbelt Pretensioners with Load Limiters	●	●	●
Height Adjustable Front Seatbelts	●	●	●
3 Point ELR Seatbelts (All Seats)	●	●	●
Seatbelt Reminders for all Seats	●	●	●
Rear Seat Occupant Alert - Basic Type	●	●	●
ISOFIX Child Seat Anchor Points (2x 2nd Row)	●	●	●
Top Tether Child Seat Anchor Points (3x 2nd Row)	●	●	●
Power Child Safety Lock (Auto)	-	●	●
Speed Sensing Auto Door Lock	●	●	●
Remote Smart Park Assist 2 (RSPA 2)	-	●	●
Parking Sensors	Front & Rear	Front / Rear / Side	
Rear View Monitor with Dynamic Guidelines	●	-	-
Surround View Monitor (SVM) with Dynamic Guidelines	-	●	●
EXTERIOR FEATURES			
Standard LED Headlights	●	●	-
Premium LED Headlights with Intelligent front-lighting system	-	-	●
LED Daytime Running Lights	●	●	●
Auto Light Control (Dusk Sensing)	●	●	●
Rear Spoiler with LED Stop Light	●	●	●
Rear LED Fog Lamp	●	●	●
Side Mirrors	Electrically Adjustable, Heated and Folding with LED Side Indicators and High Glossy Cover		
LED Rear Combination Lamps	●	●	●

Specifications.

EV6 (continued)

Specifications key:

- = included
- = not included
- LR - Long Range

	LIGHT LR RWD	EARTH LR AWD	GT-LINE LR AWD
EXTERIOR FEATURES CONTINUED			
Auto Flush Outside Door Handle - Body Colour	●	●	●
Solar & Acoustic Windshield with Solar Front Door Glass	●	●	●
Privacy Glass (Rear Windows & Tailgate)	●	●	●
Aeroblade Front Wipers	●	●	●
GT-Line Exterior Styling	-	-	●
Door Garnish	Non-Painted	Black Paint	Body Colour
Glossy Black Window Beltline	●	●	●
Tilting & Sliding Wide Power Sunroof (with One Touch Safety)	-	-	Optional
INTERIOR FEATURES			
Seating Configuration	5 Seats		
Interior Seat Trim	Cloth & Composite Leather	Composite Leather	Suede & Composite Leather
Premium Relaxation Seat Function	Driver only	Driver & Front Passenger	Driver only
Driver & Front Passenger's Seat Height Adjuster	●	●	●
Driver's Power Adjustable Memory Seat with Lumbar support	●	●	●
Front Passenger's Power Adjustable Seat with Lumbar support	-	●	●
Height Adjustable Headrests with Driver & Passenger Up / Down & Sliding	●	●	●
Heated (3-Step) Front Seats	●	●	●
Ventilated Front Seats	-	-	●
Remote Folding 2nd Row Seats	●	●	●
2-Spoke Composite Leather Steering Wheel with Paddle Shifters	●	●	-
GT-Line exclusive 3-Spoke Composite Leather Sport Steering Wheel Paddle Shifters	-	-	●
Active Sound Design (ASD)	-	-	●
Heated Steering Wheel	●	●	●
Aluminium Sports Pedals	-	-	●
Metal Paint Inside Door Handle	●	●	●
60:40 Split Folding Rear Seat	●	●	●
Rear Seat Centre Armrest with Cup Holder	●	●	●
Driver & Front Passenger's Seat Back Panel with Pocket	●	●	●
LED Front Overhead Console Lamp & 2nd Row Lamps	●	●	●
LED Rear Cargo Lamp	●	●	●
LED Front Trunk (Frunk) Lamp	●	●	●
Luggage Screen	●	●	●
Luggage Net Hook	●	●	●
Under Floor Storage Box	●	●	●
COMFORT & CONVENIENCE FEATURES			
12.3" Colour TFT-LCD Digital Instrument Cluster	●	●	●
12.3" Satellite Navigation System	●	●	●
Kia Connect - Connected Car Service (CCS) & Over-The-Air (OTA) Updates	●	●	●
Apple CarPlay™ ∞ with Voice Recognition	●	●	●

Specifications.

EV6 (continued)

Specifications key:

- = included
- = not included
- LR - Long Range

	LIGHT LR RWD	EARTH LR AWD	GT-LINE LR AWD
COMFORT & CONVENIENCE FEATURES CONTINUED			
Android Auto™ † with Voice Recognition	●	●	●
Bluetooth® Multi-connection functionality	●	●	●
6 Speaker Audio System	●	●	-
14 Speaker Meridian® Premium Sound System	-	-	●
Wireless Phone Charger	●	●	●
2x 12v Power Outlets (1x Behind Centre Console & 1x Cargo Area)	●	●	●
1st Row USB charger (1x Front Console)	●	●	●
2nd Row USB chargers (2x behind 1st row seats)	●	●	●
2x USB Charge Ports - Outside Centre Console	●	●	●
Head-up Display (Windshield-type)	-	●	●
Steering Wheel Mounted Audio & Cruise Controls	●	●	●
V2L - Vehicle to Load Interior 3-Pin NZ Type Socket (Lower of 2nd Row Seat)	●	●	●
V2L - Vehicle to Load Exterior Adaptor (Type2 to 3-Pin NZ Type Socket)	-	-	●
Dual Zone Automatic Climate Control	●	●	●
Auto Window Defog System	●	●	●
Smart Key with Interior Vehicle Start / Stop Button	●	●	●
Immobilizer	●	●	●
Remote Central Locking	●	●	●
Rain Sensing Front Wipers	●	●	●
Front & Rear Power Windows	●	●	●
Front Windows with Auto Up / Down Safety Function	●	●	●
Electrochromic Rear View Mirror (ECM)	●	●	●
Power Tailgate (Height Adjustable)	●	●	●
Sliding-Type Sun Visors with Illuminated Vanity Mirrors	●	●	●
Heat Pump System	-	-	●
DIMENSIONS			
Overall Length (mm)	4,695 mm		
Overall Width (mm)	1,880 mm	1,890 mm	
Overall Height (mm)	1,550 mm		
Wheelbase (mm)	2,900 mm		
Minimum Ground Clearance (mm)	160 mm		
Tare Weight (kg)	2,055 kg	2,155 kg	2,165 kg
Luggage Capacity - Rear Seats Up / Down (VDA)	520 L / 1,290 L		480 L / 1,250 L
Towing Capacity - braked / unbraked (kg)	1,800 kg / 750 kg		
Max. towball download (kg)	100kg		

Information contained herein is for comparative purposes only. Specifications at any given time may vary to the above.

* Driving range figures standards are calculated using the World Harmonised Light Vehicle Test Procedure (WLTP). Actual results achieved will differ according to operating conditions and driving style.

** Charging times of the high voltage battery may vary according to the condition and durability of the high voltage battery, charger specifications and ambient temperature.

*** Not all handsets may be compatible.

****Maximum Towing Capacity should only be achieved when the battery has more than 35% charge remaining

∞ Apple CarPlay: Requires an iPhone 5 or later and it is recommended to always update your iPhone to the latest iOS release. Use the Apple Lightning cable provided with your phone, or Apple certified Lightning cable.

† Android Auto: Requires an Android phone with Android 5.0 Lollipop or higher. It is recommended to always update your phone to the latest OS release. Use the USB cable provided with your phone.

Kia Motors cannot guarantee continued compatibility.

Kia confidence goes further.



All new Kia EV6 Vehicles come with an impressive 7-Year / 150,000 km (whichever comes first) Warranty Programme covering against manufacturing or assembly defects. This warranty programme is transferable between owners and emphasises our commitment to our customers.



All new Kia EV6 vehicles powered by a high-voltage drive battery come with a 8-year / 160,000 km (whichever comes first) warranty that covers components found in the drive battery case. In the event that your vehicle becomes immobile due to a high voltage battery or system failure, we'll cover the cost of the tow to the nearest authorised Kia dealer.



A Roadside Assistance Programme for the duration of the Warranty Period is also offered on every new Kia at no cost. In the unlikely event that your Kia has broken down, help is only a call away and trained staff will be dispatched to your location. If a repair cannot be conducted on the spot, the vehicle will be towed free of charge to the nearest Kia dealer.



Your new EV6 comes with a complimentary 5-year subscription to Kia Connect and Over-the-Air (OTA) Updates. Synchronise destinations, check the vehicle status, control certain vehicle functions and more with the Kia Connect app.

