

Ground Floor

**TOTAL APPROXIMATE FLOOR AREA  
EXCLUDING GARDEN:**  
**1044.5 sq ft (97.04 sq mt)**  
**House : 983.7 sq ft (91.39 sq mt)**  
**Outbuildings: 60.8 sq ft (5.65 sq mt)**  
**Garden: 287.3 sq ft (26.69 sq mt)**

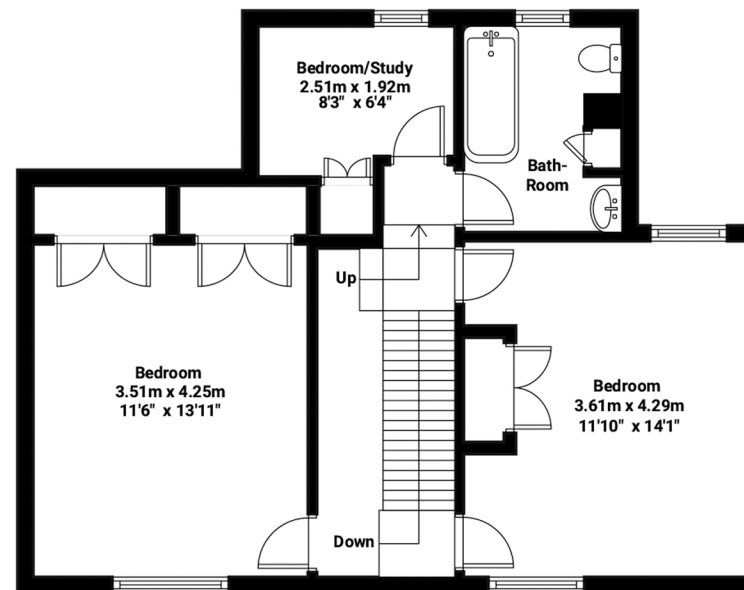

First Floor

## Magpie Cottage, Bures

Illustration for identification purposes only. Measurements are approximate and not to scale.



**NP** NICHOLAS  
PERCIVAL