

# Pre-made Pouch Filler / Sealer TT-8D-N

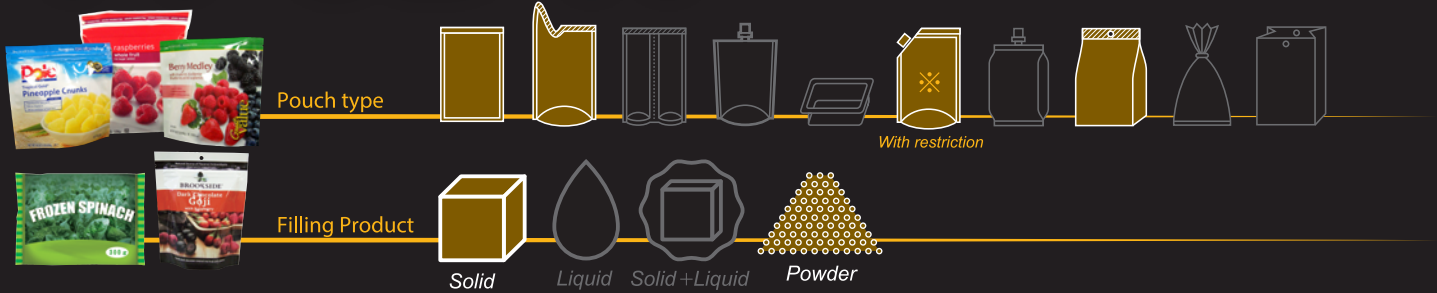

- Widely flexible for various pouch formats and product types.
- Designed for safe and sanitary operation.
- Easy cleaning, washdown design.
- Simple, intuitive operation and maintenance using touch screen controls.
- Optional zipper opening, nitrogen gas flush, liquid filling systems and other features.



Wet Use



Stations



Simplex



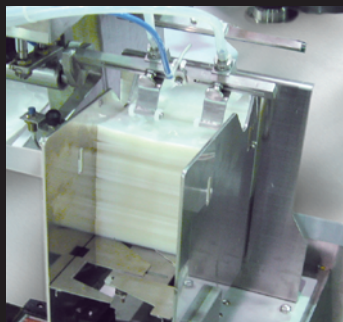

## Elevator Magazine

Simplified, cost-effective pouch magazine for flat pouch only applications.



## Conveyor Magazine

Flat, standup & floating gusset pouch styles. Optional ptc zipper / corner spout styles. Standard & high capacity versions.



## HMI: Color Touch Screens

User-friendly, information rich screens with maintenance functions.

## Machine Dimensions

\* Specifications & dimensions subject to change without notice

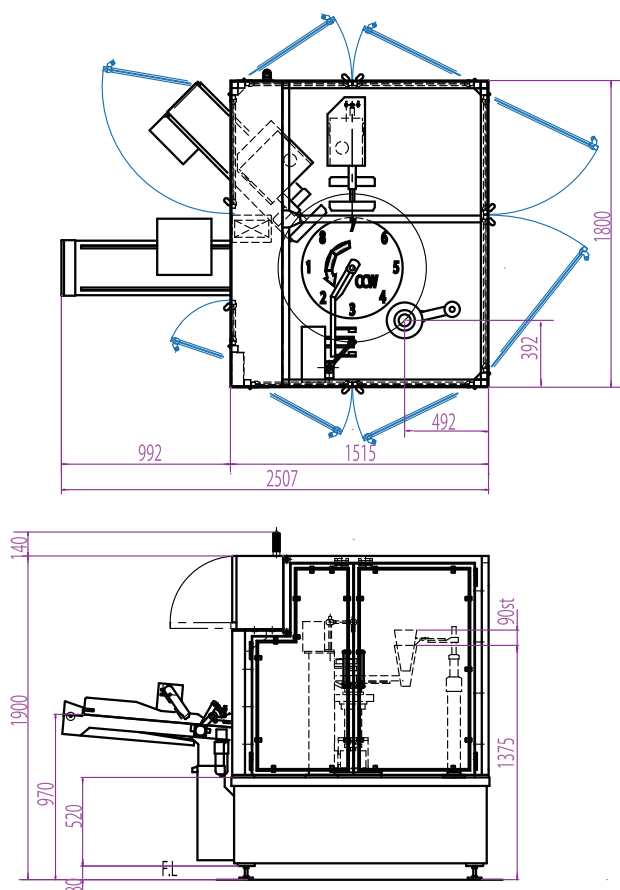

## Machine Specifications

\* Depending on product

<b>Capacity</b>	max. 55 ppm
<b>Pouch Size</b>	W: 120 - 260 mm, 80 - 220 mm L: 130 - 400 mm
<b>Pouch Material</b>	Various laminated pouches, PE pouch
<b>Pouch Style</b>	Flat, standup & floating gusset. Optional ptc zipper style.
<b>Sealing Method</b>	2-stage heat/cool sealing method
<b>Electric Power</b>	5.7 kVA
<b>Air Consumption</b>	0.5MPa (72psi), 350 - 450NL/min(ANR)
<b>Machine Dimension &amp; Weight</b>	W 1,800 x L 2,507 x H 2,040 mm 1,700Kg
<b>Accessories</b>	Product feeding hopper, Product discharge conveyor Pouch opening following guide, Product counter, Heater disconnection alarm Pouch opening detection device
<b>Options</b>	Date printer, Air squeeze device, Tapping Stand-up pouch bottom opening device N2 Gas flush device, Zip open-close device Fill pause mode, Seal area cleaning, Pouch recycle, Double pouch detection, Various filling devices, Pouch pick-up position detection, Product in seal detection

## Applications

Frozen foods, Seafood, Snacks, Rice & other grains, Noodles, Pet foods, Granular & powder products and many others