

Sparks

International Edition

TRUE WIRELESS STEREO

INTRODUCTION

Page-01

Overview and packing list

(The picture is only for reference, please refer to the actual product)

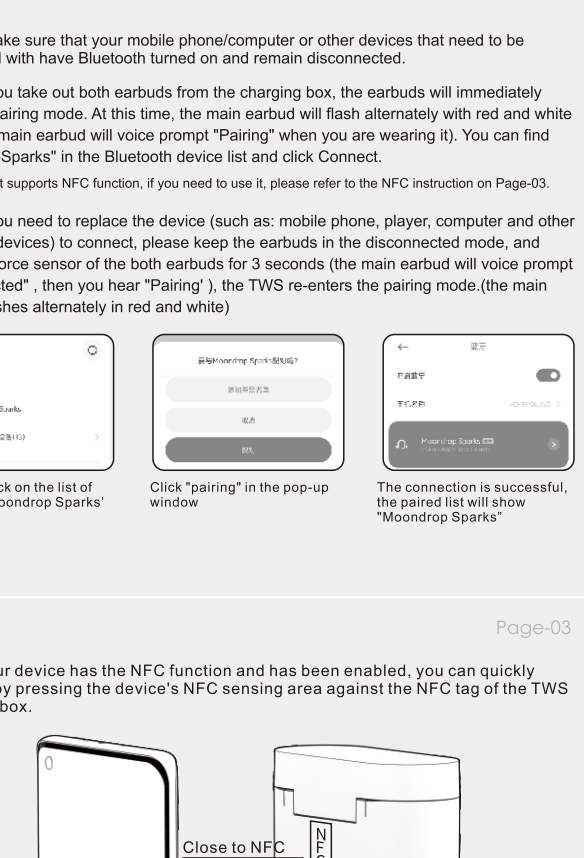

Packaging contains Moondrop-sparks TWS earbuds and charging case, three sizes of ear-tips, USB charging cable, and after-sales service and product manual & safety guide.

Page-02

Connect with your device

Please make sure that your mobile phone/computer or other devices that need to be connected with have Bluetooth turned on and remain disconnected.

1. When you take out both earbuds from the charging box, the earbuds will immediately enter the pairing mode. At this time, the main earbud will flash alternately with red and white lights (the main earbud will voice prompt "Pairing" when you are wearing it). You can find "MoondropSparks" in the Bluetooth device list and click Connect.

*This product supports NFC function, if you need to use it, please refer to the NFC instruction on Page-03.

2. When you need to replace the device (such as: mobile phone, player, computer and other Bluetooth devices) to connect, please keep the earbuds in the disconnected mode, and touch the force sensor of the both earbuds for 3 seconds (the main earbud will voice prompt "disconnected", then you hear "Pairing"), the TWS re-enters the pairing mode.(the main earbud flashes alternately in red and white)



Find and click on the list of devices: "Moondrop Sparks"

Click "pairing" in the pop-up window

The connection is successful, the paired list will show "Moondrop Sparks"

Page-03

When your device has the NFC function and has been enabled, you can quickly connect by pressing the device's NFC sensing area against the NFC tag of the TWS charging box.

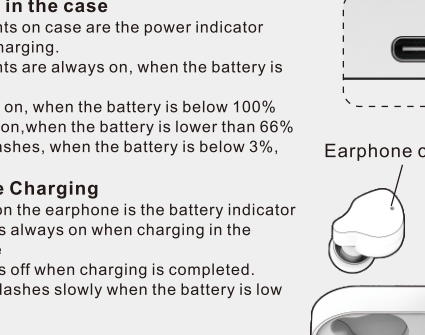

Auto reconnect

When your device and headset have been paired, and neither has been connected to a new device, take the headset out of the charging compartment to automatically pair.

Single Ear

If you only need to use a single earbud, you can put the one earbud back into the charging box after the connection of the earbuds and device is completed.

Page-04

Touch Operation

Function	Status	Operation	Voice/Light indication
Answer the call	Incoming call	Double tap the force sensor	It is "Synchronized ringtone" in iPhone and "default ringtone" in Android, when calling comes in.
Hang up the call	On calling	Double tap the force sensor	/
Reject the call	Ringing	2 Seconds Long Press the force sensor	/
Cancel dialing	On Calling	Double tap the force sensor	/
Play music	Music playing	Double tap the force sensor	1 beep when the operation is successful
Pause playback	Music playing	Double tap the force sensor	1 beep when the operation is successful
Next track	Playing music	Triple tap the force sensor	1 beep when the operation is successful
Previous track	Playing music	Triple tap the force sensor	1 beep when the operation is successful
Siri	Connected	2 Seconds Long press the force sensor	/
DUT	With your Earphone in the case	Tap the force sensor 5 times	/
Reenter pairing	with your Earphone out of the case	long press binaural touch area for 3 seconds	Non-playback or talking status
Binaural re-pairing	Charging state	long press binaural earbuds touch area for 8 seconds	Both earbuds white lights flash

* Operate arbitrary unilateral earbud if not specified in the Operations column
* * Both earbuds out of the box, connected to the device and in a non-audio playback or non-call state.

Page-05

Charging

1.Charging in the case

The three lights on case are the power indicator lights of the charging.

The three lights are always on, when the battery is 100% full

Two lights are on, when the battery is below 100% Single light is on, when the battery is lower than 66%

Single light flashes, when the battery is below 3%,

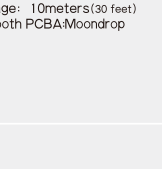

Type-C charger

2.Earphone Charging

The red light on the earphone is the battery indicator The red light is always on when charging in the charging case

The red light is off when charging is completed.

The red light flashes slowly when the battery is low



Charging connector (right)

Charging connector (left)

Case charging indicator

Page-06

Light color indications

(The white light indicates the Bluetooth working state, the red light indicates the battery state)

Earbuds state	Light state
Earbuds in Charging	The red light is always on; the charging box light is always on
Earbuds charging completed	After the charging is completed, the red light turns to white and the light is on for 10 seconds, and the light is off; the charging box light is off after 30 seconds
Earbuds turn on and leave the charging box	After the automatic connection is successful, there is no light prompt, and the voice prompt "Connected", otherwise it enters the Bluetooth pairing mode, and the charging box light turns off after 30 seconds.
Battery power is less than 3.6V	Red light flashes slowly
Both earbuds pairing mode	White light flashes quickly
Bluetooth pairing mode	Red and white flashing alternately

Time management for each state

State	Waiting period	Perform operation
No device connection at starting mode	180 seconds	Shut down (press any key to trigger or enter and exit the warehouse to start)
No call play on connection	360 seconds	Standby (not shut down to keep connected, enter low power consumption mode)
Pairing timeout	180 seconds	Shut down (press any key to trigger or enter and exit the warehouse to start)
Device disconnected	180 seconds	Shut down (press any key to trigger or enter and exit the warehouse to start)

Page-07

Voice prompts

State	Voice
Power on	Power on
Power off	Power off
Pairing	Pairing
Paired successfully	Pairing successful
Pairing failed	Pairing fail
Connected successfully	Connected
Disconnect	Disconnected
Low battery prompt	Battery low
Low power shutdown	Power off

Specifications

Frequency Range: 20-20000Hz (IEC60318-4)
Speaker: 6mm Dynamic Driver
Housing Material: ABS+PC
Diaphragm: Beryllium-Coated Dome+PU
Suspension Ring: Coil: 0.035mm-CCAAM (Daikoku)
Magnetic Circuit: [HEMC] Improved High Density Magnetic Circuit+N52 Neodymium magnet
Acoustic Filter: Patent Anti-blocking Filter
Bluetooth Version: Bluetooth 5.2
Audio Transmission: aptX Adaptive/aptX/AAC/SBC
Battery Capacity: Headphone-50mAh
Battery charging-700mAh
Battery life: 8hours+48hours
Charging current: 5V-500mA
Control mode: Touch, Light tips, Voice prompt
Bluetooth coverage: 10meters (30 feet)
Supplier of Bluetooth PCB: Moondrop

Page-08

Security Instructions

Please read this important security instructions before using the equipment. This information contains general safety information applicable to this device and may include content not applicable to this device. Please follow the warnings and cautions to avoid injury to yourself or others or damage to your equipment.

Warning

Failure to comply with safety warnings and regulations would result in serious injury or death.
Do not use damaged power cord or plug or loose power socket
Unsafe connections can cause electric leakage or fire.
Do not use wet hands or other wet body parts to touch
Touch the device, power cord, plug or power socket, otherwise it may cause electric shock.
When unplugging the power cord, do not use too much force, otherwise it may cause electric shock or fire.
Do not bend or damage the power cord, otherwise it may cause electric leakage or fire.
Do not operate the device with wet hands while it is charging, otherwise it may cause electric shock.
Always use the device in a safe and dry environment.
Do not directly connect the positive and negative terminals of the charger together, otherwise it may cause a fire or cause serious injury.
Do not use the device outdoors during a thunderstorm, otherwise it may cause electric shock or equipment failure.
Use batteries, chargers, accessories and supplies approved by the manufacturer.
Do not use universal batteries or chargers may shorten the life of the battery or cause the device to malfunction. They may also cause a fire or cause the battery to explode.
Fast charging is not supported on this device. Please use a 5V/0.5A input charging adapter for your safety.
Do not put the device in the back pocket or hang it on the waist
Excessive force may damage the device, cause explosion or fire.
If you hit or fall, you may be injured.
Do not drop the device or subject it to strong impact
Otherwise, it may damage the device or battery, cause the device to fail to work normally, or shorten the device life or cause serious injury.
It may also cause overheating, burning or other dangers.

MOONDROP

Page-09

Handle and dispose of equipment and chargers carefully
Do not throw battery or device into fire.
Do not place batteries or devices in or on heating devices (such as microwave ovens, ovens, or radiators). The device may explode if overheated.
Always dispose of used battery or device, please comply with local regulations.
Do not squeeze or pierce the device.
Do not subject the device to external high voltage, otherwise it may cause internal short circuit and overheating.
Protect equipment, batteries and chargers from damage.
Do not use the device in extremely cold or extremely hot temperatures.
Extreme temperature can damage the device, reduce the charging capacity of the device, and shorten the service life of the device and battery.
Do not use the data cable with the skin peeled off or damaged, and the charger with damaged or not working properly.
Do not store device near or in water heaters, microwave ovens, hot cooking equipment, or high-pressure containers
The battery may leak.
The equipment may overheat and cause a fire.
Do not use or store the device in areas where dust or aeolian materials are concentrated
Do not foreign objects may cause device damaged, fire or electric shock.
Prevent the charger socket and the smelter end of the charger from contacting conductive materials such as liquid, dust, metal powder, or pencil lead. Do not touch with sharp tools.
Charger socket: do not bump the charger socket
Conductive materials may short-circuit or corrode the contacts, which may cause explosion or fire.
When using a wireless charger, do not place metal objects, magnets, and magnetic stripe cards between the device and the wireless charger.
The device may not charge properly or may overheat.
If you use medical equipment, please contact the medical equipment manufacturer before using this device to determine whether it will be affected by the radio frequency emitted by this device.
During air flight, the use of electronic equipment will interfere with the airplane's electronic navigator. Follow the airline's regulations and the instructions of the "aircraft crew. If the equipment is allowed, please always use it in a safe and proper way.
The electronic equipment of the car may malfunction due to radio interference from the equipment. For details, please contact the manufacturer.
Do not place the device in a place with dense smoke or fog
Otherwise, the surface of the device may be damaged or the device may malfunction.
If the battery is not used for a long time, the battery may malfunction.
If you use hearing aids and cochlear implants, please contact the manufacturer for information about radio interference.
The radio frequencies emitted by this device may interfere with certain hearing aids and cochlear implants. Before using this equipment, please contact the manufacturer to determine whether the equipment will be affected by the radio frequencies emitted by this equipment while driving.
Do not use the device near radio frequency devices or instruments (such as audio systems or radio antenna towers)

MOONDROP

Page-10

The device and some accessories (sold separately) contain magnets. The American Heart Association and the British Medical Association and the Federal Aviation Administration also warned that magnets will affect implantable pacemakers, heart rhythm converters, defibrillators, insulin pumps or other electronic medical devices (collectively referred to as "medical devices") within 15 cm. operating. If you are a user of any of these medical devices, please do not use this device and some accessories (sold separately) before consulting a doctor.
Note
Failure to comply with safety precautions and regulations can lead to personal injury or property damage
Do not use the device near other electronic devices
Most electronic devices use radio frequency signals. Your device may interfere with other electronic devices.
Equipment with speakers is particularly susceptible to interference.
If you use your device in places that may be interfered by radio frequency such as hospitals, airplanes or cars
If possible, use the device beyond 15 cm of the pacemaker to avoid interference with the pacemaker.
In order to minimize the interference of the device to the pacemaker, please use the device on the side of opposite to the pacemaker.
If you use medical equipment, please contact the medical equipment manufacturer before using this device to determine whether it will be affected by the radio frequency emitted by this device.
During air flight, the use of electronic equipment will interfere with the airplane's electronic navigator. Follow the airline's regulations and the instructions of the "aircraft crew. If the equipment is allowed, please always use it in a safe and proper way.
The electronic equipment of the car may malfunction due to radio interference from the equipment. For details, please contact the manufacturer.
Do not place the device in a place with dense smoke or fog
Otherwise, the surface of the device may be damaged or the device may malfunction.
If the battery is not used for a long time, the battery may malfunction.
If you use hearing aids and cochlear implants, please contact the manufacturer for information about radio interference.
The radio frequencies emitted by this device may interfere with certain hearing aids and cochlear implants. Before using this equipment, please contact the manufacturer to determine whether the equipment will be affected by the radio frequencies emitted by this equipment while driving.
Do not use the device near radio frequency devices or instruments (such as audio systems or radio antenna towers)

MOONDROP

Page-11

Radio frequency may cause device malfunction.
Turn off the device in a potentially explosive environment
Always operate in accordance with regulations, instructions and signs in an explosive environment.
Do not use the equipment in gas stations or near flammable materials, chemical agents and explosive areas.
Do not store or carry flammable liquids, gases or explosive materials in boxes containing device or accessories.
If any part of the device is damaged, smokes, or smells of burning things, please stop using the device immediately. The equipment can not be reused until being repaired by the MOONDROP Service Center.
Broken glass may hurt your hands and face.
If the device emits smoke or the smell of burning things, it may cause the battery to explode or burn.
Please observe all safety warnings and regulations regarding the use of equipment while driving.
Driving safely is your primary responsibility while driving. If prohibited by law, please do not use the device while driving. For the safety of you and others, please follow the safety warnings and relevant regulations and remember the following tips:
Place the equipment in an easy-to-access location. No need to look away from the road to get the wireless device.
In order to avoid danger, pause the call in traffic jams or bad weather conditions (rain, sleet, snow, ice).
Rain and sleet, snow, ice and heavy traffic can cause danger.
Do not record voice memos. Recording a language memo while driving prevents you from focusing on the primary responsibility of driving safely.
According to the traffic situation, decide whether to answer the call reasonably. Answer calls when not moving forward or in traffic jams. Try to call after parking.
Do not engage in nervous or excited conversations to avoid distraction. Please let the caller know that you are driving.
Properly maintain and use equipment
Keep the equipment dry
Moisture and liquid can damage equipment parts or circuits.
Do not turn on the device when it is wet. If the device is turned on, turn it off (if the device cannot be turned off, please maintain the status quo). Then dry the equipment with a towel and contact the local Shuiyueyu service center.
This equipment is equipped with a built-in liquid indicator. Water damage to the equipment will invalidate the manufacturer's warranty.
The device should be stored on a flat ground.
If the device falls, it will be damaged.

MOONDROP

Page-12

The device can be used where the atmosphere temperature is between 0°C and 35°C. You can store the device where the ambient temperature is between -20 °C and 50 °C. Using or storing the device outside the recommended temperature range may cause damage to the device or shorten battery life.
Please store the device in a cool, dry place. Do not store the device in a car in summer, otherwise, the equipment may be damaged or the battery may explode.
Do not expose the device to direct sunlight for a long time, such as on the dashboard of a car. Do not store the device with metal objects such as coins, keys and necklaces.
The device may be scratched or malfunction.
If the battery contacts come in contact with metal objects, it may cause a fire.
Do not store the device near magnetic fields
When exposed to a magnetic field, the device may malfunction or the battery may discharge.
Magnetic stripe cards (including credit cards, phone cards, bank books and boarding cards) may be damaged by magnetic fields.
Avoid contact with the device when it is overheated. Otherwise it may cause low temperature burns, redness and skin pigmentation
After using the device for a long time, pay attention to the heating of the device and avoid contact with the device.
Do not sit on the device, or keep in direct contact with your skin for a long time while the device is charging or connected to the power source.
High temperature resistance varies from person to person. Please pay special attention when using it by children, the elderly.
Protect hearing and ears when using earplugs
Excessive exposure to strong sounds can cause hearing loss.
Contact with strong sounds while walking may distract you and cause accidents.
Always turn down the volume before using earplugs, and use only the lowest volume required to listen to conversations or music.
If there are foreign objects on the earplugs, and you wear the earplugs for a long time, it may cause ear infections. Please keep the earplugs dry and clean.
In a dry environment, static electricity may accumulate in the earplugs. Avoid using this earplug in a dry environment, or touch metal objects to discharge static electricity before using the earplug.
Do not use headphones while driving or riding a horse. Otherwise, it may distract you and cause accidents. Depending on your area, this may also be illegal.
Precautions for using the device during walking or moving.
Always pay attention to your surroundings to avoid harming yourself or others.
Do not paint or paste paper on the equipment

MOONDROP

Page-13

If you are allergic to the paint or metal parts of the device, it may cause itching, eczema or swelling of the skin. When the above situation occurs, please stop using the device and consult a doctor.
Do not place equipment and accessories in or near the airport deployment area. If the equipment is improperly placed, the airport metal detectors, which can cause serious injury.
Do not drop the device or cause collision
The device may be damaged or malfunction.
If the device is bent or deformed, it may damage the equipment or cause parts malfunction.
Ensure the longest service life of the battery and charger
If the battery is not used for a long time, the battery may malfunction.
The equipment will discharge if left unused for a long time, and must be recharged before use.
When the equipment is not in use, disconnect the power supply.
The battery can only be used for the designated purpose.
Follow all the instructions in this manual to ensure the longest service life of the device and battery. The manufacturer will not provide warranty for damage or poor performance caused by failure to follow the warnings and instructions.
The equipment may wear out over time. Although some parts and repairs are guaranteed during the warranty period, damage or deformation caused by the use of unapproved accessories is not covered by the warranty.
Do not disassemble, modify or repair the equipment
Any changes or modifications to the equipment will cause the manufacturer to not guarantee the equipment. For repairing, please contact your local MOONDROP authorized dealer.
Do not disassemble or modify the equipment, as this may cause an explosion or fire.
Do not disassemble or reuse the battery.
When cleaning the equipment, please follow the following advices
Use a soft and dry cloth to wipe the device, use a brush or other tools to remove the earwax or dirt on the device.
Clean the battery contacts with a dry cloth.
Do not use chemicals or cleaning agents. Otherwise, the surface of the equipment may be discolored or corroded, and it may also cause electric shock or fire.
Prevent the equipment from contact with dust, sweat, ink, oil, and chemical products (such as cosmetics, antibacterial sprays, hand sanitizers, detergents and insecticides.)
Otherwise, the internal and external parts of the device may be damaged, or the performance may deteriorate. If the device comes into contact with any of the above-mentioned substances, please wipe it with a soft, lint-free cloth.

MOONDROP

Page-14

Do not use the device for any purpose other than the designated purpose
The device may malfunction
Avoid disturbing others when using the device in public places
Only qualified personnel are allowed to repair the device
If the equipment is repaired by unqualified personnel, the equipment may be damaged and the warranty will not be provided.
Do not distribute copyrighted content
Do not distribute copyrighted material without the permission of the content owner. This behavior violates copyright law. The manufacturer is not responsible for any legal problems caused by any illegal actions by users against copyrighted content.
Disclaimer
All content and services available through this device belong to third parties and are protected by copyright, patents, trademarks and other intellectual property laws. Such content and services are only for personal non-commercial use. Without the permission of the content owner or service provider, you may not be able to use any content or service. In addition to the above restrictions, unless you have the explicit permission of the application content or service provider, you may not be able to modify, copy, republish, upload, post, transmit, translate, or repost, any content or service displayed through this device, sell, create new derivative works, develop or distribute in any way.
Third-party content and services are provided. For any purpose, MOONDROP Company does not provide any express or implied guarantees for the content or services provided. MOONDROP Co. expressly declares that it does not assume any implicit guarantees. Or through regulations, common law, or other means (including but not limited to marketability or applicability for specific purposes) recognized terms or conditions. In any case (including negligence), any content or service provided through this device, Even if it has been notified in advance that there is a possibility of such damage, whether it is in contract or tort, any direct, indirect, accidental, special or corresponding loss or damage compensation costs, attorney fees, various expenses or any resulting from other losses or damages, or connecting any information contained, or the results caused by you or any third party using any content or service, MOONDROP Co. does not guarantees for its accuracy, validity, timeliness, legality or completeness.
Third-party services may be stopped or interrupted at any time, and MOONDROP Co. is not responsible or guarantees for any content or the time period during which the service is available while driving. The content and services are transmitted by third parties through networks and transmission equipment outside the control of MOONDROP. In addition to the generality of the exemption clause, MOONDROP

MOONDROP

Page-15

also expressly stated that it does not assume any responsibility or obligation for any interruption or delay of any content or service applicable to this device.
MOONDROP Co has neither responsibility nor obligation for customer service involving content and services. Any service requirements related to content or services should be directly borne by the content and service providers.

Content of hazardous substances in products

Name	Hazardous substances and elements					
	Pb	Hg	Cd	PBB	PBB	PBDE
Circuit components	X	O	O	O	O	O
Metal parts	O	O	O	O	O	O
Plastic parts	O	O	O	O	O	O
battery	X	O	O	O	O	O
annex	X	O	O	O	O	O

This form is compiled in accordance with SJ/T 11364.
O: Indicates that the amount of the hazardous substance in all homogeneous materials of the part is below the limit requirement specified in GB/T 26572-2011.
X: Indicates that the content of the hazardous substance in at least one of the homogeneous materials of the part exceeds the limit requirement specified in GB/T 26572-2011, and there is currently no mature alternative in the industry. Please handle such parts or substances properly to avoid impact on the environment and human health.

MOONDROP