

Multi-Use Games Area (MUGA) 20 x 14m

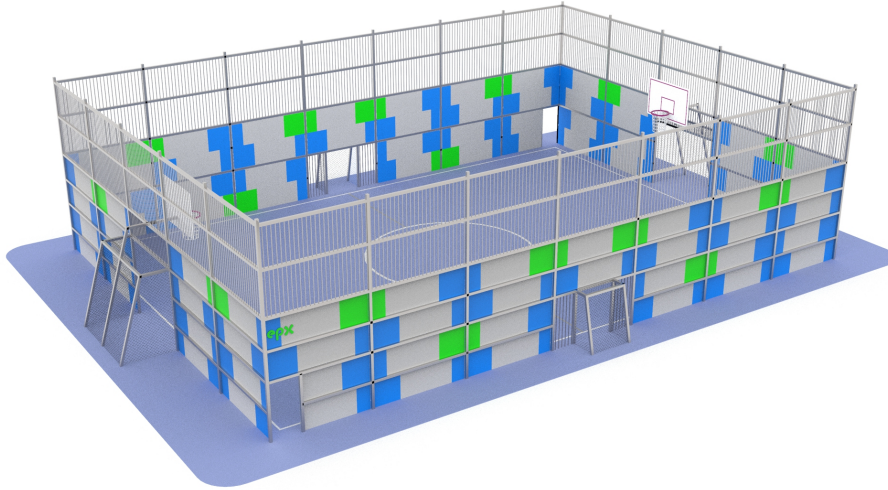

Technical Data



DIMENSIONS

20.75 x 14.2 m



SAFETY ZONE

Fully enclosed



HEIGHT

5.14 m



FREE-FALL HEIGHT

N/A

Conforms to: BS EN 15312:2007+A1:2010

Multi-Use Games Area (MUGA) 20 x 14m

Materials & Construction

Frame: 70 x 70 mm steel profile, anti-corrosion treated and powder-coated

Profiles & tubes: stainless steel and anti-corrosion-treated powder-coated steel

Panels: colour HDPE

Balustrades: double-framed stainless-steel mesh with weather- and UV-resistant HDPE

Basketball hoop: included

Fixings: bolts and profiles anti-corrosion treated and plastic-capped

Warranty: 48 months unit / 10yr HDPE / 15yr structural

Manufactured and tested in accordance with BS EN 15312:2007+A1:2010.

The equipment shown is a computer visualisation only; the actual product will look similar. Colours may vary from those shown. Construction materials can be tailored to the customer's requirements. Dimensional tolerance +/- 5cm.

Additional Views

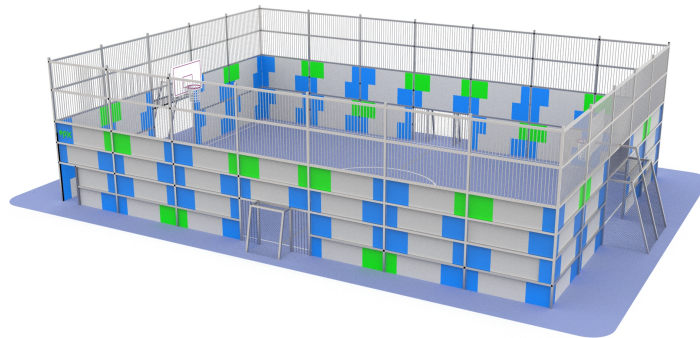

Why Choose This Product

The Multi-Use Games Area is a fully enclosed, all-weather ball court that turns one footprint into a football pitch, basketball and netball court and general games space. Perimeter fencing, integrated goals, a basketball hoop and rebound walls keep play contained and continuous — a hard-wearing centrepiece for schools, parks, housing developments and community sports sites.

- One enclosed court for football, basketball, netball and team games
- Perimeter fencing with integrated goals, basketball hoop and rebound walls
- Powder-coated 70 x 70 mm steel with stainless-steel mesh-and-HDPE balustrades
- Certified to BS EN 15312:2007+A1:2010 for free-access multi-sports equipment