



## SHAFT POWER LIMITATION

Reliable shaft power limitation system for EEXI compliance and continuous monitoring

MAIHAK SHaPoLi enables compliance with EEXI requirements through continuous monitoring and limitation of shaft power. The system provides transparent power monitoring, reliable recording of exceedance events and a proven solution for regulatory compliance.

### Why Shaft Power Limitation

- Supports EEXI compliance
- Transparent monitoring of power reserve usage
- Simplified compliance documentation
- Reliable event recording
- Easy retrieval of operational logs
- Improved operational transparency
- Easy and fast to install
- All time direct access to full engine power
- Features additional performance measurement

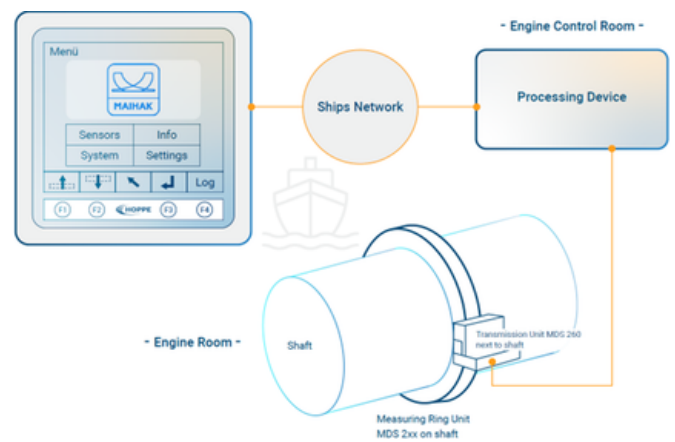

### System Design

- HOMIP 2 control and monitoring platform
- Continuous comparison of actual and permitted shaft power
- Automatic exceedance monitoring
- Event logging and reporting functionality
- USB-based log file export
- Integrated alarm management system

## Maihak Shapoli (Stand Alone)

- Limitation based on actual power measurement device
- Limitation can be exceeded at any time (safety aspect)
- No limitation when reversing (stop maneuver)
- Added value of the additional power measurement
- Automatic event logging
- Tamper-proof due to permanent recording
- No changes to existing systems necessary
- Excellent performance / price ratio

## Engine Power Limitation (EPL)

- Limit calculation based on injected fuel amount , not considering fuel's quality nor main engines condition
- Limitation also in reverse (worse stopping behavior)
- No added value
- Changes to existing engine control system software necessary
- Software solution usually quite expensive

## OUR PRODUCT RANGE

### Fluid & Floating

- Valve Remote Control
- Anti-Heeling
- Tank Gauging
- Flume Anti-Rolling
- Interling Anti-Rolling
- Distance Measuring
- Draught Measurement
- Electronic Inclinator
- Dynamic Draught and Floating Monitoring
- Floating Condition Control

### Performance & Energy

- Emission Monitoring
- Energy Measurement
- Shaft Power Meter
- Fuel Measurement
- Energy Saving Solutions
- Crew Connect
- Performance Monitoring
- Data Collection and Acquisition

### Fleet Services

- Spare Parts
- Technical Service
- Retrofit- And Upgrades
- MIoT Digitalization Upgrade

[www.hoppe-marine.com](http://www.hoppe-marine.com)

