

Fomite Test Project Planning





Project Planning

Test Number	Test Type	Sample Type	Air Sample Rate (L/min)
4	Fomite Test	Swab	NA

No. of OP	No. of SP	Tag Series	Sprayer	Survey Date
2	4	B	eSprayer 65 psi	2-18-26

Comments
Start Time: 1500

OPName	Tag	Lot Number
OP-001	B1	20250725
OP-002	B2	20250725

Manage Origin Points (OPs) and Sample Points (SPs)

Origin Points

- OP-001: Reception Desk
- OP-002: Training Studio Door

Sample Points

- SP-001: Reception Desk
- SP-002: Training Studio Door
- SP-003: Cardio: Tread Mill Handle
- SP-004: Upper Body: Free Weights

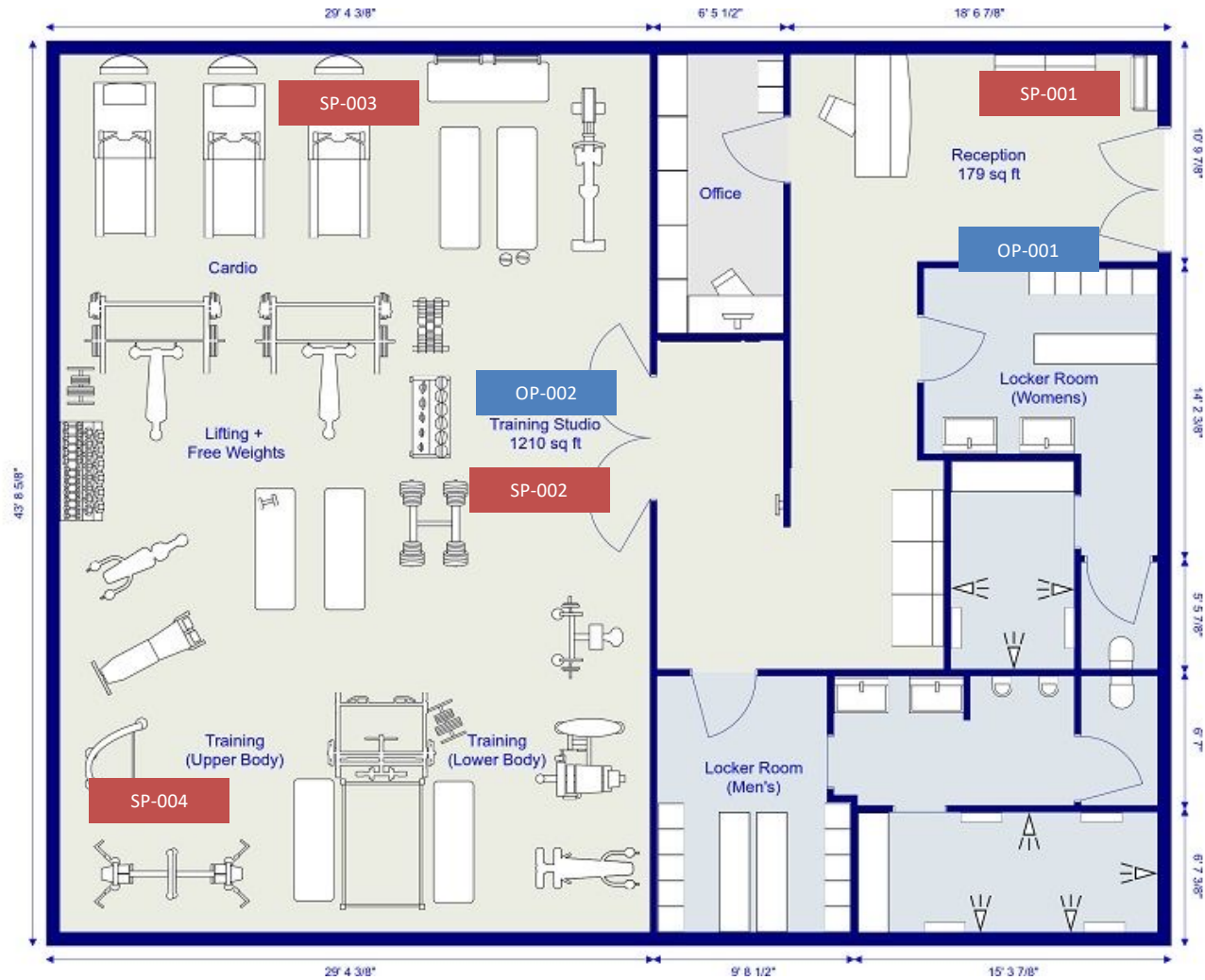

Equipment Used for Fomite Test

- eSprayer
- Yellow Cable Cord
- Wireless Module
- Battery
- Battery Cable
- Nozzle
- Syringe
- Power Cord
- Air Compressor
- Plastic Weigh Boat and Swab



Fomite Test Set-Up and Execution

- **Special Instructions**

- Do not release the buffer solution
- Remove the swab from the collection tube
- Using one hand hold the plastic weigh boat down at the edge and swab using the traditional swab technique and pattern
- Return the swab to the collection tube and place into the plastic bag

- **Traditional Swab Technique**

- Hold swab by plastic shaft about one inch (1") from the cotton tip
 - Apply sufficient pressure to the sample surface to allow a 10° to 20° bend in the swab
 - Rotate the swab so that the entire cotton tip meets the sample surface, and the sample covers all sides of the swab
-

Fomite Test Set-Up and Execution

- **Surface Area**
 - Approximately a 4" by 4" (16 sq. in.) surface area
- **Direction and Number**
 - 10x Vertical (downward)
 - 10x Horizontal (left to right)
 - 10x Diagonal (top right to bottom left)

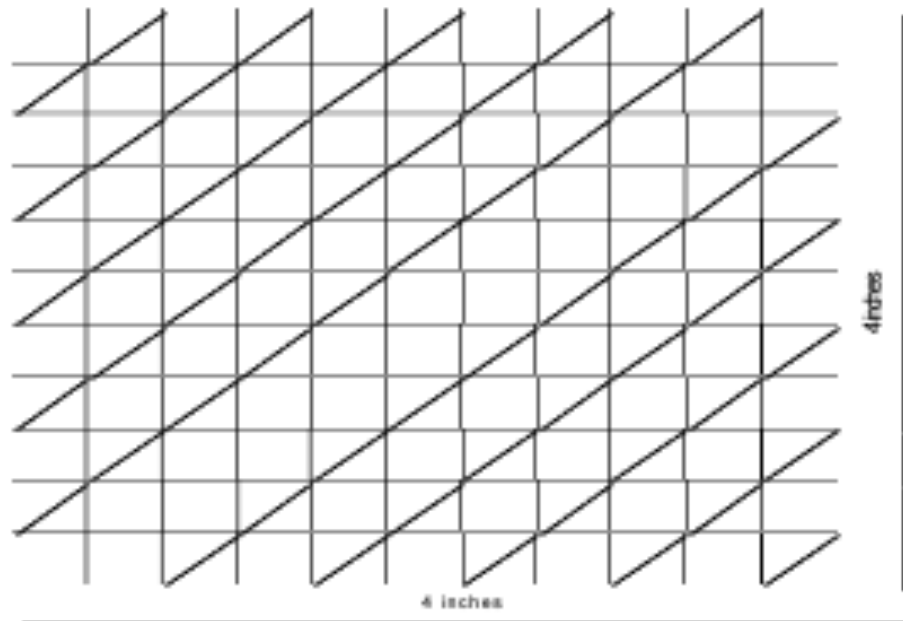

Fomite Test Execution and Completion

- Try to release all tags within five to ten minutes. If you are unable to release all tags within five to ten minutes you may need to extend the test time
 - Place the plastic weigh boat at each sample point location
 - Go to the OP with the pressurized eSprayer and air compressor and release the first tag using the battery/module
 - After the tag is released, remove your gloves, and place them next to the syringe. This will be an indicator that the tag has been released. Repeat for the remaining releases
 - Take the eSprayer and air compressor to the next OP location, pressurize the eSprayer, attach the new tag (syringe) and release the tag
 - Move and continue with the remaining six OPs
 - Swab sample point locations after the 30 minutes of test time has ended
-

Best Practices

- Get a cart to help carry the equipment
- Start the air-samplers at the time of set-up
- Verify the locations of HVAC supply equipment positioning
- Do not pre-label the sample cassettes
- Make sure the sample cassettes are snugly attached to the air sampler
- Listen for the “click” sound of the “nozzle” when attaching to the eSprayer
- Wear gloves when handling Tags

Best Practices

- Make sure the “plunger” is removed from the syringe
- Remove pelican, unused equipment, supplies, etc. before starting the test
- If a Tag spills or misfires you can not “redo” the Origin Point, consider these results lost
- After the test manually turn off the air-samplers
- Count the number of swabs when collecting the sample. If a swab breaks during sampling and you cannot continue document the swab number completed on the project configuration, this will help when analyzing the data
- Verify the sample number label on each sample cassette are in the correct order before removing from the air sampler
- Document all changes on the “Project Configuration” form

Fomite Test Results Visualization

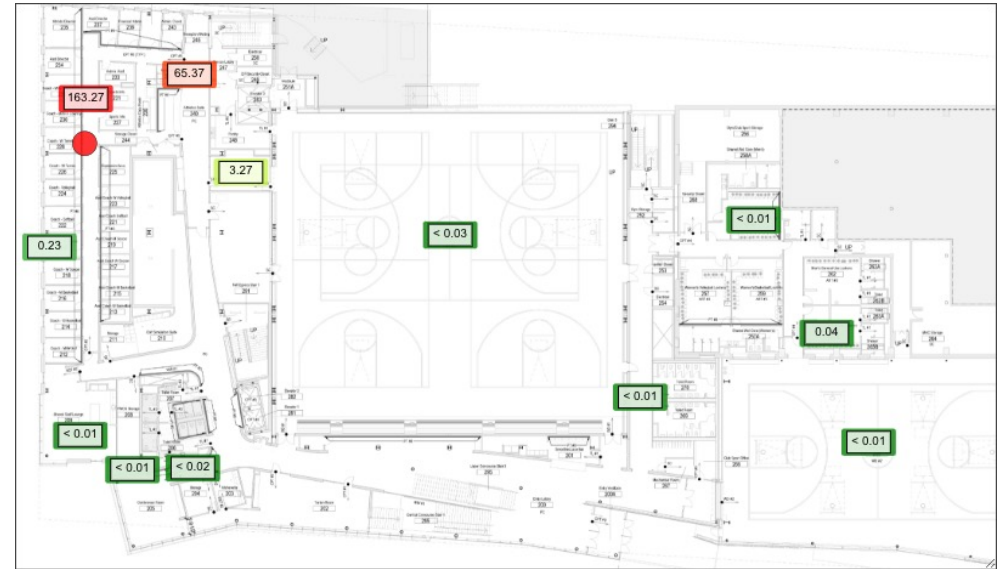

OP	Sample Location	Pass (<1 DNA Copies per million emitted)
OP-1	Corridor W	10 of 12

DNA Copies per million emitted

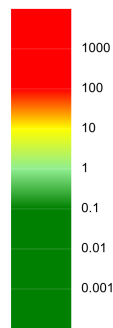

OP	Sample Location	Pass (<1 DNA Copies per million emitted)
OP-2	Corridor S	9 of 12