

LEGEND

- STORMWATER LINE AND MANHOLE
- WASTEWATER LINE AND MANHOLE
- HV AND LV POWER
- WATER
- COMMS
- DRAINAGE EASEMENT
- MINOR CONTOUR (0.1m)
- MAJOR CONTOUR (0.5m)
- RISING MAIN
- POWER CONNECTION
- COMMS CONNECTION

NOTES

- BOUNDARY AND AREA INFORMATION SHOWN HEREON IS SUBJECT TO SURVEY APPROVAL.
- COORDINATES ARE IN TERMS OF GD2000 MT EDEN CIRCUIT.
- CONTOURS ARE DERIVED FROM A DRONE SURVEY UNDERTAKEN ON 20/09/2022 AND ARE GENERALLY EXPECTED TO BE ACCURATE TO + OR +/-10mm WHERE LEVELS ARE CRITICAL TO ARCHITECTURAL DESIGN, THE DESIGNER SHOULD VERIFY LEVELS ON SITE.
- DRAINAGE LID AND INVERT LEVELS WERE PROVIDED BY THE CONTRACTOR FOR THE WORK.
- LEVELS ARE IN TERMS OF AUCKLAND VERTICAL DATUM 1946.
- ALL STORMWATER LINES OVER DN150 ARE RCCRJ CLASS 4 UNLESS SHOWN OTHERWISE.
- ALL CATCHPITS ARE STANDARD 675x450mm CAST IRON GRATING AND FRAME.
- ALL INVERTS ARE MEASURED CLOCKWISE FROM THE OUTLET .
- STORMWATER MANHOLES ARE 1050mm UNLESS SHOWN OTHERWISE.
- ALL WASTEWATER LINES ARE DN 150 uPVC DWV SN16 AS/NZ 1260, UNLESS SHOWN OTHERWISE.
- ALL WASTEWATER MANHOLES ARE DN1100mm UNLESS SHOWN OTHERWISE.
- ALL WASTEWATER CONNECTIONS ARE DN100 uPVC SN16 TO AS/NZS1260.
- ALL WATER SUPPLY MATERIALS COMPLY WITH WSL MATERIAL STANDARDS.
- ALL LOT CONNECTIONS TO BE OD25PE (INTERNAL DIA 20mm) TO FIT A 20mm METER, IN ACCORDANCE WITH WS18.
- CONSTRUCTION WAS UNDERTAKEN IN 2021 AND 2022.

CIVILPLAN CONSULTANTS

Level 9, Laidlaw House, 20 Amersham Way, Manukau, Auckland. Phone: 09 222 2445

THIS DRAWING (AND DESIGN) REMAINS THE PROPERTY OF CIVILPLAN CONSULTANTS LIMITED AND MAY NOT BE REPRODUCED OR ALTERED WITHOUT PRIOR AGREEMENT FROM CIVILPLAN CONSULTANTS LIMITED. CIVILPLAN CONSULTANTS LIMITED WILL NOT ACCEPT LIABILITY ARISING FROM UNAUTHORISED USE OF THIS DRAWING.

PROJECT TITLE:

KARAKA HARBOURSIDE ESTATE
PARAREKAU ISLAND
HINGAIA

SHEET TITLE:

ASBUILT SITE PLAN
LOT 77

SCALE: (A1/A3)

1:100 / 1:200

SCALE BAR

0 2 4 6 8 10m

ISSUE STATUS:

ASBUILT ISSUE

PROJECT NUMBER:

1829-04

DRAWING NUMBER:

AB130-77

REVISION DATE:

09.02.2023

REVISION DETAILS:

A

DRAWN:

TTK

CHECKED:

TRS

APPROVED:

MSS

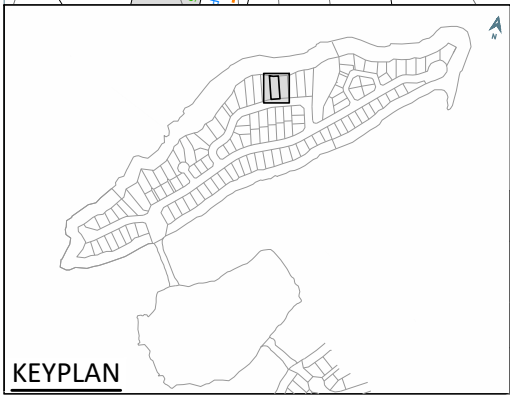

SCHEDULE OF AREAS		
LEGAL DESCRIPTION	RT	AREA
LOT 77 DP 577805	1087197	1022m ²
	TOTAL	1022m ²