

PLEASE NOTE - THIS DRAWING HAS BEEN PRODUCED FOR LAND REGISTRATION PURPOSES ONLY.

Ground Floor & Basement, 29-33 Camberwell Church Street, London, SE5 8TR

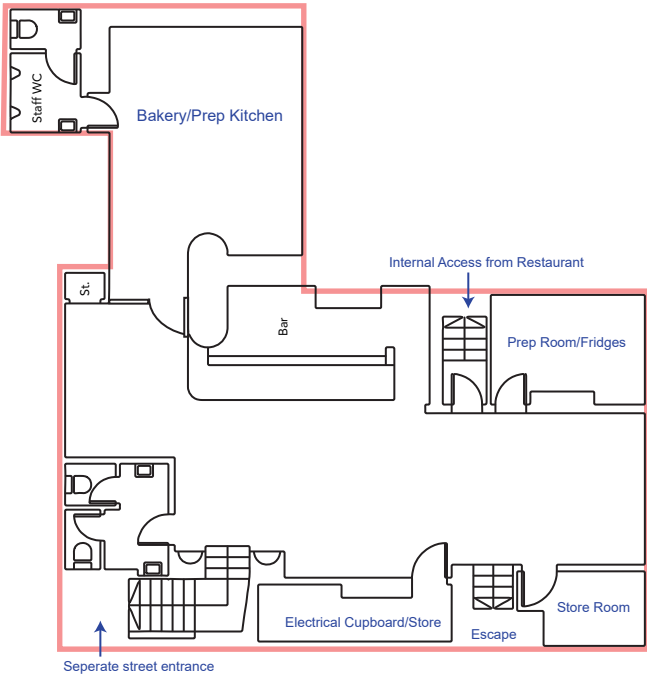

Basement Bar/Bakery
1697.4 SQFT

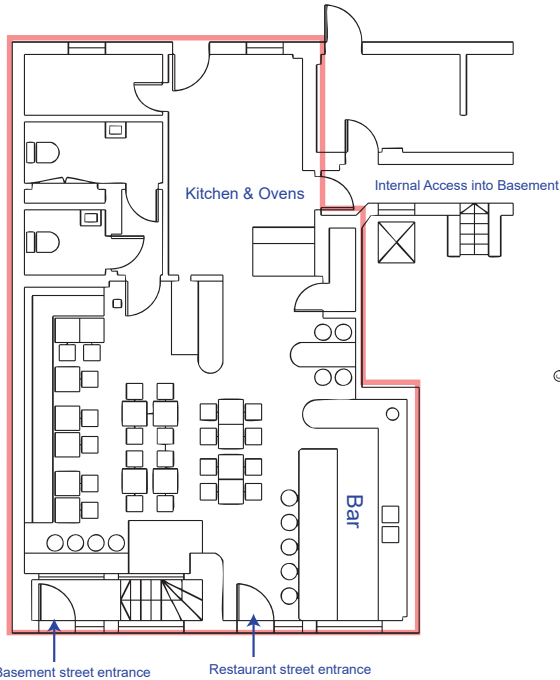

Ground Floor Restaurant
1278.0 SQFT

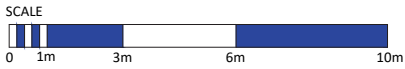

Demised Areas

Plans adapted slightly and are only roughly to scale to show current layout

client	address 29-33 CAMBERWELL CHURCH STREET LONDON SE5 8TR	location BASEMENT AND GROUND FLOOR LEASE PLAN	date 18.02.2022	scale 1:200	sheet A4	
			dwg no. PL14106-02	revision A	drawn MF/VH	
				checked PB		