

# SAS130

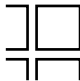

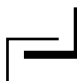
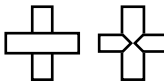
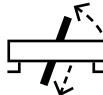

# Overview

SYSTEM GROUP		GRID			
					
Suspended Ceiling		Exposed Grid – SAS Tee Grid or SAS Alugrid variants			
TILE		GRID			
					
Lay-in		Butt-cut junctions or precise mitred joints			
ACOUSTICS					
<b>A–D</b>		<b>15–45dB</b>			
Absorption class		Insulation			
ACCESS		SYSTEM WEIGHT		LIFE EXPECTANCY	
		8mm tiles approx. <b>5kg/m²</b> 16mm tiles approx. <b>7.5Kg/m²</b> 19mm tiles approx. <b>10.75Kg/m²</b>		<b>25yr</b>	
Lift and Tilt		Based on 600 x 600mm tiles*		In excess of	

**\*Note** This includes the entire system and full associated components (suspension, tile, acoustic pad and associated fixings.)

# SAS130

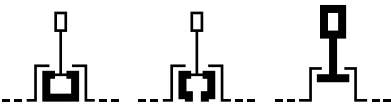

SAS130 offers either a flush (Alugrid) or tegular (Tee Grid) finish metal ceiling, depending on aesthetic preference. Lay-in tiles are quick to mount and dismount offering simple access to the ceiling void.

The suspended ceiling integrates seamlessly with both partitioning and signage for hassle free installations (Alugrid Q). The system can also form an airtight seal (with Alugrid Cleanseal) for air management and moisture control applications. Typical applications of SAS130 include commercial offices, Data Centres and labs.

### Module Sizes (mm)

500 x 500	Bespoke module sizes and shapes are available on request.
600 x 600	
750 x 750	

### Access

The void is completely accessible by removing the lay-in tiles, with no need for specialist tools.

### Finishes

SAS130 is available in all standard SAS finishes, please refer to page 105. Bespoke finishes are available on request.

### Perforations

Typically supplied with 1522 (available as stock item), 1820 or 2516. For our full range of perforations, please refer to page 83. Bespoke perforations are also an option.

### Acoustic Materials

8/16/19mm deep, 80Kg density mineral wool pad with black tissue face, foil back and sides. Other acoustic materials are available, please refer to page 20.

### Service Integration

Tiles can be formed with apertures during manufacturing and post painted for integration with lights and other services.

**Please note** Alugrid-Q sections can be supplied with “bird’s mouth” mitres on one side only. These form a flush abutment to lighting and other services resting directly on the grid. These sections are suitable for ceilings where the services are of a larger modular size than the ceiling tiles.

**Please note** SAS130 can support additional loads up to 3Kg. This is based on a point or uniformly distributed load over 0.36m², with hanger centres positioned 1000mm apart, maximum. For loads greater than 3Kg, SAS recommends using independent suspension.

### Airtightness and Acoustics

The Alugrid-P Cleanseal grid option creates an airtight barrier between the grid and tile. This stops unwanted dirt getting in behind or falling through the tile. This can be a highly desirable trait in labs and Data Centre applications.

### Partitioning and Signage

The continuous linear thread form allows the easy location and relocation of partition heads by means of an M6 bolt. The design of Alugrid-Q means this can happen repeatedly without causing damage. This same feature also allows for hanging signs and other lightweight features.

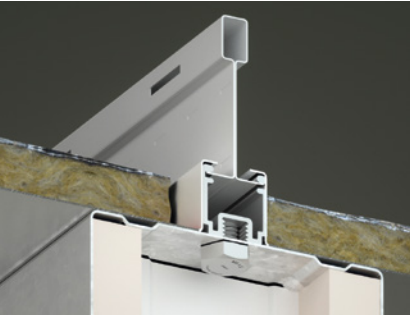

### Technical Support

Please contact our technical team for all questions relating to access, security, bespoke features, service integration or load support.

# SAS130

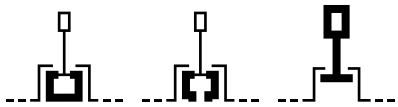

### Perspective Drawing

- 1 Emac Hanger
- 2 Emac Suspension Bracket
- 3 Main Tee
- 4 Cross Tee
- 5 Noggin
- 6 Perimeter Trim
- 7 Perimeter Wedge
- 8 SAS 130 Lay-in Tile

\*Lightweight installations only, see page 252 for full details.

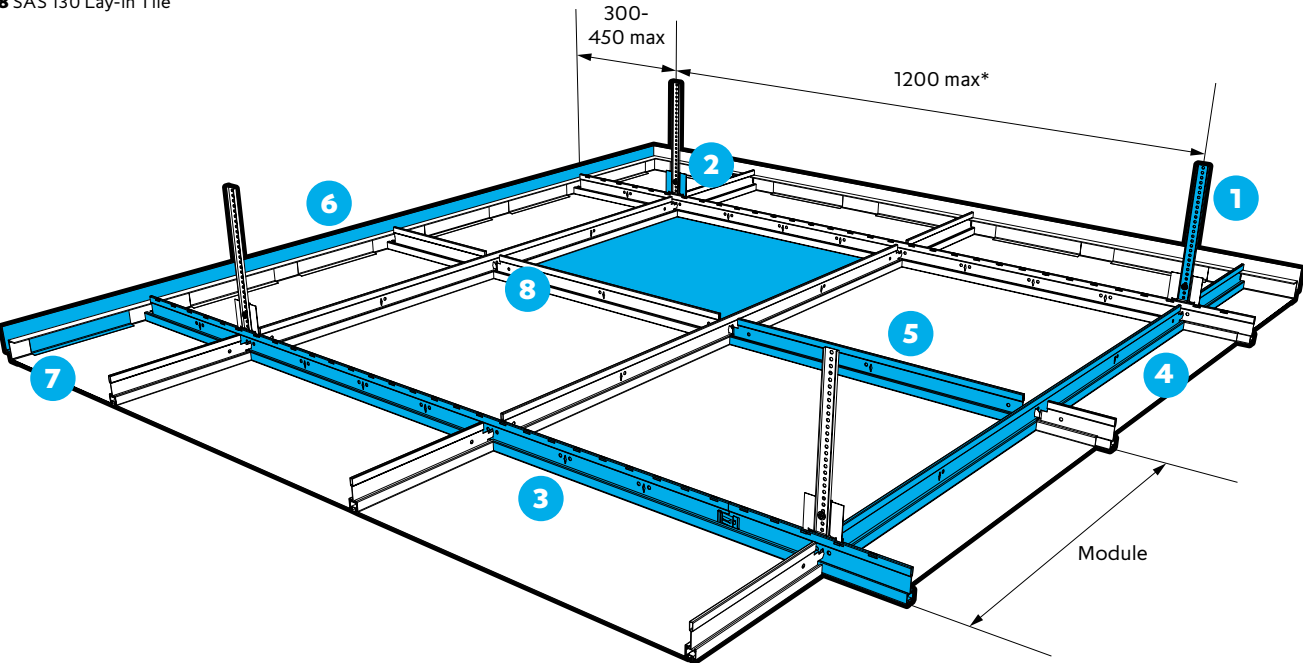

### Section and detail drawings

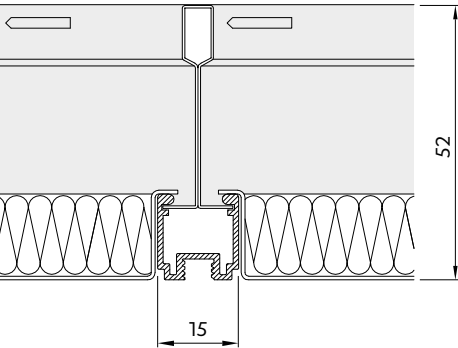
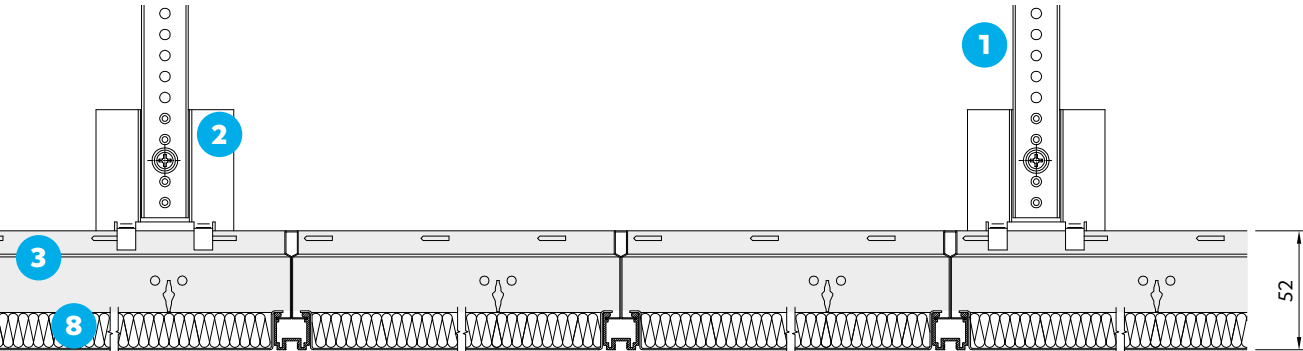

All dimensions are in mm.

# SAS130 | Grid options

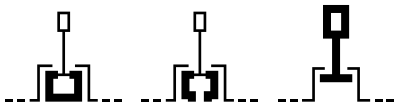

### SAS Alugrid-P 15/08

Module size mm	Tile size mm
500 x 500	484 x 484
600 x 600	584 x 584
750 x 750	734 x 734

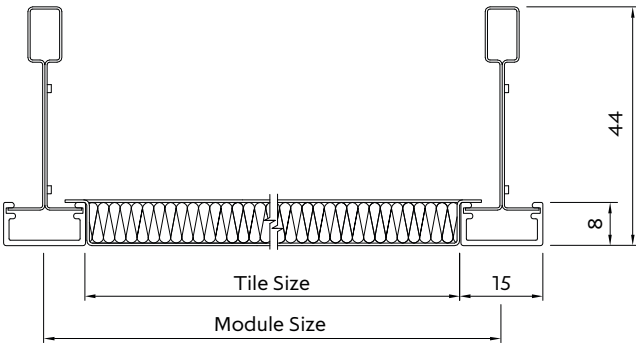

### SAS Alugrid-P 15/16

Module size mm	Tile size mm
500 x 500	484 x 484
600 x 600	584 x 584
750 x 750	734 x 734

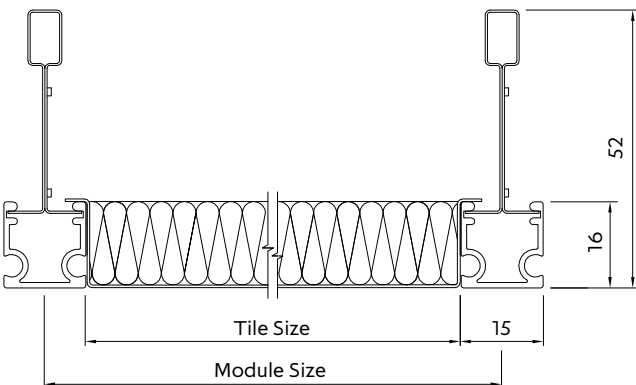

### SAS Alugrid-Q 15/08

Module size mm	Tile size mm
500 x 500	484 x 484
600 x 600	584 x 584
750 x 750	734 x 734

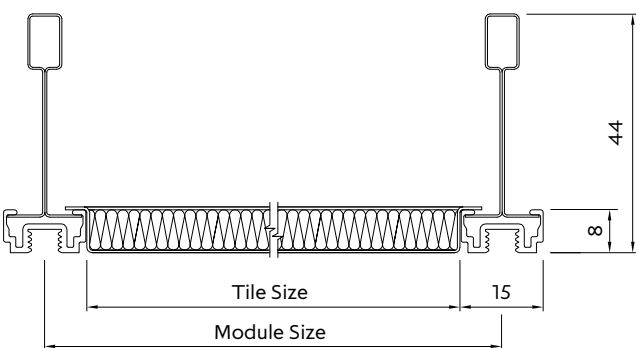

### SAS Alugrid-Q 15/16

Module size mm	Tile size mm
500 x 500	484 x 484
600 x 600	584 x 584
750 x 750	734 x 734

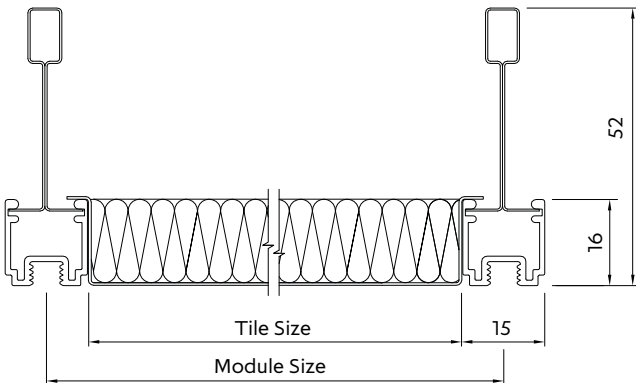

All dimensions are in mm.

# SAS130 | Grid options

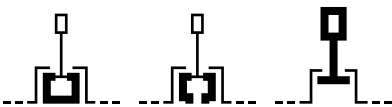

## SAS Alugrid-Q 15/19

Module size mm	Tile size mm
500 x 500	484 x 484
600 x 600	584 x 584
750 x 750	734 x 734

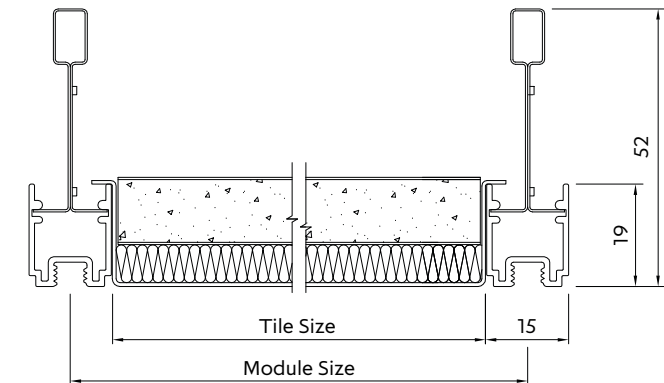

## SAS Alugrid-Q 25/16

Module size mm	Tile size mm
500 x 500	474 x 474
600 x 600	574 x 574
750 x 750	724 x 724

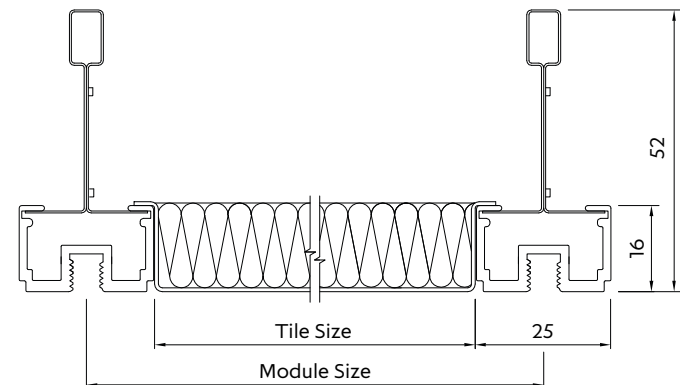

## SAS Alugrid-P Cleanseal

Module size mm	Tile size mm
500 x 500	484 x 484
600 x 600	584 x 584
750 x 750	734 x 734

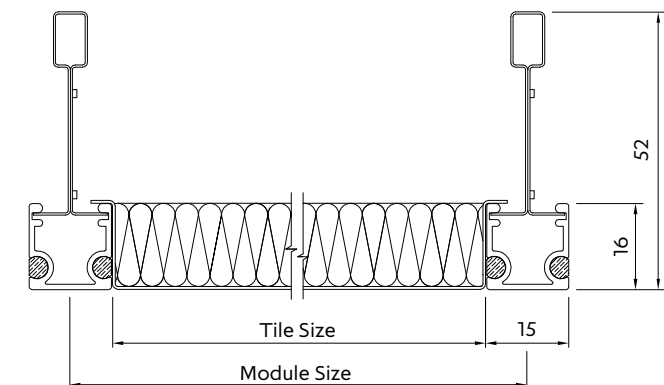

## SAS T15 Flushline

Module size mm	Tile size mm
600 x 600	594 x 594

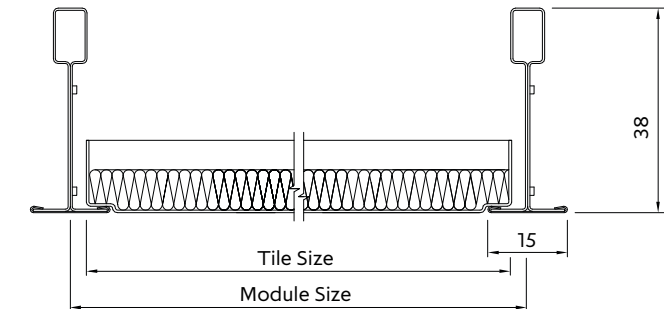

All dimensions are in mm.

# SAS130 | Grid options

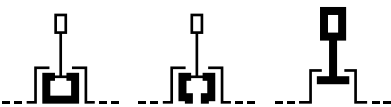

## SAS T24 Flushline

Module size mm	Tile size mm
600 x 600	594 x 594

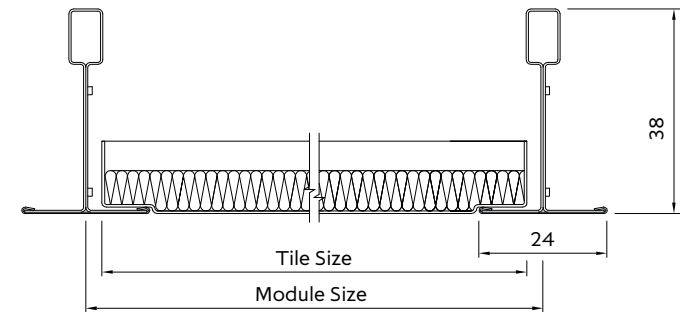

## SAS Square Edge

Module size mm	Tile size mm
500 x 500	494 x 494
600 x 600	594 x 594
750 x 750	744 x 744

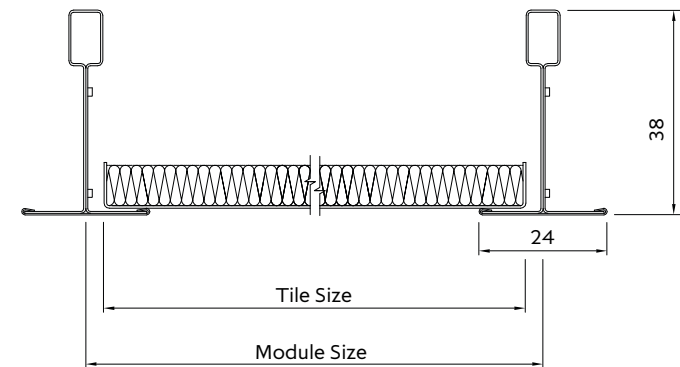

## SAS Tee Grid T15

Module size mm	Tile size mm
500 x 500	484 x 484
600 x 600	584 x 584
750 x 750	734 x 734

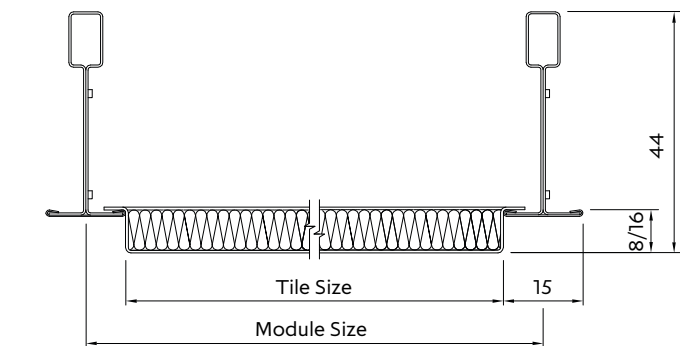

## SAS Tee Grid T24

Module size mm	Tile size mm
500 x 500	474 x 474
600 x 600	575 x 575
750 x 750	724 x 724

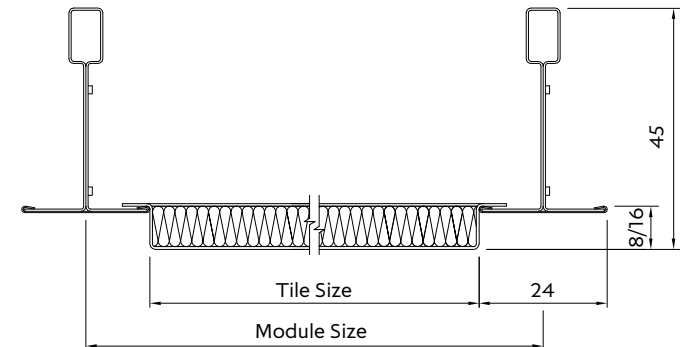

All dimensions are in mm.





SAS**130**

Slater Gordon, 58 Mosley Street

Location <b>Manchester</b> Architect <b>Harmsen Tilney          Shane</b>	Contractor <b>Eric Wright          Group Limited</b> Purpose <b>Commercial</b>
--	---



SAS**130**

World Pay, The Walbrook

Location <b>London, UK</b> Architect <b>Foster + Partners          &amp; Sidell Gibson</b>	Contractor <b>Skanska</b> Purpose <b>Commercial</b>
---	--





# MBS

Architectural

**INSPIRED BY QUALITY.  
DRIVEN BY INNOVATION.**

Architectural Ceiling & Wall Systems

Reach out to our team for support, samples and advice.  
[hello@mbsarchitectural.com.au](mailto:hello@mbsarchitectural.com.au) | [mbsarchitectural.com.au](http://mbsarchitectural.com.au)

**VIC**  
03 9580 7800  
7 Haymer Court  
Braeside 3195

**QLD**  
07 2116 0717  
13 Pease Court  
Bethania 4205