

Included Components & Fixings:

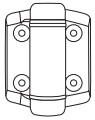

Nylon Hinge x2



Cover x4



Safety Cap x1



Scews x16



Tension Tool x1

⚠ Max load bearing weight 30kg

***Remove all existing hinges before installing your gate hinges.**

STEP 1 - INSTALL HINGES TO GATE FIRST

Nylon Hinge Cross Section

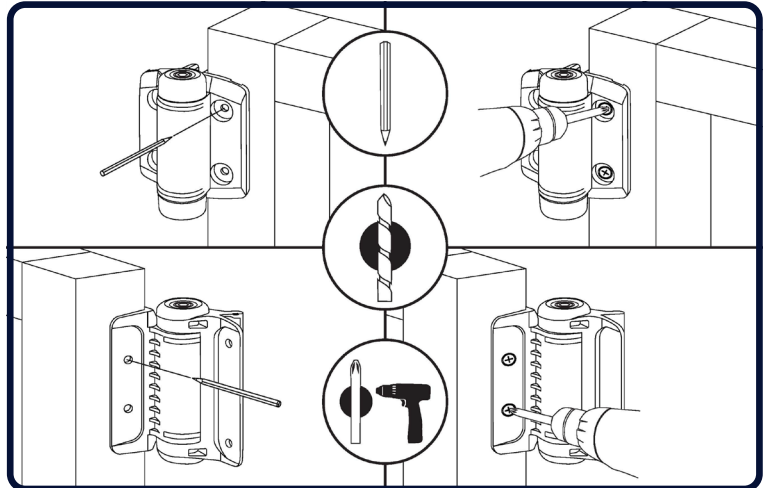
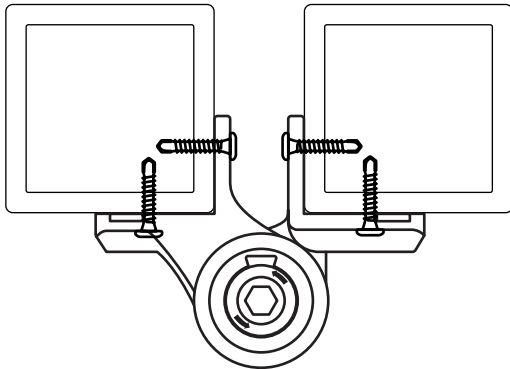

STEP 2 - INSTALL HINGES TO FENCE POST

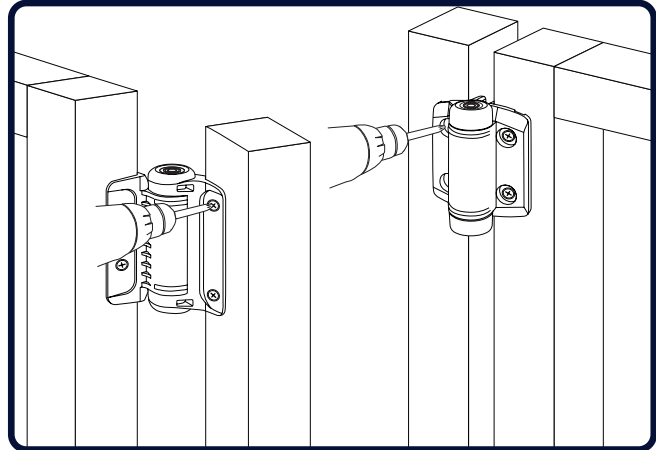
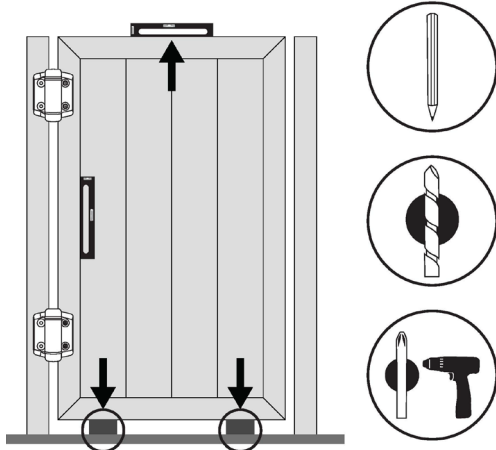

STEP 3 - INSTALL /REMOVE THE COVERS

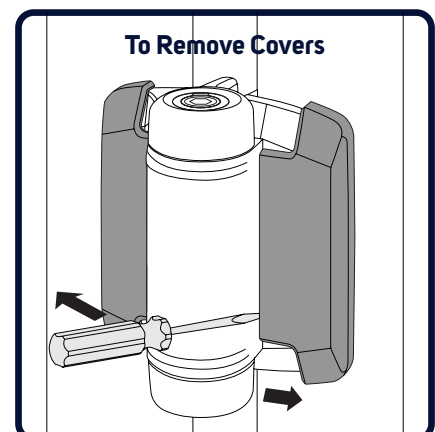
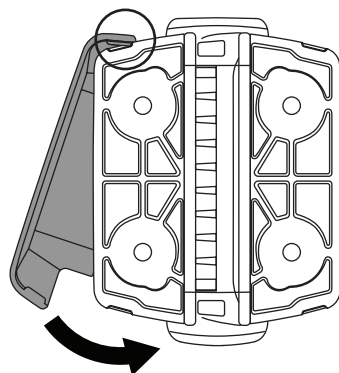
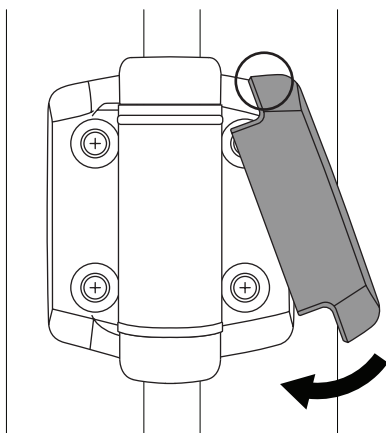

STEP 4 - ADJUST TENSION WITH GATE CLOSED

INCREASE HINGE TENSION

Insert the hex of the provided tension tool, and increase the tension by counterclockwise rotation.

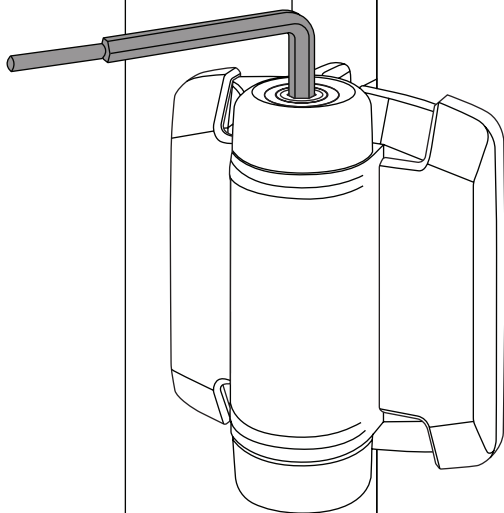

RELEASE HINGE TENSION

Insert another end of the provided tension tool, press to reset the rotation.

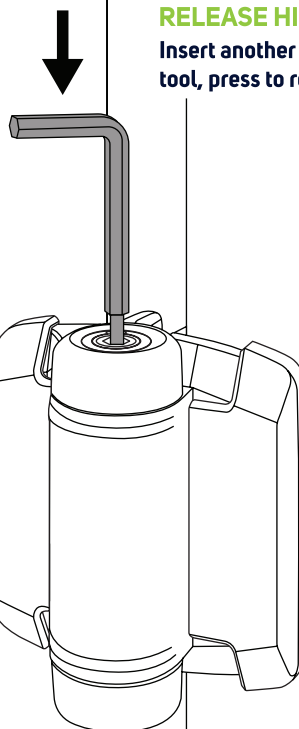

STEP 5 - ASSEMBLE SAFETY CAP

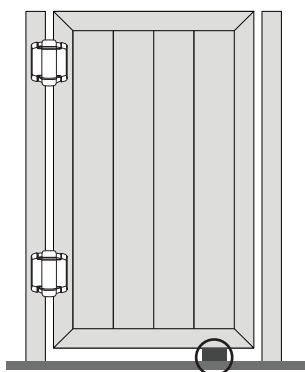

IMPORTANT TO NOTE
For gates over 14kg, support gate while adjusting tension.

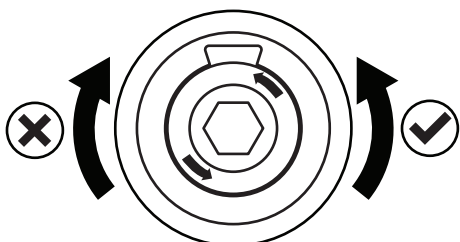

IMPORTANT TO NOTE
Adjust tension on each hinge from the top adjuster only.

ASSEMBLE SAFETY CAP

To prevent hinge being used as a foothold by toddlers, attach the optional safety cap to lower hinge.

