

05 BRIDGEVIEW SIGNATURE SUITE



2 BEDROOM / 2.5 BATH

This luxurious Residence with sweeping river, bridge, and mountain views features two bedrooms, two full baths, one half-bath, and private terrace.

VIEW: PREMIUM NORTHWEST

STANDOUT FEATURES

- Floor-to-ceiling windows with expansive views of the lush West Hills and Forest Park on one side and the sparkling Willamette River and spectacular Mount St. Helens on the other
- Modern kitchen with top-tier appliances
- Large entertaining island in kitchen
- Open-plan kitchen-living area opens onto a cozy glass-walled terrace
- Corner layout optimizes natural light throughout the entire Residence
- Spacious walk-in closet in primary bedroom
- Extended entry hallway creates showcase for artwork
- Hidden washer and dryer
- Includes one reserved, underground parking space

-  **COASTAL FINISH** (OPTION 1)
-  **MOUNTAIN FINISH** (OPTION 2)

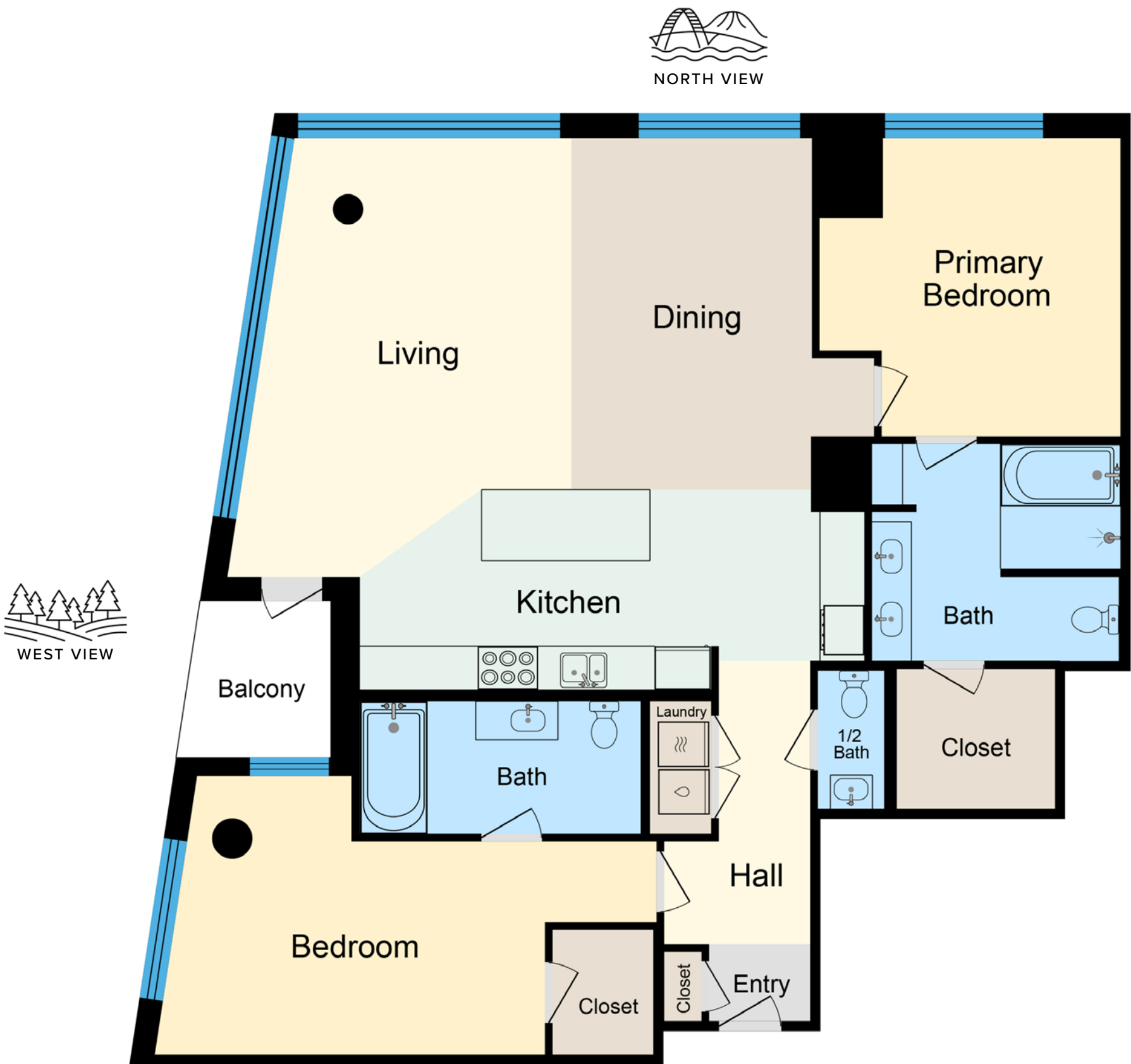
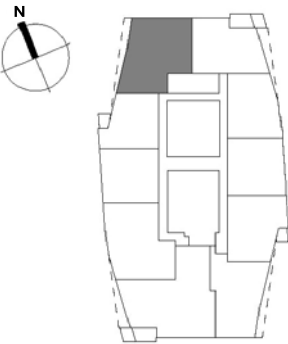

THE RITZ-CARLTON RESIDENCES, PORTLAND | 550 SW 10TH AVENUE | PORTLAND, OREGON 97205

Exact floor plan may vary. All information deemed reliable but not guaranteed. Square footage will differ from room dimensions due to wall thickness and shape. Only areas with color are included in square footage totals.