

# FOR SALE

24,851 SF & 26,418 SF  
INDUSTRIAL BUILDINGS



## FREESTANDING INDUSTRIAL BUILDINGS

3241 & 3243 BENCHMARK DR, LADSON, SC 29456

**Harbor**  
COMMERCIAL PARTNERS

# SITE PLAN

BENCHMARK INDUSTRIAL PARK, Ladson, SC 29456





# BUILDING B FLOOR PLAN

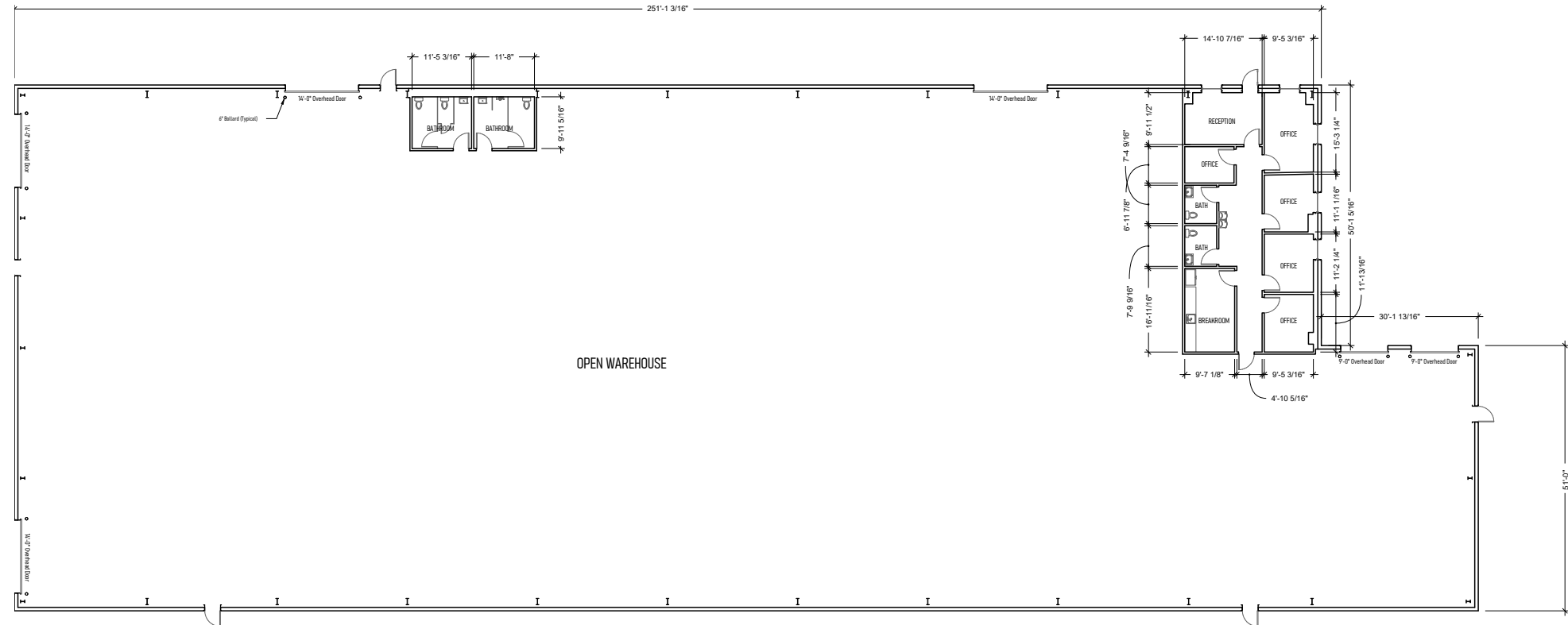

Building B - Floor Plan  
Scale: 1/8\"/>

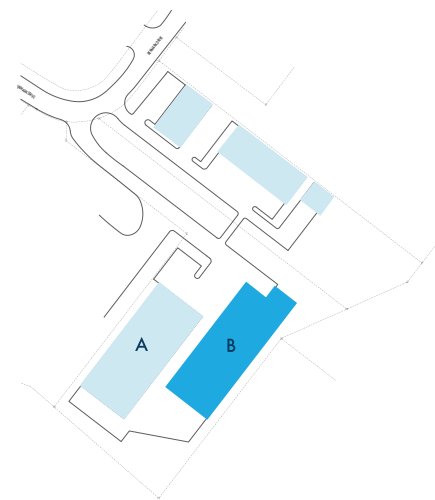

# BUILDING B SPECS

SIZE	26,418 SF
TMS	390-00-00-217
COUNTY	Charleston County
ZONING	Industrial
EXISTING OFFICE	1,619 SF
EAVE HEIGHT	21'
CENTER HEIGHT	26'
COLUMNS	None - Clear Span
CONSTRUCTION	Insulated Metal
DOCK HEIGHT DOORS	(2) 9' x 9'
DRIVE IN DOORS	(4) 14' x 16'
BUILDING DIMENSIONS	101' x 281'
AUTO PARKING SPACES	15+
TRAILER PARKING	20
POWER	Three Phase
LIGHTING	LED
SPRINKLERS	Wet System

# AVAILABILITY

AVAILABLE DATE	Now
LIST PRICE	\$5,025,000



### LOCATION MAP



### DIRECTIONAL MAP

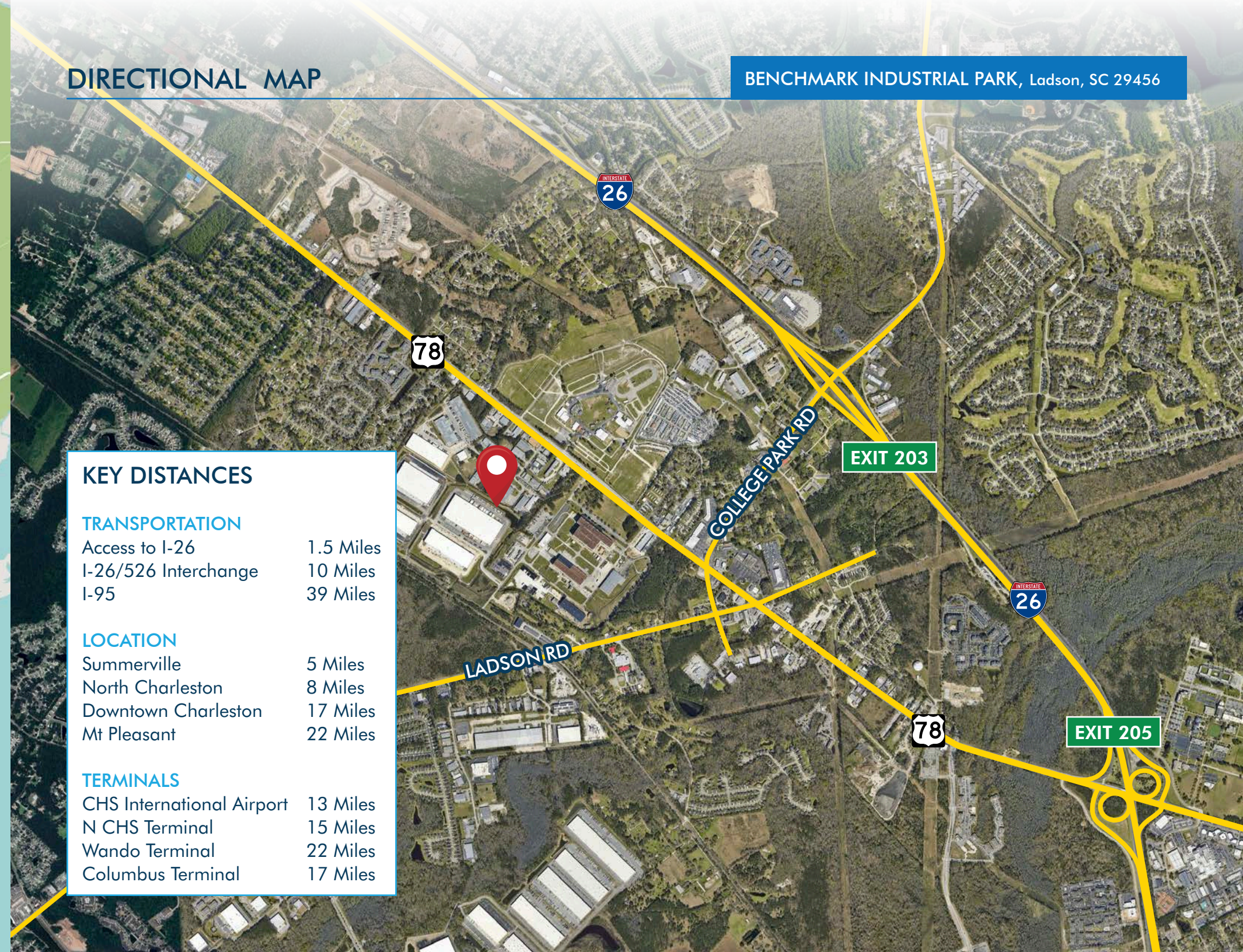

#### KEY DISTANCES

TRANSPORTATION	
Access to I-26	1.5 Miles
I-26/526 Interchange	10 Miles
I-95	39 Miles

LOCATION	
Summerville	5 Miles
North Charleston	8 Miles
Downtown Charleston	17 Miles
Mt Pleasant	22 Miles

TERMINALS	
CHS International Airport	13 Miles
N CHS Terminal	15 Miles
Wando Terminal	22 Miles
Columbus Terminal	17 Miles



## SALE CONTACTS:

**Tradd Varner, SIOR**

Partner

+1.843.532.1684

tradd.varner@

harborcommercialpartners.com

**Todd Garrett, CCIM, SIOR**

Managing Partner

+1.843.408.8846

todd.garrett@

harborcommercialpartners.com

**Crawford Riddle**

Associate

+1.864.423.4973

crawford.riddle@

harborcommercialpartners.com

 **Harbor**  
COMMERCIAL PARTNERS

harborcommercialpartners.com