

FOR LEASE

600 - 53,260 SF

WAREHOUSE/DISTRIBUTION



1930 HANAHAN RD, HANAHAN, SC 29406



1930 HANAHAN RD, HANAHAN, SC 29406

THE OFFERING

UNIT	SIZE	LEASE RATE	NNN	AVAILABLE DATE
1400B	53,260 SF	\$6.50 PSF NNN	\$2.50	Q1
1400E	0.75 AC & 600 SF Office	\$5,500/Month	\$2.50	Q1
1500	40,341 SF	\$7.75 PSF NNN	\$2.50	Q1



PROPERTY SPECS

TAX ID/APN	475-08-00-003
BUILDING TOTAL	258,542 SF
SPACE AVAILABLE	600 SF - 53,260 SF
LEASE RATE	\$6.50 - \$7.75 PSF NNN
NNN	\$2.50 PSF NNN
COUNTY	Charleston
MUNICIPALITY	City of Hanahan
YEAR BUILT	1975
ZONING	M1 - Light Industrial
PARKING	Surface

1930 HANAHAN RD, HANAHAN, SC 29406

UNIT 1400B SPECS

UNIT SIZE	53,260 SF
OFFICE SF	1,500 SF
WAREHOUSE SF	52,360 SF
LEASE RATE	\$6.50 PSF NNN
NNN	\$2.50 PSF NNN
CLEARANCE HEIGHT	14' - 22'
CENTER HEIGHT	22'
HEATING/COOLING	Office only
LIGHTING	LED
POWER	Three Phase/ 600 Amp/ 480V
DRIVE-IN DOORS	(1) 12'x14', (1) 14'x14'
DOCK HIGH DOORS	(1) 10'x10'
COLUMN SPACING	20'
VENTILATION	Yes
PARKING	6-8 Spaces
TRAILER PARKING	Yes
RESTROOMS	2

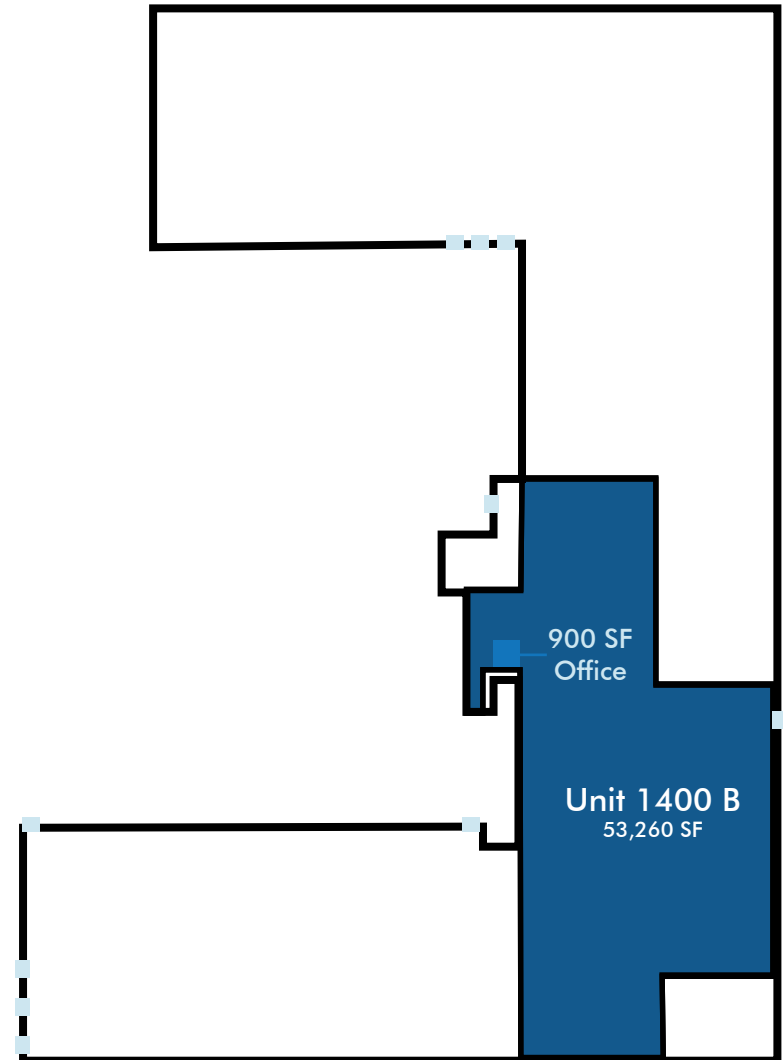

UNIT 1400B



1930 HANAHAN RD, HANAHAN, SC 29406



1930 HANAHAN RD, HANAHAN, SC 29406

UNIT 1400E SPECS

UNIT SIZE	600 SF
LAYDOWN YARD	0.75 AC
LEASE RATE	\$5,500/Month
NNN	\$2.50 PSF NNN
HEATING/COOLING	100%
TRAILER PARKING	20 Trailer Spaces

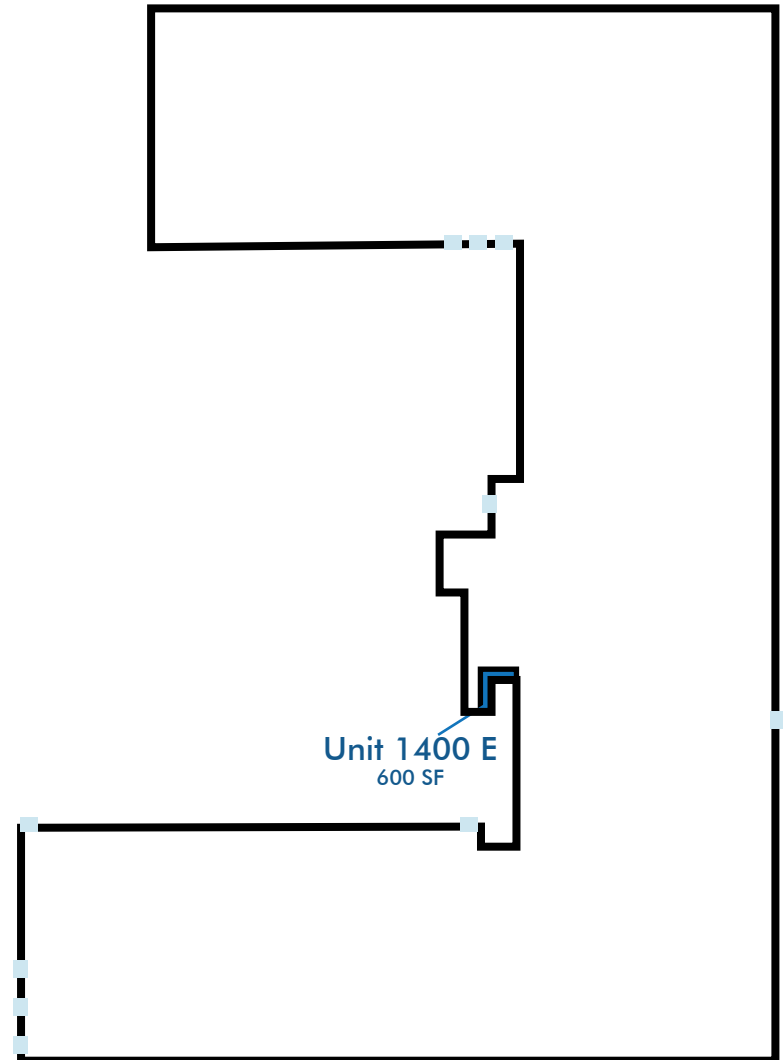

1930 HANAHAN RD, HANAHAN, SC 29406

UNIT 1500 SPECS

UNIT SIZE	40,341 SF
OFFICE SF	850 SF
WAREHOUSE SF	39,491 SF
LEASE RATE	\$7.75 PSF NNN
NNN	\$2.50 PSF NNN
CLEARANCE HEIGHT	20' - 26'
CENTER HEIGHT	26'
HEATING/COOLING	Office only
LIGHTING	Fluorescent
POWER	Three Phase/ 350 Amp
DRIVE-IN DOORS	(2) 8'x10', (1) 12'x12'
DOCK HIGH DOORS	(1) 14'x14'
EAVE HEIGHT	20'
VENTILATION	Yes
PARKING	10 Spaces
TRAILER PARKING	20
SKYLIGHTS	Yes

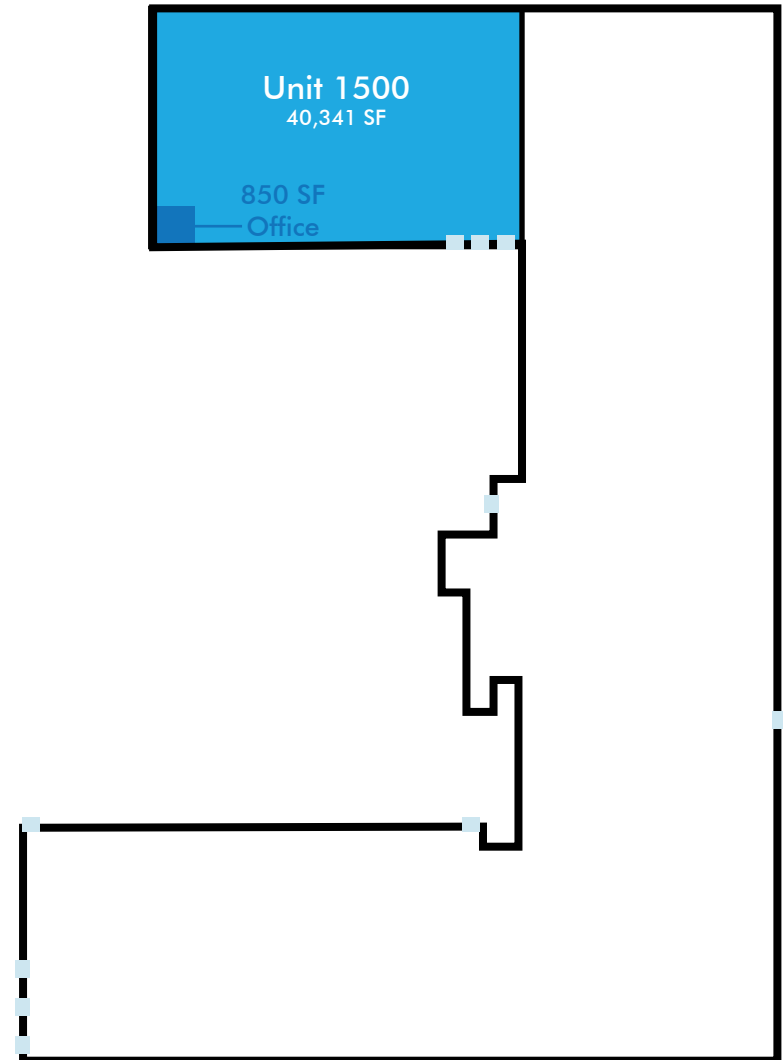

UNIT 1500



1930 HANAHAN RD, HANAHAN, SC 29406



1930 HANAHAN RD, HANAHAN, SC 29406

LOCATION MAP

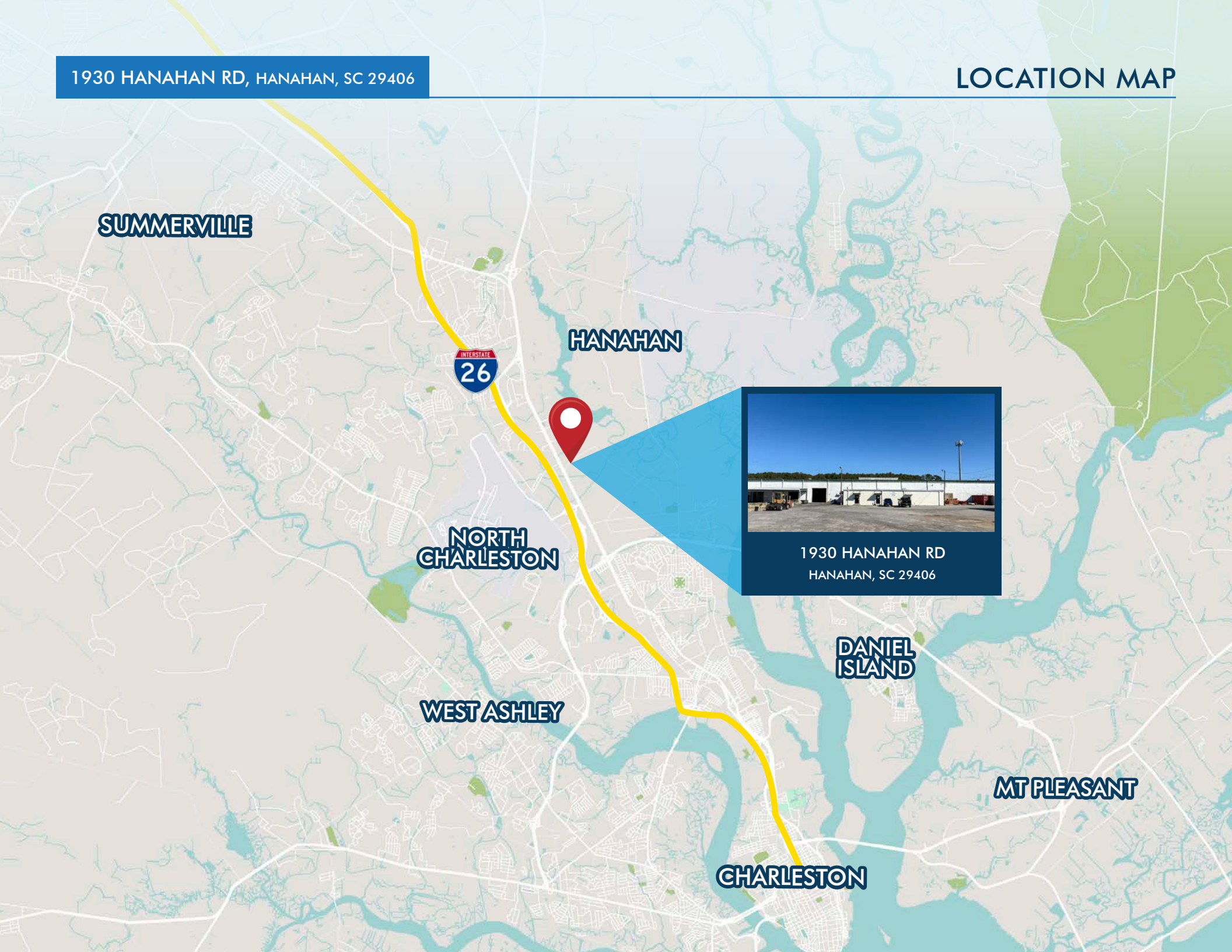

SUMMERVILLE

HANAHAN



NORTH CHARLESTON



1930 HANAHAN RD
HANAHAN, SC 29406

WEST ASHLEY

DANIEL ISLAND

MT PLEASANT

CHARLESTON



CONTACTS:

Tradd Varner, SIOR
Partner
+1.843.532.1684
tradd.varner@
harborcommercialpartners.com

Todd Garrett, CCIM, SIOR
Managing Partner
+1.843.408.8846
todd.garrett@
harborcommercialpartners.com

Crawford Riddle
Associate
+1.864.423.4973
crawford.riddle@
harborcommercialpartners.com

Harbor
COMMERCIAL PARTNERS

harborcommercialpartners.com