



**MIAMI-DADE COUNTY, FLORIDA
PRODUCT CONTROL SECTION**

11805 SW 26 Street, Room 208

Miami, Florida 33175-2474

T (786) 315-2590 F (786) 315-2599

**DEPARTMENT OF REGULATORY AND ECONOMIC RESOURCES (RER)
BOARD AND CODE ADMINISTRATION DIVISION**

NOTICE OF ACCEPTANCE (NOA)

www.miamidade.gov/building

Miami Wall Systems, Inc.

701 West 25 Street

Hialeah, FL 33010

SCOPE:

This NOA is being issued under the applicable rules and regulations governing the use of construction materials. The documentation submitted has been reviewed and accepted by Miami-Dade County RER - Product Control Section to be used in Miami Dade County and other areas where allowed by the Authority Having Jurisdiction (AHJ).

This NOA shall not be valid after the expiration date stated below. The Miami-Dade County Product Control Section (In Miami-Dade County) and/ or the AHJ (in areas other than Miami-Dade County) reserve the right to have this product or material tested for quality assurance purposes. If this product or material fails to perform in the accepted manner, the manufacturer will incur the expense of such testing and the AHJ may immediately revoke, modify, or suspend the use of such product or material within their jurisdiction. RER reserves the right to revoke this acceptance, if it is determined by Miami-Dade County Product Control Section that this product or material fails to meet the requirements of the applicable building code.

This product is approved as described herein and has been designed to comply with the Florida Building Code, including the High Velocity Hurricane Zone.

DESCRIPTION: Series "122" Aluminum Single Hung Window – L.M.I.

APPROVAL DOCUMENT: Drawing No. 122-SH-LM, titled "Single Hung Window 122 Series (LMI)", sheets 1 through 8 of 8, dated 9/4/08, with revision #2 dated 03/16/21, prepared by manufacturer, signed and sealed by Jorge E. Valdes, P.E., bearing the Miami-Dade County Product Control Revision stamp with the Notice of Acceptance number and expiration date by the Miami-Dade County Product Control Section.

MISSILE IMPACT RATING: Large and Small Missile Impact Resistant

LABELING: Each unit shall bear a permanent label with the manufacturer's name or logo, city, state, model/series, and following statement: "Miami-Dade County Product Control Approved", unless otherwise noted herein.

RENEWAL of this NOA shall be considered after a renewal application has been filed and there has been no change in the applicable building code negatively affecting the performance of this product.

TERMINATION of this NOA will occur after the expiration date or if there has been a revision or change in the materials, use, and/ or manufacture of the product or process. Misuse of this NOA as an endorsement of any product, for sales, advertising or any other purposes shall automatically terminate this NOA. Failure to comply with any section of this NOA shall be cause for termination and removal of NOA.

ADVERTISEMENT: The NOA number preceded by the words Miami-Dade County, Florida, and followed by the expiration date may be displayed in advertising literature. If any portion of the NOA is displayed, then it shall be done in its entirety.

INSPECTION: A copy of this entire NOA shall be provided to the user by the manufacturer or its distributors and shall be available for inspection at the job site at the request of the Building Official.

This NOA **revises NOA No. 19-0409.04** and consists of this page 1 and evidence pages E-1, E-2, E-3 and E-4, as well as approval document mentioned above.

The submitted documentation was reviewed by **Manuel Perez, P.E.**

8/31/21

NOA No. 21-0628.11

Expiration Date: August 15, 2024

Approval Date: September 09, 2021

Page 1

NOTICE OF ACCEPTANCE: EVIDENCE SUBMITTED

1. EVIDENCE SUBMITTED UNDER PREVIOUS NOA's

A. DRAWINGS

1. Manufacturer's die drawings and sections.
(Submitted under NOA No. 04-1122.06)
2. Drawing No. **122-SH-LM**, titled "Single Hung Window 122 Series (LMI)", sheets 1 through 7 of 7, dated 09/04/08, with revision #1 dated 05/20/19, prepared by manufacturer, signed and sealed by Jorge E. Valdes, P.E.
(Submitted under NOA No. 19-0409.04)

B. TESTS

1. Test report on: 1) Air Infiltration Test, per FBC, TAS 202-94
2) Uniform Static Air Pressure Test, Loading per FBC TAS 202-94
3) Water Resistance Test, per FBC, TAS 202-94
4) Large Missile Impact Test per FBC, TAS 201-94
5) Cyclic Wind Pressure Loading per FBC, TAS 203-94
6) Forced Entry Test, per FBC 2411.3.2.1, TAS 202-94
along with marked-up drawings and installation diagram of an aluminum single hung window, prepared by Fenestration Testing Laboratory, Inc., Test Report No. **FTL-3385**, dated May 03, 2002, signed and sealed by Luis Antonio Figueredo, P.E.
(Submitted under NOA No. 04-1122.06)
2. Test reports on: 1) Air Infiltration Test, per FBC, TAS 202-94
2) Uniform Static Air Pressure Test, Loading per FBC TAS 202-94
3) Water Resistance Test, per FBC, TAS 202-94
4) Large Missile Impact Test per FBC, TAS 201-94
5) Cyclic Wind Pressure Loading per FBC, TAS 203-94
6) Forced Entry Test, per FBC 2411.3.2.1, TAS 202-94
along with marked-up drawings and installation diagram of aluminum single hung mulled windows, prepared by Fenestration Testing Laboratory, Inc., Test Report No. **FTL-3386**, dated May 01, 2002, signed and sealed by Luis Antonio Figueredo, P.E.
(Submitted under NOA No. 04-1122.06)
3. Test reports on: 1) Air Infiltration Test, per FBC, TAS 202-94
2) Uniform Static Air Pressure Test, Loading per FBC TAS 202-94
3) Water Resistance Test, per FBC, TAS 202-94
4) Large Missile Impact Test per FBC, TAS 201-94
5) Cyclic Wind Pressure Loading per FBC, TAS 203-94
6) Forced Entry Test, per FBC 2411.3.2.1, TAS 202-94
along with marked-up drawings and installation diagram of an aluminum equal leg aluminum fixed frame window, prepared by Fenestration Testing Laboratory, Inc., Test Report No. **FTL-4091**, dated February 20, 2004, signed and sealed by Edmundo Largaespada, P.E. *(For Reference only)*
(Submitted under NOA No. 04-1122.06)

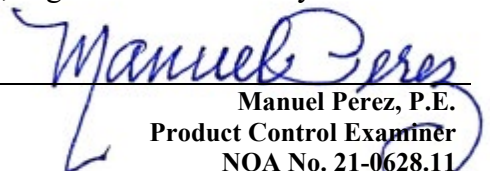
Manuel Perez, P.E.
Product Control Examiner
NOA No. 21-0628.11
Expiration Date: August 15, 2024
Approval Date: September 09, 2021

NOTICE OF ACCEPTANCE: EVIDENCE SUBMITTED

1. EVIDENCE SUBMITTED UNDER PREVIOUS NOA's (CONTINUED)

B. TESTS (CONTINUED)

4. Test reports on: 1) Air Infiltration Test, per FBC, TAS 202-94
2) Uniform Static Air Pressure Test, Loading per FBC TAS 202-94
3) Water Resistance Test, per FBC, TAS 202-94
4) Large Missile Impact Test per FBC, TAS 201-94
5) Cyclic Wind Pressure Loading per FBC, TAS 203-94
6) Forced Entry Test, per FBC 2411 3.2.1, TAS 202-94

along with marked-up drawings and installation diagram of an aluminum equal leg fixed frame windows mulled together, prepared by Fenestration Testing Laboratory, Inc., Test Report No. **FTL-5595**, dated 06/06/08, signed and sealed by Carlos Rionda, P.E.

(For Reference only)

(Submitted under NOA No. 08-0512.15)

C. CALCULATIONS

1. Anchor verification calculations and structural analysis, complying with **FBC 6th Edition (2017)**, dated 05/20/19 and 06/28/19, prepared by Miami Wall Systems, Inc., signed and sealed by Jorge E. Valdes, P.E.
(Submitted under NOA No. 19-0409.04)
2. Glazing complies with **ASTM E1300-09**

D. QUALITY ASSURANCE

1. Miami-Dade Department of Regulatory and Economic Resources (RER)

E. MATERIAL CERTIFICATIONS

1. Notice of Acceptance No. **19-0305.02** issued to **Kuraray America, Inc.** for their "Trosifol® Ultraclear, Clear and Color PVB Glass Interlayers" dated 05/09/19, expiring on 07/08/24.
2. Notice of Acceptance No. **17-0808.02** issued to **Kuraray America, Inc.** for their "SentryGlas® (Clear and White) Glass Interlayers" dated 12/28/17, expiring on 07/04/23.

F. STATEMENTS

1. Statement letter of conformance, complying with **FBC 6th Edition (2017)**, and of no financial interest, dated 03/29/19, issued by Miami Wall Systems, Inc., signed and sealed by Jorge E. Valdes, P.E.
(Submitted under NOA No. 19-0409.04)

G. OTHERS

1. Notice of Acceptance No. **12-0816.07**, issued to Miami Wall Systems, Inc. for their Series "122" Aluminum Single Hung Window - L.M.I., approved on 09/27/12 and expiring on 08/29/13.

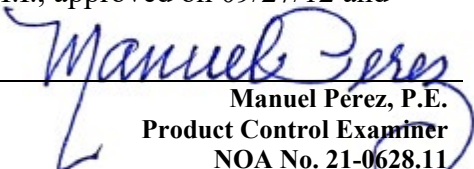
Manuel Perez, P.E.
Product Control Examiner
NOA No. 21-0628.11
Expiration Date: August 15, 2024
Approval Date: September 09, 2021

NOTICE OF ACCEPTANCE: EVIDENCE SUBMITTED

2. NEW EVIDENCE SUBMITTED

A. DRAWINGS

1. Drawing No. **122-SH-LM**, titled “Single Hung Window 122 Series (LMI)”, sheets 1 through 8 of 8, dated 09/04/08, with revision #2 dated 03/16/21, prepared by manufacturer, signed and sealed by Jorge E. Valdes, P.E.

B. TESTS

1. Test report on: 1) Air Infiltration Test, per FBC, TAS 202-94
2) Uniform Static Air Pressure Test, Loading per FBC TAS 202-94
3) Water Resistance Test, per FBC, TAS 202-94
4) Large Missile Impact Test per FBC, TAS 201-94
5) Cyclic Wind Pressure Loading per FBC, TAS 203-94
6) Forced Entry Test, per FBC 2411 3.2.1, TAS 202-94
along with marked-up drawings and installation diagram of a series 122 single hung muller to fixed window, prepared by Fenestration Testing Laboratory, Inc., Test Report No. **FTL-12615**, dated June 16, 2021, signed and sealed by Idalmis Ortega, P.E.

C. CALCULATIONS

1. Anchor verification calculations and structural analysis, complying with **FBC 7^h Edition (2020)**, dated 08/19/21, prepared by Miami Wall Systems, Inc., signed and sealed by Jorge E. Valdes, P.E.
2. Glazing complies with **ASTM E1300-16**

D. QUALITY ASSURANCE

1. Miami-Dade Department of Regulatory and Economic Resources (RER)

E. MATERIAL CERTIFICATIONS

1. Notice of Acceptance No. **20-0915.22** issued to **Kuraray America, Inc.** for their “**Trosifol® Ultraclear, Clear and Color PVB Glass Interlayers**” dated 11/19/20, expiring on 07/08/24.
2. Notice of Acceptance No. **20-0915.19** issued to **Kuraray America, Inc.** for their “**SentryGlas® (Clear and White) Glass Interlayers**” dated 11/19/20, expiring on 07/04/23.

Manuel Perez, P.E.
Product Control Examiner
NOA No. 21-0628.11
Expiration Date: August 15, 2024
Approval Date: September 09, 2021

Miami Wall Systems, Inc.

NOTICE OF ACCEPTANCE: EVIDENCE SUBMITTED

2. NEW EVIDENCE SUBMITTED (CONTINUED)

F. STATEMENTS

1. Statement letters of conformance, complying with **FBC 7th Edition (2020)**, dated August 17, 2021, prepared by manufacturer, signed and sealed by Jorge E. Valdes, P.E.
2. Statement letters of no financial interest, dated August 17, 2021, prepared by manufacturer, signed and sealed by Jorge E. Valdes, P.E.
3. Proposal No. **21-0333** issued by the Product Control Section, dated April 30, 2021, signed by Manuel Perez, P.E.

G. OTHERS

1. Notice of Acceptance No. **19-0409.04**, issued to Miami Wall Systems, Inc. for their Series "122" Aluminum Single Hung Window - L.M.I., approved on 08/15/19 and expiring on 08/15/24.

Manuel Perez, P.E.
Product Control Examiner
NOA No. 21-0628.11
Expiration Date: August 15, 2024
Approval Date: September 09, 2021

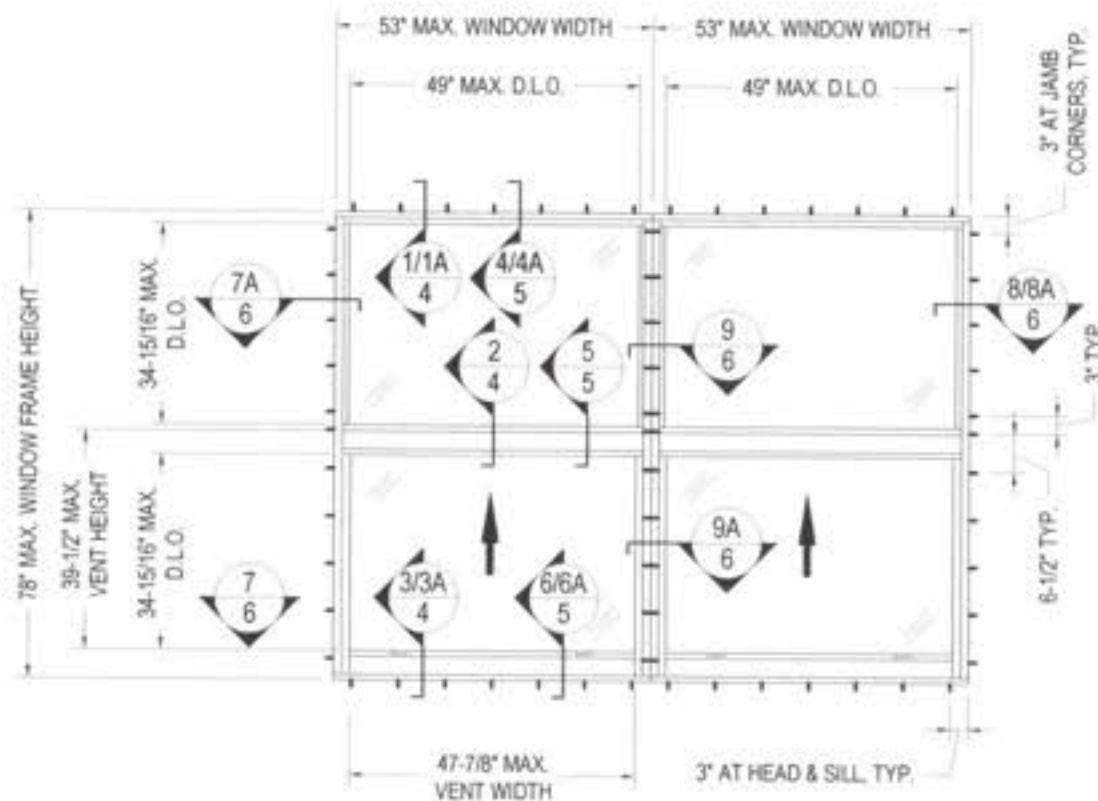

THESE WINDOWS ARE RATED LARGE AND SMALL MISSILE IMPACT.
SHUTTERS ARE NOT REQUIRED

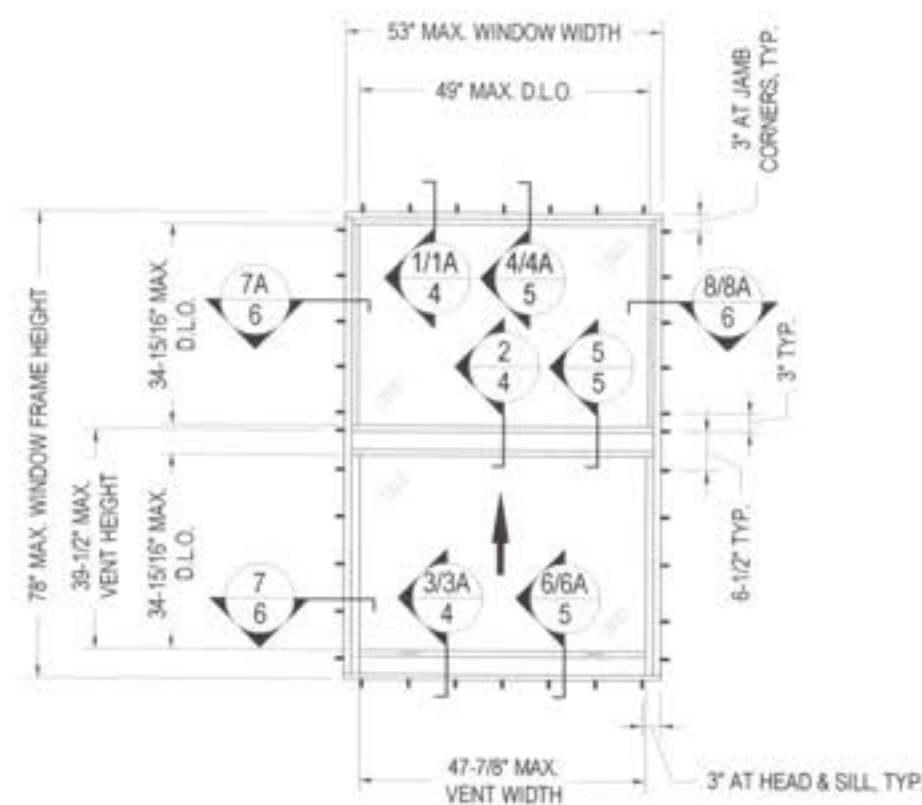

SERIES 122 ALUMINUM SINGLE HUNG WINDOWS

GENERAL NOTES

1. THIS PRODUCT HAS BEEN DESIGNED AND TESTED IN ACCORDANCE WITH THE 2020 FLORIDA BUILDING CODE 7TH EDITION (HIGH VELOCITY HURRICANE ZONE)
2. WOOD BUCKS MUST BE ENGINEERED TO TAKE THE WIND LOADS IMPOSED BY WINDOWS AND TO BE REVIEWED BY BUILDING OFFICIAL.
3. ALL INSTALLATION FASTENERS HOLES MUST BE IN-FACTORY PUNCHED FOR 1/4" DIAMETER FLAT HEAD SCREWS.
4. EQUAL AND UNEQUAL LEG FRAME CONDITIONS INCLUDED.
5. LOCK OPTIONS INCLUDE CAM LOCKS OR SPRING LOCKS OR BOTH.
6. UN-CLIPPED VERTICAL MULLION APPLICATION SHALL BE LIMITED TO APPROVED WINDOW DIMENSIONS, SEE MULLION LOAD CAPACITY CHART 2, SHEET 3 OF 8.
7. USE CLUSTER OF FASTENERS AT SILL AND HEAD WHERE UN-CLIPPED VERTICAL MULLIONS OCCUR ONLY (SEE DETAIL "A", SHEET 3 OF 8)

INSTRUCTIONS:

- STEP 1 - DETERMINE DESIGN WIND LOAD REQUIREMENT BASED ON WIND VELOCITY, BUILDING HEIGHT, WIND ZONE USING APPLICABLE **ASCE 7** STANDARD.
- STEP 2 - SEE CHART 1 ON SHEET 2 FOR DESIGN LOAD CAPACITY OF DESIRED GLASS SIZE.
- STEP 3 - IF WINDOWS ARE TO BE MULLED TOGETHER, CHECK MILLION CAPACITY FOR A GIVEN SPACING AND HEIGHT USING CHART 2 ON SHEET 3 OF 8. THE CAPACITY SHOULD EXCEED THE DESIGN LOAD.
- STEP 4 - THE LOWEST VALUE RESULTING FROM STEP 2 AND 3 SHALL APPLY TO ENTIRE SYSTEM.

DESIGN PRESSURE	± 75 PSF	± 90 PSF	± 120 PSF
HEAD / SILL	15-3/4"	11-3/4"	9-1/4"
JAMBS	17-3/8"	9"	7-1/4"



PRODUCT REVISED
as complying with the Florida
Building Code
NOA-No. 21-0628.11
Expiration Date: 08/15/2024
By: Manuel Perez
Miami-Dade Product Control

Miami Wall Systems, Inc.



701 West 25th Street
Hialeah, Florida 33010

Phone (305) 888-2300 Fax (305) 888-3058

SINGLE HUNG WINDOW 122 SERIES (LMI)

TYPICAL ELEVATIONS
GENERAL NOTES

NO.	DATE	REVISION
1	5/20/2019	UPDATE TO 2017 FBC
2	3/16/2021	UPDATE TO 2020 FBC

DATE: 9/4/2008

SCALE: 3/8" = 1'-0"

DWG. BY: L.B.A.

CHK. BY: JV

DWG NO.: 122-SH-LM

SHEET 1 OF 8

CHART 1

GLASS DESIGN LOAD CAPACITY - PSF							
WINDOW DIMENSION		GLASS TYPE GL-1		GLASS TYPE GL-2		GLASS TYPE GL-3	
WIDTH (W)	HEIGHT (H)	EXTERIOR (+)	INTERIOR (-)	EXTERIOR (+)	INTERIOR (-)	EXTERIOR (+)	INTERIOR (-)
40	64	90	90	120	120	75	75
44		90	90	120	120	75	75
48		90	90	120	120	-	-
53		90	90	120	120	-	-
40	68	90	90	120	120	75	75
44		90	90	120	120	-	-
48		90	90	120	120	-	-
52		90	90	120	120	-	-
36	72	90	90	120	120	75	75
40		90	90	120	120	-	-
44		90	90	120	120	-	-
48		90	90	120	120	-	-
53	76	90	90	120	120	-	-
36		90	90	120	120	75	75
40		90	90	120	120	-	-
44		90	90	120	120	-	-
48	78	90	90	120	120	-	-
36		90	90	120	120	75	75
40		90	90	120	120	-	-
44		90	90	120	120	-	-
48	80	90	90	120	120	-	-
36		90	90	120	120	75	75
40		90	90	120	120	-	-
44		90	90	120	120	-	-

NOTE:
STANDARD SILL AND STANDARD MEETING RAIL OPTIONS ARE LIMITED TO ± 90 PSF
(SEE SHEET 4 OF 8 AND 5 OF 8)

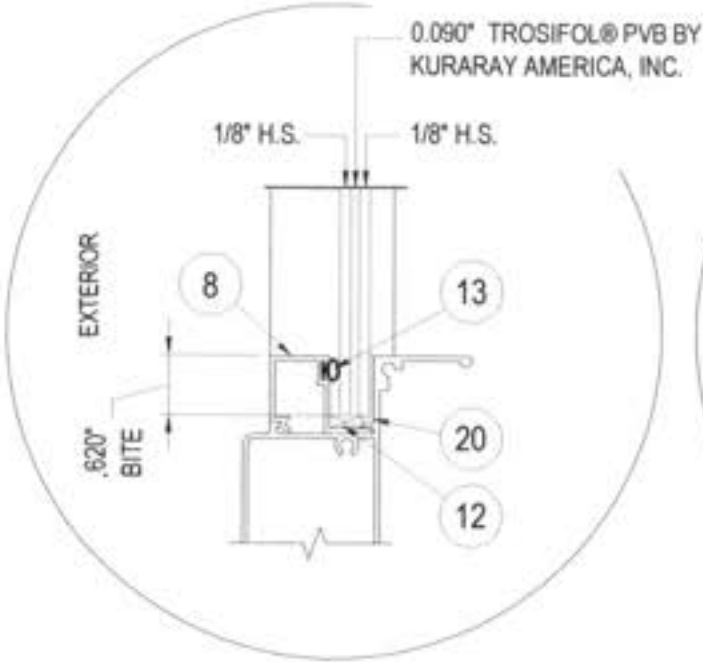

GLASS TYPE GL-1
5/16" OVERALL THICKNESS LAMINATED GLASS

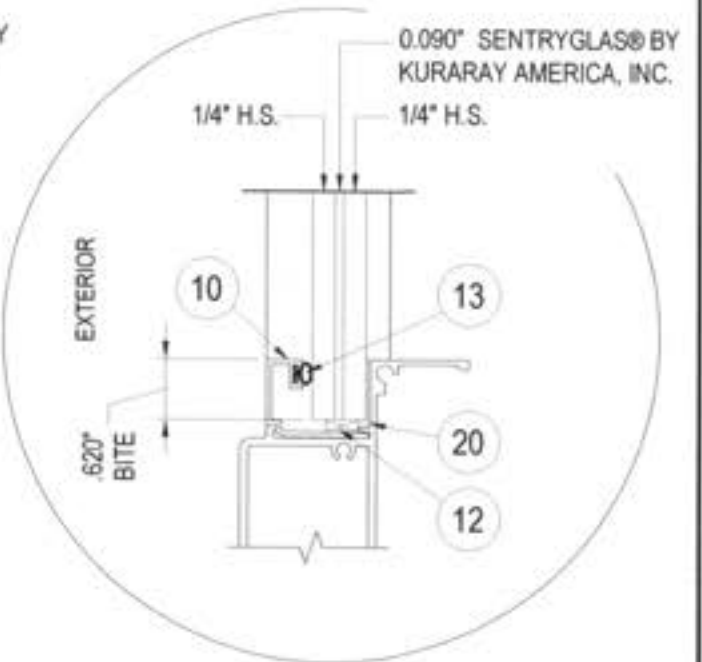

GLASS TYPE GL-2
9/16" OVERALL THICKNESS LAMINATED GLASS

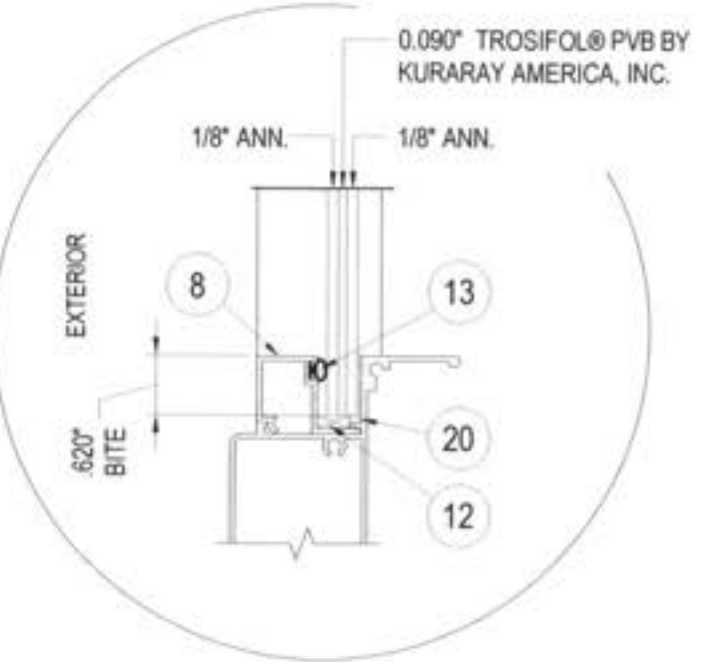

GLASS TYPE GL-3
5/16" OVERALL THICKNESS LAMINATED GLASS

GLASS OPTIONS
SCALE 1:2

PRODUCT REVISED
as complying with the Florida
Building Code
NOA-No. **21-0628.11**
Expiration Date: **08/15/2024**
By: *Manuel Perez*
Miami-Dade Product Control



Miami Wall Systems, Inc.
701 West 25th Street
Hialeah, Florida 33010
Phone (305) 888-2300 Fax (305) 888-3058

SINGLE HUNG WINDOW 122 SERIES (LMI)

GLASS DESIGN LOAD CHART
GLASS OPTIONS

NO.	DATE	REVISION
1	5/20/2018	UPDATE TO 2017 FBC
2	3/13/2021	UPDATE TO 2020 FBC

DATE: 9/4/2008
SCALE: AS NOTED
DWG. BY: L.R.A.
CHK. BY: JV
DWG. NO.: 122-SH-ELA
SHEET 2 OF 8

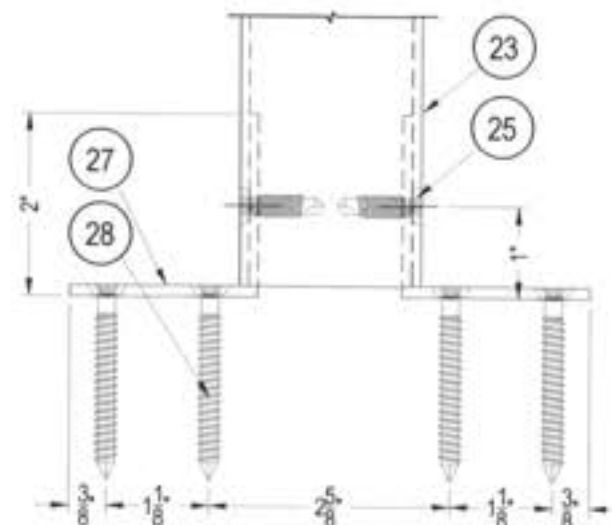
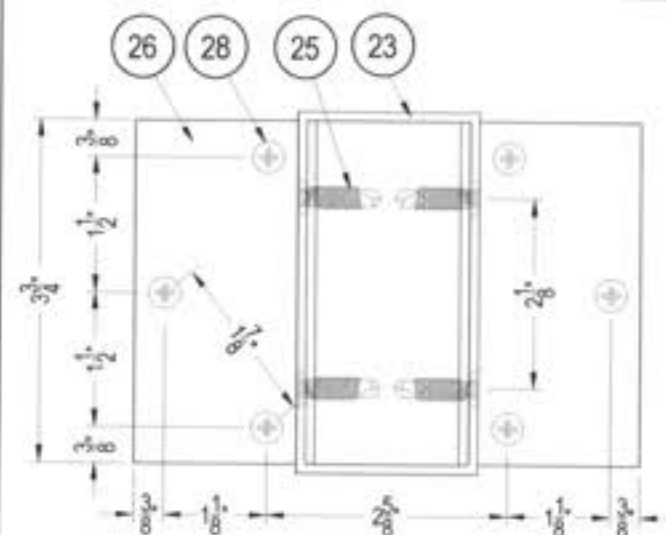

MULLION TYPE 3
(2 x 4 x 1/8" THK.)

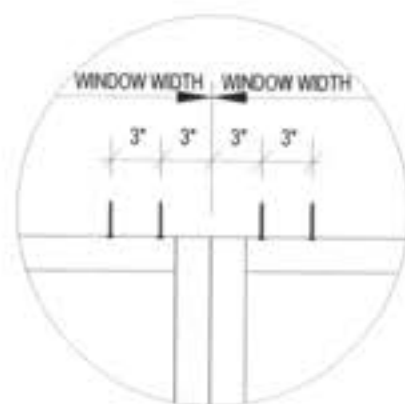

DETAIL "A"
TYPICAL CLUSTER OF ANCHORS
AT INTERLOCKS TOP & BOTTOM
(ONLY AT UNCLIPPED MULLION CONDITIONS)

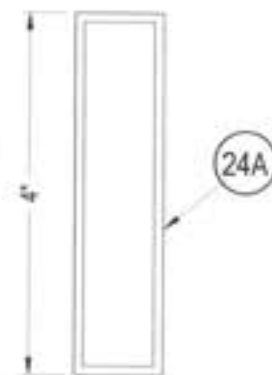

MULLION TYPE 2
(1 x 4 x 1/8" THK.) UNCLIPPED

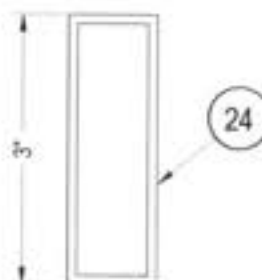

MULLION TYPE 1
(1 x 3 x 1/8" THK.) UNCLIPPED

CHART 2

MULLION DESIGN LOAD CAPACITY - PSF							
WINDOW DIMENSION		MULLION TYPE 1 (1 x 3 x 1/8")		MULLION TYPE 2 (1 x 4 x 1/8")		MULLION TYPE 3 (2 x 4 x 1/8")	
WIDTH (W)	MULLION SPAN (H)	EXTERIOR (+)	INTERIOR (-)	EXTERIOR (+)	INTERIOR (-)	EXTERIOR (+)	INTERIOR (-)
40	64	120	120	120	120	120	120
44		120	120	120	120	120	120
48		114	114	114	114	120	120
53		110	110	110	110	120	120
38	68	106	106	106	106	120	120
42		100	100	100	100	120	120
46		94	94	94	94	120	120
50		91	91	91	91	120	120
53	72	88	88	90	90	120	120
38		89	89	90	90	120	120
42		82	82	90	90	120	120
46		78	78	90	90	120	120
50	76	74	74	90	90	120	120
53		71	71	90	90	120	120
36		78	78	90	90	-	-
40		71	71	90	90	-	-
44	78	66	66	90	90	-	-
48		62	62	90	90	-	-
36		71	71	90	90	-	-
40		65	65	90	90	-	-
44	78	60	60	90	90	-	-
48		57	57	90	90	-	-

NOTES:

MULLIONS RATED IN THIS CHART MAY BE ORIENTED VERTICALLY OR HORIZONTALLY.
INTERPOLATION BETWEEN WIDTHS ALLOWED.

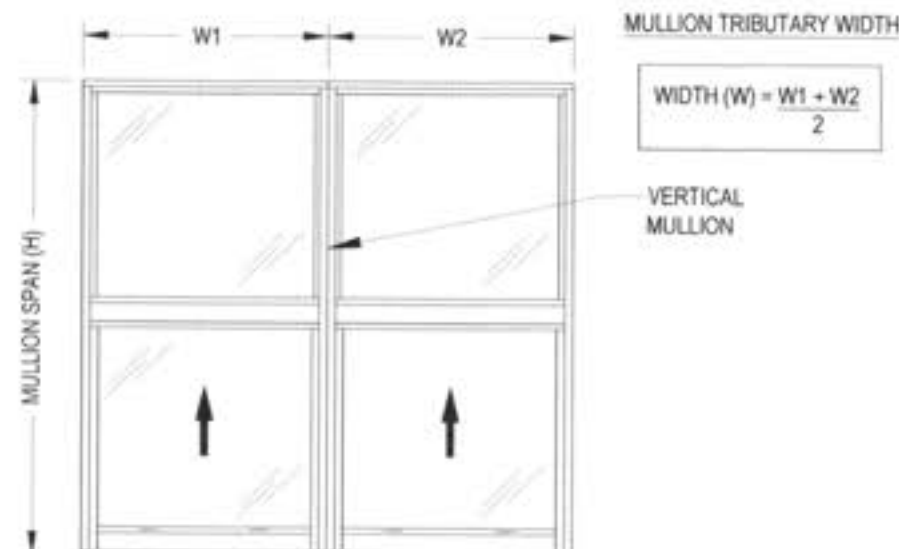

PRODUCT REVISED
as complying with the Florida
Building Code
NOA-No. **21-0628.11**
Expiration Date: **08/15/2024**
By: *Manuel Perez*
Miami-Dade Product Control



NO.	DATE	REVISION
1	9/20/2019	UPDATE TO 2017 FBC
2	3/13/2021	UPDATE TO 2020 FBC
3	9/4/2024	DATE: 9/4/2024
4		SCALE: 1-2
5		DRG. BY: LRA
6		CHK. BY: JV
7		DRG. NO.: 122-SH-LM
8		SHEET 3 OF 8

Miami Wall Systems, Inc.



SINGLE HUNG WINDOW 122 SERIES (LMI)
MULLION DETAILS
MULLION DESIGN LOAD CHART

701 West 25th Street
Hialeah, Florida, 33010

Phone (305) 888-2300 Fax (305) 888-3058

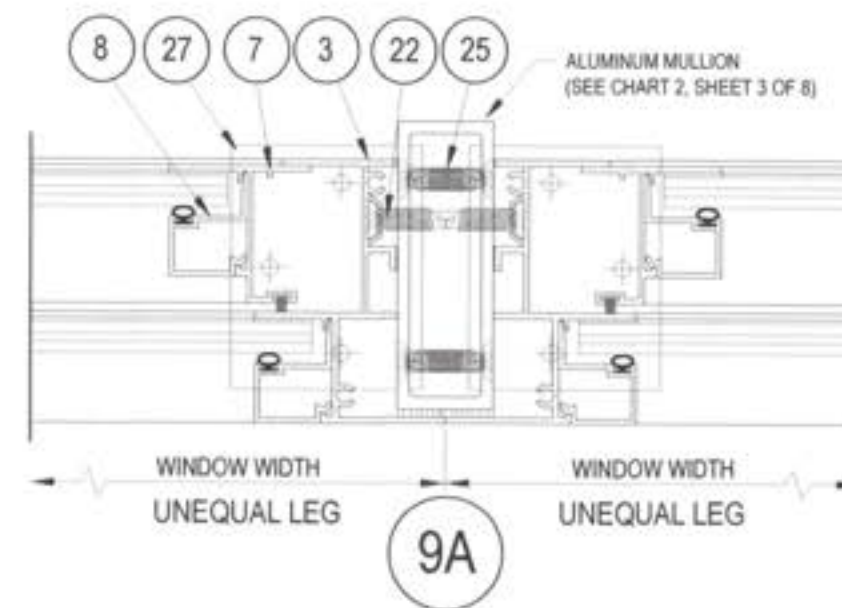
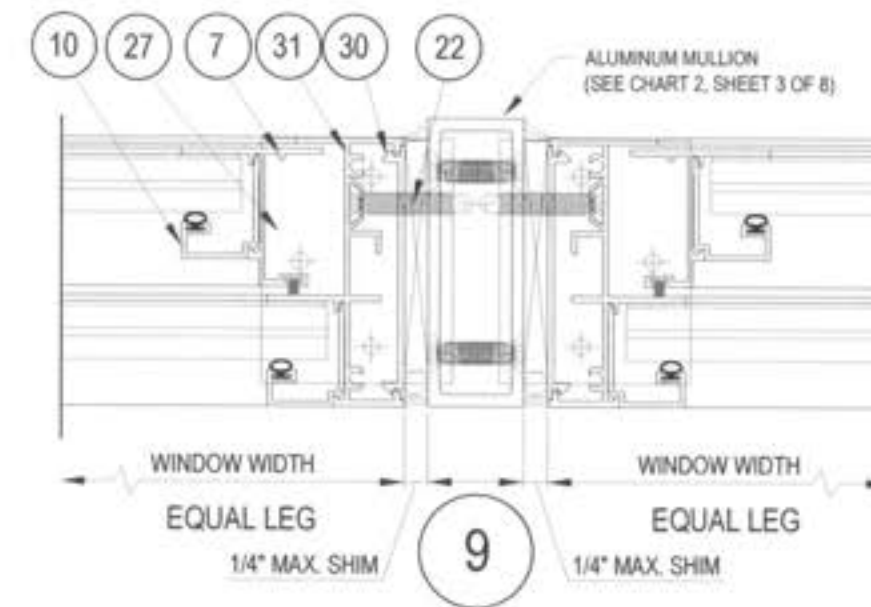
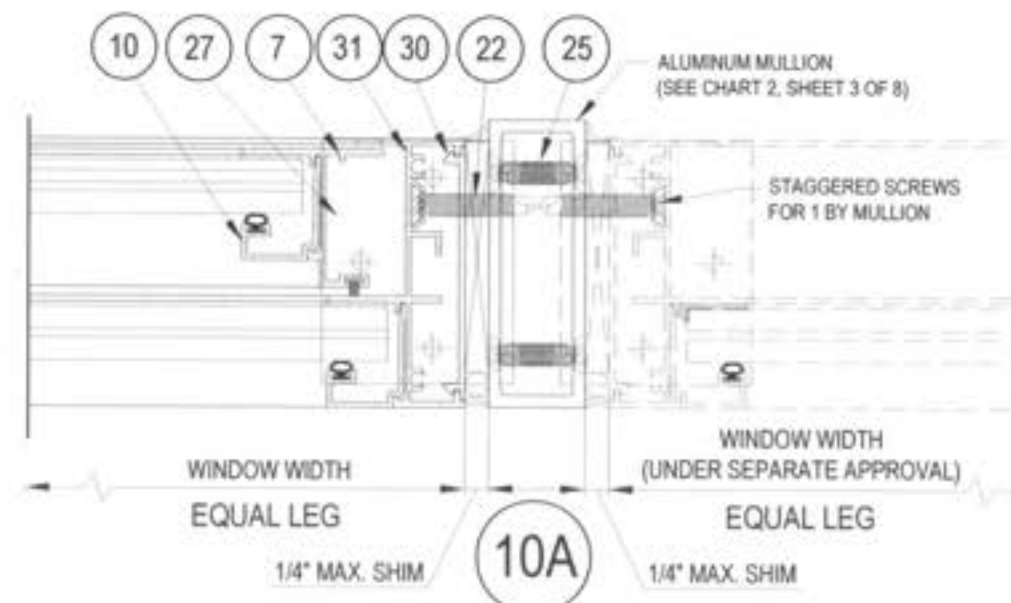
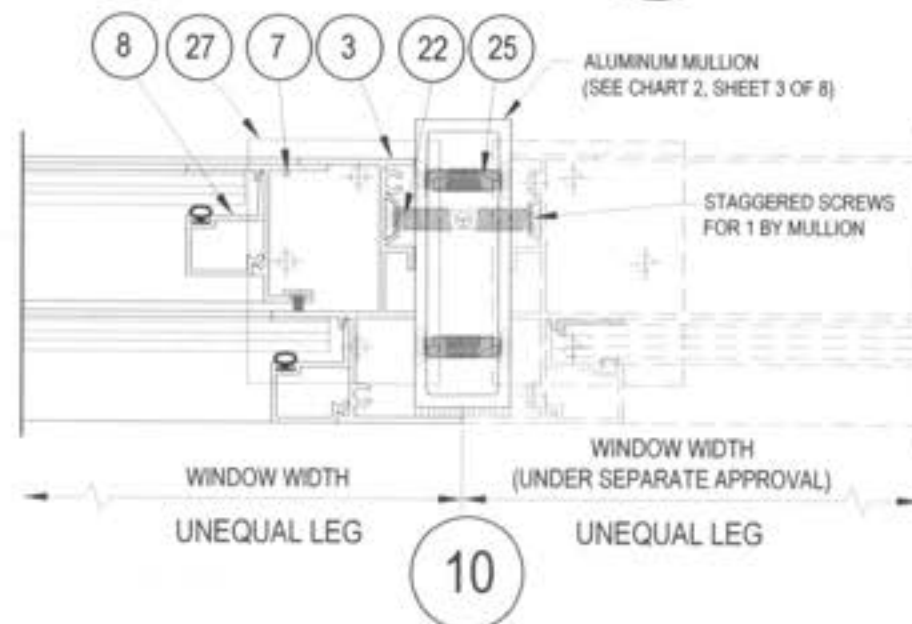
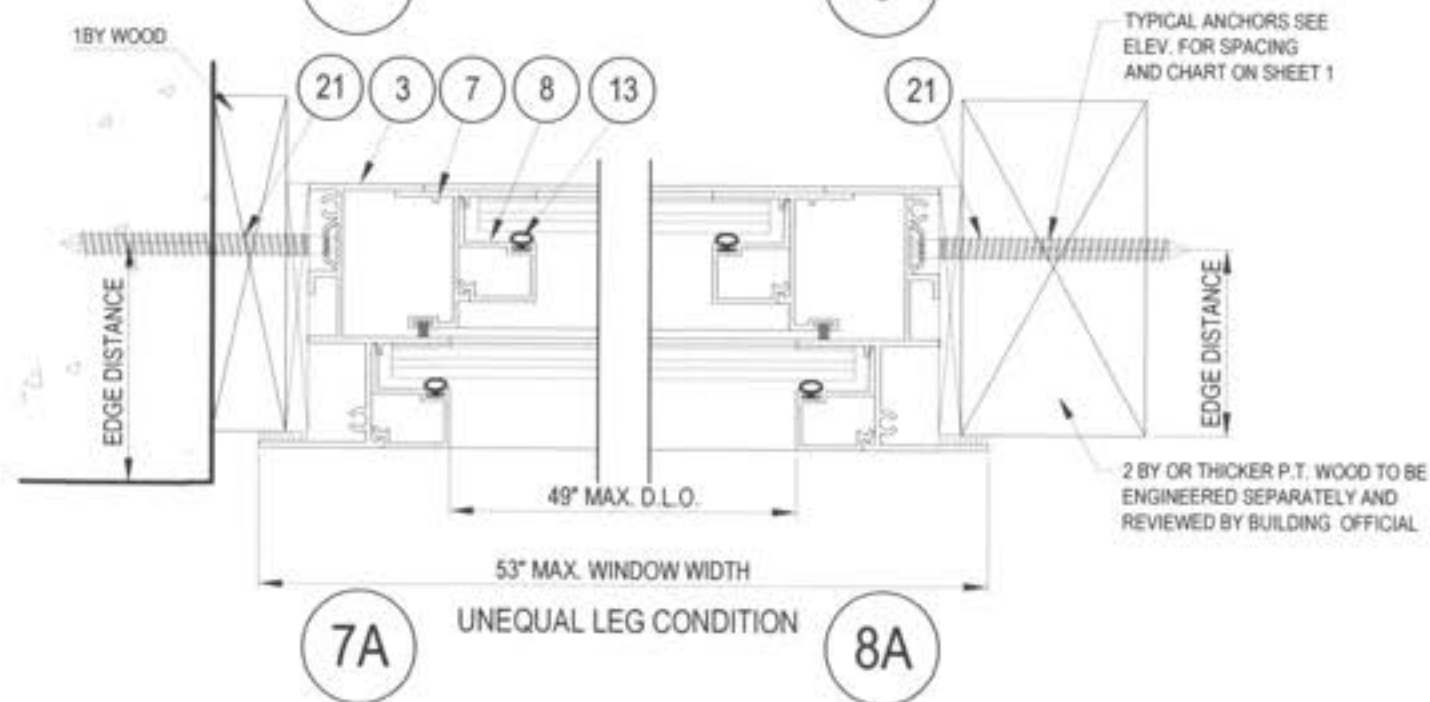
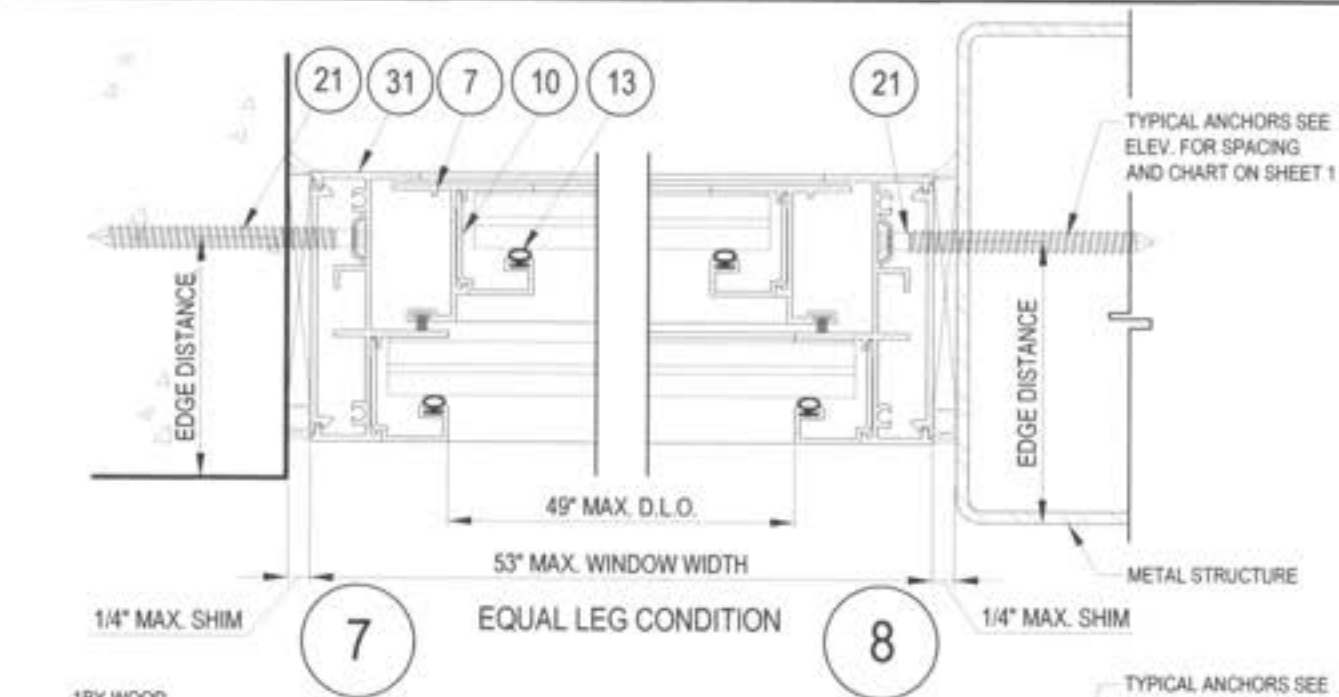

PRODUCT REVISED
as complying with the Florida
Building Code
NOA-No. 21-0628.11
Expiration Date: **08/15/2024**
By: *Manuel Perez*
Miami-Dade Product Control



NO.	DATE	REVISION
1	5/26/2014	UPDATE TO 2017 FBC
2	3/16/2021	UPDATE TO 2020 FBC
3	9/4/2008	
4		
5		
6		
7		
8		
9		
10		
11		
12		
13		
14		
15		
16		
17		
18		
19		
20		
21		
22		
23		
24		
25		
26		
27		
28		
29		
30		
31		
32		
33		
34		
35		
36		
37		
38		
39		
40		
41		
42		
43		
44		
45		
46		
47		
48		
49		
50		
51		
52		
53		
54		
55		
56		
57		
58		
59		
60		
61		
62		
63		
64		
65		
66		
67		
68		
69		
70		
71		
72		
73		
74		
75		
76		
77		
78		
79		
80		
81		
82		
83		
84		
85		
86		
87		
88		
89		
90		
91		
92		
93		
94		
95		
96		
97		
98		
99		
100		

Miami Wall Systems, Inc.

701 West 25th Street
Hialeah, Florida 33010

Phone (305) 895-2000 Fax (305) 895-3006



SINGLE HUNG WINDOW 122 SERIES (LM1)

HORIZONTAL SECTIONS

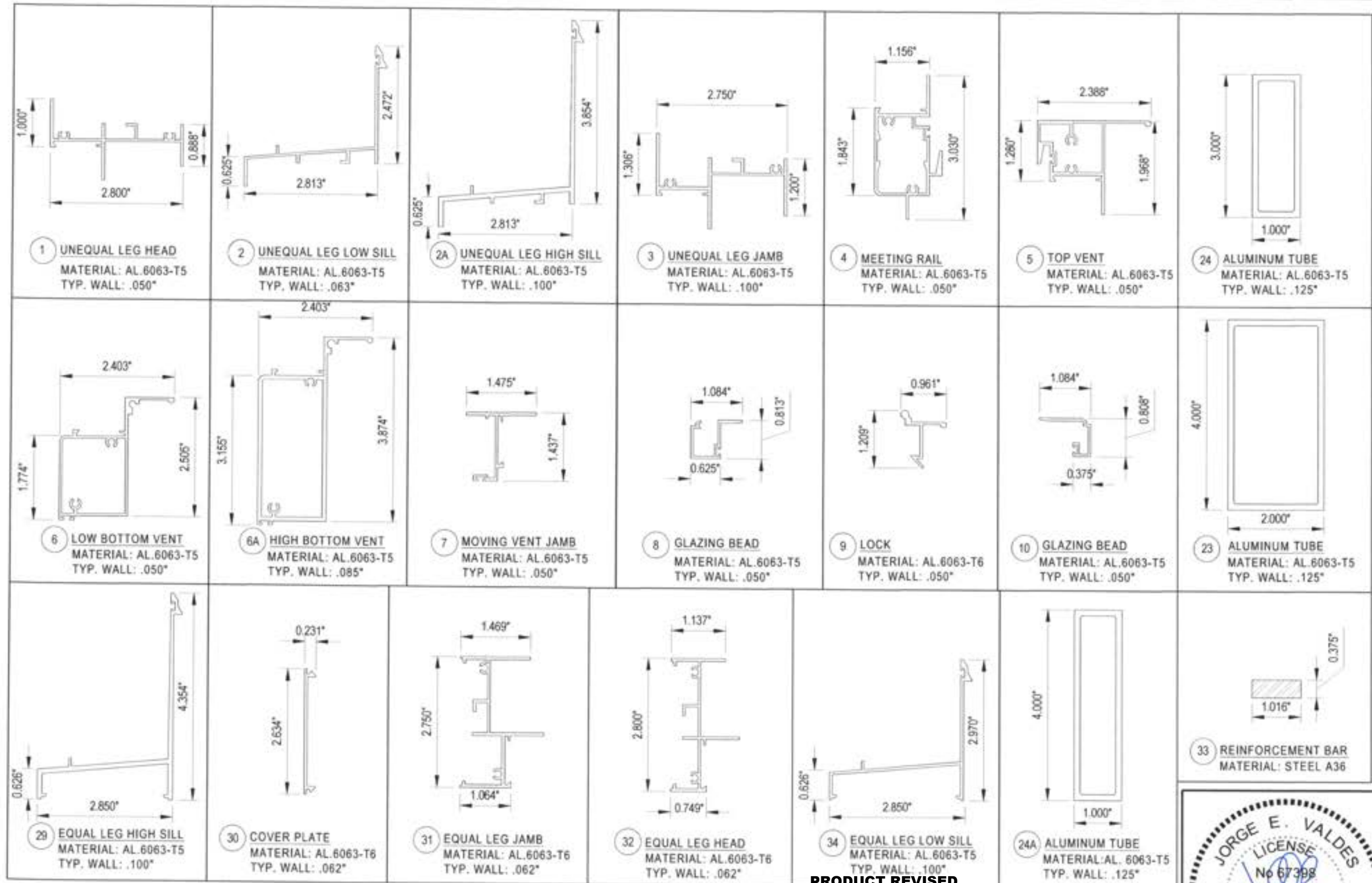

PRODUCT REVISED
as complying with the Florida
Building Code
NOA-No. **21-0628.11**
Expiration Date: **08/15/2024**
By: *Manuel Perez*
Miami-Dade Product Control



Miami Wall Systems, Inc.
701 West 25th Street
Hialeah, Florida 33010
Phone (305) 888-2300 Fax (305) 888-3058

SINGLE HUNG WINDOW 122 SERIES (LMI)
EXTRUSION DETAILS

NO.	DATE	REVISION
1	5/20/2019	UPDATE TO 2017 FBC
2	3/16/2021	UPDATE TO 2020 FBC
3		
4		
5		
6		
7		
8		
9		
10		
11		
12		
13		
14		
15		
16		
17		
18		
19		
20		
21		
22		
23		
24		
25		
26		
27		
28		
29		
30		
31		
32		
33		
34		
35		
36		
37		
38		
39		
40		
41		
42		
43		
44		
45		
46		
47		
48		
49		
50		

DATE: 9/4/2008
SCALE: 1/2
DWG. BY: L.R.A.
CHK. BY: JV
DWG. NO.: 122-SH-LM
SHEET 7 OF 8

