

BOILER ROOM

CAPACITY: **30** • SQ FT: **1,000**
 MINIMUM RENTAL: **4 HOURS**

STARTING AT \$1,200 (SAT/SUN ONLY)

Adjacent to the Card Room, this members-only Speakeasy is appropriately named the Boiler Room as the 1942 boiler holds center stage. This will be a warm—pun intended—place for you to unwind after a day at the office or share something special from your private locker with clients, colleagues or friends and family. Coming online in 2025, reach out if interested in getting on the waitlist.

WHAT'S INCLUDED IN THE SPACE

- Conversation seating areas
- Built-in bar
- 65" television
- Bottle keeps (150)
- Sonos sound system throughout
- Gigabit Internet
- Air conditioning
- Restroom

ADDITIONAL OFFERINGS AVAILABLE

- Garment rack
- Barware, glassware and water stations
- Cocktail tables with black spandex (10)
- Easels (3)

ADJACENT ROOMS

- Card Room for additional 50 reception

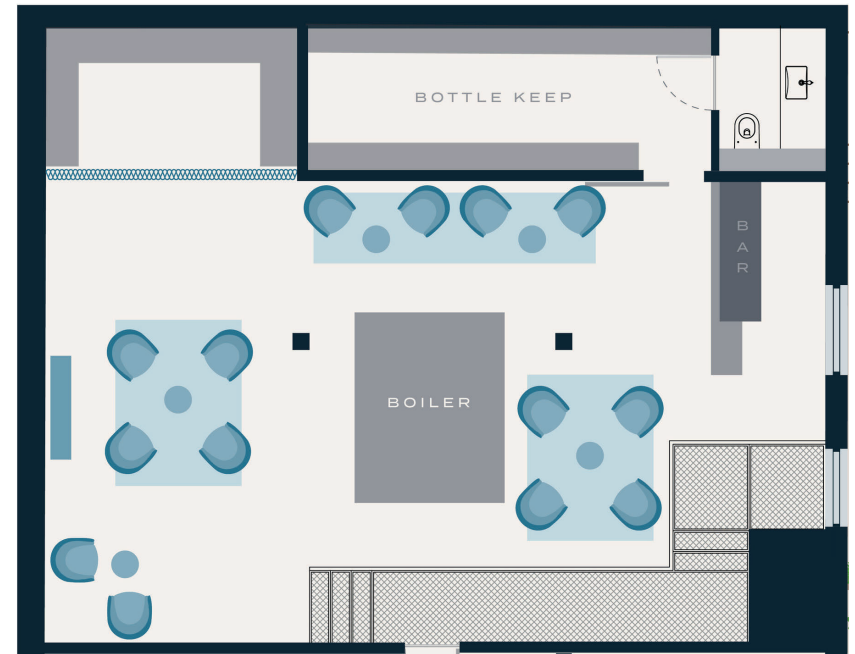

COURTYARD LEVEL

CONTACT US TO DISCUSS CONFIGURATIONS DESIGNED TO
 SUIT YOUR EVENT NEEDS: EVENTS@LABOURTEMPLE.COM