



GAYLORD
NATIONAL®

RESORT & CONVENTION CENTER



Welcome to Gaylord National!

AT GAYLORD HOTELS, THE DIFFERENCE IS THE EXPERIENCE

Any hotel can deliver a meeting, but only Gaylord Hotels has the meeting expertise to create the most powerful meeting experience that your attendees will remember forever.

***Smarter Meetings. Amazing Results.
Gaylord National - "Everything in one Place".***

Located on the banks of the Potomac River just minutes from downtown Washington, D.C., Gaylord National Resort and Convention Center offers over 545,000 sq. ft. of flexible meeting and exhibit space, 1,996 guest rooms, on-site restaurants, entertainment, an award-winning spa, a lush indoor garden atrium and more. Our soaring 19-story glass atrium and stately Federal-style architecture celebrate the spirit and history of our nation's capital, providing the perfect backdrop for your one-of-a-kind event.

Our STARS (associates) are extensively trained to handle meetings of every size. Whether it is a group of 10 or 10,000, they take ownership of your event and work passionately, pro-actively and tirelessly to create a flawless meeting experience.

TABLE OF CONTENTS

2	Resort & Destination Overview
10	Overview Maps
	CONVENTION & MEETING SPACE
12	Woodrow Wilson Meeting Space <i>Woodrow Wilson Ballroom; Annapolis, Baltimore & Fort Washington Rooms</i>
14	Cherry Blossom Meeting Space <i>Cherry Blossom Ballroom; Camellia, Azalea, Magnolia & Presidential Rooms</i>
16	Potomac & Maryland Ballrooms
18	Chesapeake & Mezzanine Conference Rooms
20	National Harbor Conference Rooms
22	Prince George's Exhibition Hall
24	Indoor Event Space <i>Eastern Shore; Town Meeting Space</i>
26	RiverView Ballroom
28	Outdoor Event Space



You have to see it to believe it!
Bring photos and pages to life with our new Engage Gaylord Hotels app.

Interactive images are designated with the  icon.

Download the app at www.engagegaylordhotels.com or scan QR Code.



Washington, D.C.'s Capital Region at Our Doorstep



Just minutes from Washington, D.C., Gaylord National offers the ideal location to enjoy all of the rich heritage, business and culture that the Capital Region has to offer. With an on-site tour desk, car service, rental cars and even a private pier for water taxi services, your attendees will be able to explore some of the area's world-renown monuments, museums and historic attractions.





Surrounded by the Vibrant Energy of National Harbor



Discover National Harbor. Voted one of the Top 50 U.S. Destinations for meetings, Gaylord National puts you and your attendees at the heart of all of the excitement and entertainment that this Washington, D.C. waterfront destination has to offer. From its vibrant downtown atmosphere with outdoor cafes and music, water activities, designer-fashion shopping at Tanger Outlets, and the best views of the region from its 180-ft Capital Wheel, National Harbor offers something for everyone – including the new MGM National Harbor with world-class entertainment, slot machines and luxury table games.





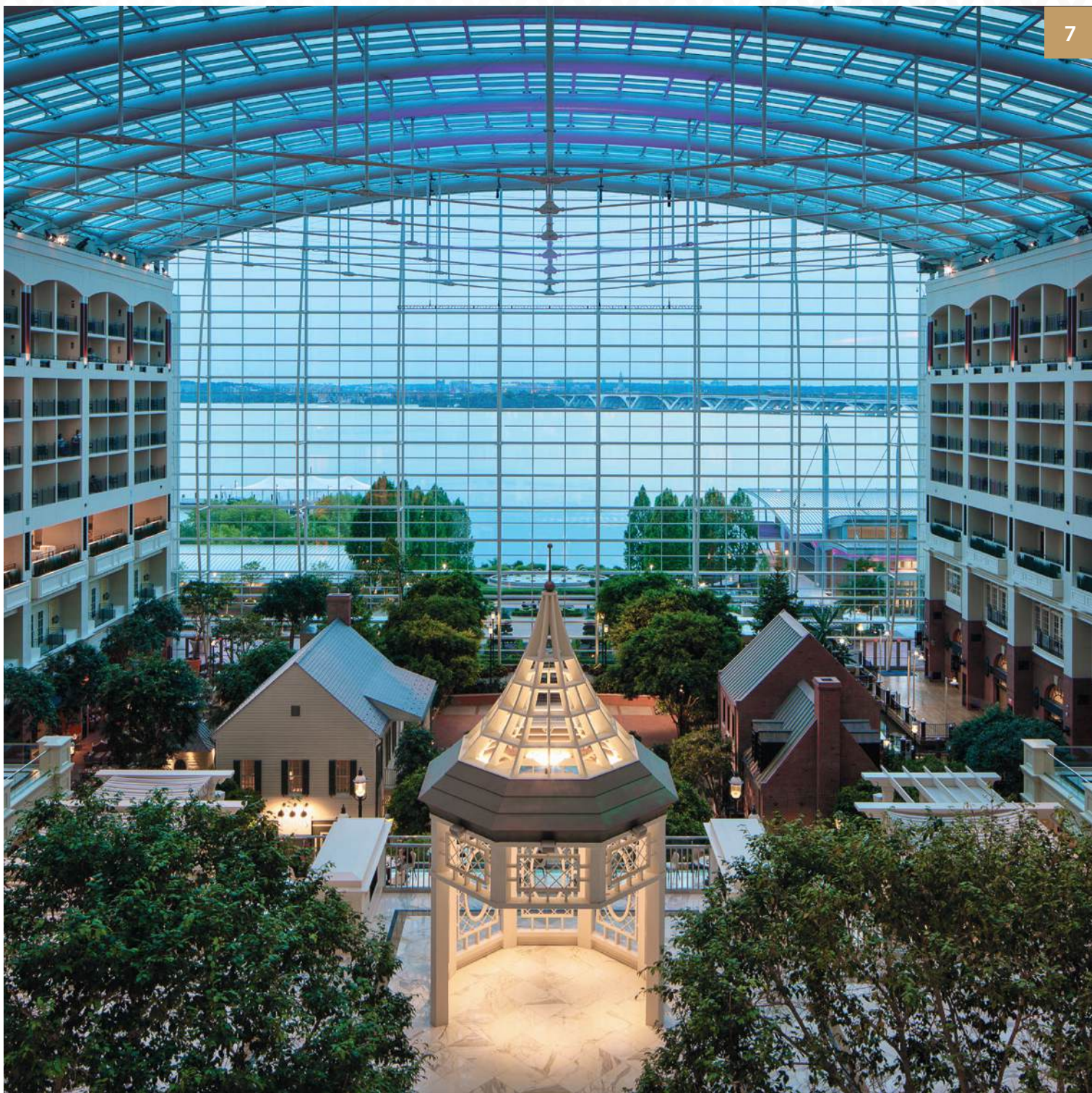

An Extraordinary Environment

ALL UNDER ONE ROOF

Hosting your meeting at Gaylord National means an abundance of creative and unique networking, dining and entertainment options just steps from your meeting room and minutes from your guest room. From a rooftop lounge to a luxurious spa; a sports bar to a fine-dining steakhouse, there is something for everyone at Gaylord National. Our expert catering and banquet team will partner with you to plan unique events for your group. Our beautiful glass atrium, extraordinary restaurants, and outdoor venues are available for private events.



Remarkable Meetings at Gaylord National

From boardrooms to ballrooms, conferences to celebrations, relaxed reception to formal presentation, no matter what size or style of meeting you're imagining, the world-class staff of Gaylord National can bring your vision to life. Our customizable event spaces provide the flexibility you need to make your gathering exceptional.

The Most Experienced Meetings Professionals

At Gaylord National our mission is hosting flawless meetings. And our team does it better than anyone. Through open communication, listening and understanding the purpose of your meeting, we gain a complete perspective of what drives your business and, ultimately, the goals of your meeting. Your Gaylord National team will successfully plan and execute your meeting with unmatched expertise, creativity and agility.

Quick Facts

- Conveniently located off I-95, just minutes from Washington D.C., 15 minutes from Reagan National and 45 minutes from Dulles and Baltimore-Washington International Airports
- 1,996 guest rooms including 110 suites
- Over 545,000 sq. ft. of flexible meeting, convention, exhibit and pre-function space
 - 180,000 sq. ft. of exhibition space with 17 dedicated and covered loading docks
 - Five ballrooms from 8,000 sq. ft. to 50,000 sq. ft. including RiverView Ballroom with 270 degrees of floor to ceiling windows
 - Up to 101 conference and breakout rooms
 - Over 75,000 sq. ft. of spectacular outdoor event space including an 11,000 sq. ft. private event pier
- Private dining options in all of our restaurants including Pose Rooftop Lounge
- Ample bus parking and a separate dedicated bus loop
- Relâche Spa, a 20,000 sq. ft. award winning full-service spa and salon
- Multi-cultural experience and expertise for all types of events
- In-house audio-visual, destination management and transportation companies
- Three full-service restaurants, two grab and go options, four bars and in-room delivery
- Six retail stores offering everything from sundries, souvenirs, jewelry, and women apparel & accessories
- Shuttles to downtown Washington, D.C. Reagan National Airport, and the Harbor Circulator Bus running daily between the harbor's hot spots
- Water Taxi to Old Town Alexandria, Georgetown, The Tidal Basin, Mount Vernon, and The National's Baseball Stadium (seasonal)
- On-site sedan, eco-friendly car services and Hertz® Rental Car





Overview Map

COLOR LEGEND

- Lower Atrium
- Lobby Level
- Ballroom Level *Meeting Space*
- Resort Footprint

KEY

- Concierge
- Front Desk
- Valet
- Bus
- Taxi / Car Service
- Car Rental
- Bell Services
- Restrooms
- Elevator
- Stairs
- Escalator
- Fedex Office Business Center

DINING

- Pienza Marketplace *Lower Atrium*
- National Pastime Bar & Grill *Lower Atrium*
- Old Hickory Steakhouse & Lounge *Lobby Level*

BAR & LOUNGE

- Belvedere Lobby Bar *Lobby Level*
- Pose Rooftop Lounge *Elevator across from Bell Stand to 18th Floor*

EATERY

- The Cocoa Bean Coffee • *Lower Atrium*
- Harbor Marketplace • *Lower Atrium*

SHOPPING

- Key Provisions News, Sundry & Gifts • *Lower Atrium*
- Stars N' Stripes *Lower Atrium*
- Paisley Accessories & More *Lower Atrium*
- Amelia's Boutique *Lower Atrium*
- Relâche Boutique *Lobby Level*
- Strictly First Glass *Lobby Level*

AMENITIES

- Relâche Spa & Salon *Lobby Level*
- Fitness Center *ELV2 to Level P*
- Pool *ELV2 to Level P*
- Potomac Play Zone *ELV2 to Level P*



Meeting Space Map

National Harbor Conference Rooms

- A** National Harbor Conference Rooms

Ballroom Level

- | | |
|--------------------------------------|----------------------------------|
| B Maryland Ballroom | I Cherry Blossom Ballroom |
| C Chesapeake Conference Rooms | J Magnolia Rooms |
| D Potomac Ballroom | K Camellia Rooms |
| E Baltimore Rooms | L Azalea Rooms |
| F Fort Washington Boardroom | M Presidential Boardroom |
| G Annapolis Rooms | |
| H Woodrow Wilson Ballroom | |

Lobby Level

- N** Mezzanine Conference Rooms

Lower Atrium

- | |
|--|
| O Prince George's Exhibition Hall |
| P Town Square |
| Q Eastern Shore Meeting Space |
| R RiverView Ballroom |
| S Orchard Terrace |

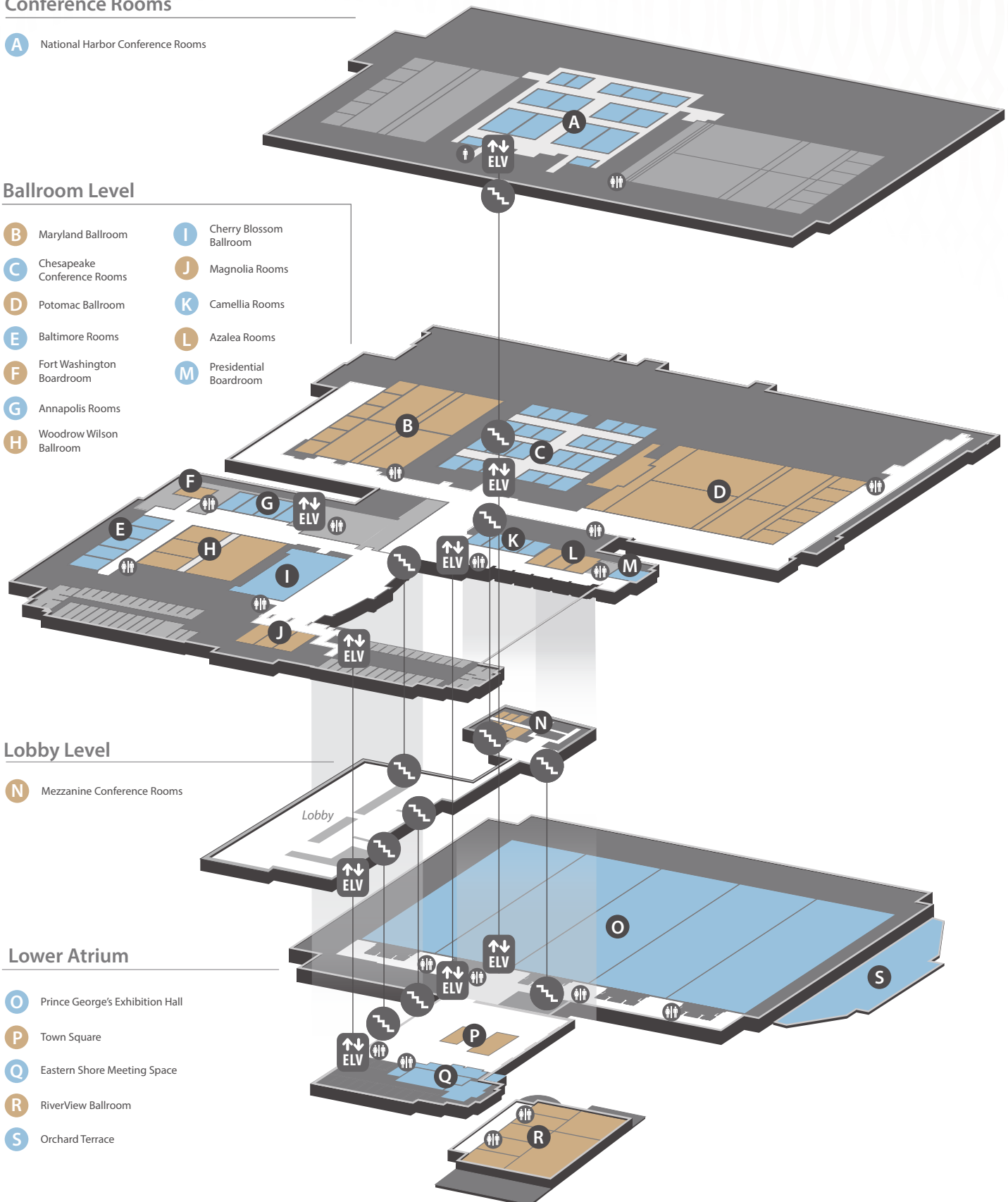



Woodrow Wilson Meeting Space

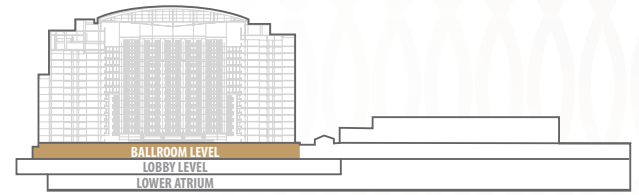

- KEY**
- Restrooms
 - Stairs
 - Registration Desks
 - Service Areas
 - Elevator
 - Escalator
 - Coat Check

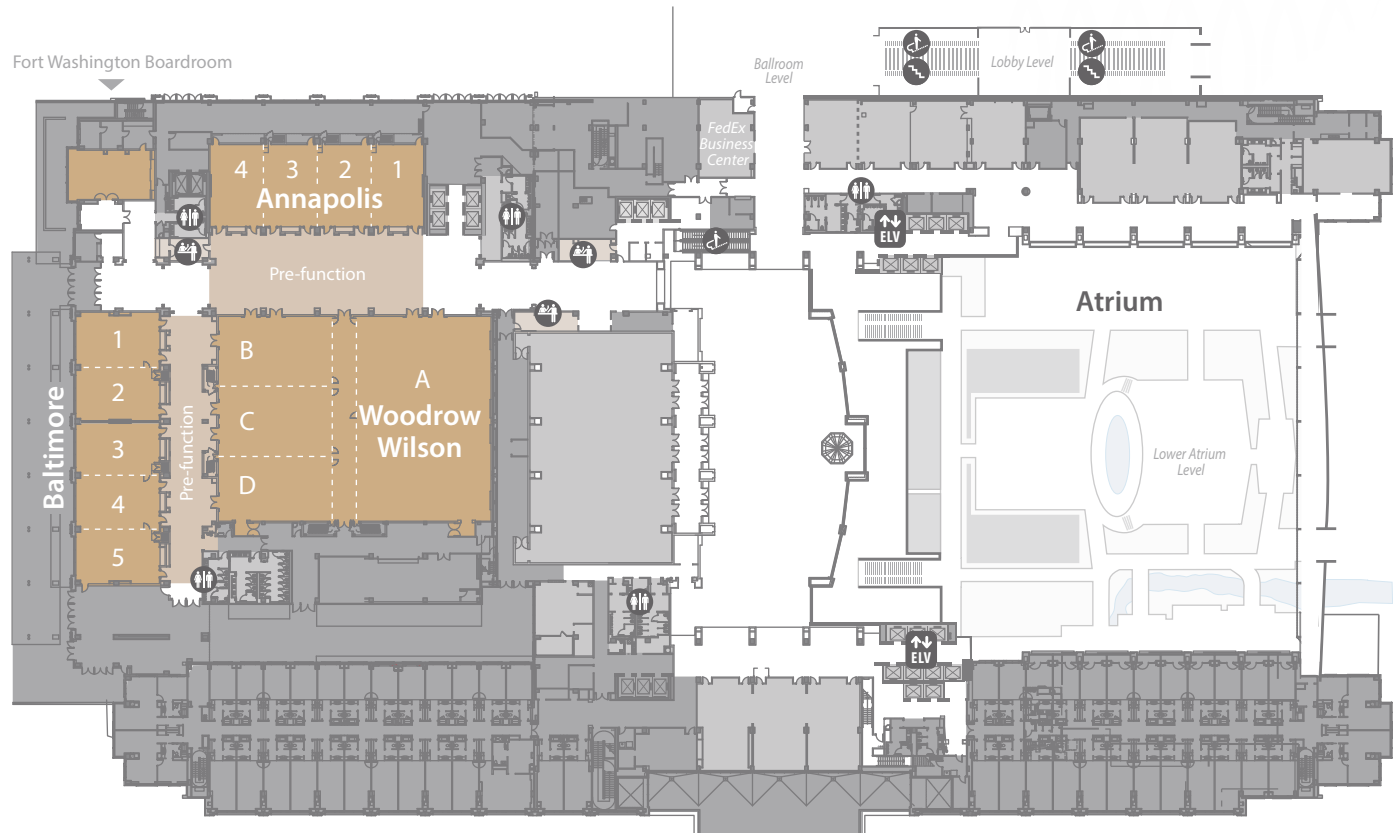

Photograph: Woodrow Wilson Ballroom



BALLROOM	L X W X H (FEET)	SQ. FT.	THEATER	CLASSROOM	CONFERENCE	U-SHAPE	ROUNDS (10)	RECEPTION
WOODROW WILSON	136x102x22	13,780	1,400	756			840	1,378
A	102x67x22	6,788	748	432			480	679
B	35x57x22	1,964	176	96	40	45	130	196
C	35x57x22	1,987	176	96	40	45	130	199
D	32x57x22	1,822	176	96	40	45	120	182
Registration Desk	28x9x9	144						

MEETING SPACE	L X W X H (FEET)	SQ. FT.	THEATER	CLASSROOM	CONFERENCE	U-SHAPE	ROUNDS (10)	RECEPTION
BALTIMORE								
1/2	45x55x14	2,273	182	108	40	42	120	228
1	45x28x14	1,155	96	54	34	36	60	116
2	45x27x14	1,118	96	54	34	36	60	112
3/4/5	44x81x14	3,289	273	180	52	63	210	340
3	45x26x14	1,116	96	54	34	36	60	112
4	44x27x14	1,144	96	54	34	36	60	114
5	44x28x14	1,142	96	54	34	36	60	114
ANNAPOLIS	43x107x14	4,436	384	216	82	96	270	444
1	43x26x14	1,086	96	54	34	36	70	109
2	43x27x14	1,123	96	54	34	36	70	112
3	43x27x14	1,121	96	54	34	36	70	112
4	43x27x14	1,106	96	54	34	36	70	111
Registration Desk	16x7x10	112						

BOARDROOM	L X W X H (FEET)	SQ. FT.	THEATER	CLASSROOM	CONFERENCE	U-SHAPE	ROUNDS (10)	RECEPTION
FORT WASHINGTON	43x26x14	1,029			15			
Registration Desk	9x5x8	350						

Capacities shown in this book are maximum for each room, with no staging or audio-visual, and should be used for reference only. Room capacities will be diminished based on your staging and audio-visual needs.



Photographs: (Left & Right, Baltimore Meeting Room)



Cherry Blossom Meeting Space

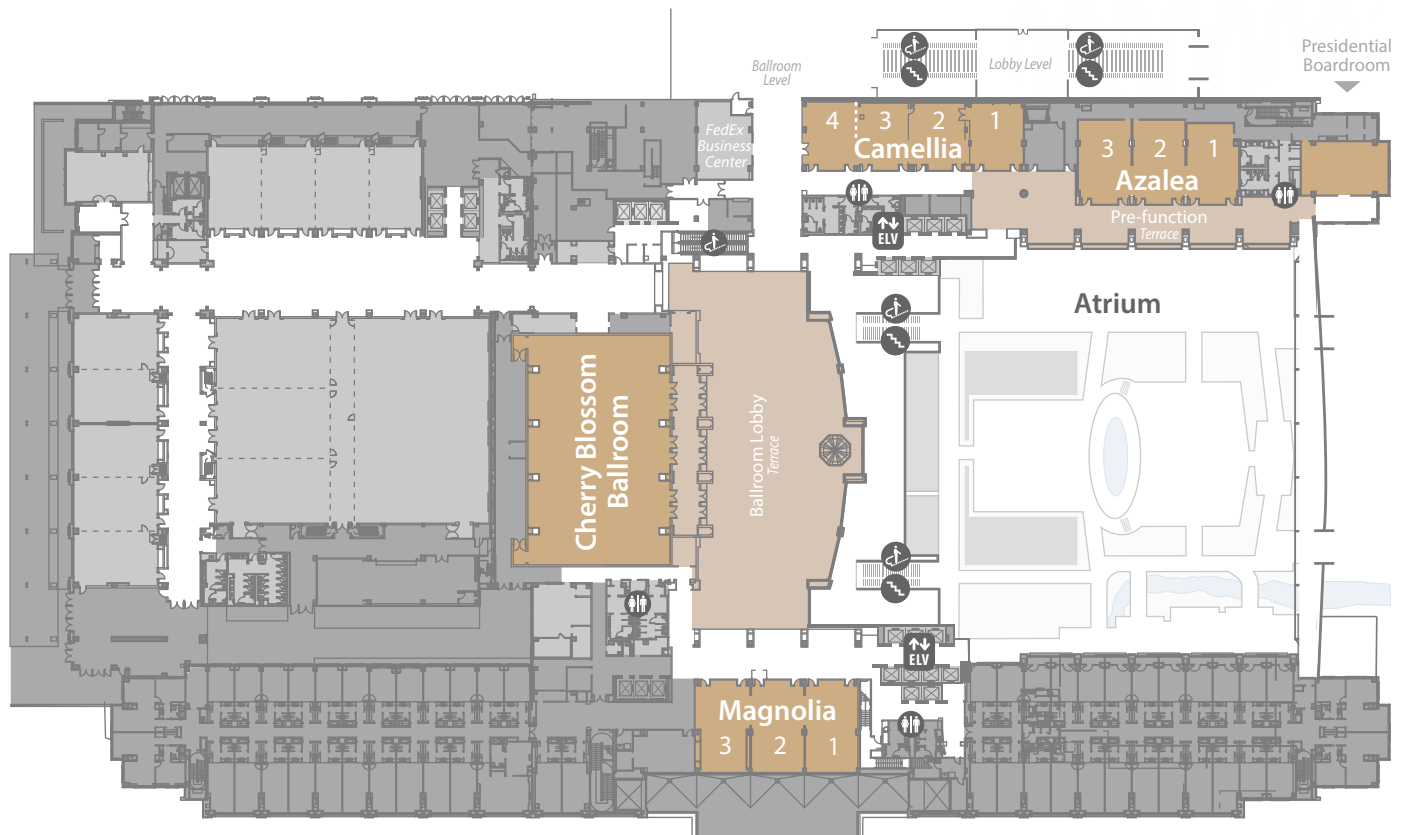
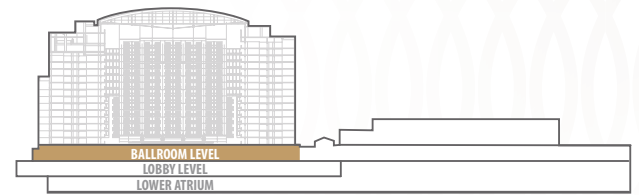

Photograph: Cherry Blossom Ballroom

BALLROOM	L X W X H (FEET)	SQ. FT.	THEATER	CLASSROOM	CONFERENCE	U-SHAPE	ROUNDS (10)	RECEPTION
CHERRY BLOSSOM	116x71x20	7,957	720	439			500	796
Ballroom Lobby	178Lx82W	11,582						

MEETING SPACE	L X W X H (FEET)	SQ. FT.	THEATER	CLASSROOM	CONFERENCE	U-SHAPE	ROUNDS (10)	RECEPTION
CAMELLIA								
1	27x26x10	864	70	36	28	24	50	85
2	30x27x10	736	60	36	22	24	40	83
3/4	30x50x10	1,559	90	54	30	24	80	100
3	30x27x10	823	60	36	22	24	40	83
4	30x23x10	826	50	27	22	24	40	83
AZALEA								
1	39x27x10	1,064	96	45	34	30	60	105
2	39x27x10	1,064	96	45	34	30	60	105
3	39x27x10	1,064	96	45	34	30	60	105
Pre-function								
MAGNOLIA								
1	42x27x10	1,180	84	45	28	30	60	110
2	42x27x10	1,150	84	45	28	30	60	110
3	42x27x10	1,185	84	45	28	30	60	110

BOARDROOM	L X W X H (FEET)	SQ. FT.	THEATER	CLASSROOM	CONFERENCE	U-SHAPE	ROUNDS (10)	RECEPTION
PRESIDENTIAL	42x27x9.5	1,090			16			

Capacities shown in this book are maximum for each room, with no staging or audio-visual, and should be used for reference only. Room capacities will be diminished based on your staging and audio-visual needs.



Photographs: (Left, Cherry Blossom Ballroom; Right, Presidential Boardroom)



Potomac & Maryland Ballrooms

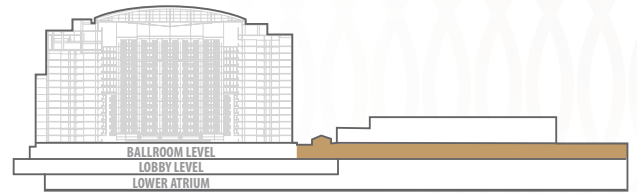

- KEY**
- Restrooms
 - Stairs
 - Registration Desks
 - Service Areas
 - Elevator
 - Escalator
 - Coat Check

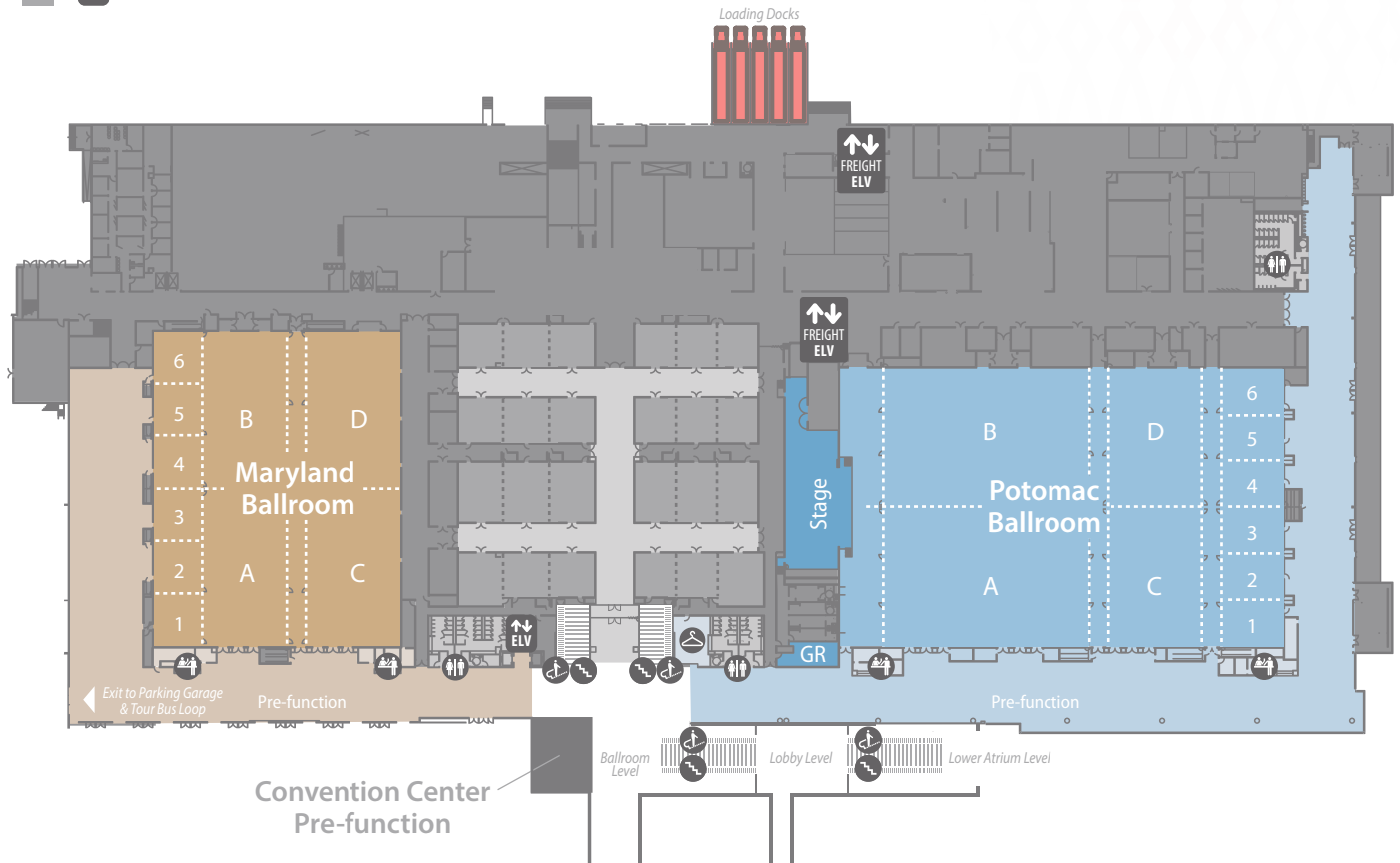

Photograph: Potomac Ballroom



BALLROOM	L X W X H (FEET)	SQ.FT.	THEATER	CLASSROOM	CONFERENCE	U-SHAPE	ROUNDS (10)	RECEPTION
MARYLAND BALLROOM	199x156x28.5	31,127	3,520	2,043			2,070	3,113
A	99x54x28.5	5,427	614	334			360	543
B	99x54x28.5	5,430	614	334			360	543
C	99x59x28.5	5,921	614	334			390	592
D	99x59x28.5	5,933	614	334			390	593
Breakouts								
1	33x30x28.5	994	72	42	28	30	60	99
2	33x30x28.5	995	72	42	28	30	60	100
3	33x30x28.5	1,001	72	42	28	30	60	100
4	33x30x28.5	998	72	42	28	30	60	100
5	33x30x28.5	994	72	42	28	30	60	99
6	33x30x28.5	992	72	42	28	30	60	99
Access Corridor A&C / B&D	12x200x28.5	2400						
Pre-function	18 H	15,965						
2 Registration Desks		171ea						

BALLROOM	L X W X H (FEET)	SQ.FT.	THEATER	CLASSROOM	CONFERENCE	U-SHAPE	ROUNDS (10)	RECEPTION
POTOMAC BALLROOM	175x316x28.5	51,462	5,520	3,402			3,080	5,146
A	89x129x28.5	11,479	1,088	663			760	1,148
B	86x129x28.5	11,145	1,088	663			740	1,115
C	88x60x28.5	5,317	540	312		50	350	532
D	86x60x28.5	5,160	540	312		50	340	516
Breakouts								
1	28x39x28.5	1,098	84	60	34	36	60	110
2	30x39x28.5	1,147	84	60	34	36	60	115
3	31x39x28.5	1,186	84	60	34	36	60	119
4	28x39x28.5	1,085	84	60	34	36	60	109
5	30x39x28.5	1,129	84	60	34	36	60	113
6	29x39x28.5	1,109	84	60	34	36	60	111
Access Corridors								
1	175x24x28.5	4,295						
2	175x24x28.5	4,295						
Stage	32.8x99.3x28.5							
Extension	9.5x50x28.5							
Stage Corridor	9.6x50x28.5	480						
Green Room	31x15x9	465						
Pre-function		22,405						
2 Registration Desks	14x8x12	171ea						
Coat Check	21x22x12	462						

PRE-FUNCTION

	L X W (FEET)	SQ.FT.
CONVENTION CENTER PRE-FUNCTION	38x46	1,748

Capacities shown in this book are maximum for each room, with no staging or audio-visual, and should be used for reference only. Room capacities will be diminished based on your staging and audio-visual needs.



Chesapeake & Mezzanine Conference Rooms

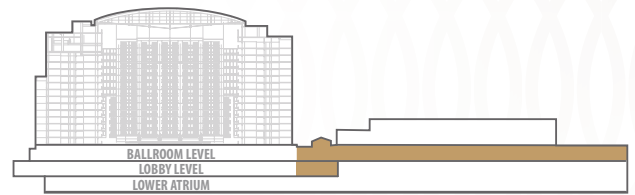

- KEY**
- Restrooms
 - Stairs
 - Registration Desks
 - Service Areas
 - Elevator
 - Escalator
 - Coat Check

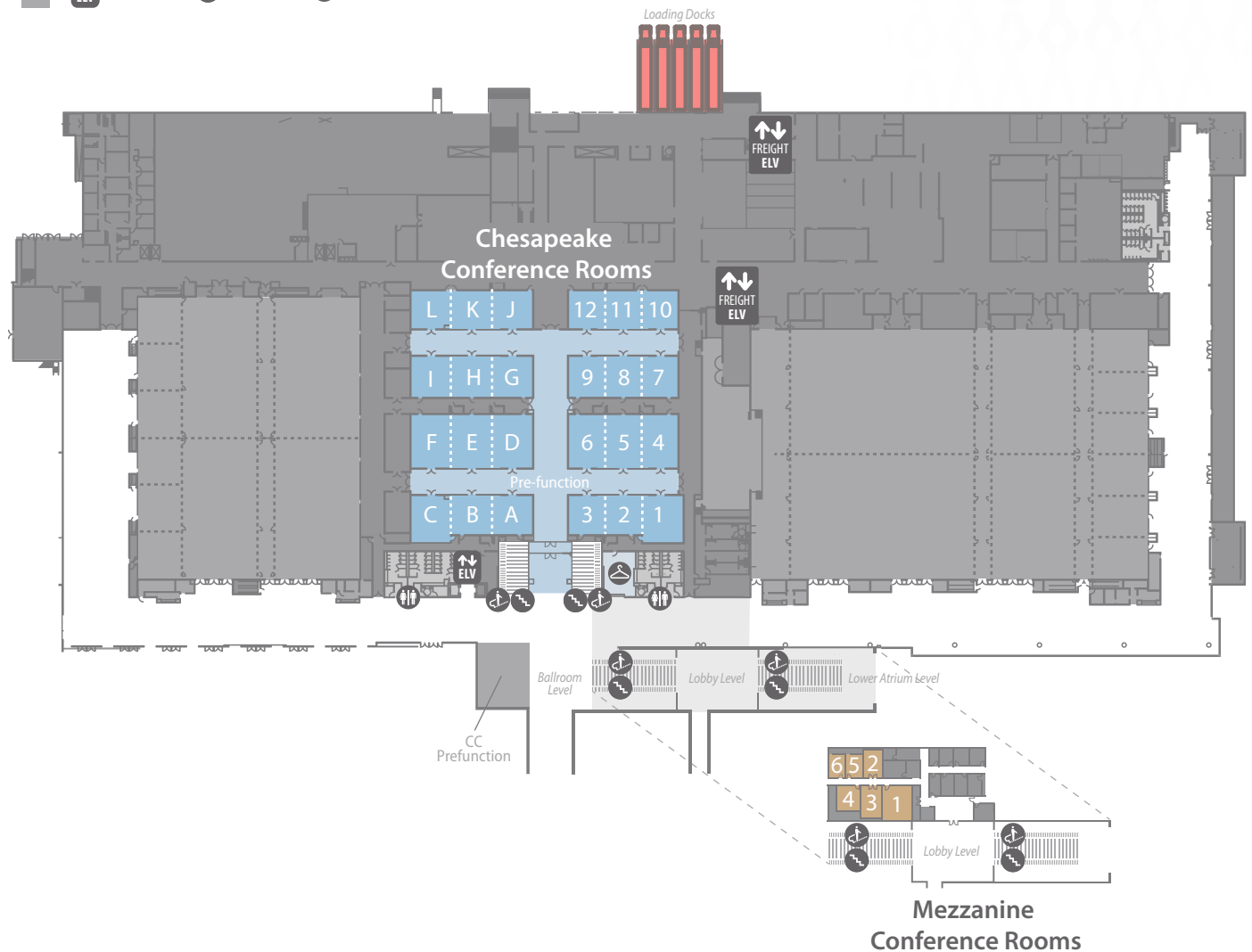

Photograph: Camellia Conference Setup

CONFERENCE ROOM	L X W X H (FEET)	SQ. FT.	THEATER	CLASSROOM	CONFERENCE	U-SHAPE	ROUNDS (10)	RECEPTION
CHESAPEAKE								
A/B/C		2,358	207	102	66	72	120	236
A	28x29x14	782	67	33	22	24	40	78
B	28x29x14	795	70	36	22	24	40	80
C	28x29x14	781	70	33	22	24	40	78
D/E/F		3,169	210	135	84	90	180	316
D	37x28x14	1,051	70	45	28	30	60	105
E	37x28x14	1,054	70	45	28	30	60	105
F	37x29x14	1,064	70	45	28	30	60	106
G/H/I		2,453	180	108	66	72	120	246
G	29x28x14	811	60	36	22	24	40	81
H	29x29x14	817	60	36	22	24	40	82
I	29x29x14	825	60	36	22	24	40	83
J/K/L		2,296	150	81	66	72	120	230
J	27x28x14	767	50	27	22	24	40	77
K	27x28x14	770	50	27	22	24	40	77
L	27x28x14	759	50	27	22	24	40	76
1/2/3		2,186	163	99	66	72	120	218
1	28x29x14	802	60	36	22	24	40	80
2	28x26x14	682	48	27	22	24	40	68
3	28x25x14	702	55	36	22	24	40	70
4/5/6		2,836	210	135	84	90	180	283
4	37x26x14	954	70	45	28	30	60	95
5	37x26x14	951	70	45	28	30	60	95
6	37x26x14	931	70	45	28	30	60	93
7/8/9		2,196	150	108	66	72	120	220
7	29x26x14	737	50	36	22	24	40	74
8	29x26x14	735	50	36	22	24	40	74
9	29x25x14	724	50	36	22	24	40	72
10/11/12		2,044	150	81	66	72	120	205
10	27x25x14	682	50	27	22	24	40	68
11	27x25x14	675	50	27	22	24	40	68
12	27x25x14	687	50	27	22	24	40	69

CONFERENCE ROOM	L X W (FEET)	SQ. FT.	THEATER	CLASSROOM	CONFERENCE	U-SHAPE
MEZZANINE ROOMS						
1	25x21	625	40	30	22	25
2	20x14	285			10	
3	23x15	342			10	
4	17x18	307			10	
5	17x12	204			8	
6	17x12	204			8	

Capacities shown in this book are maximum for each room, with no staging or audio-visual, and should be used for reference only. Room capacities will be diminished based on your staging and audio-visual needs.



National Harbor Conference Rooms

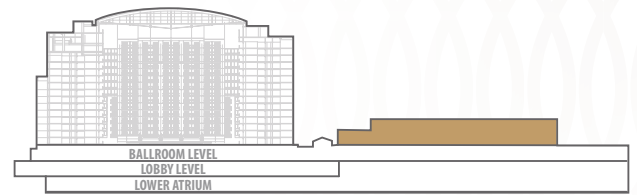

- KEY**
- Restrooms
 - Stairs
 - Registration Desks
 - Service Areas
 - Elevator
 - Escalator
 - Coat Check

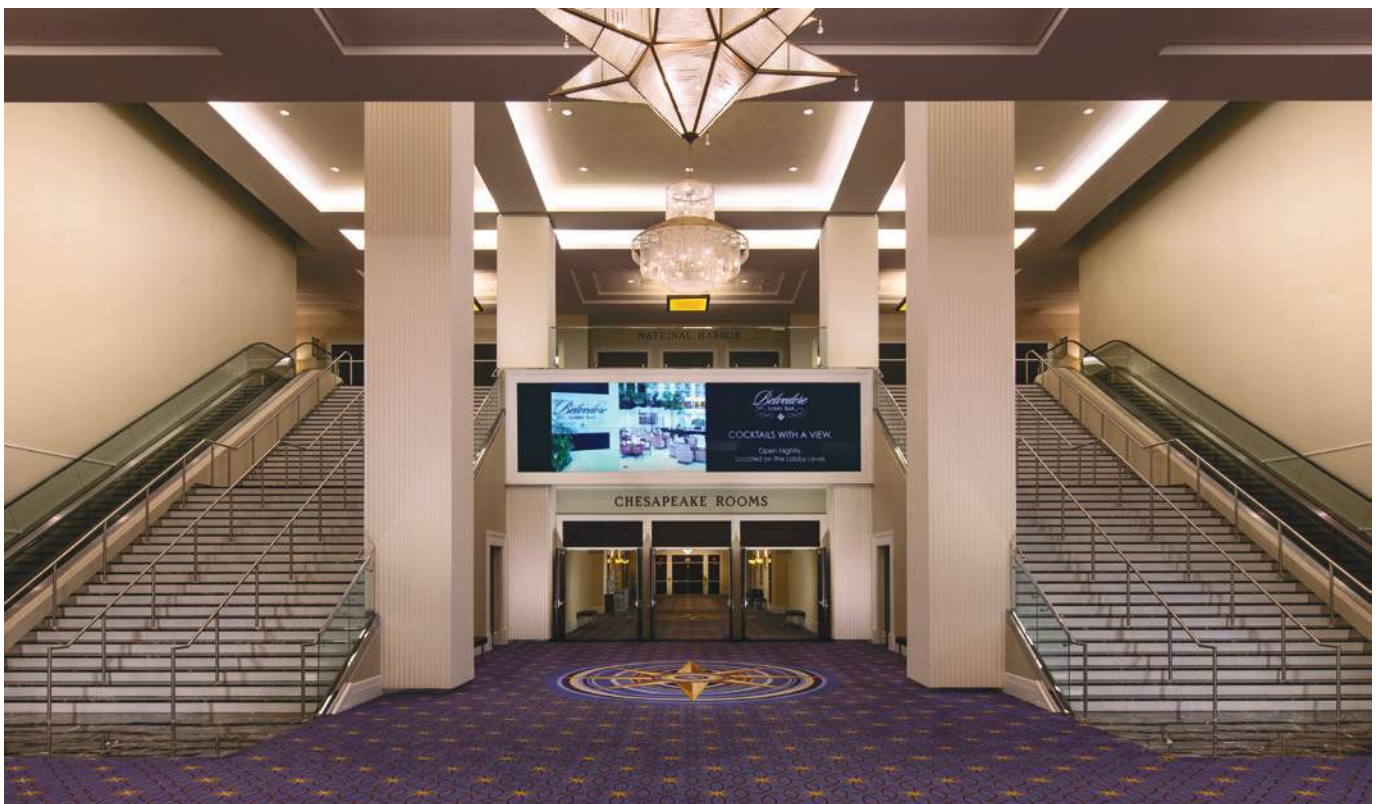
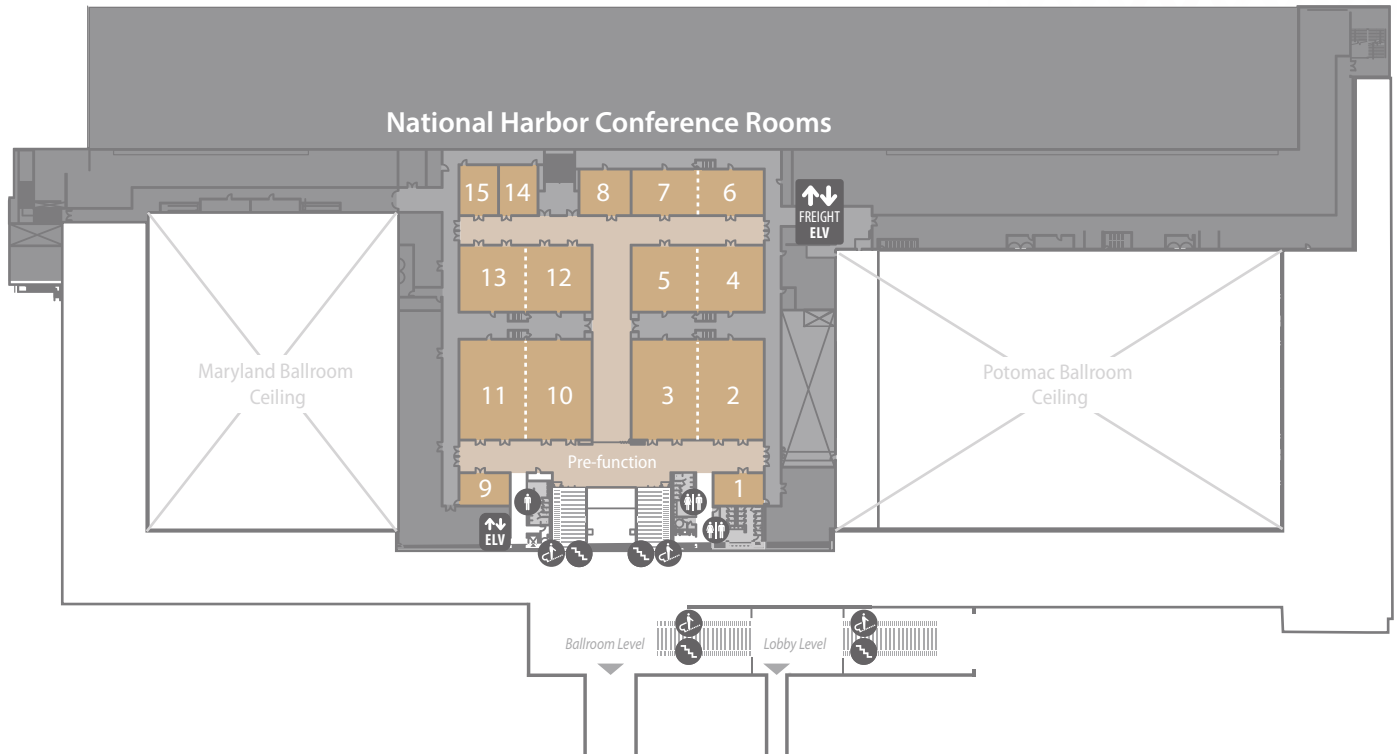

CONFERENCE ROOM	L X W X H (FEET)	SQ.FT.	THEATER	CLASSROOM	CONFERENCE	U-SHAPE	ROUNDS (10)	RECEPTION
NATIONAL HARBOR								
1	20x31x14	621	48	24	22	24	40	62
2/3	63x82x14	5,135	510	294	92	102	300	514
2	63x41x14	2,595	260	150	46	51	150	260
3	63x41x14	2,540	250	144	46	51	150	254
4/5	42x82x14	3,410	300	177	68	72	180	341
4	42x41x14	1,726	160	90	34	39	90	173
5	42x41x14	1,684	140	87	34	33	90	168
6/7	29x82x14	2,355	220	120	68	66	120	236
6	29x41x14	1,175	110	60	34	33	60	118
7	29x41x14	1,180	110	60	34	33	60	118
8	29x32x14	919	70	45	28	27	60	92
9	20x32x14	636	48	24	22	24	40	64
10/11	63x82x14	5,098	490	285	98	102	300	510
10	63x41x14	2,568	250	150	52	51	150	257
11	63x41x14	2,530	240	135	46	51	150	253
12/13	42x82x14	3,398	320	177	68	81	180	340
12	42x41x14	1,696	160	90	34	45	90	170
13	42x41x14	1,702	160	87	34	36	90	170
14	31x24x14	756	60	36	22	18	40	76
15	31x24x14	757	60	36	22	18	40	76

Capacities shown in this book are maximum for each room, with no staging or audio-visual, and should be used for reference only. Room capacities will be diminished based on your staging and audio-visual needs.



Photograph: Right, Camellia Dinner Setup



Prince George's Exhibition Hall

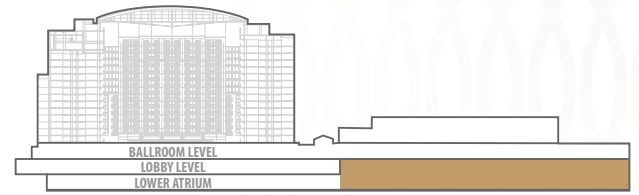

- KEY**
- Restrooms
 - Stairs
 - Registration Desks
 - Service Areas
 - Elevator
 - Escalator
 - Coat Check

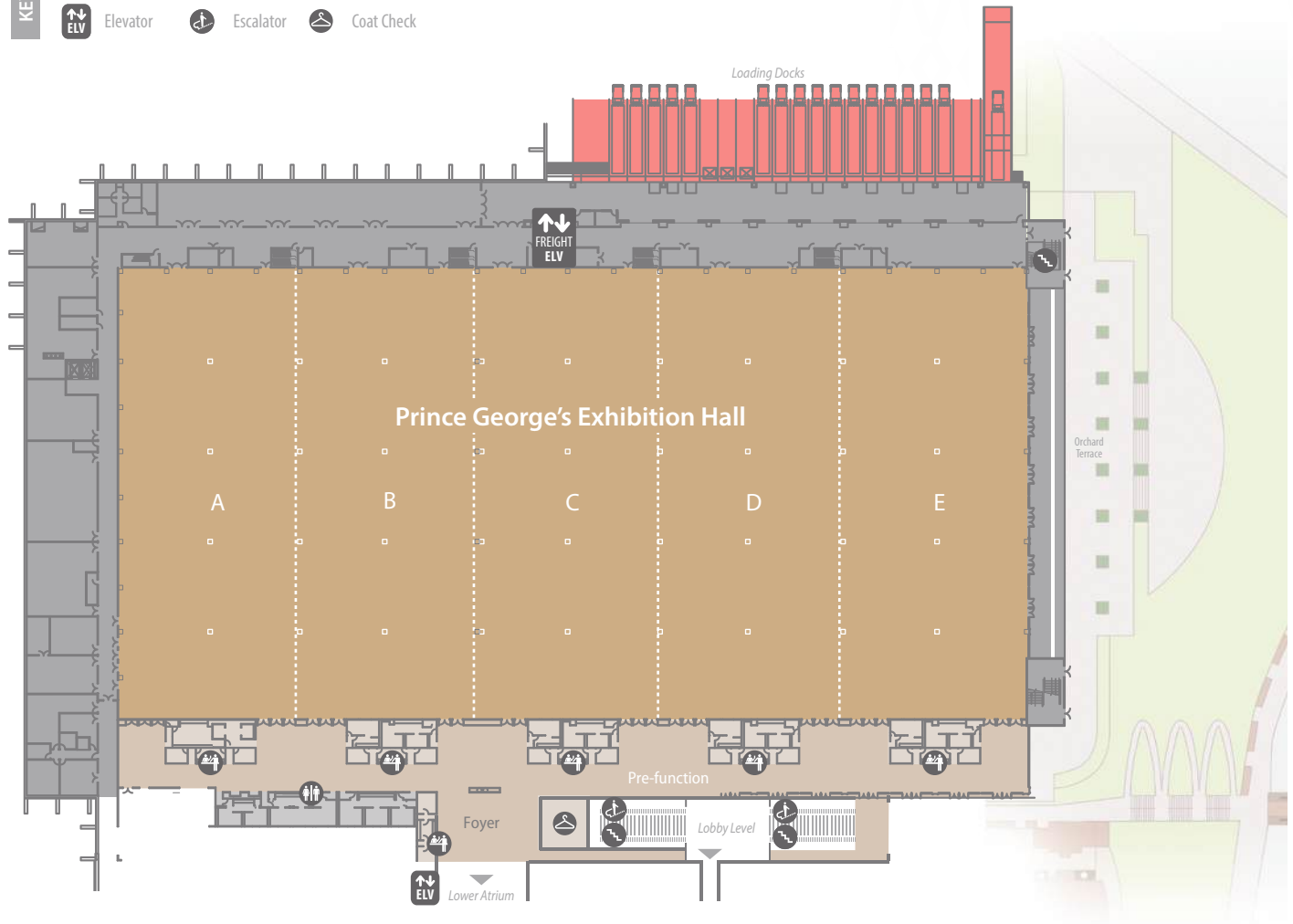

Photograph: Exhibition Hall

EXHIBITION HALL	L X W X H (FEET)	SQ. FT.	THEATER	CLASSROOM	ROUNDS (10)	RECEPTION	8 X 10 BOOTHS	10 X 10 BOOTHS
PRINCE GEORGE'S	299x602x24	178,787	17,878	8,515	10,000	17,878	984	953
A	299x117x24	34,881	3,488	1,661	2,000	3,488	188	162
B	299x118x24	35,153	3,515	1,674	2,000	3,515	200	184
C	299x122x24	36,257	3,626	1,727	2,000	3,626	200	184
D	299x120x24	35,692	3,569	1,700	1,990	3,569	200	184
E	299x125x24	36,804	3,680	1,753	1,990	3,680	196	171
Pre-function Space		23,361						
5 Registration Desks		152 ea						
Coat Check	23x23x10	425						

Capacities shown in this book are maximum for each room, with no staging or audio-visual, and should be used for reference only. Room capacities will be diminished based on your staging and audio-visual needs.

Photograph: Exhibition Hall

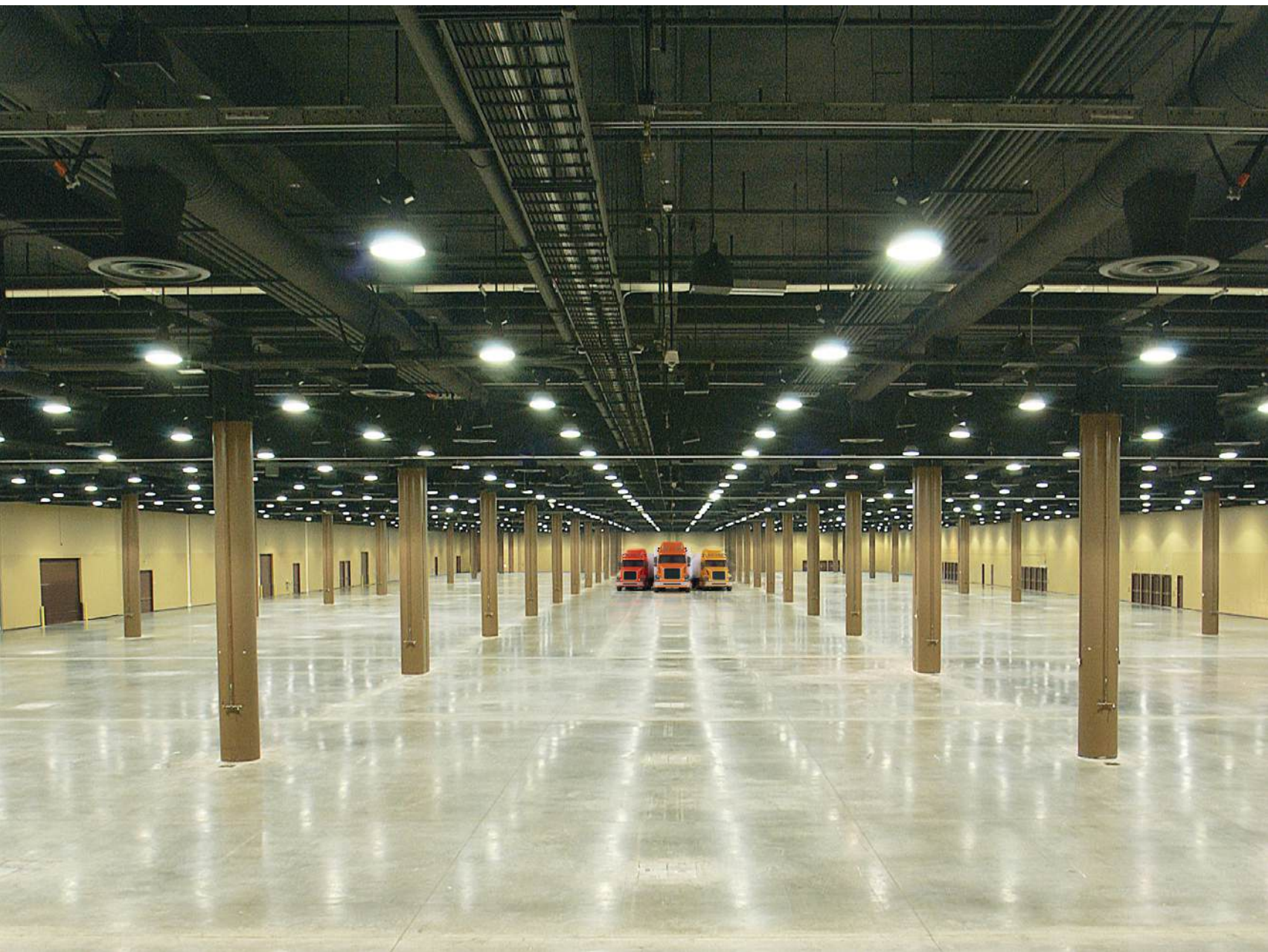



Indoor Event Space

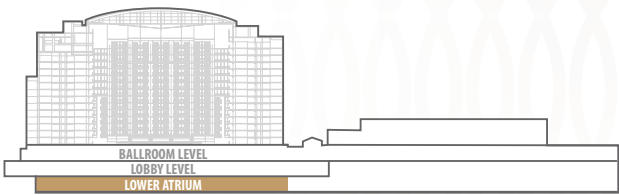

- KEY
- Restrooms
- Stairs
- Registration Desks
- Service Areas
- Elevator
- Escalator
- Coat Check

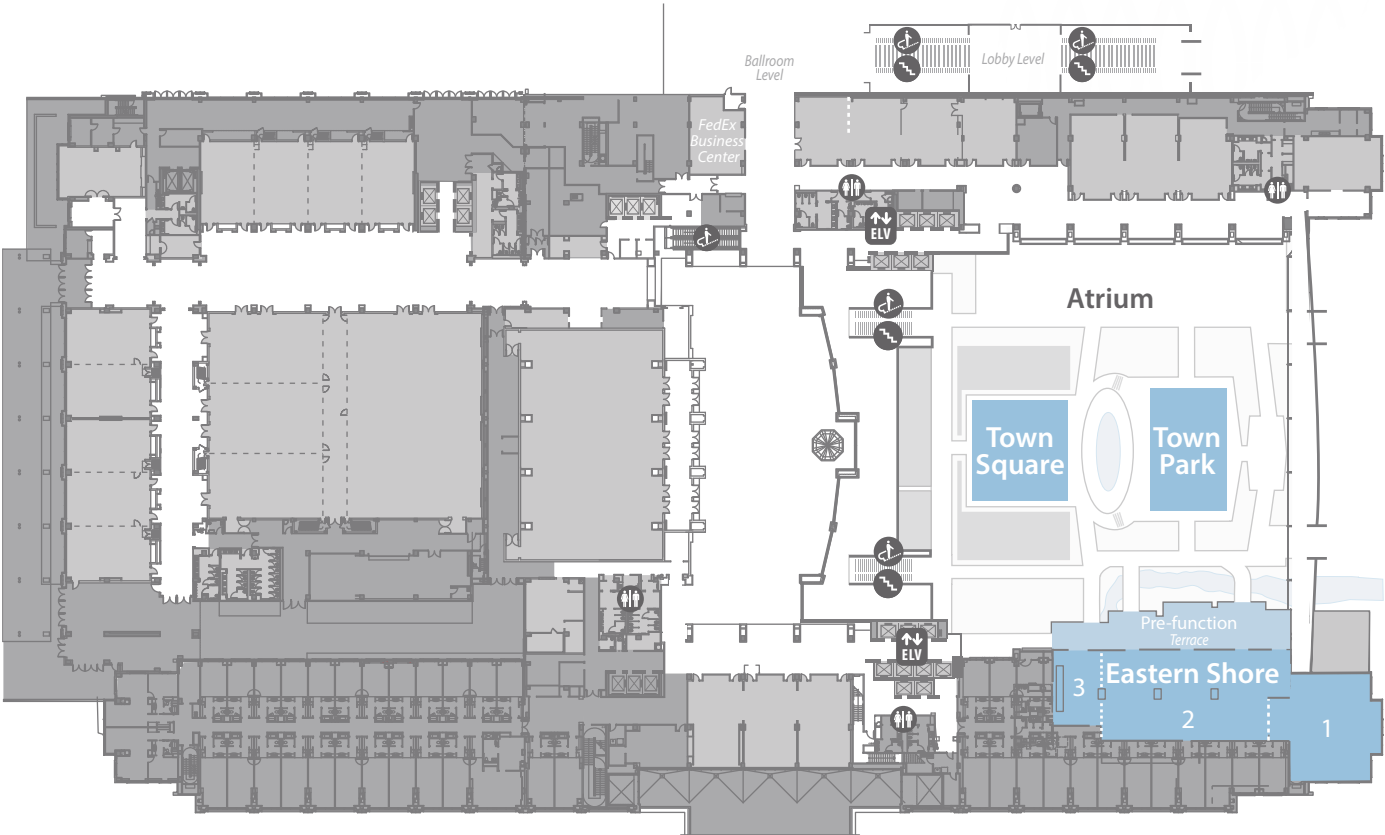

LOWER ATRIUM	L X W X H (FEET)	SQ.FT.	THEATER	CLASSROOM	CONFERENCE	U-SHAPE	ROUNDS (10)	RECEPTION
EASTERN SHORE								
1	51x30x11	1,914	100	63	34	36	80	100
2	45x75x11	3,356	269	162	34	36	160	200
3	30x15x11	576						
Pre-function (The Wharf)		1,392						
TOWN MEETING SPACE								
Town Square		2,000						
Town Park		2,600						



Photographs: (Top, Gaylord National Atrium; Left, Eastern Shore; Right, Eastern Shore)



RiverView Ballroom

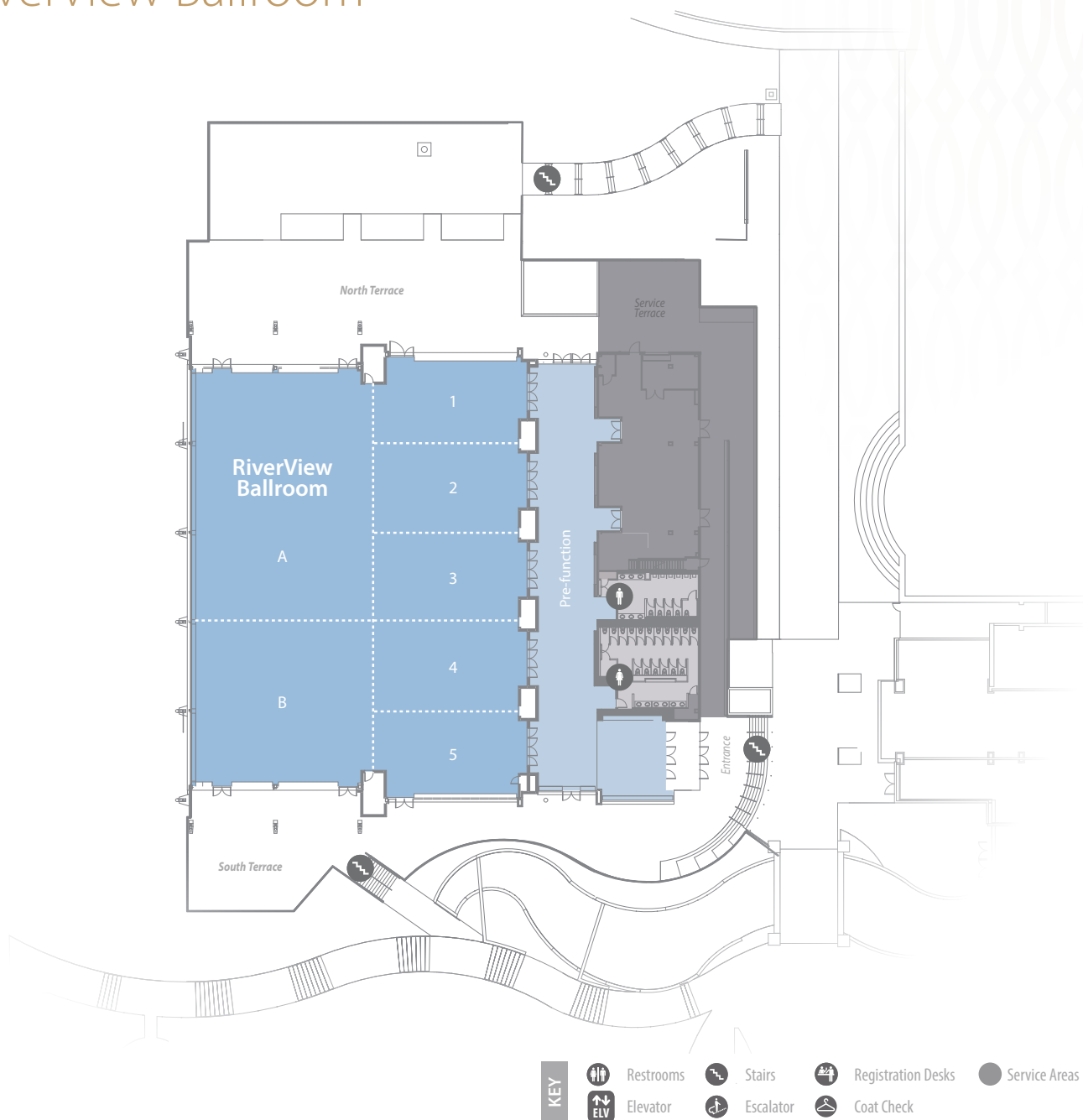

BALLROOM	L X W X H (FEET)	SQ.FT.	THEATER	CLASSROOM	CONFERENCE	U-SHAPE	ROUNDS (10)	RECEPTION
RIVERVIEW BALLROOM	141x110x(13-20)	16,069	1,800	820			990	1,850
A*	85x62x20	5,270	722	330			350	650
B*	29x48x20	3,416	425	180			200	450
1	29x48x(13-19)	1,449	130	64	42	36	100	190
2	29x48x(13-19)	1,449	130	64	42	36	100	190
3	29x48x(13-19)	1,449	130	64	42	36	100	190
4	29x48x(13-19)	1,449	130	64	42	36	100	190
5	29x48x(13-19)	1,449	130	64	42	36	100	190
Pre-function	145x20	3,330						
North Ballroom Terrace	70x218	7,820						
South Ballroom Terrace	40x58	2,120						

Capacities shown in this book are maximum for each room, with no staging or audio-visual, and should be used for reference only. Room capacities will be diminished based on your staging and audio-visual needs.

* Section must be accessed through adjoining areas.

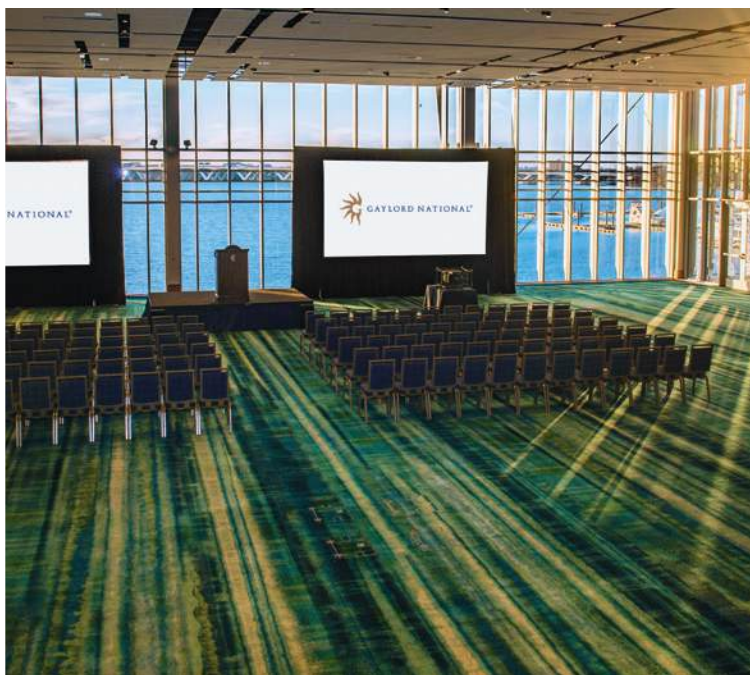

Photographs: (Top, RiverView Ballroom; Left, RiverView Ballroom Exterior; Right, RiverView Ballroom)



Outdoor Event Space



COLOR LEGEND

- Convention Center
- Property Grounds
- Outdoor Spaces

OUTDOOR EVENT SPACE

- E1 Orchard Terrace
- E2 Gaylord Pier
- E3 Potomac Terrace
- E4 Marina Promenade
- E5 Town Green
- E6 Promenade Park

EVENT SPACE

SQ. FT.

OUTDOOR

Orchard Terrace	39,000
Gaylord Pier	11,000
Potomac Terrace	8,400
Marina Promenade	10,600
Town Green	13,500
Promenade Park	3,000



Photograph: Orchard Terrace