

ALT ClicWall

Installation Guide

**Welcome to a new era
in decorative panels.**

hello@vidaspace.co.nz
www.vidaspace.co.nz
0800 119 388



Table of Contents

1. Preparation	4
2. Installing the substructure	5
3. Positioning ClicWall panels	7
3.1 Securing the ClicWall	
3.2 Installing the ClicWall	
4. Finishing internal and external corners	10
4.1 Internal Corners	
4.1.1 Open joint or sealing	
4.1.2 Aluminium ClicWall internal corner profile	
4.1.3 Flexible ClicWall MDF corner profiles	
4.2 External Corners	
4.2.1 Aluminium ClicWall external corner profile	
4.2.2 L-profile for external corner	
4.2.3 Flexible ClicWall MDF corner profiles	
5. Incorporating windows and doors	13
5.1 Windows	
5.1.1 Finishing with a ClicWall external corner profile	
5.1.2 Finishing with MDF mouldings or flexible ClicWall MDF corner profiles	
5.1.3 Finishing with aluminium L-profile	
5.1.4 MDF mitre	
6. Incorporating pipes, sockets and switches	17
6.1 Sockets & Switches	
6.2 Installation around a pipe	
6.3 Radiators and Air Conditioners	
7. Finishing skirting boards and ceiling joints	18
7.1 Skirting Board Trim	
7.1.1 Surface-mounted skirting board	

- 7.1.2 Shadow gap
- 7.1.3 Flush-recessed skirting board
- 7.1.4 Connecting to vinyl flooring

7.2 Ceiling Finish

8. Maintaining and replacing panels **20**

8.1 Retouching a Damaged Panel

8.2 Replacing a Damaged Panel

8.3 Maintaining ClicWall

9. Specific processing tips **23**

9.1 Wide Wall (> 8 M)

9.2 High Wall (> 3.5 M)

9.2.1 Finishing with aluminium T-profile

9.2.2 Shadow gap

9.2.3 Overlap connection

9.3 ClicWall Against or Under an Angled Wall

9.3.1 Against an angled wall

9.3.2 Under an angled wall

9.4 Removable Panel

9.5 Using ClicWall as a Ceiling Finish or Sloping Wall

1. Preparation

Below we go over the most important to-do's before installation:

1. Select a finishing method of your choice: skirting boards, corner profiles, etc.
2. Determine what type of substructure you want to work with and procure matching fasteners (screws or staples) and MS polymer sealant.
3. Assemble the necessary work tools:
 - Plunge-cut saw with guide rail for the panels
 - Screwdriver or stapler to attach the panels
 - Caulking gun to fix and finish the panels
 - Grinding wheel or metal scissors to cut the metal/studs to size and/or a mitre saw to cut the CLS/SLS wood and the corner profiles to size
 - Jigsaw to cut out U-shapes for finishing around beams, etc.
 - Hole saw for cut-outs at sockets, switches, ventilation pipes etc.
 - Masking tape to temporarily secure panels when making corners
 - Spirit level or laser
4. Clean the work floor and wear appropriate personal protective equipment.
5. Check that the room is sufficiently dry and allow the panels to acclimatise there for at least 48 hours in unopened packaging. Make enough perforations to allow for optimal acclimatisation. Make sure there are no holes around the joint to avoid excessive dust collecting on it. Do not remove the packaging until you start installation.
6. Ideally, the room temperature should be between 15 and 20 °C and the humidity between 50 and 60 %. Keep the temperature and humidity constant during installation and ensure a wind and watertight environment.

1

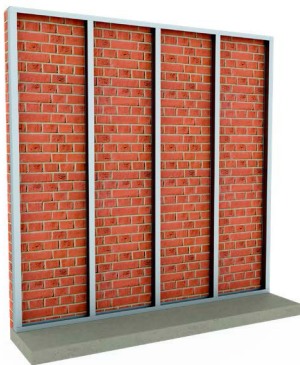

2

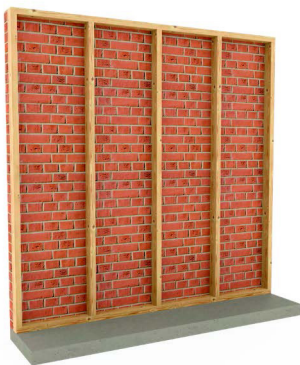

3

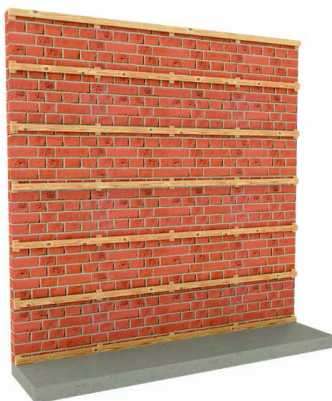

4

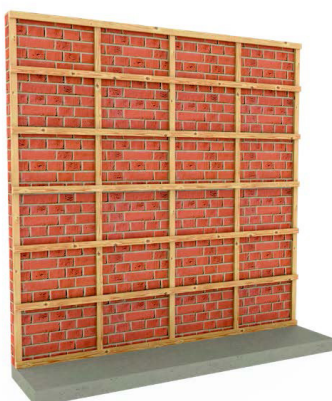

2. Installing the substructure

You generally install ClicWall on a substructure. Install the structure in a straight line, level and without undulations.

There are various types of substructures:

1. **Vertical posts of metal studs**
 - Centre-to-centre distance 600mm
2. **CLS/SLS**
 - Centre-to-centre distance 600mm
3. **Ceiling slats/roof battens directly on the wall horizontally**
 - Centre-to-centre distance 400mm
 - Use spacer screws or packing shims to obtain a flat, aligned surface.
4. **Wooden grid**
 - Vertical posts, centre distance 600mm (e.g. CLS/SLS 38 x 63mm)
 - Horizontal battens, centre-to-centre distance 400mm (e.g. ceiling slats 23 x 38mm)

As you build the frame, think about how you want to distribute the panels across the wall. If the wall is not a multiple of 600 mm, it is best to start and end with 2 equal panels (minimum width 250 mm).

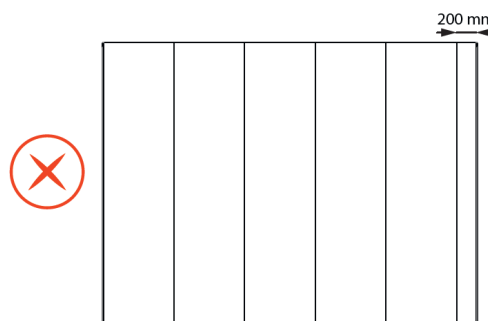
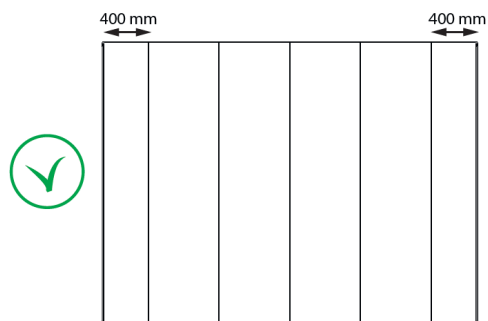

How do I calculate the width of the start and end panels?

- Divide the width of the wall by the width of the panel (600 mm).
- Subtract X number of panels from that until you are left with a number between 1 and 1.999.
- Multiply this number by 600 and finally divide by 2.

Example:

- $3200/600 = 5.33$
- $5.33 - 4 = 1.33$
- $1.33 \times 600 = 800 > 800/2 = 400$

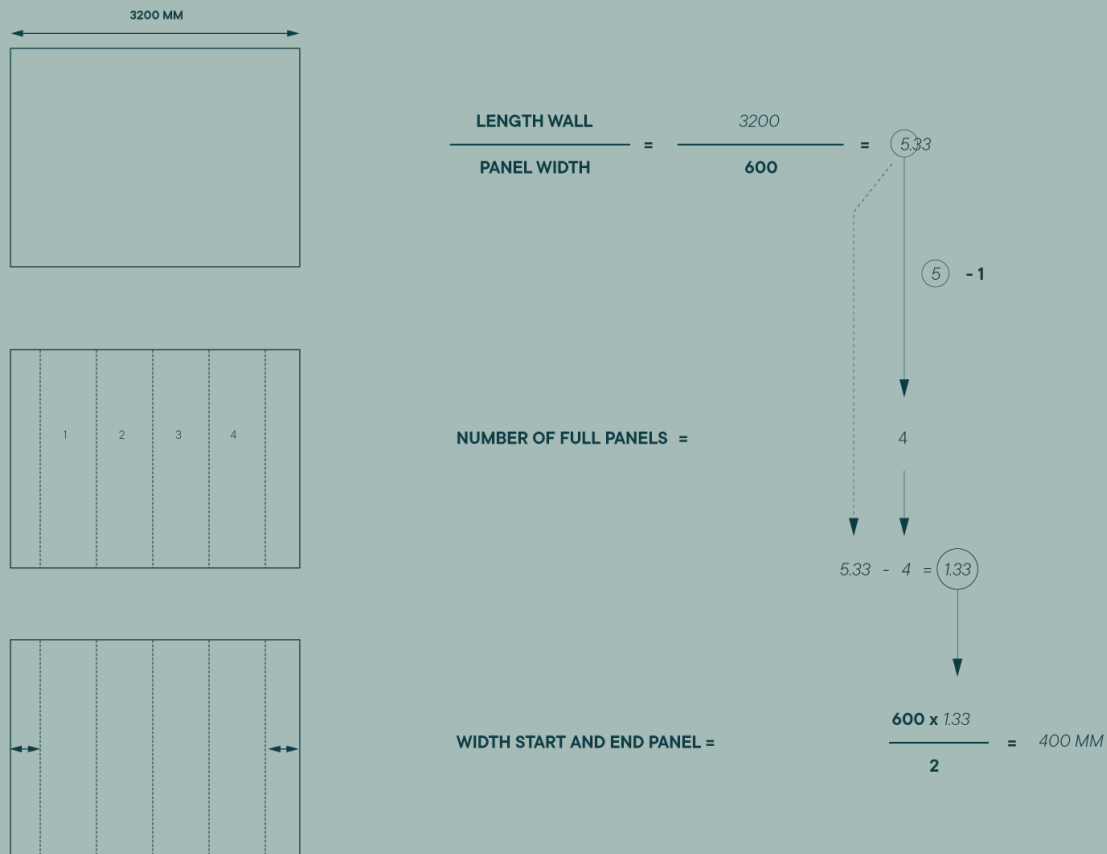

Take into account an expansion joint of 1 mm per running metre (maximum 8 metres) and the location of windows and doors. Avoid posts and battens near pipes and other utilities.

For loads up to 50 kg per screw (4.5 x 45 mm is recommended), the Clicwall panels do not require any additional wood reinforcement (e.g. OSB, chipboard, etc.). For loads up to 70 kg, you can use a Qualirack panel (12 mm). In each case, follow the item's installation instructions.

If a CLT structure is already in place, you can install the ClicWall panels directly onto it (using the same method as installing on battens). The CLT panel must not have any unevenness or be concave or convex. What if the surface is uneven anyway? Install aligned battens against the CLT. You then attach the ClicWall to these.

You can also attach ClicWall directly to plasterboard if the substrate has no unevenness or undulations. Stagger the ClicWall panels in relation to the plasterboard or install the plasterboard horizontally. Preferably work with plasterboard without bevelled edges to ensure a level surface. If there is any unevenness, it is best to install aligned battens against the plasterboard panels and then attach the ClicWall to these.

TIP: Are you installing ClicWall against an exterior wall (cold zone on the outside, warm zone on the inside)? Then in some cases you will need a vapour barrier, for example if you insulate the wall on the warm interior side. Install the vapour barrier between the wood battens and the ClicWall. A second layer of battens between the vapour barrier and the ClicWall is not necessary

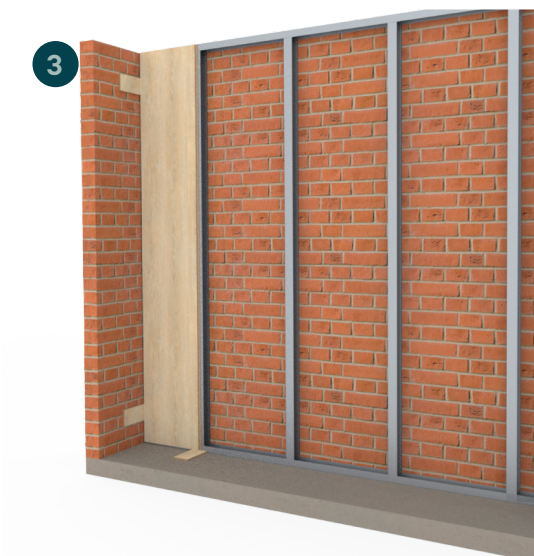

3. Positioning the ClicWall Panels

3.1 Securing the ClicWall

You can attach ClicWall with wood screws (3.5 x 25 mm) or staples (width > 10 mm, depth > 20 mm). Use MS polymer sealant to attach the first and last panels or as extra reinforcement if you use staples. Make sure the substrate is free of dust before applying the MS polymer sealant.

We recommend self-drilling screws to attach ClicWall to metal studs. Make sure that the diameter of the screw head is less than 7 mm.

MS polymer sealant is the best solution for attaching ClicWall to plasterboard. Screws and staples are not suitable in this case. Allow the sealant to dry on the first panel before installing the following panels. You can also install ceiling slats against the plasterboard and attach the panels to these using screws or staples.

Screws or Velcro tape are recommended if you are using ClicWall in a modular set-up where the panels are assembled and disassembled multiple times. Staples or MS polymer sealant are not suitable in this kind of set-up.

3.2 Installing the ClicWall

IMPORTANT: in this manual, we always install ClicWall from left to right.

1. Position the first panel level and allow at least 10 mm clearance at the bottom. You can use a piece of ClicWall for this purpose, which you remove again after fastening the panel **1**

Allow a 1 mm expansion joint per running metre on the left and right sides **2 3**

Leave a 1 to 2 mm joint if you are finishing the ceiling joint with elastic sealant. You can also provide a little more space if you are using finishing strips.

Cut the first panel to size in length and width. Leave the groove on the panel and cut along the tongue side as you adjust the width.

2. Attach the first panel with dabs of MS polymer sealant on the left side **4**. Then insert a screw or staple into the groove every 400 mm on the right side. There is a dotted line in the groove to indicate where you can screw **5** or staple **6**. Make sure the screws or staples are neatly recessed. Et voilà, the first panel is in place.

TIP: Secure the left side of the first panel with a batten or wedge until the mounting sealant has dried. This will prevent the first panel from coming loose when you install the second.

3. Cut the second panel to length, position it in the groove at an angle of about 30° to the wall and press it in gently. Then attach the panel through the groove and into the substructure. Do not push too hard if the panels do not slide together smoothly to avoid damaging the tongue and groove. Make sure the panels are interlocked at the top and bottom to ensure a smooth appearance **7** **8**.

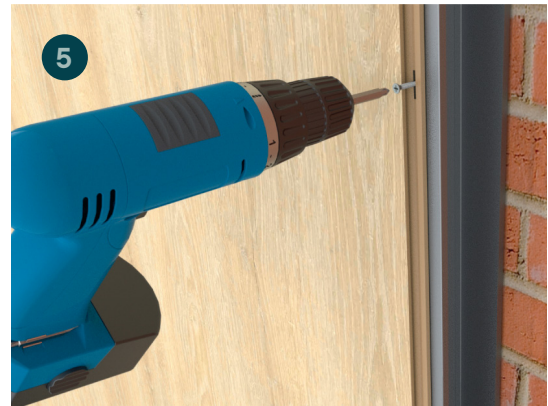

- Repeat this operation up to and including the penultimate panel.

You can still adjust the width of the last panel. When doing so, remember to allow for the expansion joint. You have to keep the tongue on the panel but you can remove the groove. Click the last panel into the one before it and attach it to the structure on the right side using the mounting sealant. Secure the glued side with a batten or wedge.

TIP: Hide the longer wall behind the shorter one. This gives the longer wall more room to move and limits the visible joint in the corner.

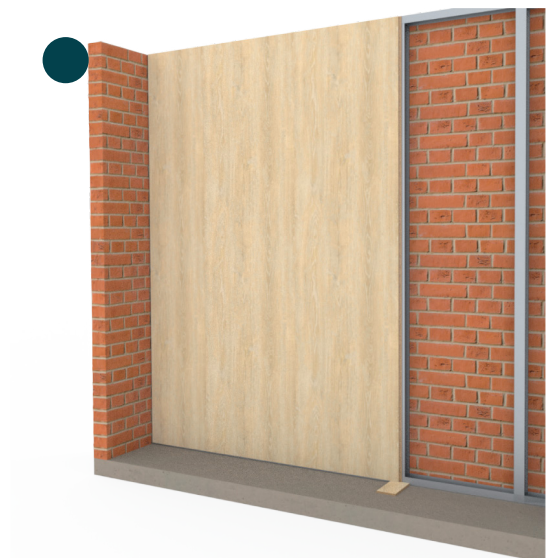

4. Finishing internal and external Corners

You can finish ClicWall in a number of ways. Fit and level the substructure properly for a perfect corner joint.

4.1 Internal Corners

4.1.1 Open joint or sealing

Fill the open joint in the internal corner with sealant, then smooth it out. You can also leave the joint open and work with a shadow gap, but not in humid areas **1**.

4.1.2 Aluminium ClicWall internal corner profile

Use aluminium ClicWall interior corner profiles (2785 or 3500mm) to finish interior corners **2**.

Cut the profile to length: the height of the panel minus the skirting board height.

Apply MS polymer sealant to the serrated side of the profile and attach it to the panel with tape **3**. Place a piece of skirting board under the profile so it does not slip down during curing **4**. Afterwards, remove the tape with a utility knife

TIP: If you work with an interior corner profile, the short wall to which the profile is glued cannot expand. The profile then fills the entire expansion joint. Only the long wall can still slide behind the profile. Thus, this method is only recommended in a situation with a short and a long wall. Do you have two long walls? Then fill the joint with sealant or create a shadow gap.

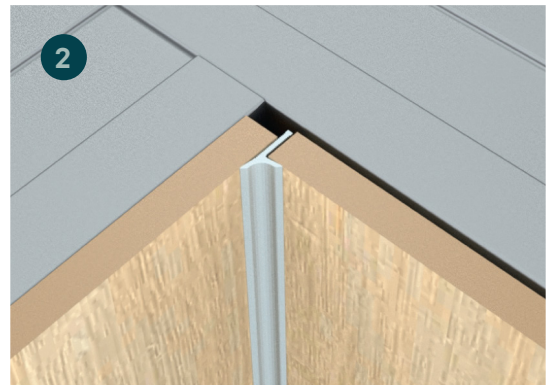
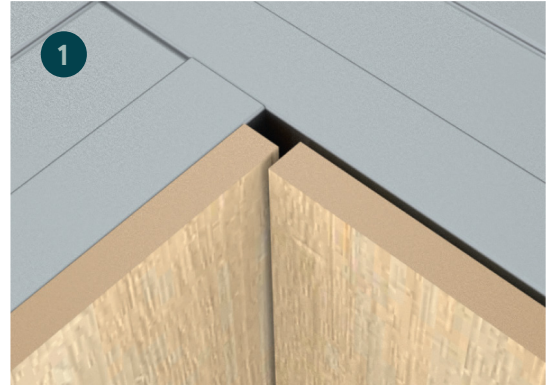

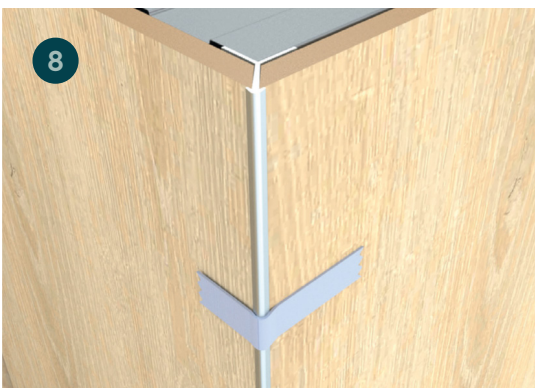
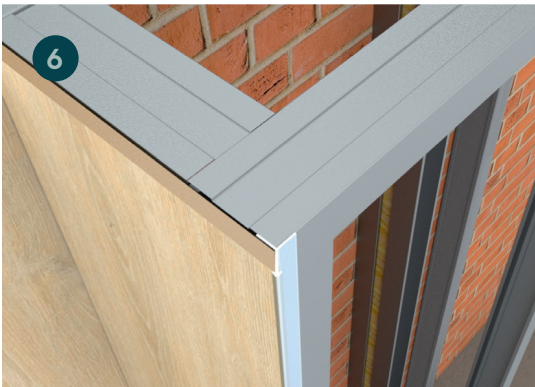
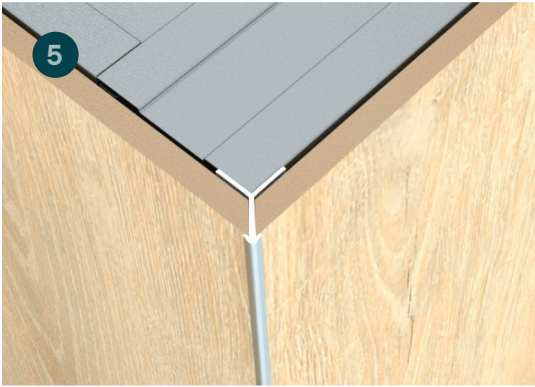

4.2 EXTERNAL CORNERS

4.2.1 Aluminium ClicWall external corner profile

ClicWall exterior corner profiles (2785 or 3500mm) guarantee the most aesthetic finish for the exterior corner (with connection tolerances up to 1.5mm) **5**.

1. Cut the panel first to length, then to width with a 45° mitre. The width is the distance to the corner + the thickness of the panel + 1mm for the thickness of the profile **6**.

TIP: Sand the mitre lightly to avoid injury from the sharp edge after sawing.

2. Cut the profile to length. Subtract the skirting height from this so that the skirting board will fit nicely against the wall afterwards.
3. Apply adhesive to the front edges of the profile and attach the profile to the panel. Then apply dabs of glue to the corners of the substructure and install the panel together with the profile on the substructure.

Place a piece of skirting board under the profile so it does not slip down during curing **7**.

Next cut the following panel to size with a mitre (distance to the corner + the thickness of the panel + 1mm for the thickness of the profile) and slide this panel into the profile. Apply masking tape to the profile and corner panels until the MS polymer sealant has dried **8**. Secure the second panel in the groove with screws or staples, or repeat the previous step to make a U-structure.

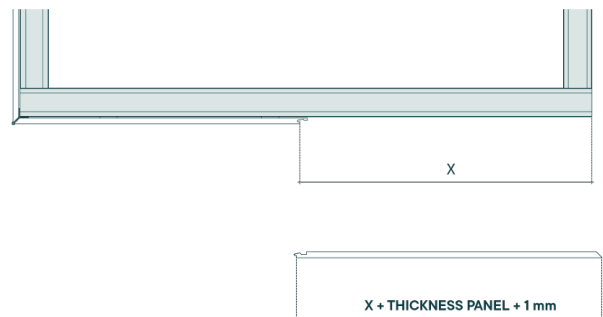

4.2.2 L-profile for external corner

If you use the aluminium ClicWall L-profile (10 x 15 x 1.5mm), you do not need to mitre the corner panels .

You can also install a larger L-profile. L-profiles are available from most hardware merchants in a variety of sizes.

Please note these profiles are available indent only. Please contact the team for local trim recommendations

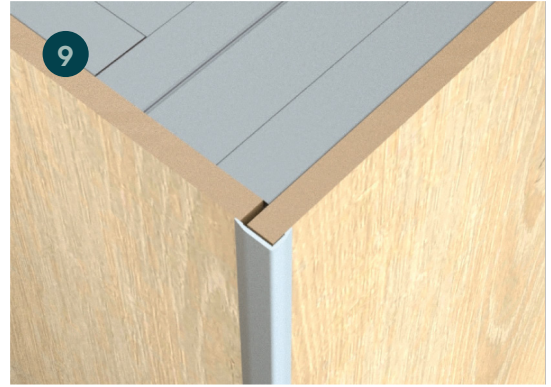

5. Incorporating Windows and Doors

5.1 Windows

Windows can be incorporated into MDF or ClicWall panels. Ensure a seamless seal between the reveal and the exterior joinery.

5.1.1 Finishing with a ClicWall external corner profile

Proceed in the same way as for exterior corners **1** :

1. Start with panel A and cut it to length. Then cut the recess for the window opening using mitred corners. Take into account the thickness of the panels for the reveals (D1, D2 and D4) and also allow 1mm for the thickness of the corner profile
2. Put panel A in place. Click the left side into the previous panel but do not yet attach the right side with screws or staples.
3. Cut all ClicWall exterior corner profiles (P1-P4) to size.
4. Apply dabs of MS polymer sealant to the interior and exterior of corner profile P1. Place the profile between the substructure and panel A.
5. Attach panel A to the substructure with screws or staples in the joint.
6. Apply dabs of MS polymer sealant to the interior of corner profiles P2, P3 and P4 and attach the profiles to the substructure.
7. Cut panels B1 and B2 to length. Make sure the top of B2 and the bottom of B1 are mitred.
8. For panels B1 and B2, remove the thickening at the back of the tongue. This will allow you to click into panel A with a smooth twist. **2** **3** .
9. Place panel B1 on profile P1 and slide it against panel A. Do the same for the bottom of panel B2.
10. Cut panel C to length, then mitre the cut-out for the window opening. Allow for the thickness of the panels for the reveals (D2, D3 and D4) and also allow 1 mm for the thickness of the corner profile.
11. For panel C, also remove the thickening at the back of the tongue and slide it into panel B1 and B2. Make a tight connection to profiles P2, P3 and P4.

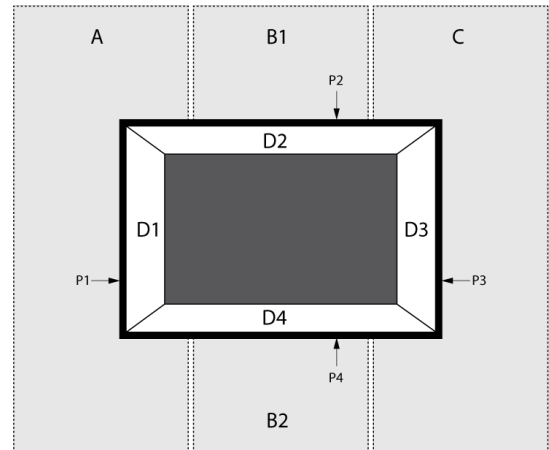

You can make reveals in ClicWall panels or moisture-resistant MDF panels (max. 12mm). Start with the top and bottom (D2 and D4). Cut the strips to size and create a mitre on the side that connects with the profile. Apply dabs of MS polymer sealant to the structure and exterior of profiles P2 and P4. Position the strips and ensure a tight fit to the profiles. Repeat for strips D1 and D3. After installing all the strips, seal the joints between the different reveals (D1-D4). Also seal the transition between the reveals and the window.

5.1.2 Finishing with MDF mouldings

Cut strips of MDF to cover the reveals.

The ClicWall wall panel will not reach in front of the MDF framing. Cut the frames to size and attach them with MS polymer sealant **4**.

5.1.3 Finishing with aluminium L-profile

Cut strips of MDF or ClicWall to cover the reveals. As a finish, choose aluminium profiles (minimum width according to the thickness of the MDF) **5** or ClicWall L-profile (min. 10 x 15 x 1.5mm) **6**.

Let the vertical ClicWall wall panel come up to in front of the sawn strips for the most aesthetic finish. Cut the profiles to size and attach them with MS polymer sealant.





Decor / Decor Finish



Black MDF / Decor Finish

5.1.4 MDF mitre

Do you prefer a finish without profiles? Then, mitre the MDF and cold glue the panels together with white wood glue. Lightly sand the corners afterwards



6. Incorporating pipes, sockets and switches

6.1 Sockets and Switches

Sockets and switches are easily incorporated using with a hole saw of the required diameter. Make the cut-outs when you cut the panels to size, before you install the panel. Keep in mind the structure **1**.

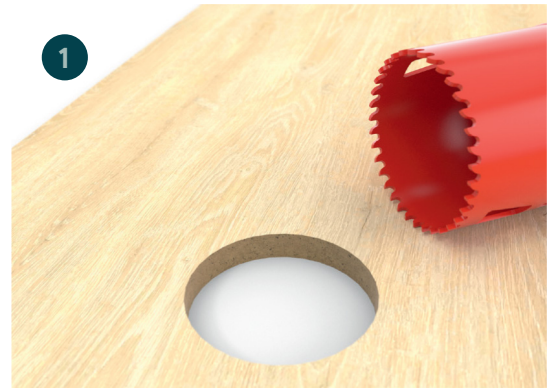

6.2 Installation around a pipe

A pipe prevents the turning motion for clicking the panel into the previous one. In this situation you have to slide the panel (with cut-out for the pipe) into the previous panel. To do this, remove the thickening on the tongue at the back of the panel **2**.

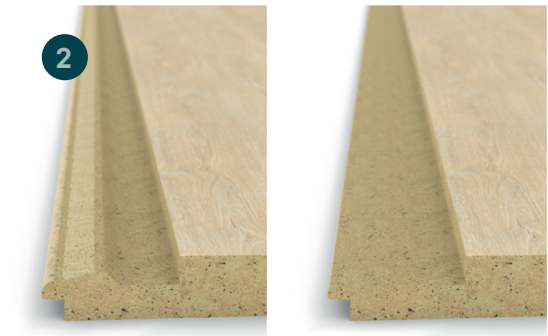

Make a cut-out for the pipe and allow an additional 3 mm for clearance around the pipe itself. Divide the length of the panel horizontally into two, exactly through the centre of the pipe.

Install the lower section of the panel **3**. The modified tongue allows you to slide the panel sideways into the previous panel. For this you need 3mm clearance around the pipe (see above).



Apply white wood glue to the end of the bottom panel. Then, with a sideways motion, put the top section of the panel in place **4**.

6.3 Radiators and Air Conditioners

You can install ClicWall near a radiator without any problems, provided there is at least 3 to 5cm between the panels and the appliance.

With an air conditioner, it is best to avoid direct air currents on the panels.



7. Finishing Skirting Boards and Ceiling Joints

7.1 Skirting Board Trim

7.1.1 Surface-mounted skirting board

Select skirting board - timber, MDF or aluminum profile. Use MS polymer sealant to attach the skirting boards or profiles **1**

7.1.2 Shadow gap

For a clean finish, work with shadow gaps. Use an L-profile **2** or fill with a strip of black moisture-resistant MDF **3** (or other moisture-resistant material) to prevent contact with water.

When installing the L-profile or strip, take into account unevenness in the floor and the height of the profile or strip. Align the bottom of the ClicWall level. Allow enough space so that once the panels are installed, you can smoothly place the profile or strip between the floor and the ClicWall. Take into account the highest point of the floor and allow 2mm extra clearance between the profile or strip and the ClicWall to avoid tension on the panels. Secure the profile or strip with MS polymer sealant.

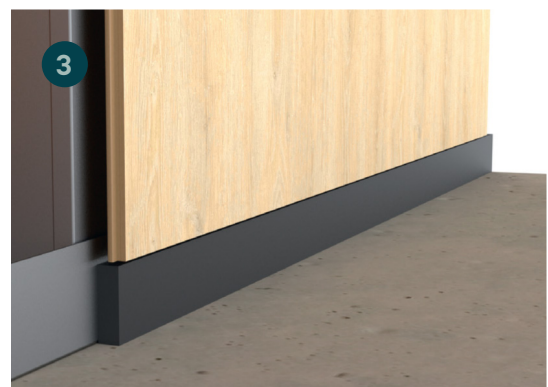



7.1.3 Flush-recessed skirting board

Place the skirting board in the same plane of the ClicWall, with or without an L-profile (10 x 15 x 1.5mm) **4**.

Use a jig and packing so that you can then place the skirting board underneath, in combination with an L-profile if necessary **5**. Where necessary, cut the skirting board to the correct height. Attach the skirting board and seal the joint between the skirting board and the ClicWall.



Avoid contact between the panels and absorbent fasteners. Are you installing stone skirting boards with absorbent grout? Then install a profile between the skirting boards and the panels or leave a joint that you can fill with elastic sealant.

7.1.4 Connecting to vinyl flooring

You can also finish ClicWall with a raised vinyl floor. Install the ClicWall first, then the L-profile, then the vinyl floor against the L-profile. Allow 2 mm clearance between the ClicWall and the L-profile to avoid tension on the panels **6**.

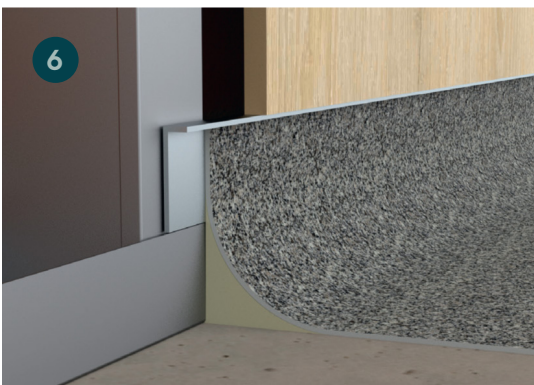

7.2 Ceiling Finish

Preferably install the ClicWall before you finish the ceiling to avoid damaging the ceiling and to allow the panels to expand properly.

If you install the ClicWall after you have finished the ceiling, it is best to provide an expansion joint. You can leave it open or fill it with elastic sealant. If necessary, use a finishing strip or L-profile in MDF or aluminium to hide the expansion joint. Attach it with MS polymer sealant **7**.



8. Maintaining and replacing panels

ClicWall panels are shock-proof. The impact resistance is up to 4 times higher than plasterboard – up to 20 Newton (N). The scratch resistance is also 4 times higher than that of plasterboard.

8.1 Retouching a damaged panel

Slight damage to ClicWall panels is easily touched up with a repair kit.

1. Careful preparation is necessary. First clean the dust spot on the floor and make sure it is free of oil and grease.
2. Choose your color.
3. Melting and mixing.
4. Fill.
5. Remove excess material with the sharp side of the filler applicator.
6. Detail work: if you want to imitate the wood grain in detail, make a groove in the filler with a sharp object and fill in the groove with a darker color.
7. Degreasing: degrease with the gray sanding block.
8. Adjustment of the gloss layer: with the green side of the block you provide more gloss. With the white side you make the surface matt.

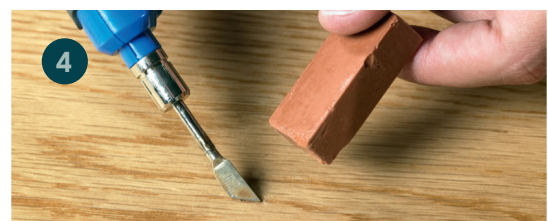

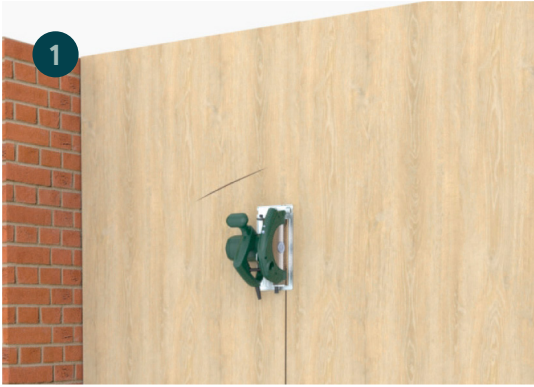

8.2 Replacing a damaged panel

You can easily replace a badly damaged panel using a multi-tool and plunge-cut saw. Note: you can only remove an installed panel if it was attached with screws or staples.

1. Set the plunge-cut saw to the thickness of the panel (10mm or 12mm). Cut the panel to be replaced lengthwise at 40mm from the joint on the groove side **1**.
2. Complete the operation at the top and bottom with a multi-tool **2**.
3. Remove the left side (tongue side) of the panel from the assembly **3**.
4. Remove the remaining piece on the right side (groove side). The screws or staples can be left in place.
5. Using MS polymer sealant, reattach the panel to the right of the replaced panel to the substructure. Press it down well and let the glue dry.
6. Take a new panel, cut it to length and remove the lip from the groove **4**.
7. Click the new panel into the panel to its left and attach the right side (where the groove was originally) to the substructure with MS polymer sealant.

8.3 Maintaining ClicWall

ClicWall's hygienic melamine surface requires no special maintenance. You can also easily clean textured wood or other surfaces.

Treating slight or recent soiling

Clean the panel with a paper towel, a soft dry or damp cloth, or a sponge. Do you use a damp cloth? Afterwards, dry the panel surface with an absorbent paper towel or microfibre cloth.

Treating normal or long-term soiling

Clean the panel with warm water and a microfibre cloth, soft sponge or brush. Do not use too much water while cleaning. Choose a standard cleaning agent or one without abrasive ingredients. Apply the agent immediately to the soiled area. Then wipe the panel using fresh water to remove all traces of the agent and avoid streaks. Dry the panel surface with an absorbent cloth or paper towel.

Under no circumstances use the following materials and cleaning agents:

- Abrasive or aggressive materials (scouring pad, steel wool)
- Polish, washing powder, furniture cleaner, bleach
- Detergents with strong acids and salts
- Steam cleaning equipment.

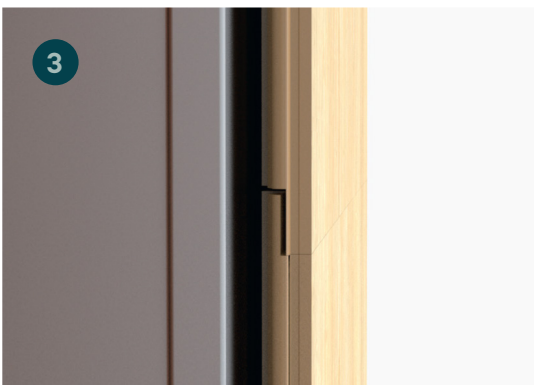

9. Specific Processing Tips

9.1 Wide Wall (> 8m)

Allow an additional expansion joint for walls wider than 8 metres and finish with a T-profile. Attach with MS polymer sealant.

9.2 High Wall (> 3.5m)

A T-profile is the most practical installation method for walls higher than 3.5 metres (3500mm panels are indent only). You can also place the panels on top of each other as they are or using a rebate. Install the bottom row of ClicWall level to make the panels blend seamlessly. Avoid dirt or unevenness between rows.

9.2.1 Finishing with aluminium T-profile

Install the bottom row of ClicWall, leaving an open joint (with packing if necessary), then install the top row of panels. Finish the transition with an aluminium T-profile

1

Mount the T-profile with the wide side at the front of the wall. That way, the expansion joint between the panels is hidden by the profile. Use MS polymer sealant for gluing to the bottom panel.

9.2.2 Shadow gap

After cutting the two panels at right angles, place them on top of each other with spacers in between the panels to allow for the required shadow line. Finish the full height and then continue the installation from left to right. 2

9.2.3 Overlap connection

Mill a rebate at the top of the bottom panel and at the bottom of the top panel to create an overlapping joint. Finish the full height and then continue the installation from left to right. 3

9.3 ClicWall against or under an angled wall

9.3.1 Against an angled wall

Cut the panel to length and temporarily level it in front of the structure. Do not forget the expansion joint. Measure the open space at the bottom and mark it on the panel at the top. Saw the panel at an angle and begin installation **1**.

9.3.2 Under an angled wall

Install the first panel each time at the highest point of the sloping wall. That way, it can still be turned. If the highest point is on the right, installation from right to left is recommended. Install the tongues in the grooves **2**.

9.4 REMOVABLE PANEL

If there are utilities in the room, it is best to install a removable panel.

Take a panel, cut it to length and cut the lip of the groove as shown in the figure **3**.

Mill or drill a hole on the back of the panel next to the sawn groove. Place a magnet in it in the same plane as the panel. Attach the magnet to the metal stud or to the wooden structure in which you also place a magnet. This makes the panel removable **4**.

Apply MS polymer sealant to the right of the modified groove to secure the tongue side of the next panel to the structure. Avoid contact between the sealant and the removable panel. Insert the next panel into the custom groove and press lightly. Secure the groove side with screws or staples. If necessary, open the removable panel and temporarily secure the right panel with masking tape. Then continue with the installation.



9.5 Using ClicWall as a ceiling finish or sloping wall

ClicWall is essentially a wall-finishing product. But you can also use it as a ceiling. ClicWall does not come with a Uniclic system on the short side of the panel, so the room width is limited to 3500mm(indent).

When installing on the ceiling, provide an extra sturdy framework, with cross slats with a maximum centre- to-centre distance of 300mm. Install the ClicWall panels at right angles to the battens. Attach the panels with screws (stapling is not possible) and apply sufficient MS polymer sealant to each ceiling slat across the full width of the ClicWall panel ① .



If you have any questions about ClicWall installation please reach out to our team. We'll be happy to help you.

VidaSpace Auckland Showroom
105 St Georges Bay Road, Parnell,
Auckland, New Zealand

VidaSpace Wellington Showroom
Upstairs in the Wellington Design Library
282 Thorndon Quay, Pipitea, Wellington

VidaSpace Christchurch Showroom
143 Victoria Street,
Christchurch, New Zealand

VidaSpace HQ
28 Enterprise Drive,
Levin, New Zealand