



One-of-a-kind venue for your  
once-in-a-lifetime moment.

2026 UPDATED RATES  
All rates valid until Nov 30, 2026



# Reception Venues



Harana

Size: 152 square meters

**Capacity: 75 - 85 pax**

Amenity Detail: Indoor with A/C. Comfort rooms for male & female guests. Overlooking Balcony; Sefriya Garden View



Liwasan Garden

An ode to the Versailles Garden in France, Liwasan makes for the perfect outdoor venue for celebrations of all kinds. The spacious 1215 sqm courtyard features a tiered garden fountain that is as equally enchanting under the sun as it is lit up at night.

Size: 1215 square meters

**Capacity: 150 - 200 pax**

Amenity Detail: Outdoor with garden fountain which lights up beautifully at night.



Kundiman

Amenity Detail:

Outdoor garden with idyllic fountain feature and backdrop of grand staircase leading to Tipanan Hall

**Capacity: 80 pax**



Tipanan

Size: 152 square meters

Amenity Detail:

- Indoor venue with A/C
- Functioning Kitchen & Bar
- Comfort Rooms
- Balcony Facing Sefriya Gardens

**Capacity: 75 - 85 pax**



Hiraya

Size: 1600 square meters

Amenity Detail:

- Spacious verdant garden
- Accommodation's romantic structure as backdrop
- Age old mango trees
- Convenient access to chapel

**Capacity: 150 - 200 pax**

## Rates & Inclusions

**PHP 150,000**

- Use of venue for 4 hours.
- 4-5 hours free ingress and 3 hours free egress.
- Free 4 hours use of holding room for 12 pax.
- Use of Hiraya Garden is permitted only when all 12 rooms in the Hiraya area are booked.





Size: 79 square meters

**Capacity: 30 pax**

Amenity Detail:

- Outdoor venue with uninterrupted view of Sefriya gardens.

Size: 152 square meters

Amenity Detail:

- Indoor venue with A/C
- Functioning Kitchen & Bar
- Comfort Rooms
- Balcony Facing Sefriya Gardens

**Capacity: 75 - 85 pax**

Size: 1600 square meters

Amenity Detail:

- Spacious verdant garden
- Accommodation's romantic structure as backdrop
- Age old mango trees
- Convenient access to chapel

**Capacity: 150 - 200 pax**

Amenity Detail:

Picket fence, intricate floral flooring, view of Amihan and Habagat Garden, view of Liwasan Hall.

**Capacity: 30 pax**



## Ceremony Venues

- Kapilya (50-70 pax)
- Carinosa (30-40 pax)
- Tagpuan Garden (100-150 pax)
- Tagpuan (30-40 pax)
- Habagat (100-150 pax)
- Tipanan Hall (75-100 pax)
- Harana Hall (75-85 pax)
- Liwasan Garden (150-200pax)
- Hiraya Garden (150-200pax)
- Kundiman Garden (100-150pax)

## Rates & Inclusions

**PHP 50,000**

- Use of venue for a maximum of 2 hours.
- 4-5 hours free ingress and 3 hours free egress.
- Use of Hiraya Garden is permitted only when all 12 rooms in the Hiraya area are booked.

## Cocktail Venues

- Carinosa (30-40 pax)
- Tagpuan Garden (100-150 pax)
- Tagpuan (30-40 pax)
- Habagat (100-150 pax)
- Tipanan Hall (75-100 pax)
- Harana Hall (75-85 pax)
- Liwasan Garden (150-200pax)
- Hiraya Garden (150-200pax)
- Kundiman Garden (100-150pax)

## Rates & Inclusions

**PHP 70,000**

- Use of venue for a maximum of 2 hours.
- 4-5 hours free ingress and 3 hours free egress.
- Use of Hiraya Garden is permitted only when all 12 rooms in the Hiraya area are booked.

# Wedding Packages

## PACKAGE A

Ceremony & Reception  
Venue of Your Choice

**PHP 190,000**

The use of the ceremony venue is allowed for a maximum of 2 hours, while the reception venue may be used for a maximum of 4 hours.

## PACKAGE B

Cocktail & Reception  
Venue of Your Choice

**PHP 200,000**

The use of the cocktail venue is allowed for a maximum of 2 hours, while the reception venue may be used for a maximum of 4 hours.

## PACKAGE C

Ceremony, Cocktail & Reception  
Venue of Your Choice

**PHP 250,000**

The ceremony venue may be used for a maximum of 2 hours, the cocktail venue for a maximum of 2 hours, and the reception venue for a maximum of 4 hours.

- **STANDARD CORKAGE FEES APPLY.** The total estimated cost above does not include corkage fees, which apply if you choose to hire a non-accredited food caterer (₱30,000) and non-accredited stylist (₱20,000). If you wish to begin setup beyond the free ingress period, an additional fee of ₱2,000 per hour will apply. Crew meals brought in from outside suppliers will be charged a corkage fee of ₱5,000 per meal type (e.g., breakfast, lunch, or dinner).
- Alternatively, the resort offers packed crew meals at ₱300 per head.
- For the electrical usage, we can only allow up to 60 amps. However, we will request an actual equipment list indicating the required amperage—this should include sound and light equipment, LED wall, photo booth, and band equipment, so we can properly assess if any additional payment for electrical charge will apply.
- No corkage fee will be charged for suppliers such as mobile bars, unlimited alcohol, coffee carts, grazing tables, food carts, food vans, or kiosks, except for those specifically mentioned above. However, we will need to assess if additional electrical charges apply, should they require electricity. There is also no corkage fee for fireworks on your event.
- In-house guests are strictly not allowed to avail of packed meals or bring outside food.
- Should they do so, a corkage fee of ₱400 per person per meal will apply, as the resort operates its own restaurant from 7:00 AM to 10:00 PM.
- An extra person in the room will be charged ₱2,000, inclusive of an extra bed. Please note that only one (1) extra person is allowed per room.
- We strictly do not allow non-in house guests at the resort. Guests are allowed entry only atleast an hour prior to your booked time. If all rooms are booked, non-in-house entourage members may do their preparation and makeup at the hotel.
- The venue rental includes 4 to 5 hours of free ingress and 3 hours of egress immediately after the event.
- Any extension of venue use will be charged at ₱25,000 per hour.
- The client will be informed by the Resort Management on the day of the event regarding any potential additional charges





# SEFRIYA *Grand*

A grander setting, crafted for quiet luxury.







# SEFRIYA *Grand*

## SEFRIYA GRAND PAVILION (300 PAX)

- The package includes the use of the venue for 4 hours, with 8 hours of free ingress and 4 hours of free egress.
- It also comes with complimentary use of the Bridal Makeup Room and Groom Makeup Room for 4 hours each, good for up to 10 pax per room
- Includes (1) Bedroom Suite for a one-night stay that is good for 2 pax.

**PHP 320,000**

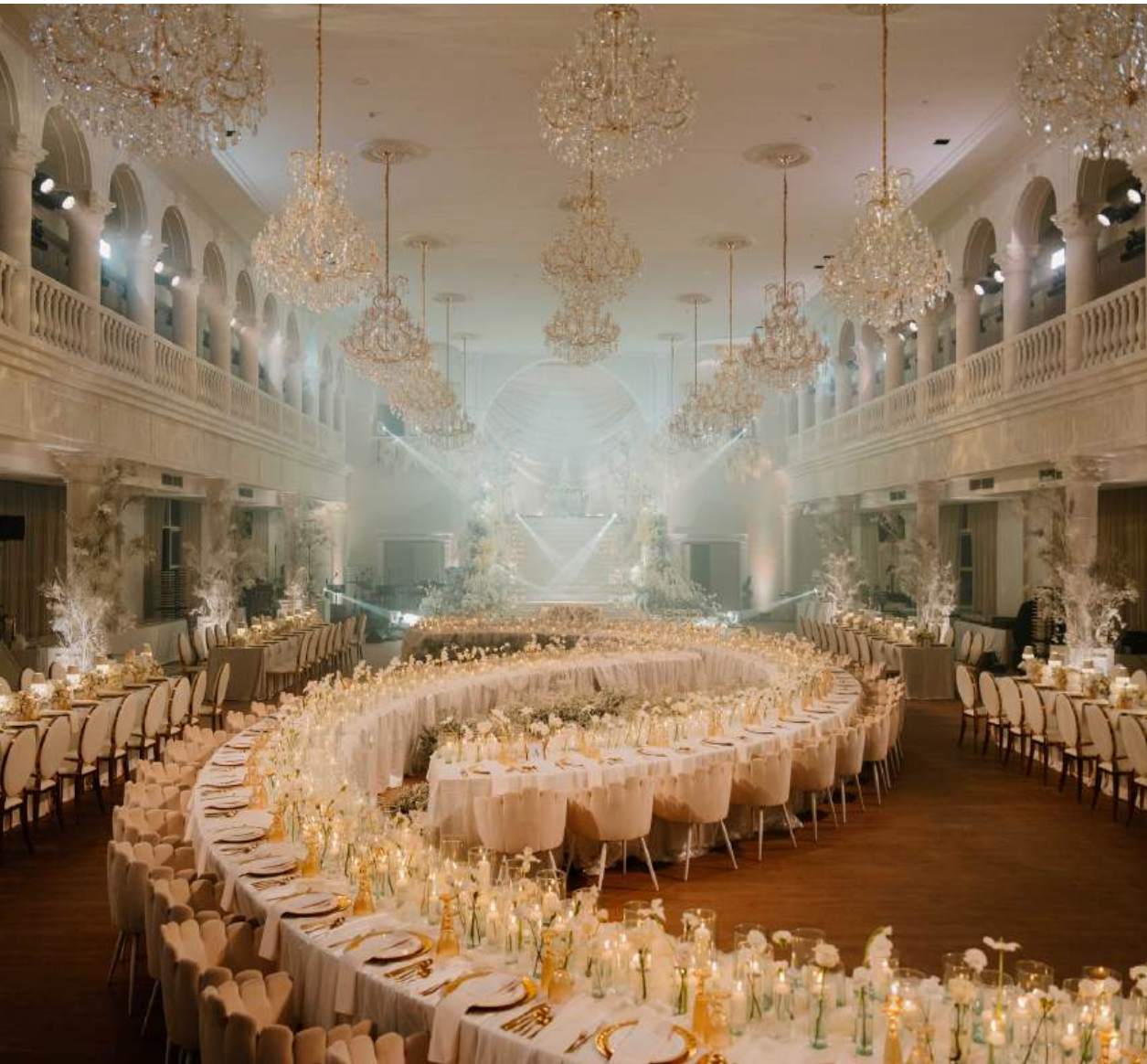



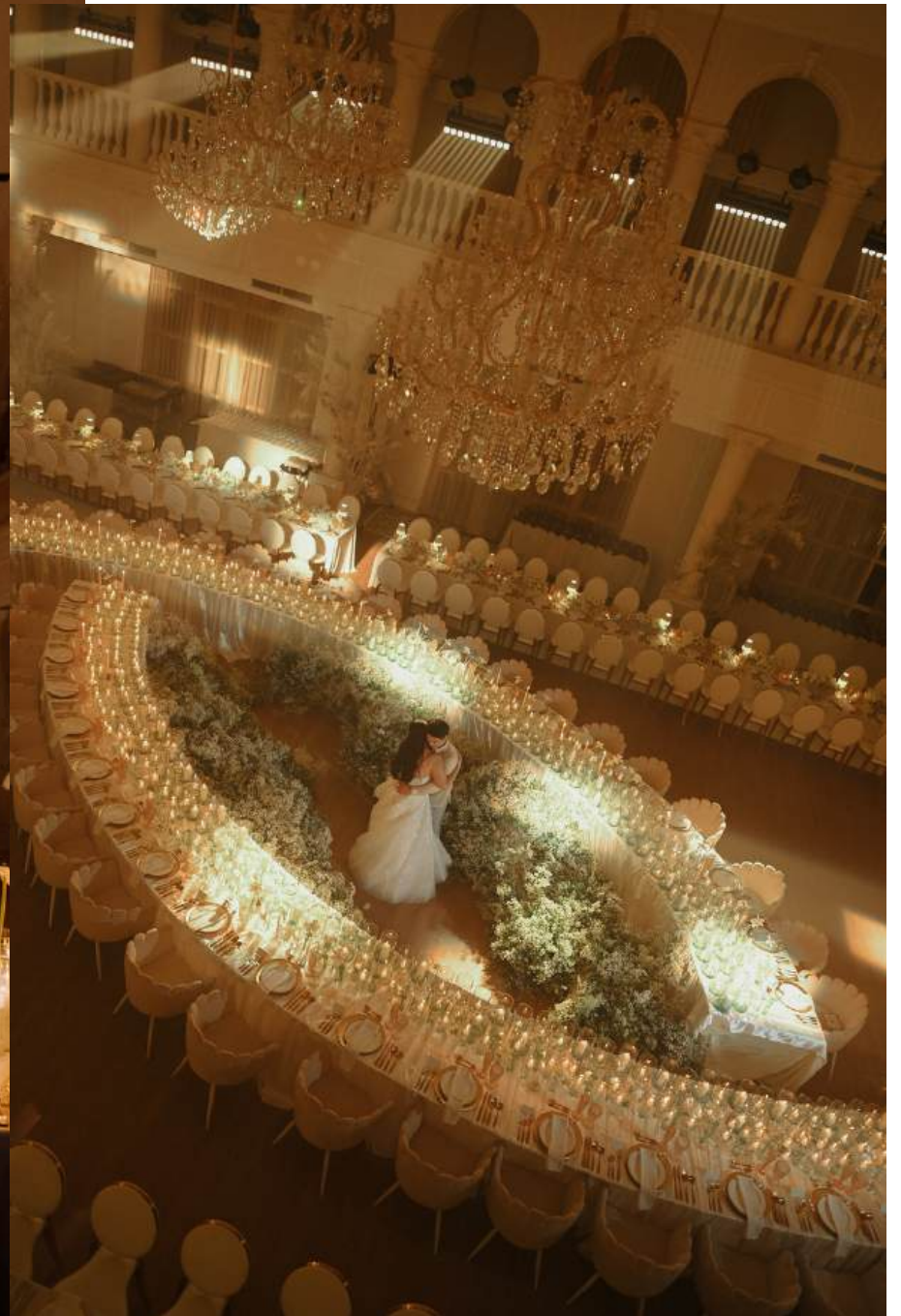





SEFRIYA  
*Grand*

## SEFRIYA GRAND PAVILION & GARDEN

- The package includes the use of the Pavilion for 4 hours and the Garden for 2 hours, along with 8 hours of free ingress and 4 hours of free egress.
- It also comes with complimentary use of the Bridal Makeup Room and Groom Makeup Room for 4 hours each, good for up to 10 pax per room
- Includes one (1) Bedroom Suite for a one-night stay that is good for 2 pax.

PHP 360,000















  
SEFRIYA  
*Grand*









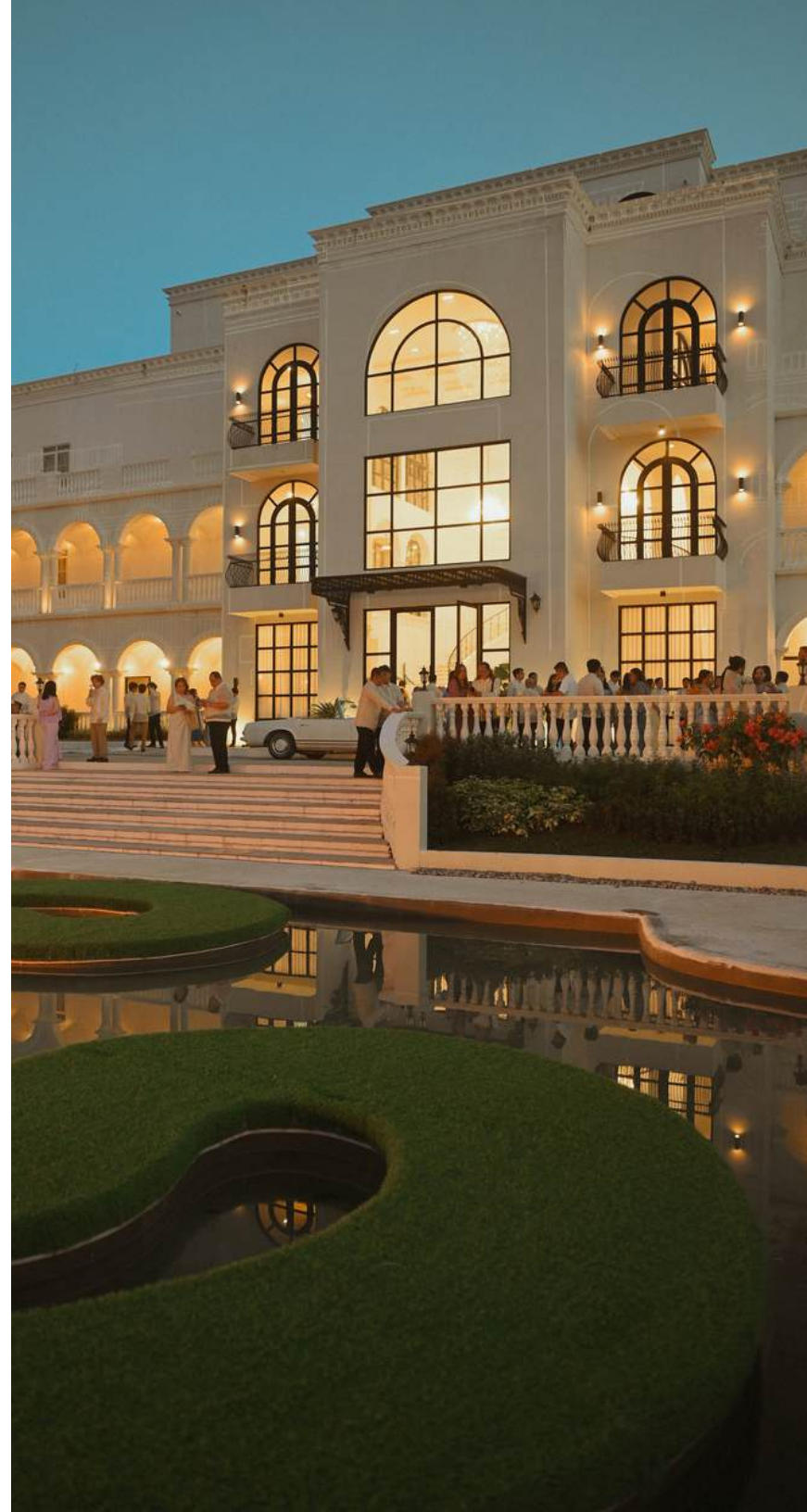







# Wedding Packages



- **STANDARD CORKAGE FEES APPLY.** The total estimated cost above does not include corkage fees, which apply if you choose to hire a non-accredited food caterer (₱30,000) and non-accredited stylist (₱20,000). If you wish to begin setup beyond the free ingress period, an additional fee of ₱5,000 per hour will apply. Crew meals brought in from outside suppliers will be charged a corkage fee of ₱5,000 per meal type (e.g., breakfast, lunch, or dinner). Alternatively, the resort offers packed crew meals at ₱300 per head.
- For the electrical usage, we can only allow up to 60 amps. However, we will request an actual equipment list indicating the required amperage—this should include sound and light equipment, LED wall, photo booth, and band equipment, so we can properly assess if any additional payment for electrical charge will apply.
- No corkage fee will be charged for suppliers such as mobile bars, unlimited alcohol, coffee carts, grazing tables, food carts, food vans, or kiosks, except for those specifically mentioned above. However, we will need to assess if additional electrical charges apply, should they require electricity. There is also no corkage fee for fireworks on your event.
- In-house guests are strictly not allowed to avail of packed meals or bring outside food. Should they do so, a corkage fee of ₱400 per person per meal will apply, as the resort operates its own restaurant from 7:00 AM to 10:00 PM.
- An additional charge of ₱2,000 per extra person will apply, inclusive of an extra bed. A maximum of one (1) extra person is allowed for Superior and Deluxe Rooms, and up to two (2) extra persons for Suite Rooms.
- Pets are allowed in the resort with a corresponding fee of ₱500 per pet per night
- For the Bridal Makeup Room and Groom Makeup Room, use beyond 4 hours will be charged ₱5,000 per extra hour per room, and guests beyond 10 pax will be charged ₱2,000 per extra person per room.
- We strictly do not allow non-in house guests at the resort. Guests are allowed entry only at least an hour prior to your booked time.
- The venue rental includes 8 hours of free ingress and 4 hours of egress immediately after the event.
- Any extension of venue use will be charged at ₱35,000 per hour.
- The client will be informed by the Resort Management on the day of the event regarding any potential additional charges.



# Deposit to Lock-in the Date

- TO CONFIRM, we kindly ask for a 50% deposit of your selected venue or package.
- We require an additional deposit 3 months prior to your booked date equivalent to at least half
- or 50% of the total estimated cost. The remaining balance can be paid on the day of the event.
- Non-refundable reservation fee shall be subtracted from the client's total bill. (Nonrefundable for cancellation or rebooking of confirmed bookings).
- The RESORT reserves the right to forfeit all deposits for cancellation/rebooking except those caused by acts of God or any other legitimate conditions beyond the client's control such as typhoons, earthquakes, volcanic eruption etc.
- I hope you find everything in order. Should you have any questions or clarifications, please do not hesitate to reach me at this number: 0917 3049 869. Thank you very much and more power!

Very truly yours,

A handwritten signature in black ink, appearing to read 'Ron Bernabe-Flores', with a stylized, cursive script.

Ron Bernabe-Flores

Sefriya Farm and Orchard