



ERROR CODES

E110-E129 SENSOR NOT CONNECTED

- Restart the system by turning the machine off and then on again.
- If the error persists, check the cable between sensor and receiver.

E201 NO GPS FIX

- Check antenna cable.

E202 NO GPS FIX (FLOAT)

- The system is calculating GPS position. Wait until it changes.
- If the error persists, the GPS conditions might be bad.
- The Job-type “Without GPS” can be used instead.

E203 NO GPS FIX (SBAS)

- Check internet connection, mobile antenna, SIM card, and NTRIP subscription.

E204 NO HEADING

- Check cable between secondary controlbox and the GPS antenna.
- If the error persists, the GPS conditions might be bad, try moving the machine to another area.

OTHER ERRORS

- Check cable between secondary controlbox and the GPS antenna.
- If the error persists, the GPS conditions might be bad, try moving the machine to another area.

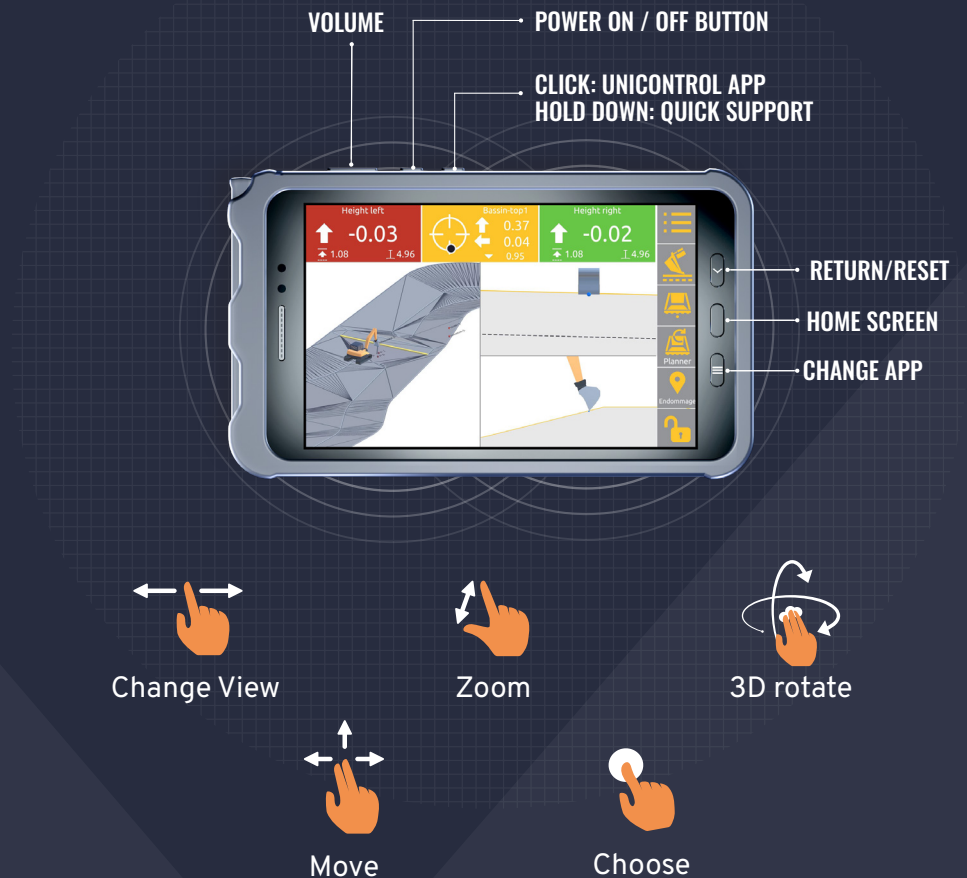



NAVIGATION

PRESS

HOLD

Job Type Menu



Project Menu

Set Zero Height



Height / Side Offset

Change Bucket Focus



Create Helpline

Change Bucket



Select Bucket Menu

Log Point



Point Code Menu

Lock to Point / Line



Delete Point / Line

MENUS

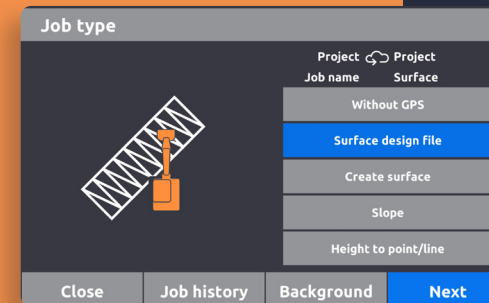

ACCESS JOB HISTORY

LOAD BACKGROUND FILES

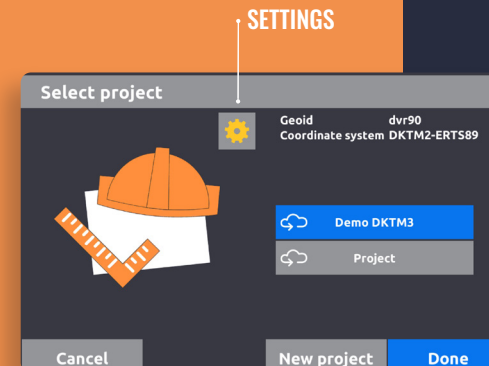

SETTINGS

CREATE NEW PROJECT

JOB TYPE MENU

From the jobtype menu, you can select between five different jobs, access your job history and load background files.

PROJECT MENU

From the project menu, you can select between projects, create new projects and access the settings menu.